JX1080U, JX1090U, JX1100U REPAIR MANUAL COMPLETE CONTENTS

SECTION 00 - GENERAL	2
SECTION 10 - ENGINE	3
SECTION 18 - CLUTCH	4
SECTION 21 - TRANSMISSIONS	5
SECTION 23 - MFD TRANSFER BOX	9
SECTION 25 - MFD AXLE	10
SECTION 27 - REAR AXLE MECHANICAL TRANSMISSION	11
SECTION 31 - POWER TAKE-OFF	12
SECTION 33 - BRAKES	13
SECTION 35 - HYDRAULIC SYSTEMS	14
SECTION 41 - STEERING	21
SECTION 44 - AXLES AND WHEELS	22
SECTION 50 - AUXILIARY UNITS	23
SECTION 55 - ELECTRICAL SYSTEMS	25
SECTION 90 - CAB, PLATFORM AND BODYWORK	35

The following pages are the collation of the contents pages from each section and chapter of the JX1080U, JX1090U, JX1100U Repair manual. Complete Repair part # 87054727.

The sections used through out all Case IH product Repair manuals may not be used for each product. Each Repair manual will be made up of one or several books. Each book will be labeled as to which sections are in the overall Repair manual and which sections are in each book.

The sections listed above are the sections utilized for the JX1080U, JX1090U, JX1100U Tractors.

DESCRIPTION AND OPERATION

SECTIONAL VIEWS

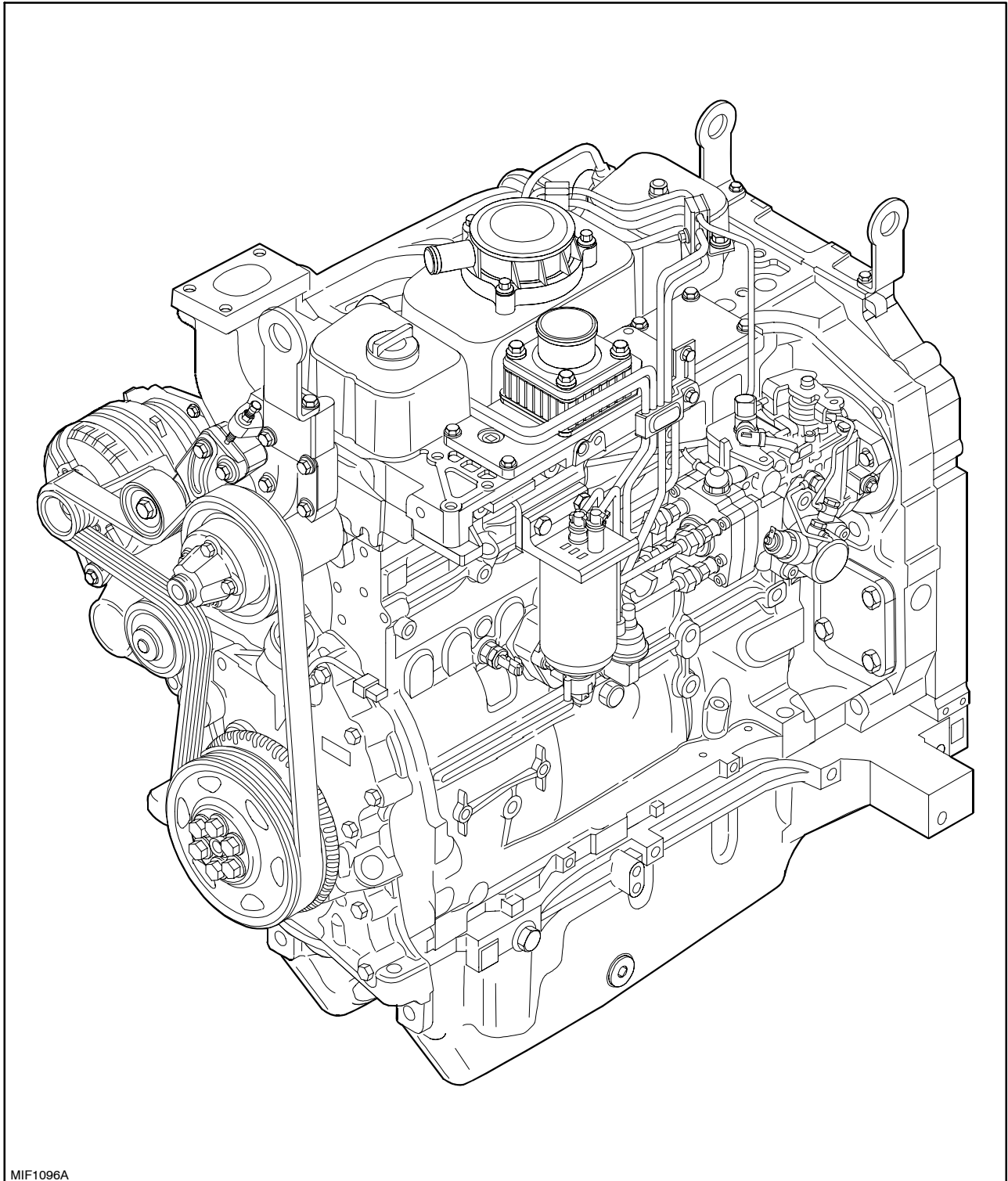

MIF1096A

View of JX1080U of 60 kW (80 HP)

model JX1090U

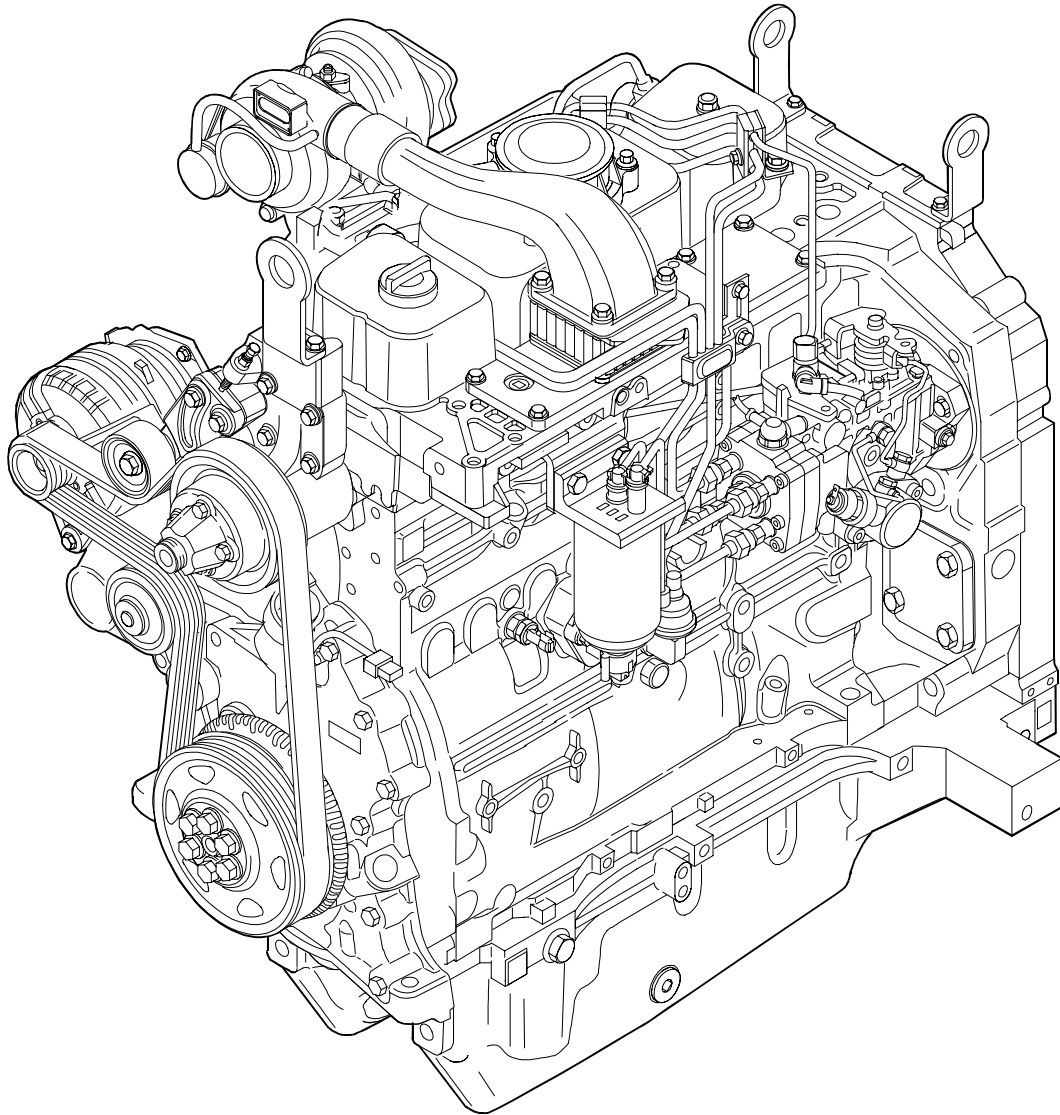
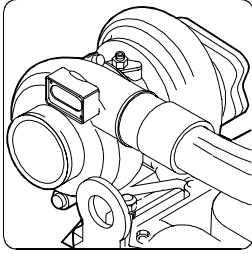

MIF1097A

View of JX1090U tractor engines of 67 kW (90 HP) and JX1100U of 73.5 kW (98 HP)

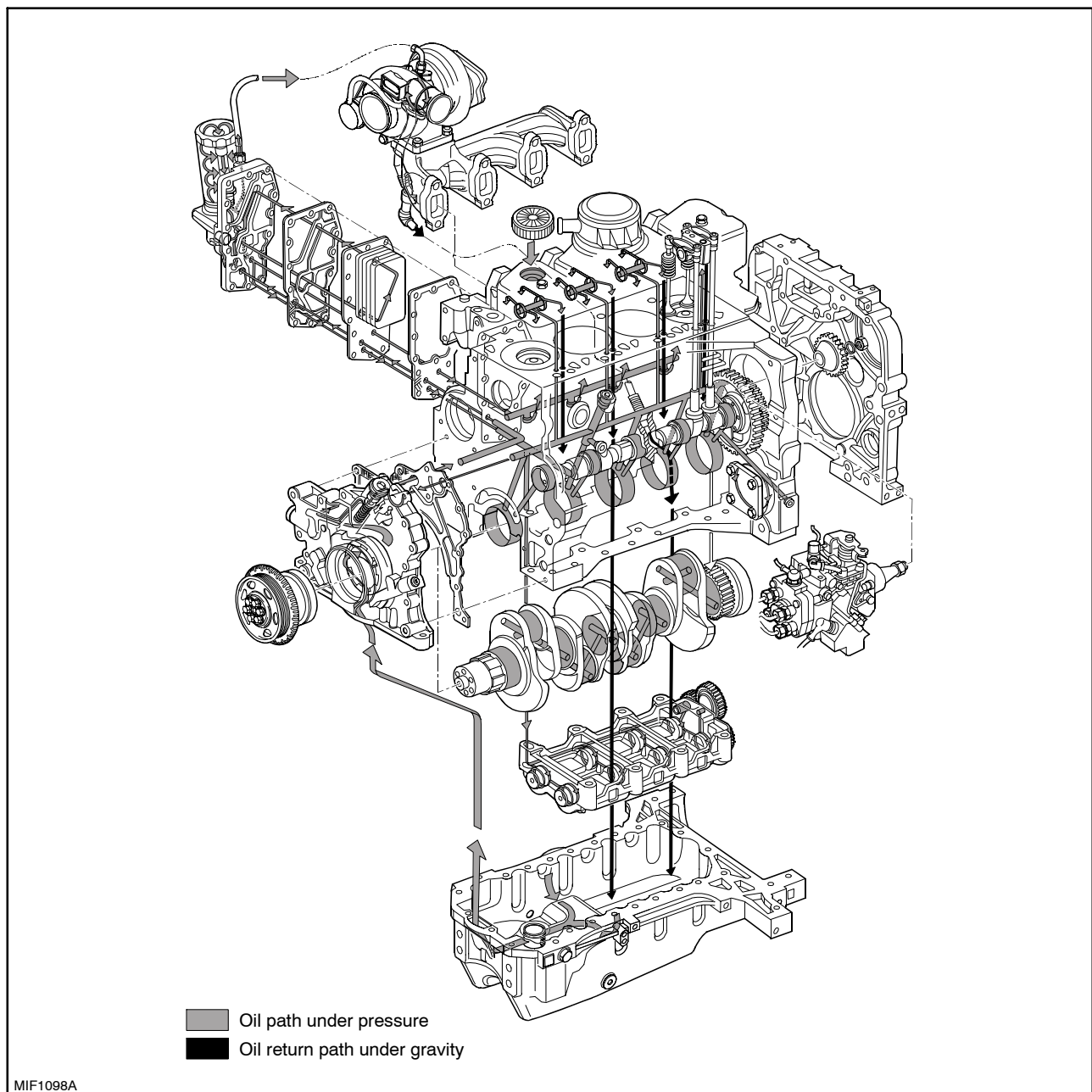

3

Lubrication diagram for engines mod. JX1090U and JX1100U

The pressurized lubrication system contains the following components:

- oil pump, housed at the front of the crankcase, driven by the grooved bushing keyed onto the shank of the crankshaft;
- water / oil cooler, housed in the crankcase;
- pressure regulator incorporated in the cooler assembly;
- by-pass valve to cut off clogged oil filter, incorporated in the cooler assembly;
- cartridge oil filter.

NOTE: Engines on JX1080U models are naturally aspirated, therefore will not contain a turbocharger lubrication circuit.

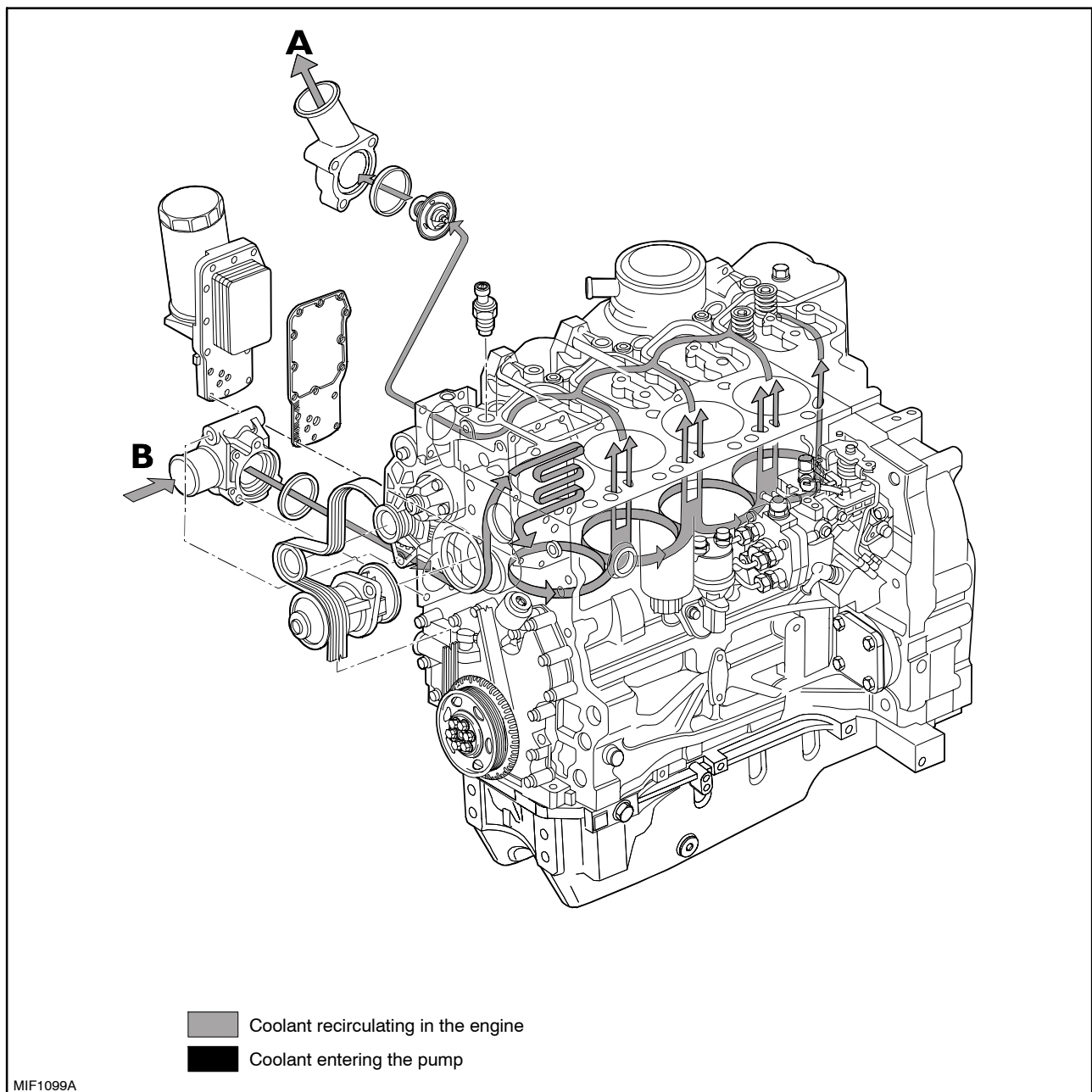

Cooling system diagram

The pressurized, closed-circuit engine cooling system contains the following components:

- lubricating oil cooler;
- centrifugal coolant pump housed at the front of the crankcase;
- thermostat valve to govern coolant circulation.

Thank you so much for reading.
Please click the “Buy Now!”
button below to download the
complete manual.



After you pay.

You can download the most
perfect and complete manual in
the world immediately.

Our support email:

ebooklibonline@outlook.com