MXU VALUE AND LIMITED SERIES 100, 110, 115, 125, 130, 135, AND MAXXUM VALUE AND PRO SERIES 110, 115, 120, 125, 130, AND 140

| | |
|---|-----------|
| SECTION 00 - GENERAL | 3 |
| SECTION 01 - SEPARATING THE TRACTOR | 3 |
| SECTION 10 - ENGINE | 7 |
| SECTION 18 - CLUTCH | 19 |
| SECTION 21 - TRANSMISSION SYSTEMS | 20 |
| SECTION 23 - DRIVE LINES | 28 |
| SECTION 25 - MECHANICAL FRONT AXLE | 29 |
| SECTION 27 - MECHANICAL REAR WHEEL DRIVE | 33 |
| SECTION 31 - POWER TAKE-OFF | 35 |
| SECTION 33 - BRAKING SYSTEM | 37 |
| SECTION 35 - HYDRAULIC SYSTEMS | 41 |
| SECTION 41 - STEERING | 65 |
| SECTION 44 - FRONT AXLE AND WHEELS | 68 |
| SECTION 50 - AUXILIARY UNITS | 69 |
| SECTION 55 - ELECTRICAL SYSTEM | 72 |

The following pages are the collation of the contents pages from each section and chapter of the MXU Series and Maxxum Series Repair manual. Complete Repair part # 87659930.

The sections used through out all Case IH product Repair manuals may not be used for each product. Each Repair manual will be made up of one or several books. Each book will be labeled as to which sections are in the overall Repair manual and which sections are in each book.

The sections listed above are the sections utilized for the MXU Series and Maxxum Series Tractors.

TIGHTENING TORQUES

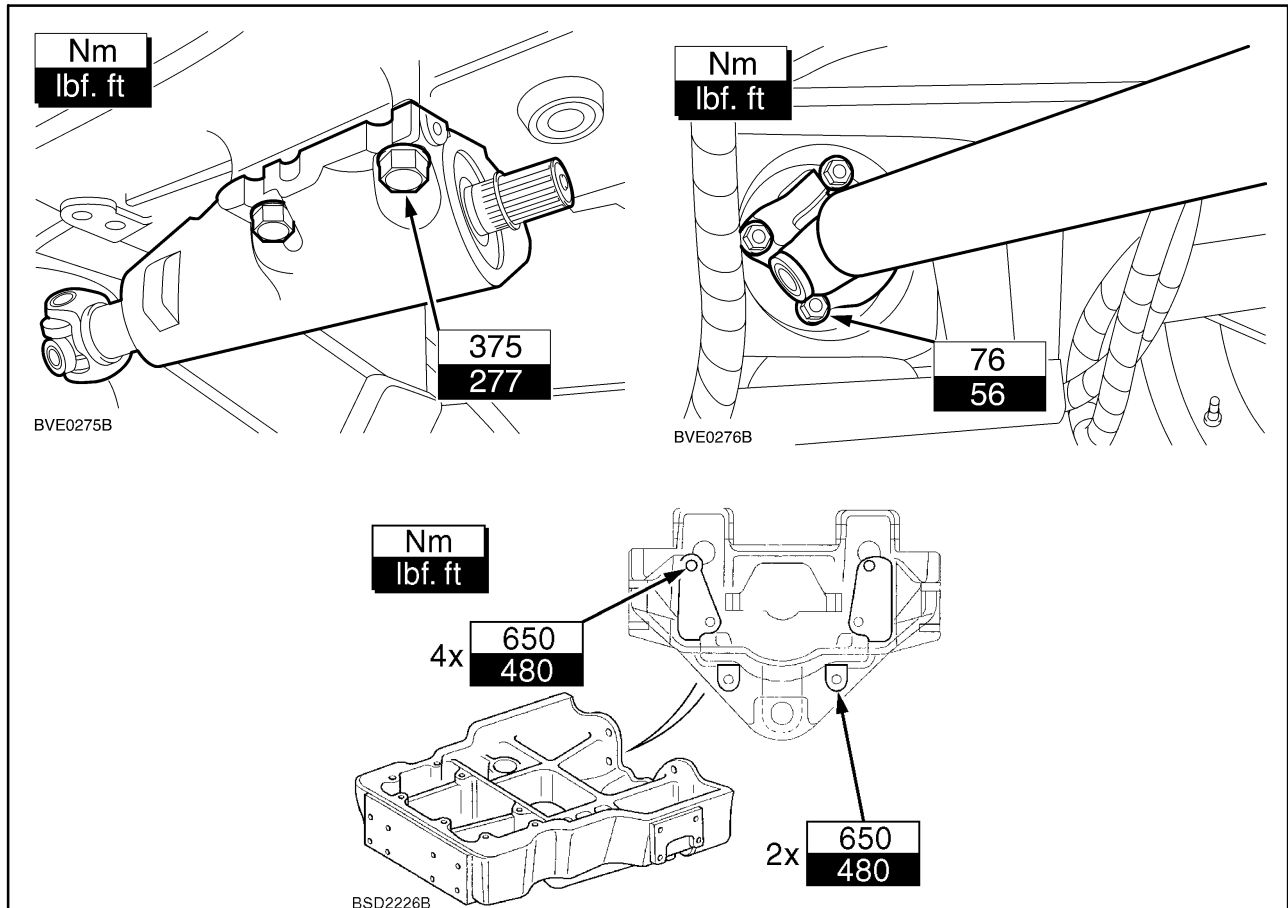

1

SPECIAL TOOLS

— **! CAUTION !** —

The operations described in this section can only be carried out with the **ESSENTIAL** tools indicated by an (X). To work safely and efficiently and obtain the best results, it is also necessary to use the recommended specific tools listed below and certain other tools, which are to be made according to the drawings included in this manual.

List of specific tools required for the various operations described in this section.

380000569 Tractor splitting kit.

380000500 Engine support brackets (with **380000569**).

380000844 Engine support adaptor plate (with **380000500**).

OVERHAUL

SEPARATING FRONT AXLE AND FRONT SUPPORT FROM THE ENGINE

Op. 10 001

Removal

Lift and handle all heavy components using lifting equipment of appropriate lifting capacity. Ensure that units or parts are supported by suitable slings or hooks. Ensure that no-one is in the vicinity of the load to be lifted.

1. Drain the cooling system (refer to cooling system drain in the cooling chapter of the engine section).
2. Remove the battery cover and disconnect the battery negative cable (1).

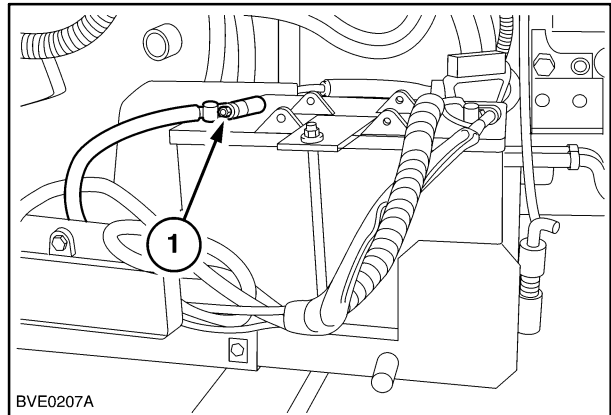

2

3. Using a suitable sling, connect the front weights to a hoist and remove the front weights (if fitted).

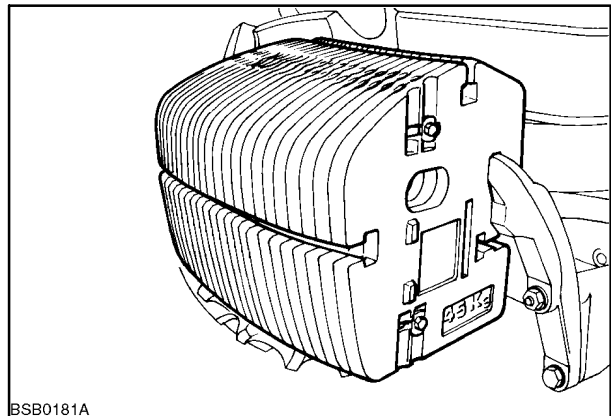

3

4. Loosen the hose clamps (1), remove the pipe clamp retaining bolt (2) and remove the air cooler outlet pipe.

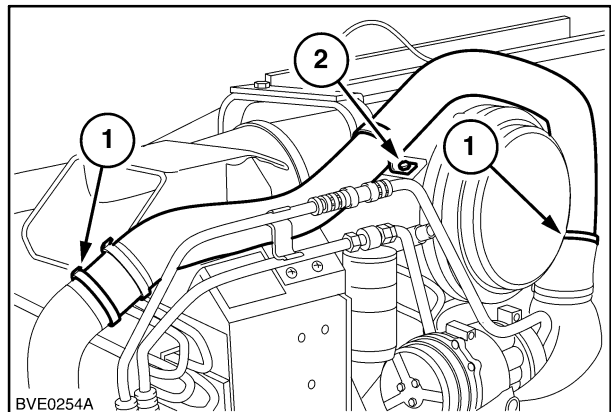

4

5. Loosen the pipe clamp (1), hose clamp (2) and remove the air cooler inlet pipe.

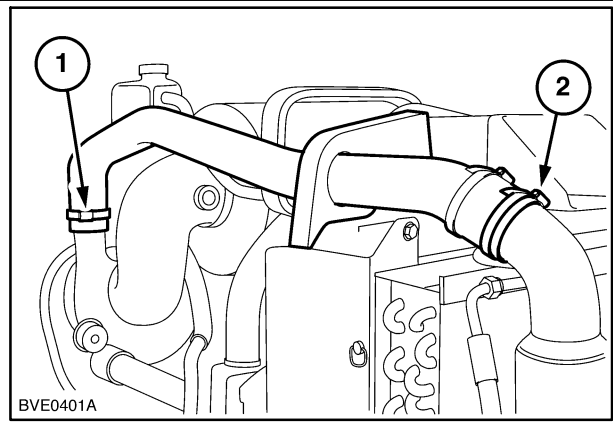

5

6. Loosen the clamp (1) and remove the air cleaner inlet.

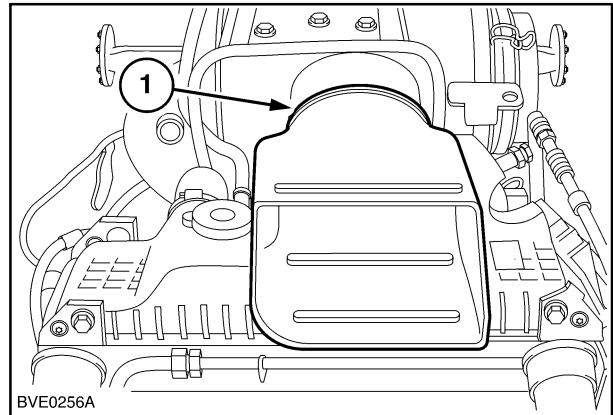

6

Tractors with Air Conditioning

7. Remove the receiver dryer retaining screws from the retaining bracket.

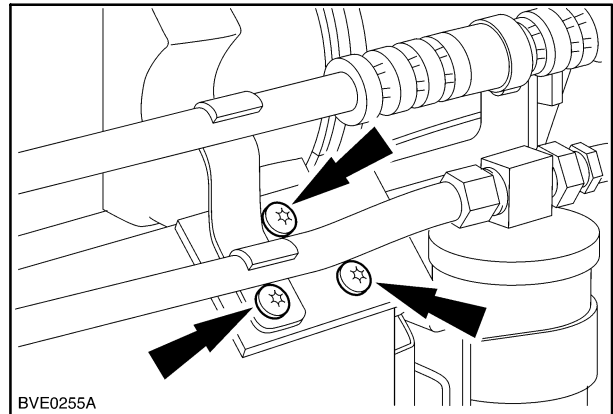

7

8. Slide out the air conditioning condenser from the radiator and reposition with the hoses still attached.

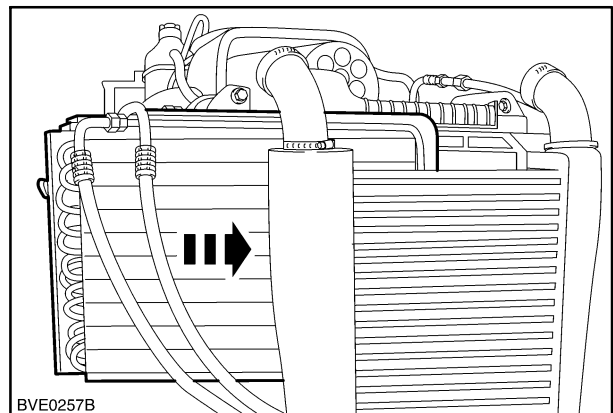

8

All Tractors

9. Loosen the hose clamps (1) and disconnect the coolant hoses from the radiator.
10. Remove the radiator support (2).

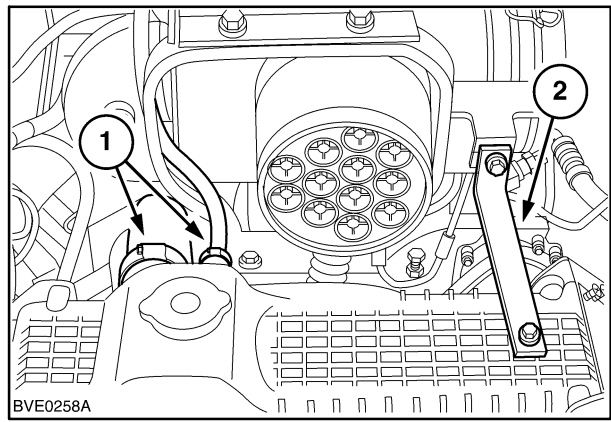

9

11. Loosen the hose clamp (1) and disconnect the coolant hose.

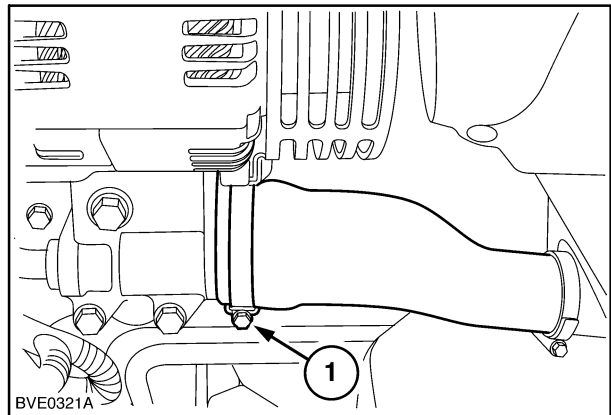

10

12. Loosen the coolant hose clamp (1) and disconnect the coolant hose connecting the cab heater to the radiator.

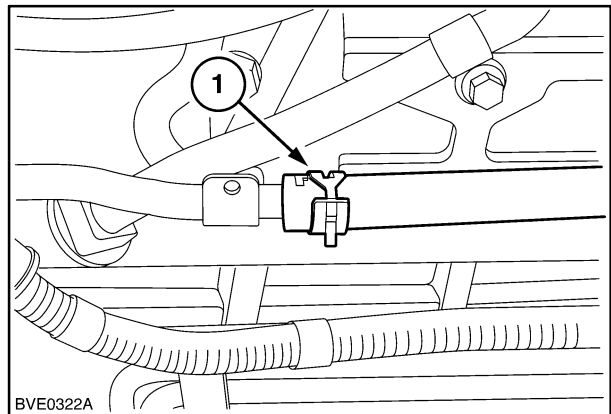

11

13. Disconnect the steering sensor electrical connector (if fitted).

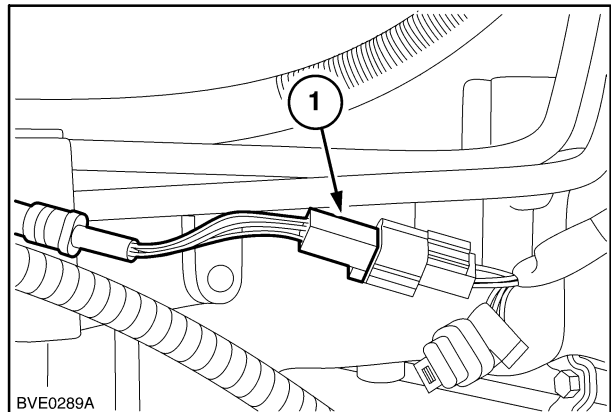

12

14. Detach the driveline oil cooler supply and return pipes from the retaining clamps.

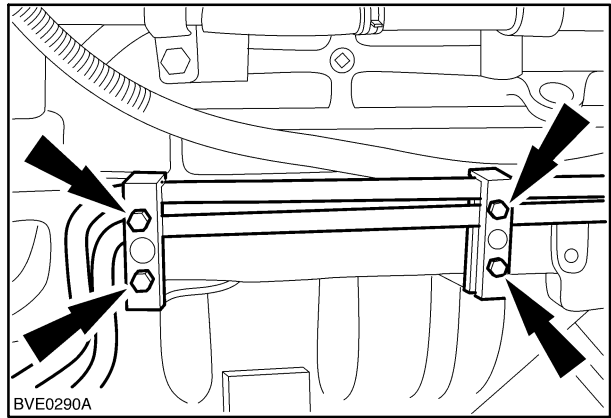

13

15. Disconnect the steering cylinder supply and return pipes (1).
16. Disconnect the differential lock oil supply pipe (2) (if fitted).

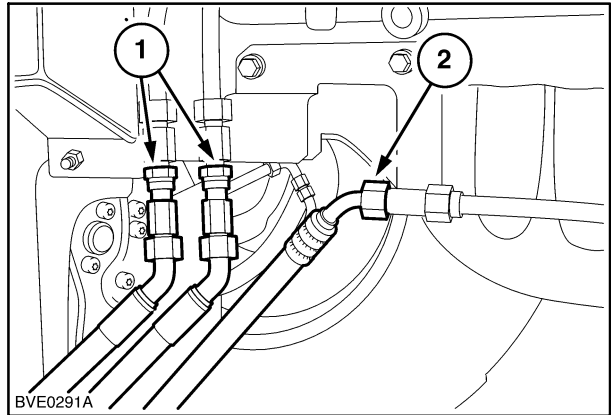

14

Tractors with Standard Front Axle

17. Remove the four wheel driveshaft guard.
18. Expand the circlip (1) and slide the circlip (1) and sleeve (2) along the four wheel drive shaft.

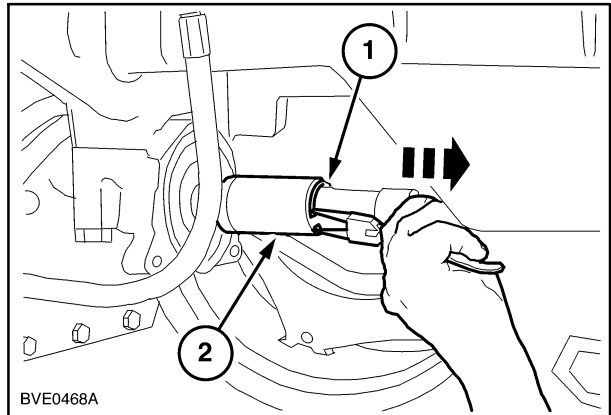

15

19. Remove the four wheel driveshaft and the central support.

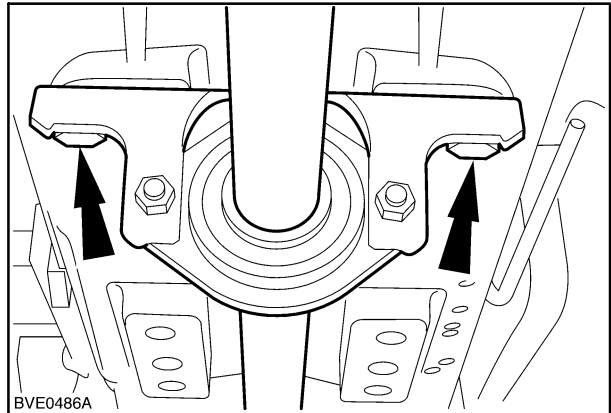

16

All Tractors

20. Position the splitting kit (1) **380000569** beneath the tractor.
21. Use the supports (2), in the the splitting kit to support the engine on the splitting stand.

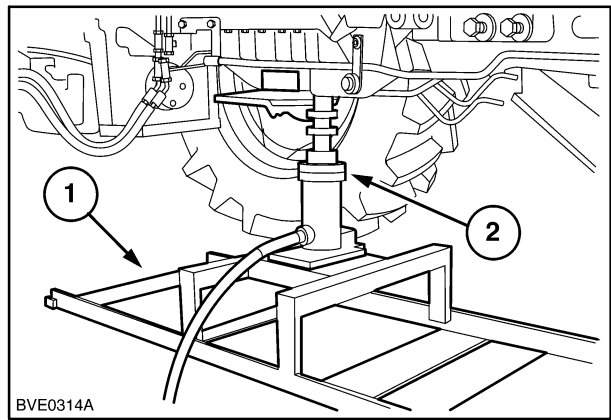

BVE0314A

17

22. Position wooden wedges (1) between the front axle and the front support. These prevent articulation of the axle.

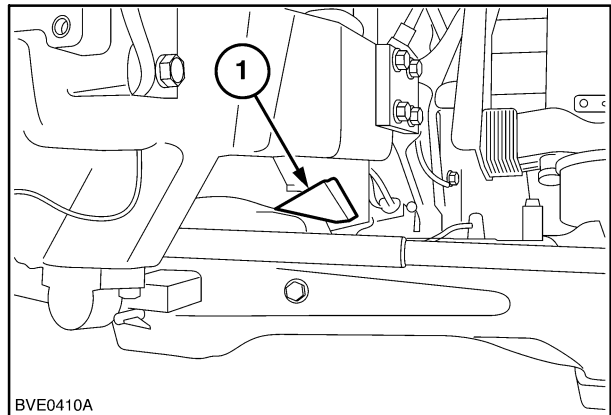

BVE0410A

18

23. Using a spreader bar and suitable chains or slings, attach the front and rear of the support assembly to a moveable overhead hoist.



Always ensure the support is adequately supported and will remain stable when separated from the engine. Failure to provide adequate support may cause the assembly to be unstable with possible personal injury if the support tips forwards or backwards.

24. Remove the front support retaining bolts and separate the front support from the engine.

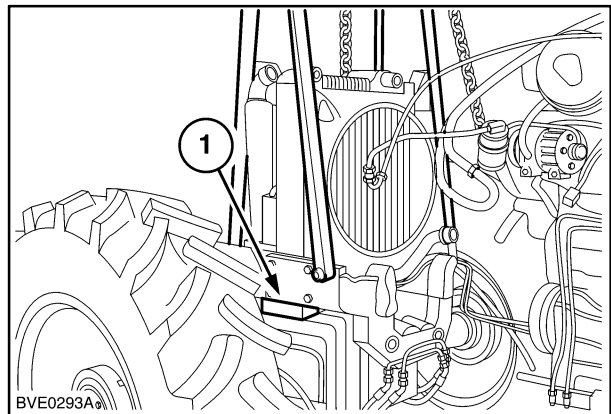

BVE0293A

19

25. Support the assembly on axle stands at the front and the rear of the support.

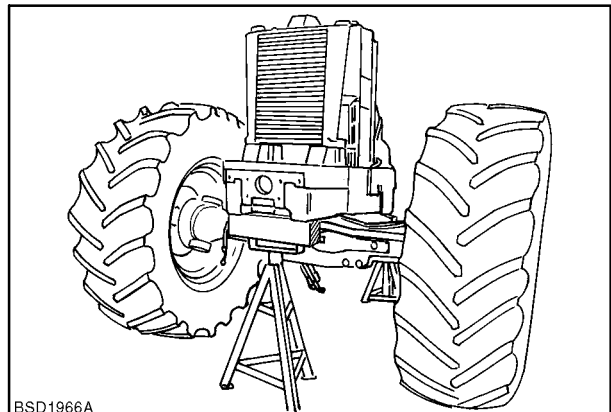

BSD1966A

20

Thank you so much for reading.
Please click the “Buy Now!”
button below to download the
complete manual.



After you pay.

You can download the most
perfect and complete manual in
the world immediately.

Our support email:

ebooklibonline@outlook.com