

Product: EXCAVATOR

Model: 312E L EXCAVATOR MJD

Configuration: 312E L Excavator MJD00001-UP (MACHINE) POWERED BY C4.4 Engine

Disassembly and Assembly C4.4 Engines for Caterpillar Built Machines

Media Number -UENR0602-11

Publication Date -01/08/2013

Date Updated -25/10/2017

i05000621

Engine Oil Pan - Remove and Install - Cast Iron Oil Pan

SMCS - 1302-010

Removal Procedure

Table 1

Required Tools			
Tool	Part Number	Part Description	Qty
A	-	Strap Wrench	1

NOTICE

Keep all parts clean from contaminants.

Contaminants may cause rapid wear and shortened component life.

NOTICE

Care must be taken to ensure that fluids are contained during performance of inspection, maintenance, testing, adjusting and repair of the product. Be prepared to collect the fluid with suitable containers before opening any compartment or disassembling any component containing fluids.

Dispose of all fluids according to local regulations and mandates.

1. In order to remove a cast iron oil pan, the engine must be removed from the machine. The engine should be mounted in a suitable stand and placed in the inverted position.

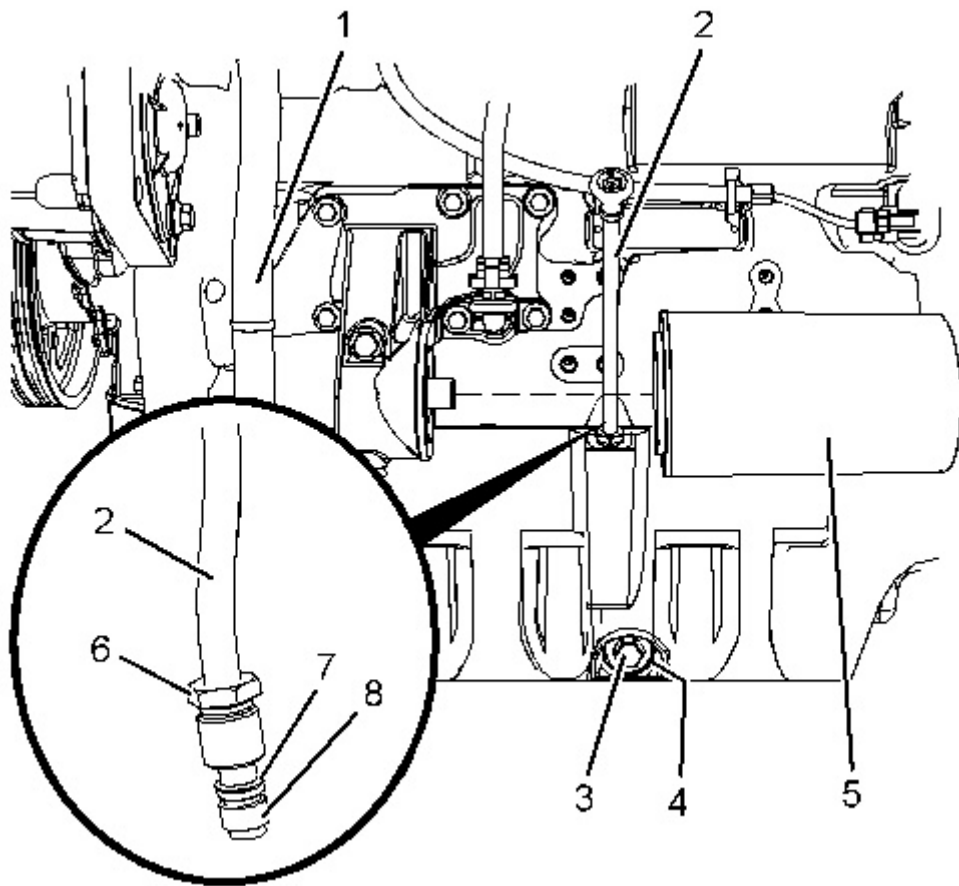

Illustration 1

g02475578

2. Use Tooling (A) in order to remove engine oil filter (5). Remove plug (3) and drain the engine lubricating oil. Remove O-ring seal (4) (not shown) from plug (3). Refer to Operation and Maintenance Manual, "Engine Oil and Filter - Change" for correct procedure.
 3. Remove breather hose (1) from the clip. Position the breather hose away from the engine oil pan.
 4. Loosen nut (6) and remove tube assembly (2). Remove O-ring seal (7) and seal (8) from the tube assembly.
-

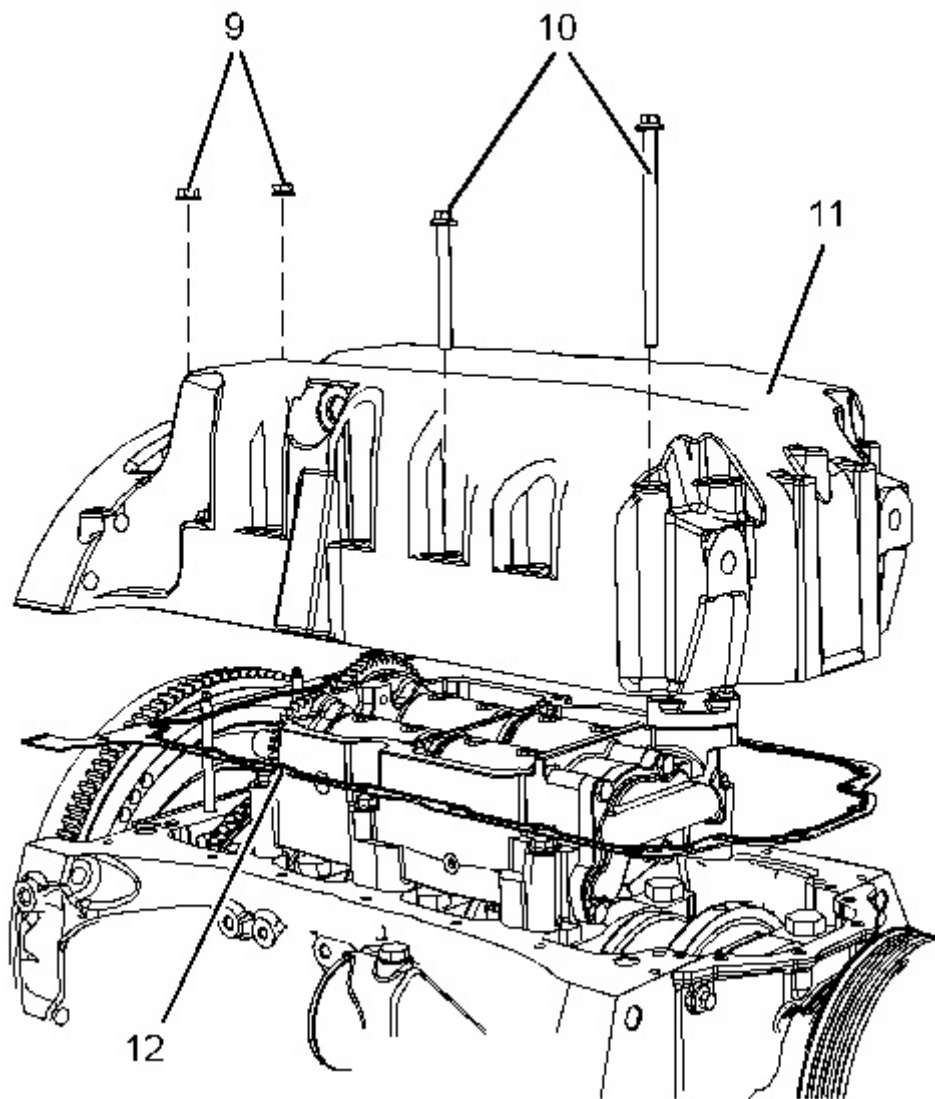

Illustration 2

g02475581

5. Remove nuts (9) and bolts (10) from engine oil pan (11).

Note: The bolts are different lengths. Note the position of the different bolts.

6. Attach a suitable lifting device to engine oil pan (11). Support the weight of the engine oil pan. The engine oil pan weighs approximately 41 kg (90 lb).
7. Use the lifting device to remove engine oil pan (11) from the cylinder block.
8. Remove gasket (12) from the cylinder block.

Installation Procedure

Table 2

Required Tools	

Tool	Part Number	Part Description	Qty
A	-	Loctite 5900	-
B	-	Loctite 243	-
C	-	Straight Edge	1

Note: In order to install a cast iron oil pan, the engine must be removed from the machine.

NOTICE

Keep all parts clean from contaminants.

Contaminants may cause rapid wear and shortened component life.

1. Ensure that the face of the cylinder block is clean and free from damage. Inspect the studs in the cylinder block for damage. If necessary, replace the studs.
2. Ensure that the engine oil pan is clean and free from damage.

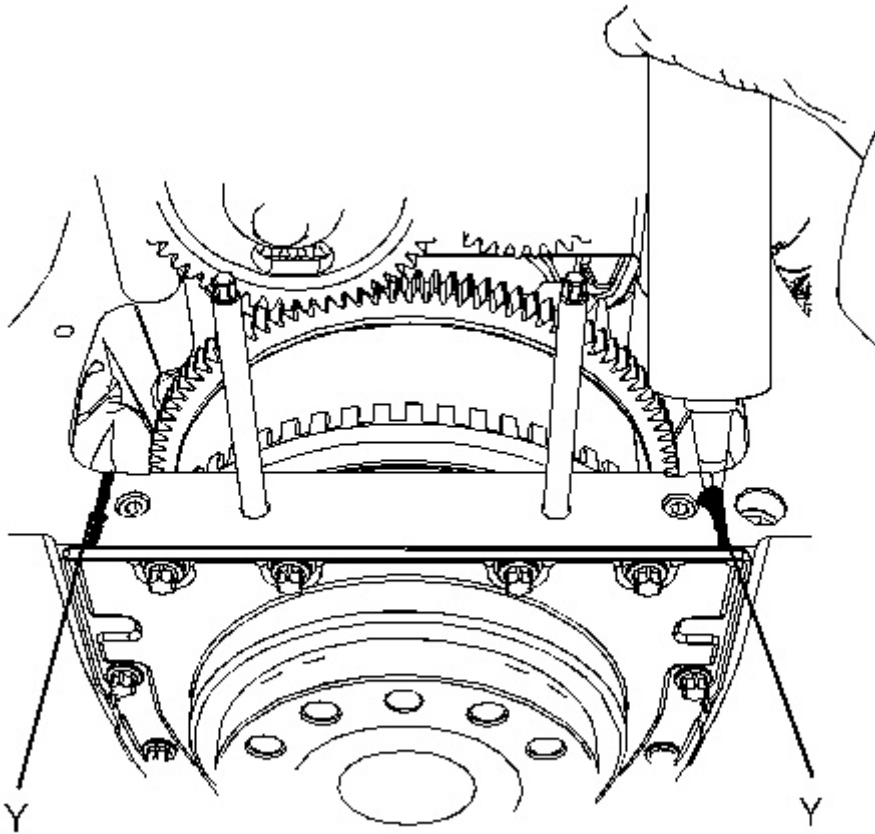

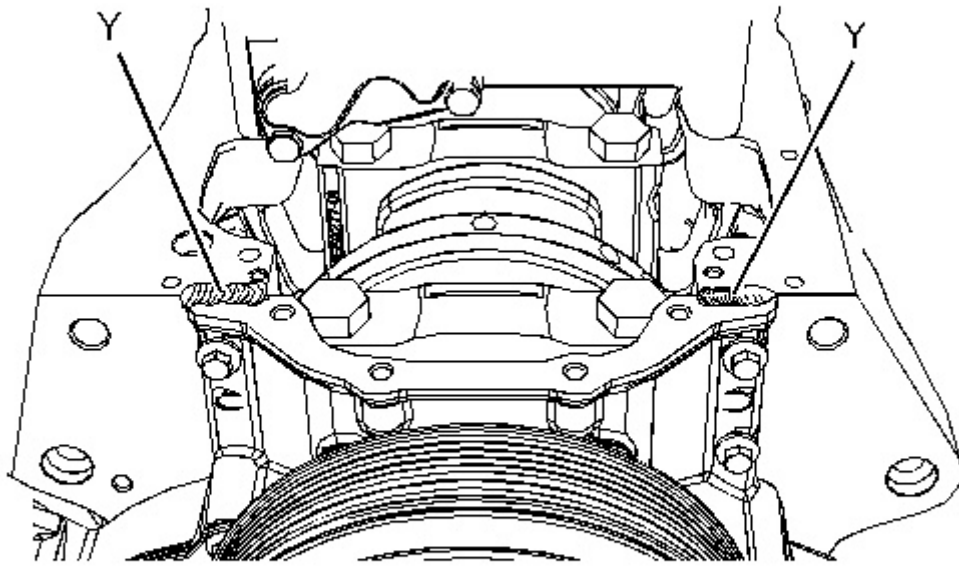

Illustration 4

g02475646

3. Apply a bead of Tooling (A) to Positions (Y) on the cylinder block.

Note: If the bridge piece for the cylinder block has just been installed, the engine oil pan must be installed before Tooling (A) has cured.

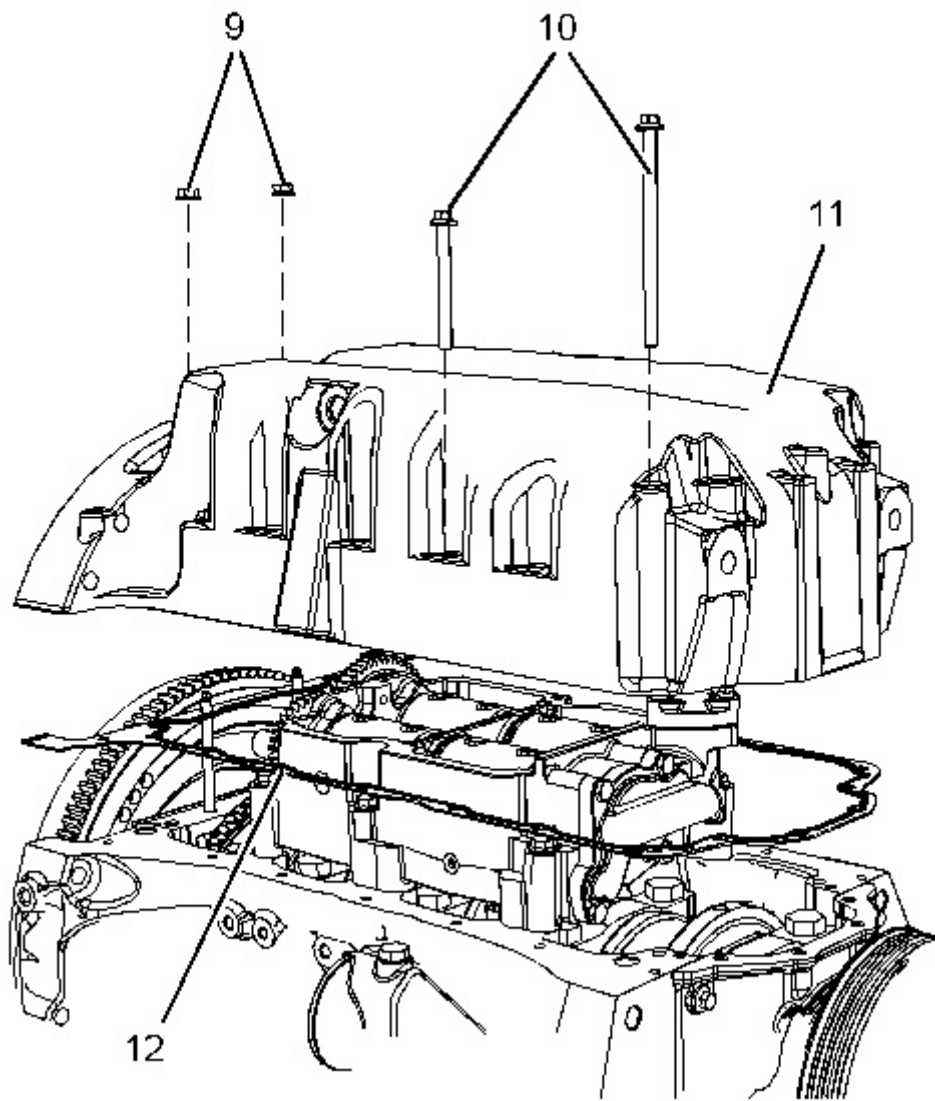

Illustration 5

g02475581

Thank you so much for reading.
Please click the “Buy Now!”
button below to download the
complete manual.



After you pay.

You can download the most
perfect and complete manual in
the world immediately.

Our support email:

ebooklibonline@outlook.com