

Model: 950L WHEEL LOADER LXX

Configuration: 950L Wheel Loader LXX00001-UP (MACHINE) POWERED BY C7.1 Engine

Disassembly and Assembly

C7.1 Engines

Media Number -UENR0633-19

Publication Date -01/07/2015

Date Updated -29/10/2018

i06826872

Fuel Injection Pump - Install

SMCS - 1251-012

Installation Procedure

Table 1

Required Tools			
Tool	Part Number	Part Description	Qty
A ⁽¹⁾	9U-6198	Crankshaft Turning Tool	1
A ⁽²⁾	9U-7336	Housing	1
	5P-7305	Engine Turning Tool	1
B	136-4632	Timing Pin (Crankshaft)	1
	268-1966	Adapter	1

⁽¹⁾ The Crankshaft Turning Tool is used on the front pulley.

⁽²⁾ This Tooling is used in the aperture for the electric starting motor.

Note: Either Tooling (A) can be used. Use the Tooling that is most suitable.

NOTICE

Ensure that all adjustments and repairs that are carried out to the fuel system are performed by authorized personnel that have the correct training.

Before beginning ANY work on the fuel system, refer to Operation and Maintenance Manual, "General Hazard Information and High-Pressure Fuel Lines" for safety information.

Refer to System Operation, Testing and Adjusting, "Cleanliness of Fuel System Components" for detailed information on the standards of cleanliness that must be observed during ALL work on the fuel system.

NOTICE

Ensure that wiring harness are correctly routed and the cable straps are not over tightened. Over tightening of the cable straps will damage the wiring harness convoluting.

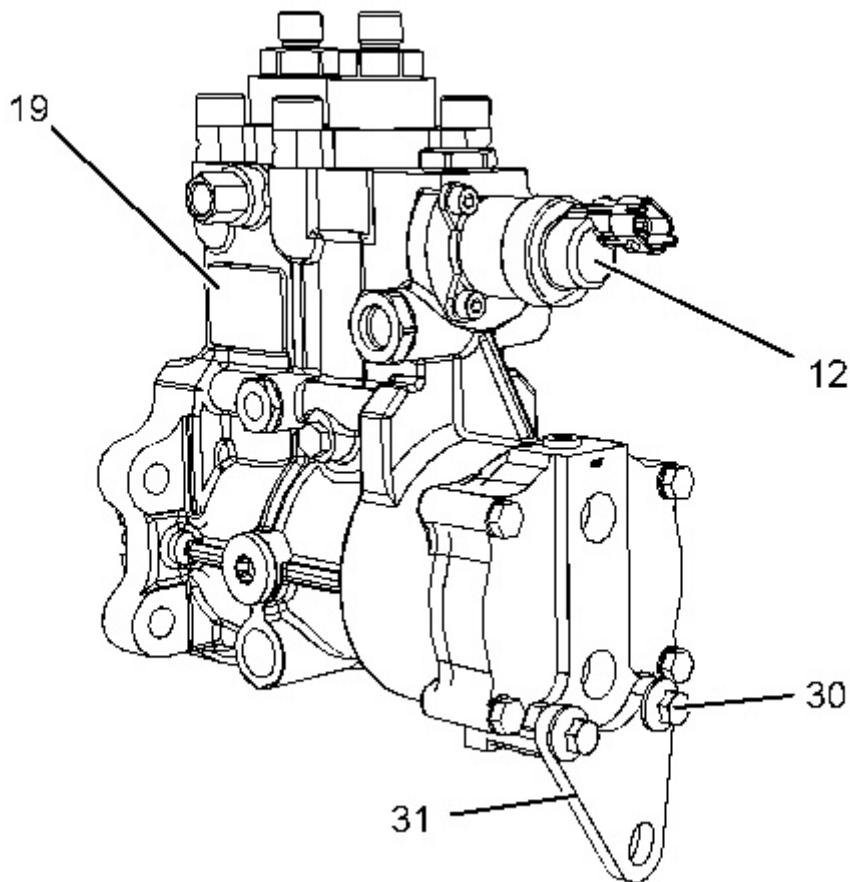

Illustration 1

g06132053

1. If necessary, follow Step 1.a through Step 1.d to install bracket (31) to fuel injection pump (19).
 - a. Position fuel injection pump (19) in a suitable stand.
 - b. Position bracket (31) onto fuel injection pump (19). Ensure that the bracket is correctly orientated.

- c. Install bolts (30) hand tight.
 - d. Tighten bolts (30) to a torque of 22 N·m (195 lb in).
2. If necessary, install flow control valve (12). Refer to Disassembly and Assembly, "Flow Control Valve - Remove and Install" for the correct procedure.
-

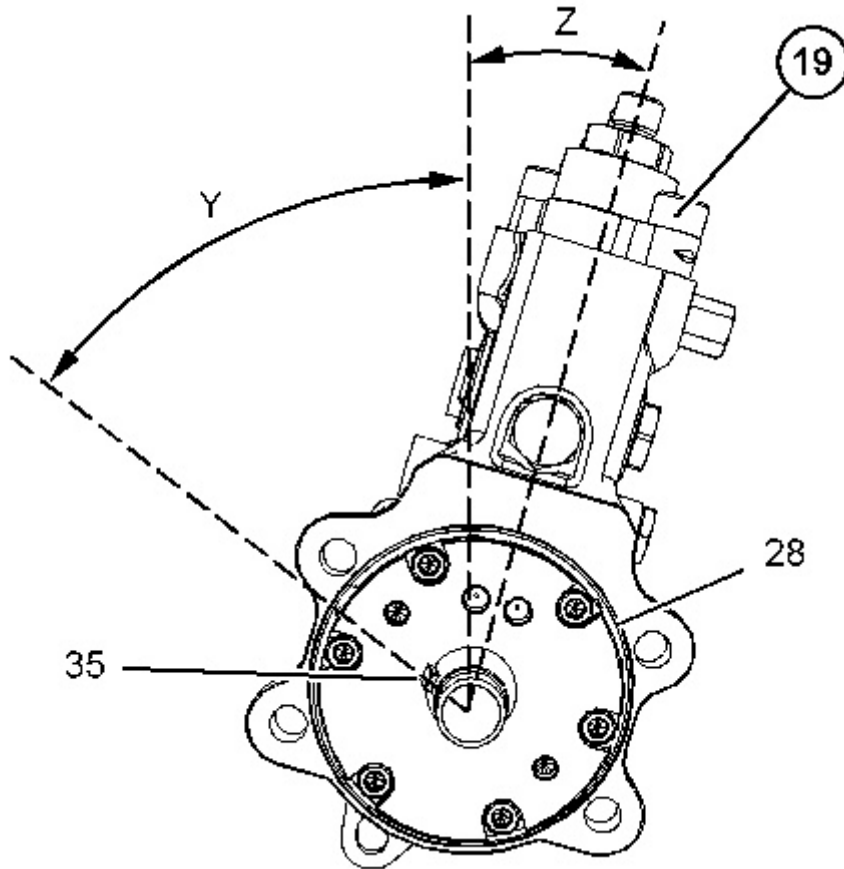

Illustration 2

g06136408

The Angle (Y) should be 43 degrees. The Angle (Z) should be 18 degrees

3. Position key (35) on the shaft on fuel injection pump (19) in the position as shown in Illustration 2
 4. Install a new O-ring seal (28) to fuel injection pump (19). Ensure that the O-ring seal is correctly installed to the groove in the fuel injection pump.
-

Thank you so much for reading.
Please click the “Buy Now!”
button below to download the
complete manual.



After you pay.

You can download the most
perfect and complete manual in
the world immediately.

Our support email:

ebooklibonline@outlook.com