

Product: TRACK LOADER

Model: 955K TRACK LOADER 71J

Configuration: 955L TRACK TYPE LOADER 71J04558-UP (MACHINE) POWERED BY 3304 ENGINE

## Disassembly and Assembly 955K TRACK-TYPE LOADER POWER TRAIN

Media Number -REG00861-00

Publication Date -01/11/1993

Date Updated -10/10/2001

### Bevel Pinion

## Transmission Mounting Adapter Removal And Installation

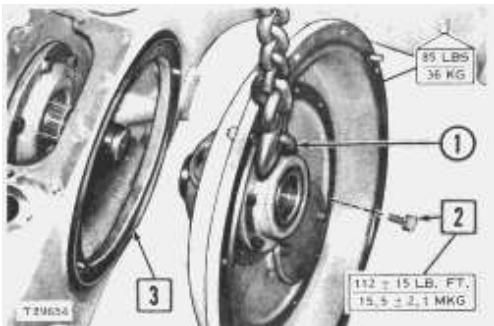

1-Forged eyebolt (1/2"-13 NC) and nut. Install eyebolt and nut and attach a hoist. 2-Bolts (eleven). 3-Seal.

## Transmission Mounting Adapter Disassembly

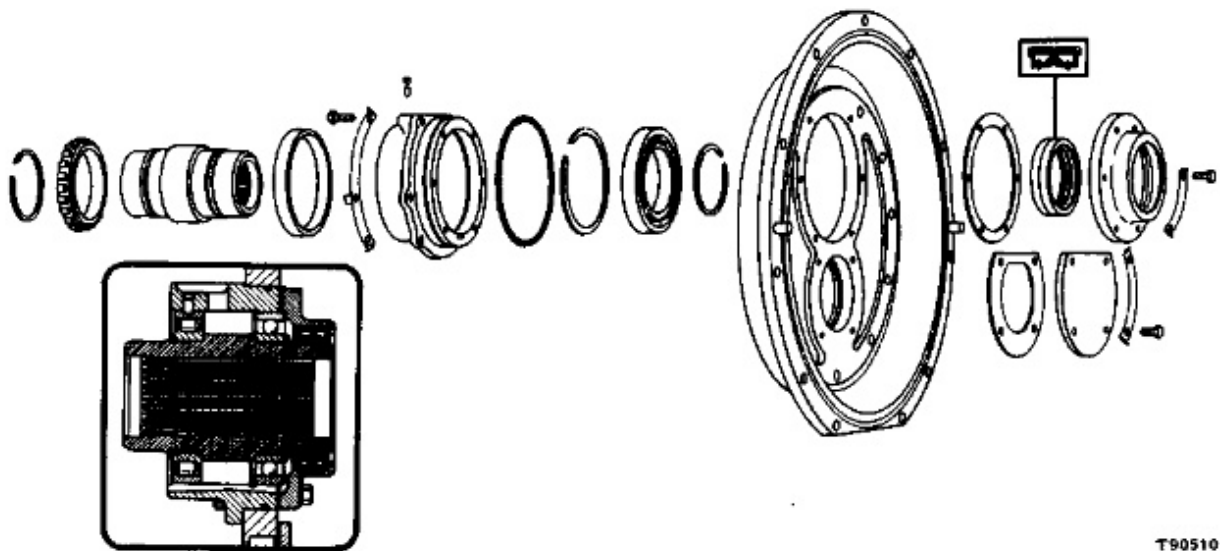

T90510

## Bevel Pinion, Bearing Cage And Pinion Locating Shims Removal And Installation



1-Bolts (four). 2-Bevel pinion bearing cage and bevel pinion. 3-Bevel pinion locating shims.

**NOTE:** If the bevel gear location is changed or if a new bearing cage or pinion is installed, the pinion location must be checked. See BEVEL GEAR AND PINION SETTING.

## Bevel Pinion And Bearing Disassembly

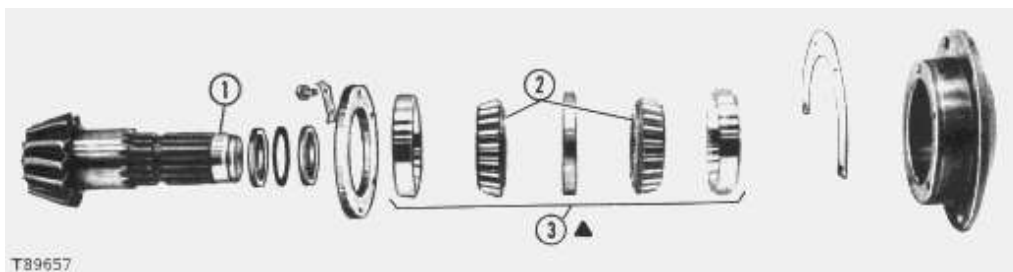

1 Press spacer onto bevel pinion shaft before installing shaft.

2 Use an arbor press to remove bearing cones.

3 For correct installation see the GENERAL INSTRUCTIONS under BEARINGS - DOUBLE ROW, TAPERED ROLLER.

---

Thank you so much for reading.  
Please click the “Buy Now!”  
button below to download the  
complete manual.



After you pay.

You can download the most  
perfect and complete manual in  
the world immediately.

Our support email:

[ebooklibonline@outlook.com](mailto:ebooklibonline@outlook.com)