HW305, HW305S, HW325 REPAIR MANUAL COMPLETE CONTENTS

SECTION 00 - GENERAL INFORMATION	2
SECTION 10 - ENGINE	3
SECTION 25 - FRONT MECHANICAL DRIVE	11
SECTION 29 - HYDROSTATIC TRANSMISSION	12
SECTION 33 - BRAKES AND CONTROLS	16
SECTION 35 - HYDRAULIC SYSTEMS	17
SECTION 44 - REAR AXLE	22
SECTION 50 - CLIMATE CONTROL	24
SECTION 55 - ELECTRICAL SYSTEMS	30
SECTION 58 - HEADER ATTACHMENTS	51
SECTION 88 - OPTIONAL EQUIPMENT	56
SECTION 90 - PLATFORM, CAB AND DECALS	60

The following pages are the collation of the contents pages from each section and chapter of the HW305, HW305S and HW325 Repair manual. Complete Repair part # 87576230.

The sections used through out all New Holland product Repair manuals may not be used for each product. Each Repair manual will be made up of one or several books. Each book will be labeled as to which sections are in the overall Repair manual and which sections are in each book.

The sections listed above are the sections utilized for the HW305, HW305S and HW325 Self-Propelled Windrowers.

ENGINE OVERHAUL INTRODUCTION

This engine overhaul procedure will describe how to repair the engine. It is up to the mechanic to decide which sections are required for each particular problem. The following associated systems of the engine are located in different chapters:

Section 55, Chapter 5 – Engine Electrical System

Chapter 2 – Fuel and Injection System

Chapter 3 – Air Intake System

Chapter 4 – Engine Coolant System

The water pump is covered in this section.

Chapter 5 – Lubrication System

Most of the repair for these areas can be done with the engine mounted in the windrower.

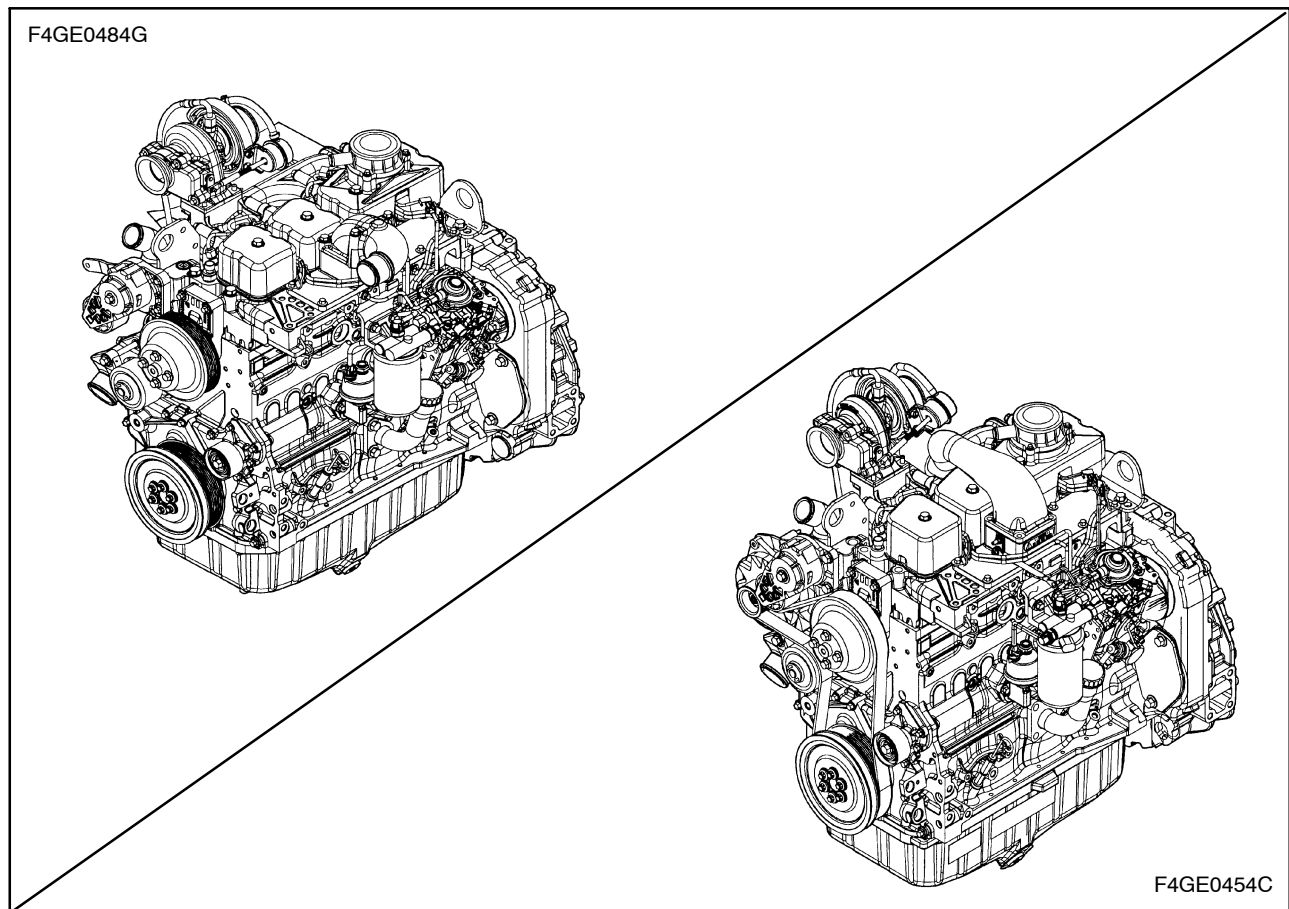

OVERHAUL

ENGINE

Removal

1. Drain coolant from radiator and engine by opening valve, 1. Catch fluid from drain hose and save for recycling. Remove the radiator cap to speed up the draining, using caution if the system is hot.

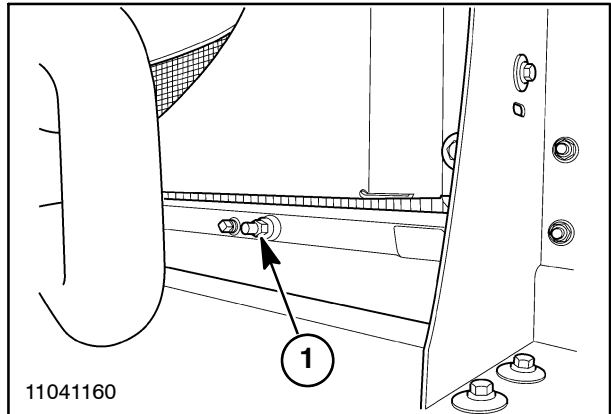

2

2. Remove battery ground cables by removing starter mounting bolt, 1.
3. Remove all positive power cables from starter terminal, 2.
4. Remove wire, 3, from starter terminal.
5. Open valve, 4, if closed, and allow any trapped coolant to drain. Loosen clamp, 5, and remove heater hose.

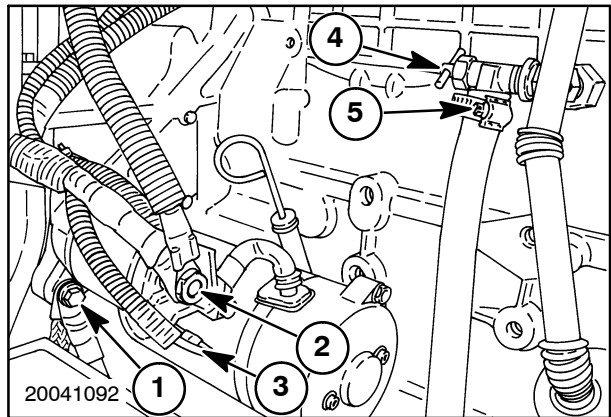

3

6. Loosen clamp, 1, and remove lower radiator hose. Also, in like manner, disconnect the upper hose.

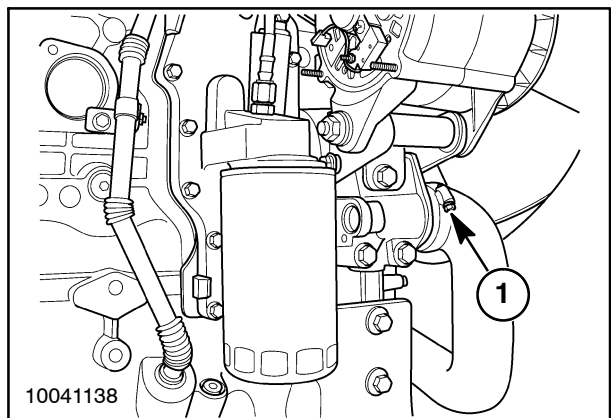

4

SECTION 10 - ENGINE - CHAPTER 1

7. Using a helper, detach four gas springs, 1, from engine area side doors by removing four flange nuts and lock washers.
8. Remove side doors by removing one bolt, 2, and loosening one, 3, at each of twelve pivot clips, 4.
9. Remove two carriage bolts, lock washers and flange nuts, 5, on each side of hood support frame.

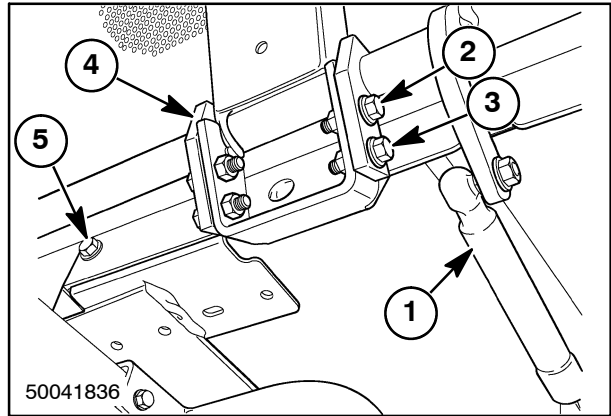

5

10. On HW305S and HW325, loosen spring clamps, 1, and remove tubing from turbo to intercooler, and from intercooler to intake manifold.
11. Loosen clamps and remove 102 mm (4") diameter tubing, 2, from air cleaner to rear bulkhead.

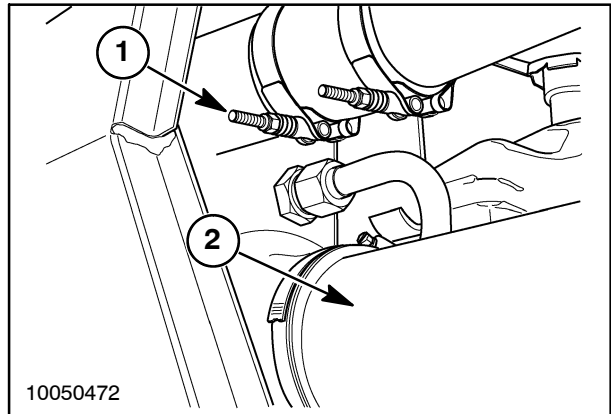

6

12. Remove nut and lock washer, 1, on ball joint at end of control cable.
13. Push off clip, 2, and remove fuel return hose with elbow attached. Likewise push off clip, 3, on fuel supply hose. Plug and bag the end of these hoses to keep out contamination.
14. Disconnect wire, 4, from fuel injection pump.

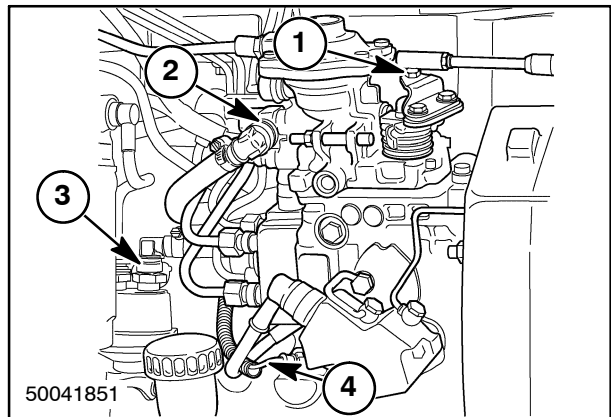

7

15. Loosen pipe clamp, 1, and remove exhaust stack, 2.
16. Disconnect restriction indicator wire, 3.
17. Loosen clamp, 4, and remove hose from air cleaner.
18. Loosen clamp and remove air cleaner evacuator hose at muffler outlet, 5.
19. Remove one 5/16 in. bolt, 6.
20. Remove two M8 cap screws and lock washers, 7, and move air cleaner to one side with mounting bracket and cable still attached.

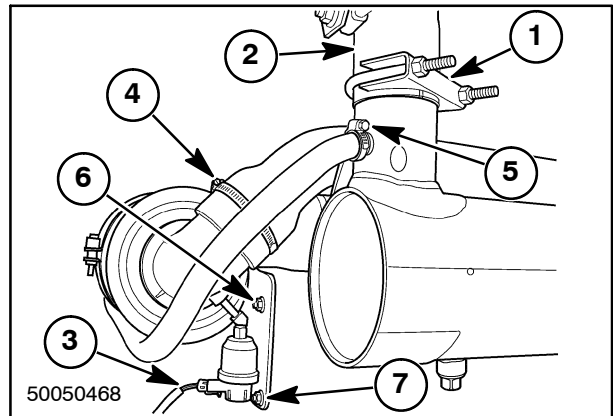

8

21. Remove four flange bolts, lock washers and flange nuts, 1, to detach hood support frame from radiator side supports. Frame can now be removed with roof panel attached.

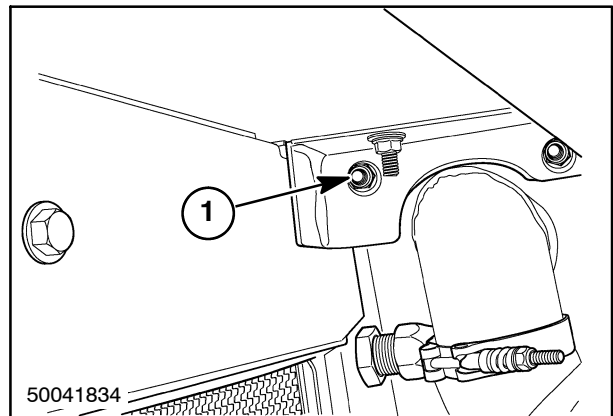

9

22. Disconnect wire harness at both sides of intake air heater, 1, if so equipped, and at oil pressure switch, 2.

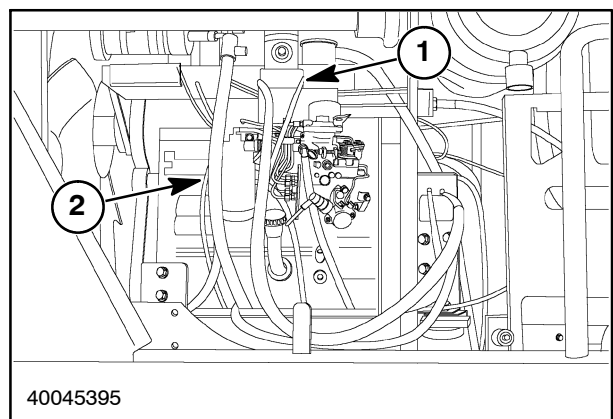

10

23. Disconnect wire connector, 1, and wire at temperature sensor, 2.
24. On models HW305 & HW305S, remove two bolts, 3, from feet of compressor, and long pivot bolt, 4, remove drive belt and lay compressor over to right side of machine with hoses connected.

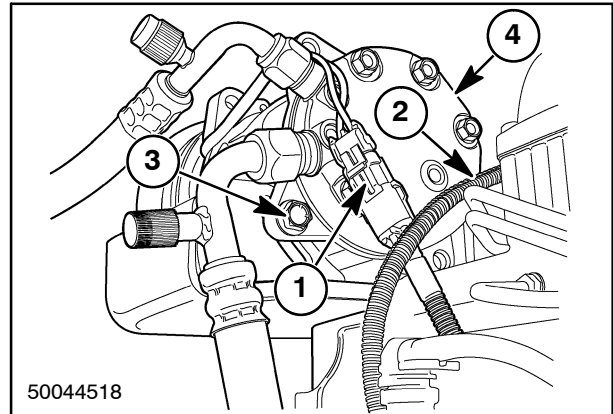

11

25. On model HW325, remove two 5/16 X 3-3/4" cap screws with lock washers and flange nuts, 1, from lower holes in compressor and through lower mount casting.
26. Remove one 3/8 X 5" long pivot bolt with lock washer and lock nut, 2, remove drive belt and lay compressor over to right side of machine with hoses connected.

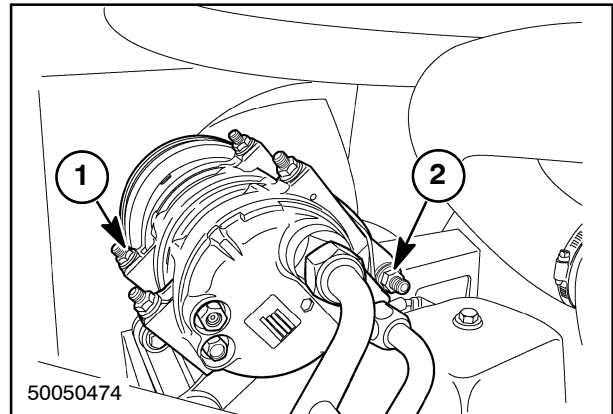

12

27. If equipped with auxiliary pump, remove two hex head flange bolts and lock washers, 1, to remove pump with PTO drive and hoses attached. Lay over to right side of windrower frame. Save gasket for re-use when reinstalling.

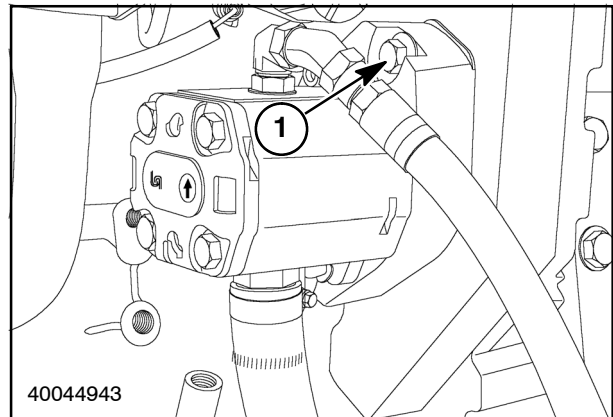

13

28. Remove four nuts and lock washers, 1, to remove rear cover, 2.

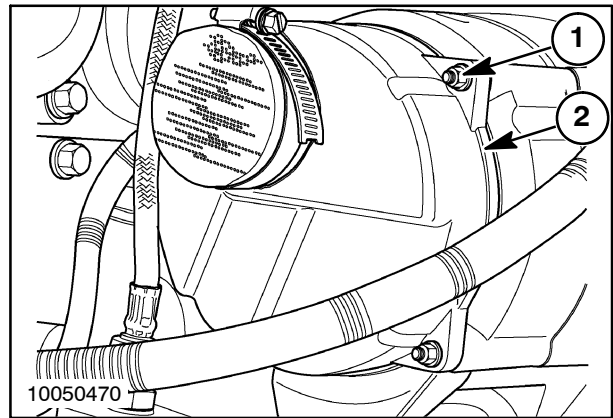

14

29. Disconnect cable, 1, and two wires of harness, 2, from alternator by removing three nuts. Screw these nuts on the terminals loosely to save for later use.
30. Remove and loosen clamps as necessary to free wiring harness and cables from engine.

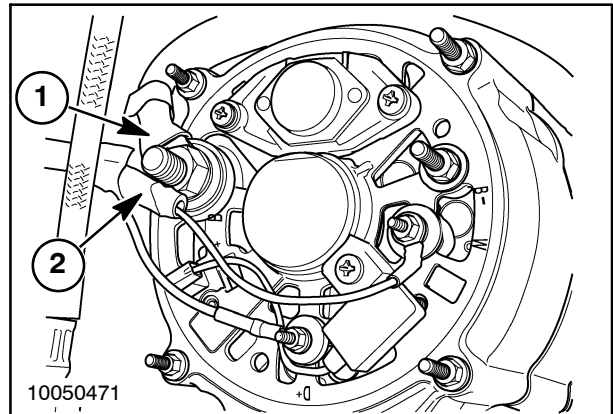

15

31. Remove plug, 1, to drain oil from gear box.
32. With adequate support provided for the pumps, remove twelve flange bolts, 2.

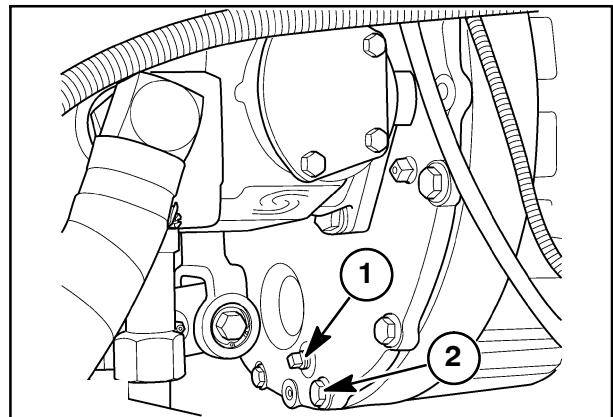

16

Thank you so much for reading.
Please click the “Buy Now!”
button below to download the
complete manual.



After you pay.

You can download the most
perfect and complete manual in
the world immediately.

Our support email:

ebooklibonline@outlook.com