

LEXION 780-620

Repair manual

Validity of manual

This manual applies to the following machine / front attachment:

Machine	Type	Vehicle identification number	
		From	To
LEXION 780	C79	C7900011	–
LEXION 760	C79	C7900011	–
LEXION 750	C78	C7800011	–
LEXION 740	C78	C7800011	–
LEXION 730 P	C78	C7800011	–
LEXION 730	C78	C7800011	–
LEXION 670	C77	C7700011	–
LEXION 780	C76	C7600011	–
LEXION 770	C76	C7600011	–
LEXION 770	C72	C7200011	–
LEXION 760	C75	C7500011	–
LEXION 750	C75	C7500011	–
LEXION 740	C75	C7500011	–
LEXION 760	C71	C7100011	–
LEXION 750	C71	C7100011	–
LEXION 670	C74	C7400011	–
LEXION 660	C74	C7400011	–
LEXION 650	C74	C7400011	–
LEXION 670	C70	C7000011	–
LEXION 630	C73	C7300011	–
LEXION 620	C73	C7300011	–



⌘

Use special tool (I).

Wheel bolt

- ▶ Coat spindle (1) and pin (2) of special tool (I) with Molykote G-n Plus.
- ▶ Pre-assemble special tool (I) as shown in the picture.
- ▶ Put adapter (3) of special tool (I) on the wheel bolt.

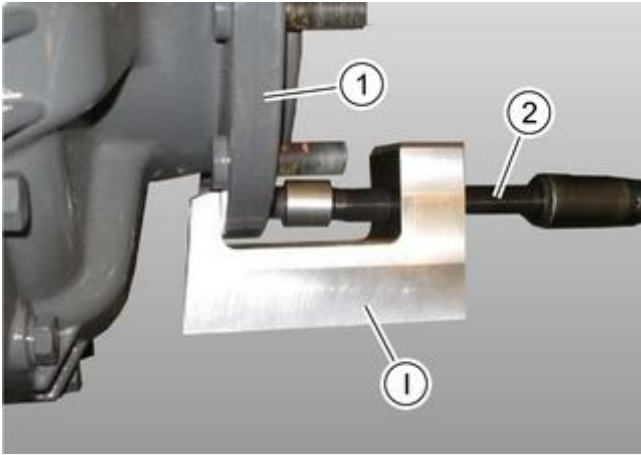

⌘

NOTICE!

High axial forces are involved.

Damage of hand tools and machine components.

- ▶ Install the special tool precisely without tilting.
- ▶ Actuate the special tool only with a hand tool.
- ▶ **Never** use an impact wrench!

Use special tool (I).

Wheel bolt

- ▶ Install special tool (I).
 - ▶ Turn the wheel shaft (1) to do this if necessary.
- ▶ Force out the wheel bolt by evenly rotating threaded spindle (2).

Installation

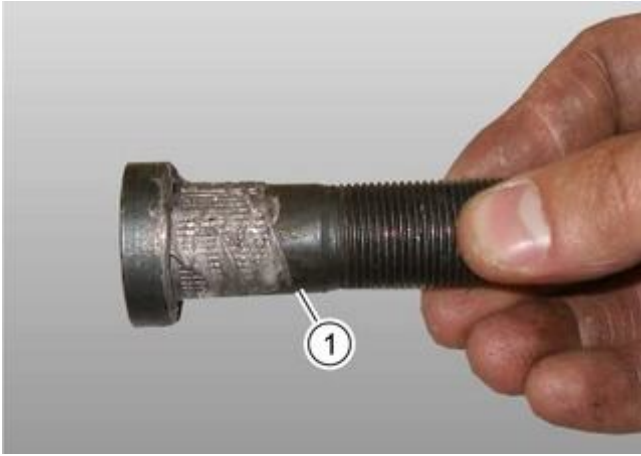

⌘

NOTICE!

Wheel bolts damaged by incorrect storage or rough treatment.

Damage of machine components.

- ▶ Check the wheel bolt threads and tothing prior to installation.
- ▶ Remove any existing burrs and rust.
- ▶ Use only flawless wheel bolts.

-
- ▶ Check wheel bolt (1) for damage and prepare them for installation.
 - ▶ Coat gearing of wheel bolts (1) with Anti-Seize.

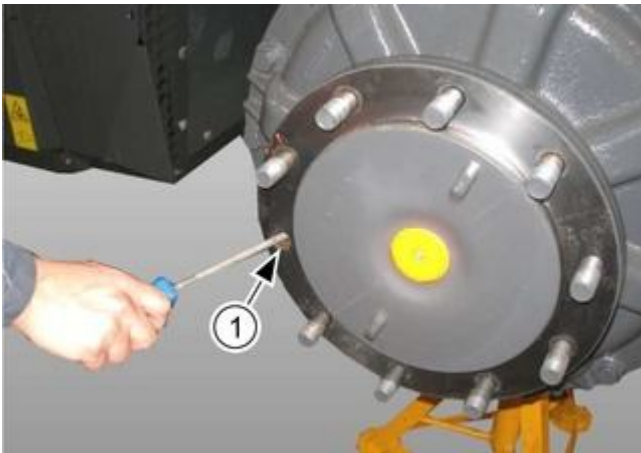

⌘

- ▶ Check the corresponding bore (1) for damage and prepare for installation.



p

- ▶ Insert wheel bolt (1).
- ▶ Ensure that the external tothing of the wheel bolt engages with the existing tothing of the bore.
- ▶ Turning the wheel bolt must no longer be possible.

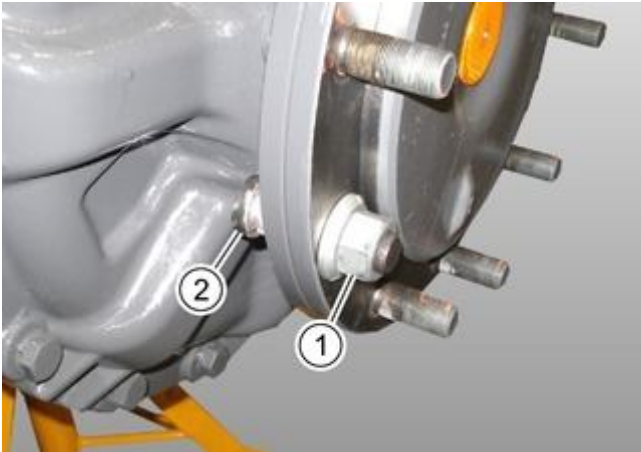

p

- ▶ Remove any grease from thread of wheel nut (1) and screw it on the wheel bolt (2).
- ▶ Pull wheel nut (1) forward until wheel bolt (2) starts being pulled into the drilled hole.
- ▶ In case of considerable stiffness, the tothing of the wheel bolt must be newly inserted.

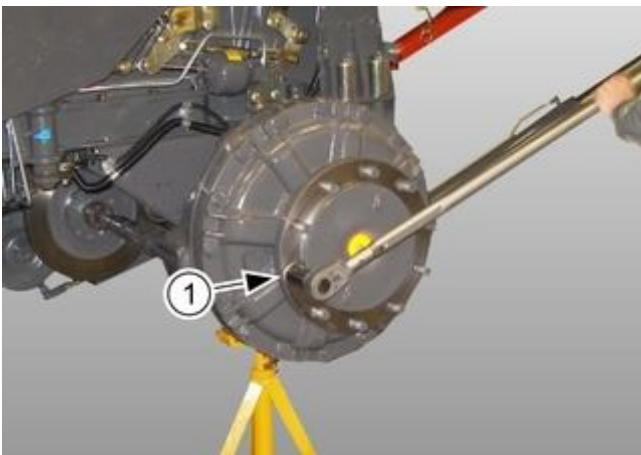

p

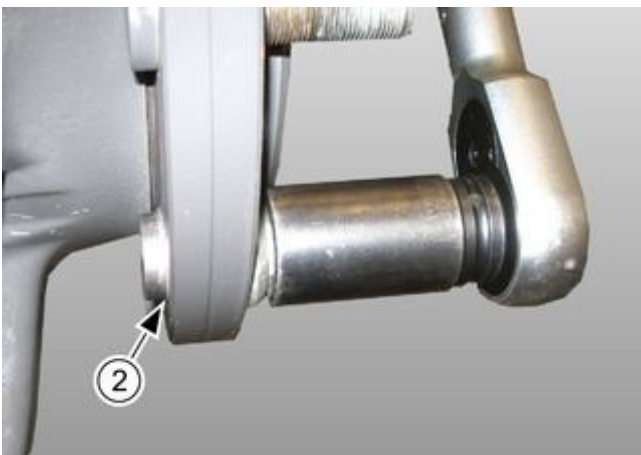

p

- ▶ Block the wheel shaft with the service brake.
- ▶ Pulling in the wheel bolt (1) in two steps:
 - ▶ Step 1: Pull the wheel bolts (1) evenly and smoothly into the drilled hole until collar (2) makes contact with the flange surface.

- ▶ Step 2: Re-tighten the wheel bolts (1).
See the Operator's Manual of the machine in question.

- ▶ Unscrew wheel nut.
- ▶ Check the thread of wheel nut and of wheel bolt.
- ▶ Check wheel bolt for elongation.

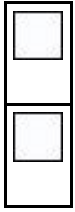

- Install the drive wheel.

- Check the function.

Operator's Manual

Identifying the drive axle

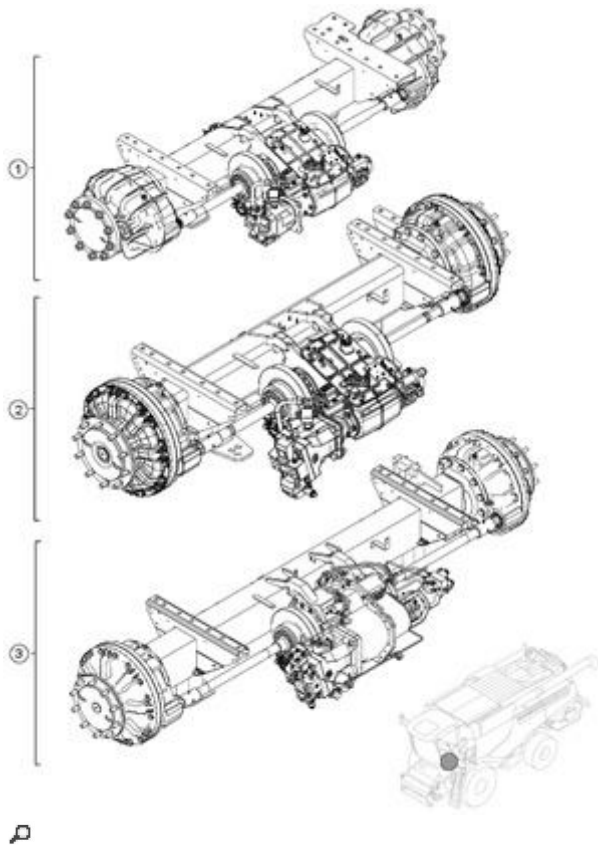

Technical specifications

	Value	CCN	Remark / designation	
Tightening torque values not specified, see "Introduction / Tightening torques" chapter				
1			Drive axle 00 1703 000 X	<u>Drive axle</u>
2			Drive axle 00 1703 003 X Drive axle 00 1703 007 X Drive axle 00 1703 008 X Drive axle 00 1703 009 X Drive axle 00 1703 011 X Drive axle 00 1703 012 X Drive axle 00 1703 013 X Drive axle 00 1703 015 X	<u>Drive axle</u>
3			Drive axle 00 1703 005 X Drive axle 00 1703 006 X Drive axle 00 1703 021 X	<u>Drive axle</u>

Drive axle

Applies to:

Drive axle 00 1703 005 X

Drive axle 00 1703 006 X

Drive axle 00 1703 021 X

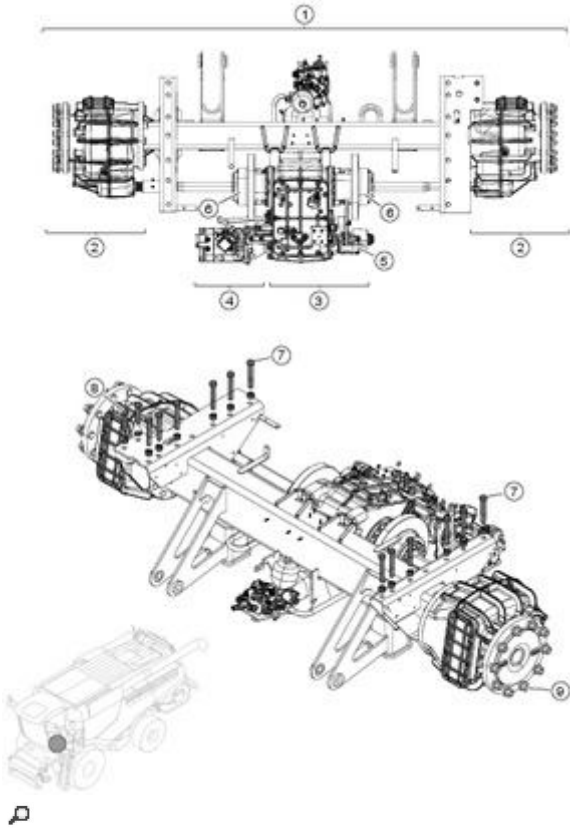

Technical specifications

	Value	CCN	Remark / designation	
Tightening torque values not specified, see "Introduction / Tightening torques" chapter				
1	1643 kg		Drive axle 00 1703 005 X Drive axle 00 1703 006 X Drive axle 00 1703 021 X	
2			Final drive 00 0776 320 X Final drive 00 0776 670 X (rice version)	<u>Final drive</u>
3			Manual gearbox 00 0776 485 X Manual gearbox 00 0776 492 X Manual gearbox 00 0776 501 X Manual gearbox 00 0776 562 X	<u>Manual gearbox</u>
4		2010	Ground drive variable-displacement motor	<u>Ground drive hydraulic motor</u>
5			Parking brake See supplement to Repair Manual (spring-type floating caliper)	

	Value	CCN	Remark / designation	
6			Service brake	<u>Drive axle service brake</u>
7	417 Nm		Bolts (7) for joining to the machine frame. Bolt down bolts (7) with new self-locking nuts.	
8	594 Nm		Tighten bolts (7) with DELO-ML 5349.	
9			Wheel bolt	<u>Wheel bolt</u>

Work preparation

Utilities:

- ▶ Sealing agents and glue:
DELO-ML-5349

Tool:

- ▶ Suitable lifting equipment (2 pcs.)
Total load-bearing capacity 1643 kg min.
- ▶ Suitable lifting gears (ropes) with appropriate load-bearing capacity.
- ▶ Suitable stands (2 pcs.)
Load-bearing capacity 10 t min. each
- ▶ Oil collecting tank
- ▶ Plugs (different sizes) for closing oil lines.

Installation instructions

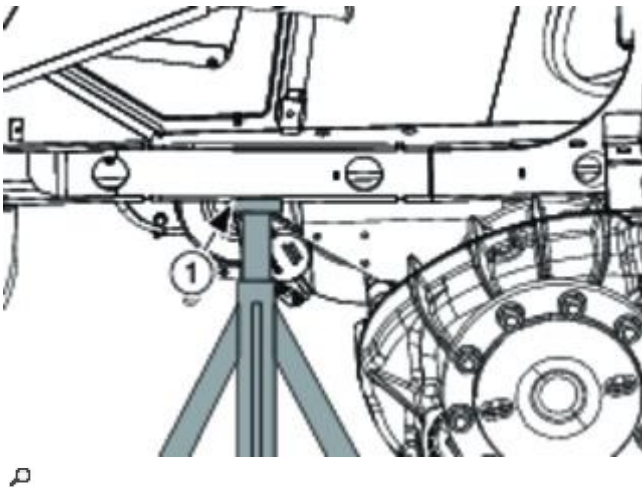

WARNING!

Lifting heavy components.

Risk of death or serious injury.

- ▶ Use a lifting tool with a sufficient bearing load.
- ▶ Use a lifting tool that operates reliably.
- ▶ Use the lifting tool on solid and even ground.
- ▶ Attach the lifting tool to the component at the intended or a suitable position.
- ▶ Only use faultless and sufficiently dimensioned lifting accessories.

- ▶ Protect lifting accessories against sharp corners and edges, for example using protectors.
-

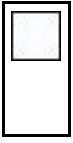
Removal:

- Jack up the machine using suitable pin-lock stands on both sides at (1) before removing the drive wheels.

Drive axle

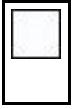
Installation:

- Remove pin-lock stands after installing the drive wheels.

Drive axle

Applies to:

Drive axle 00 1703 000 X

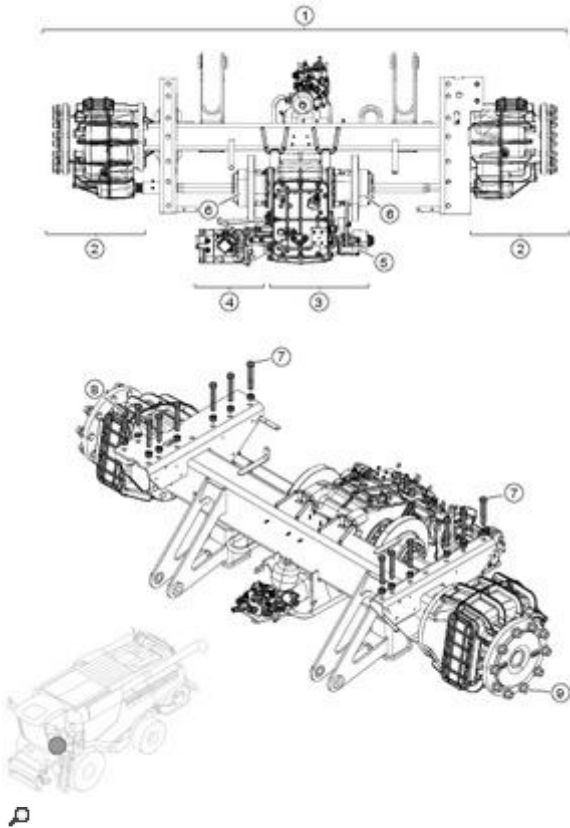

Technical specifications

	Value	CCN	Remark / designation	
Tightening torque values not specified, see "Introduction / Tightening torques" chapter				
1	1116 kg		Drive axle 00 1703 000 X	
2			Final drive 00 0776 565 X	<u>Final drive</u>
3			Manual gearbox 00 0776 351 X	<u>Manual gearbox</u>
4		2007	Ground drive fixed-displacement motor	<u>Ground drive hydraulic motor</u>
5			Parking brake See supplement to Repair Manual (spring-type floating caliper)	
6			Service brake	<u>Drive axle service brake</u>
7	417 Nm		Bolts (7) for joining to the machine frame. Bolt down bolts (7) with new self-locking nuts.	
8	370 Nm		Tighten bolts (7) with DELO-ML 5349.	
9			Wheel bolt	<u>Wheel bolt</u>

Work preparation

Utilities:

- ▶ Sealing agents and glue:
DELO-ML-5349

Tool:

- ▶ Suitable lifting equipment (2 pcs.)
Total load-bearing capacity 1116 kg min.
- ▶ Suitable lifting gears (ropes) with appropriate load-bearing capacity.
- ▶ Suitable stands (2 pcs.)
Load-bearing capacity 10 t min. each
- ▶ Oil collecting tank
- ▶ Plugs (different sizes) for closing oil lines.

Installation instructions

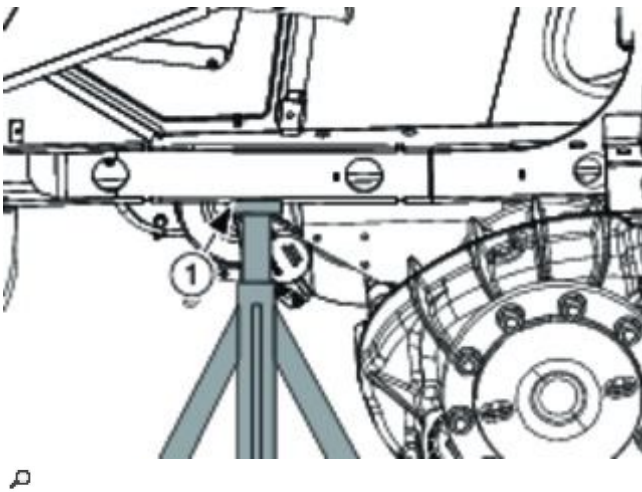

⚠ WARNING!

Lifting heavy components.

Risk of death or serious injury.

- ▶ Use a lifting tool with a sufficient bearing load.
- ▶ Use a lifting tool that operates reliably.
- ▶ Use the lifting tool on solid and even ground.
- ▶ Attach the lifting tool to the component at the intended or a suitable position.
- ▶ Only use faultless and sufficiently dimensioned lifting accessories.
- ▶ Protect lifting accessories against sharp corners and edges, for example using protectors.

Removal:

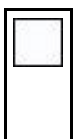

- Jack up the machine using suitable pin-lock stands on both sides at (1) before removing the drive wheels.

Drive axle

Installation:





- Remove pin-lock stands after installing the drive wheels.

Drive axle

Applies to:

Drive axle 00 1703 003 X

Drive axle 00 1703 007 X (rice version)

Drive axle 00 1703 008 X

Drive axle 00 1703 009 X

Drive axle 00 1703 011 X

Drive axle 00 1703 012 X

Drive axle 00 1703 013 X

Drive axle 00 1703 015 X

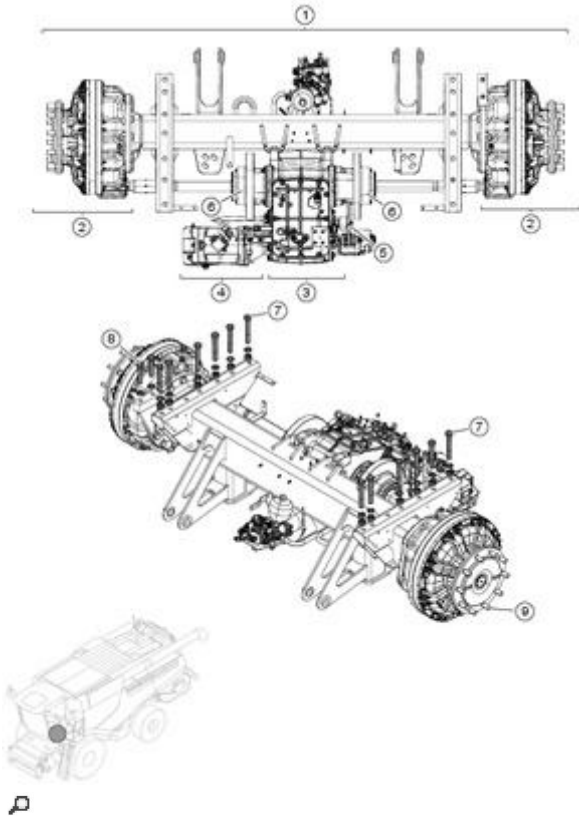

Technical specifications

	Value	CCN	Remark / designation
Tightening torque values not specified, see "Introduction / Tightening torques" chapter			
1	1491 kg		Drive axle 00 1703 003 X (rice version) Drive axle 00 1703 007 X Drive axle 00 1703 008 X Drive axle 00 1703 009 X Drive axle 00 1703 011 X Drive axle 00 1703 012 X Drive axle 00 1703 013 X Drive axle 00 1703 015 X

Buy Now



Our support email:

ebooklibonline@outlook.com