

# **HESSTON<sup>®</sup>**

## **FARM EQUIPMENT**

# **Operator's Manual**



## **L-330 LOADER**

FORM 700 704 345

---

*The*  
**PRIME LINE**

06910255

Reprinted

# HESSTON

## L-330 LOADER

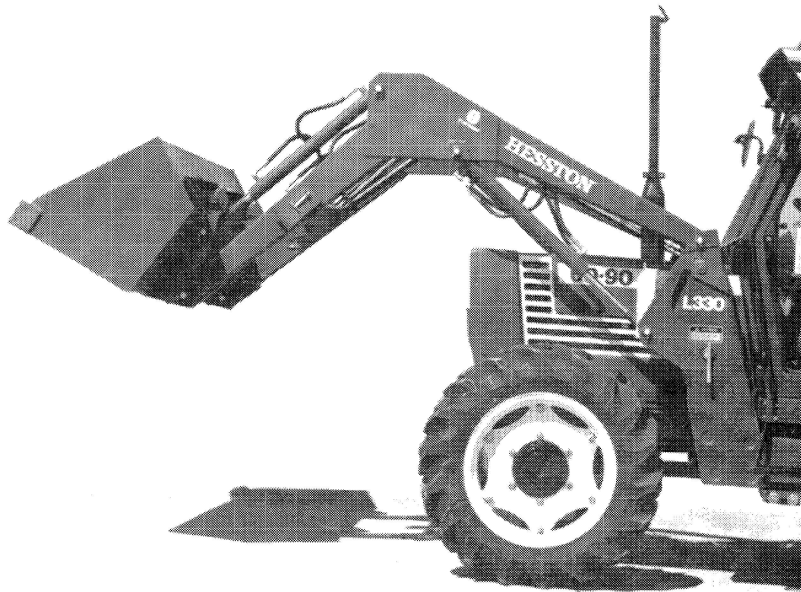

*THIS MANUAL IS APPLICABLE TO:*

L-330 Loaders, Serial No. L330-00001 and on.

### **TO OUR CUSTOMER**

We appreciate your confidence in HESSTON Farm Equipment and thank you for your patronage. In preparing this manual, we hope we have furnished you with a valuable tool for operating and maintaining this fine machine.



## **NEW EQUIPMENT SERVICE AND WARRANTY INFORMATION**

**SECURING WARRANTY SERVICE . . .** Warranty service will be performed by any Hesston Dealer authorized to sell new Hesston equipment of the type involved or by any Hesston Service Center authorized to service the type of equipment involved. At the time of requesting warranty service, you must present evidence of the date of delivery of the equipment. You should preserve this Delivery Receipt for use as evidence of the delivery date of any new equipment listed and present it when new equipment requires warranty service.

**SERVICE INSPECTION . . .** Your new Hesston equipment has been carefully prepared for delivery and has been adjusted according to factory recommendations by your dealer. You have also been provided with an Operator's Manual. We suggest that you make arrangements with your dealer, at the time of delivery, for a further service inspection after an appropriate "run-in" period. Such an inspection, other than items covered by Hesston's Warranty, will be at your expense.

Preventive maintenance pays big dividends in machine life as well as trouble free operation and lower operating costs.

**WARRANTY . . .** Your Hesston warranty for any new equipment appears on your copy of the Purchase Order or your copy of the delivery and warranty registration signed by you and your selling dealer. No charge will be made for parts replaced under the warranty nor for labor required to repair or replace such parts, except as provided in the warranty. You will be required to pay any premium for overtime labor requested by you, any charge for making service calls and for transporting the equipment to and from the place where warranty work is performed. Normal maintenance service and repair work not covered by the warranty during the warranty period and all service after the warranty period will be charged for at the dealer's regular rates and prices.

# TABLE OF CONTENTS

Specifications .....	1	Preparation .....	9
Checklists .....	2	Operation .....	11
Safety Precautions .....	4	Storage .....	16
General Information .....	7	Extra Equipment .....	17
Lubrication .....	8	Trouble Shooting.....	22
		Index .....	24

## SPECIFICATIONS

**NOTE: Specifications for Hesston L330 Loader as mounted on Hesston 60-90DT Tractor.**

*Specifications are statistical and furnished for general information only. Specifications will vary with different tractor models, tire sizes, hydraulic systems, etc. (Specifications and design are subject to change without notice and without liability therefore.)*

- |                                      |                                      |
|--------------------------------------|--------------------------------------|
| A - Max. lift height                 | F - Attachment rollback angle        |
| B - Clearance with attachment dumped | G - Digging depth                    |
| C - Reach at max. height             | H - Overall height in carry position |
| D - Max. dump angle                  | I - Height to top of pedestal        |
| E - Reach with attachment on ground  | R - Rollback at full height          |
|                                      | W - Lift capacity to full height     |

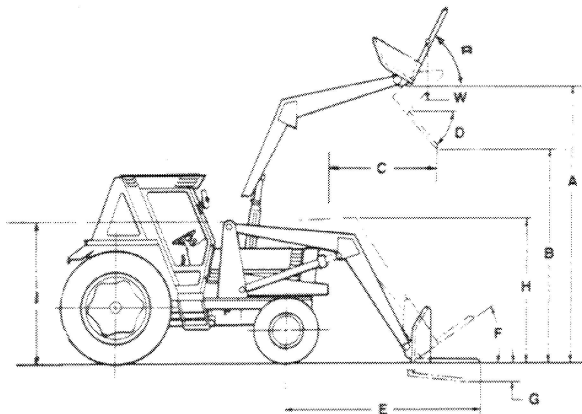

NOTE: Loader specifications will vary from one tractor model to another, and also vary with type of tractor tires used.

Loader Model .....	Hesston L330 (with 2.25-inch bore cylinders)
Attachment .....	material bucket (72-inch)
Attachment Control .....	hydraulic
Loader Weight .....	675 lbs.
Loader Mounting Frame .....	486 lbs.
Tractor Model .....	Hesston 60-90DT
Tires:	
Front .....	11.2 x 24
Rear .....	16.9 x 30
Wheelbase .....	86.6 inches
Rated Flow .....	11 gpm
Rated Pressure .....	2750 psi
Maximum Lift Height .....	121 inches
Clearance with Attachment Dumped .....	98.4 inches
Reach at Maximum Height .....	47.5 inches
Maximum Dump Angle .....	48 degrees
Reach with Attachment on Ground .....	76.5 inches
Attachment Rollback .....	13 degrees
Digging Depth .....	7 inches
Overall Height in Carry Position .....	69 inches
Height to Top of Pedestal .....	63.8 inches
Rollback at Full Height .....	93 degrees
Lift Capacity to Full Height .....	2200 lbs.
Break Out Force .....	2650 lbs.
Raising Time .....	4.5 seconds
Lowering Time .....	2.5 seconds
Attachment Dumping Time .....	4.3 seconds
Attachment Rollback Time .....	2.4 seconds

*(Specifications and design are subject to change without notice and without liability therefore.)*



# CHECKLISTS

## PRE-DELIVERY CHECKLIST

After the machine has been completely assembled and lubricated, inspect it thoroughly to be certain it is operating properly before delivering it to the customer. The following checklist is a reminder of points to inspect. Check off each item as it is found satisfactory or after proper adjustment is made.

- \_\_\_\_\_ Check to make sure loader is completely assembled according to assembly instructions.
- \_\_\_\_\_ Check all bolts to make sure they are tightened to specified torque value.
- \_\_\_\_\_ Inspect and, if necessary, lubricate all lubrication points. Make sure all fittings are in place and taking grease properly.
- \_\_\_\_\_ Inspect all hydraulic hoses, lines and fittings to make sure they are installed properly and not leaking.
- \_\_\_\_\_ Make sure hydraulic hoses are properly routed and will not be damaged when the loader is raised or lowered.
- \_\_\_\_\_ Start tractor, raise and lower loader and operate bucket cylinders and make sure unit is operating properly.
- \_\_\_\_\_ Check tractor hydraulic fluid level. Add hydraulic fluid as required to fill to full indicator on dip stick. Refer to tractor Operator's Manual for proper oil to be used.
- \_\_\_\_\_ Inflate tractor's front tires to maximum recommended pressure.
- \_\_\_\_\_ Adjust tractor tread width to recommended setting as specified under "Preparation" section.

## DELIVERY CHECKLIST

- \_\_\_\_\_ Explain warranty, then complete deliver and warranty registration forms, listing the serial number of the loader. Dealer and customer must sign forms.
- \_\_\_\_\_ Explain importance of proper lubrication and indicate all lubrication points on the loader.
- \_\_\_\_\_ Advise customer that carrying round bale on loader without a grapple is dangerous because bale can roll down loader frame injuring or killing the operator and damaging the tractor.
- \_\_\_\_\_ Advise customer of safety hazards involved when operating the tractor and loader. Refer to "Safety Precautions" section of manual.
- \_\_\_\_\_ Advise customer of the importance of adding proper rear ballast to rear of tractor to compensate for additional weight being added to front end when loader is installed.
- \_\_\_\_\_ Explain proper operation of the loader and its controls to the customer.
- \_\_\_\_\_ Give Operator's Manual to the customer and ask him to familiarize himself with all sections.
- \_\_\_\_\_ Explain to the customer that when the tractor and loader combination is transported on public roads and highways at night or during the day, accessory lights, warning devices or a Slow Moving Vehicle emblem should be used to properly warn operators of other vehicles. Check with local law enforcement officials for specific regulations.

**BEGINNING EACH SEASON CHECKLIST**

- \_\_\_\_\_ Check all hydraulic hoses, lines and fittings to be sure they are tight and not leaking. Replace any worn or damaged parts.
- \_\_\_\_\_ Check tractor hydraulic fluid level and add as required. Refer to tractor manual for recommended oil to be used.
- \_\_\_\_\_ Operate loader by raising and lowering lift arms and extending and retracting bucket cylinders. Check all hydraulic cylinders for leakage around seals. Repair as required.
- \_\_\_\_\_ Review "Safety Precautions" section of manual.
- \_\_\_\_\_ Make sure loader has been completely lubricated per "Lubrication" section prior to beginning operation.
- \_\_\_\_\_ Check all bolts on loader mounting frame to be sure they are properly tightened to specified torque value.
- \_\_\_\_\_ Check for any special attachment which will help you do a better job.

**DAILY CHECKLIST**

- \_\_\_\_\_ Remove all dirt and grease from the machine.
- \_\_\_\_\_ Completely lubricate the loader as indicated in the "Lubrication" section of manual.
- \_\_\_\_\_ Check all hoses, lines and hydraulic fittings for leaks and repair or replace as required.
- \_\_\_\_\_ Check hydraulic fluid level in tractor and fill as required. Refer to tractor manual for recommended oil to be used.
- \_\_\_\_\_ Make sure all bolts are tightened to specified torque value and have not worked loose from vibration.
- \_\_\_\_\_ Look for missing bolts or parts and replace as required.
- \_\_\_\_\_ Make sure tractor front tires are inflated to maximum recommended pressure.

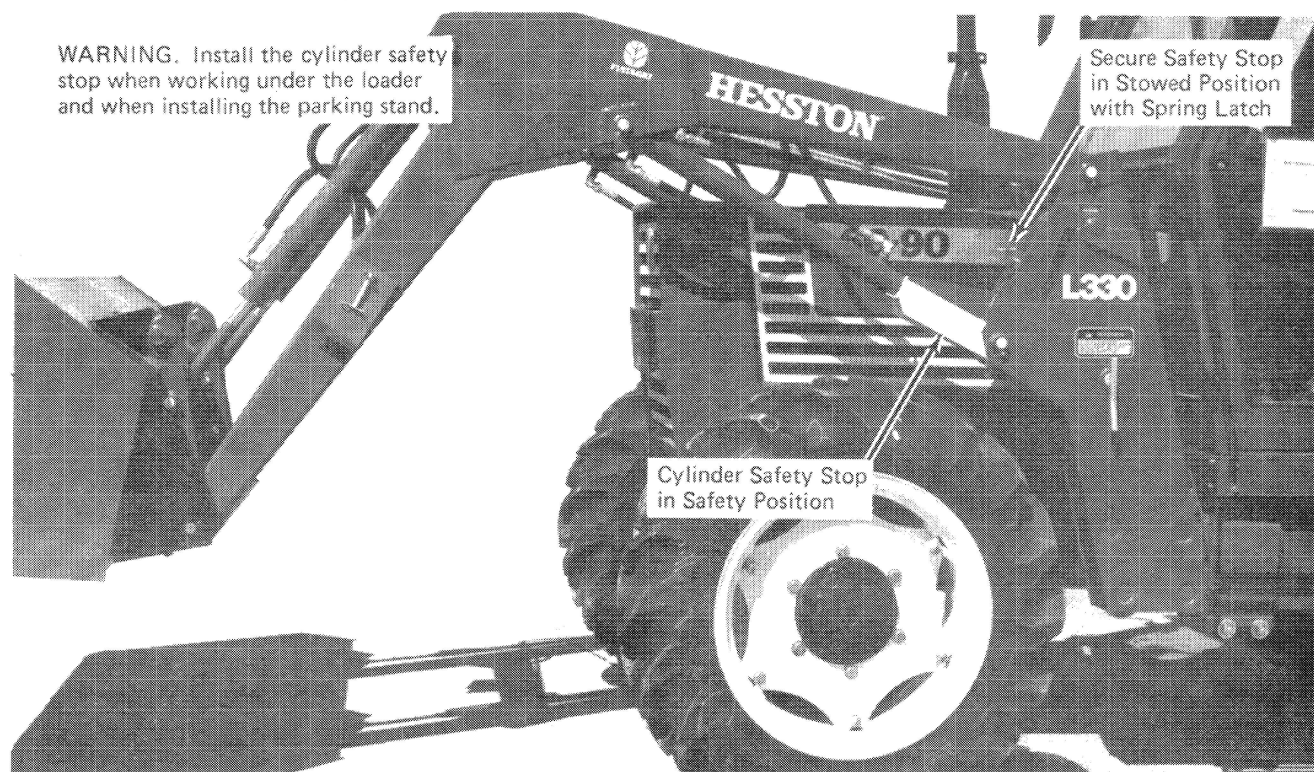

Figure 1. Installation of Safety Stop

Thank you so much for reading.  
Please click the “Buy Now!”  
button below to download the  
complete manual.



After you pay.

You can download the most  
perfect and complete manual in  
the world immediately.

Our support email:

[ebooklibonline@outlook.com](mailto:ebooklibonline@outlook.com)