

| Page Title | Page Number |
|--|-------------|
| ENGINE - AD3.152 ENGINE | 1 |
| SHORT ENGINE- . - TABLE PK ACEC9106- . | 2 |
| CYLINDER BLOCK - AD3.152 ENGINE | 3 |
| CRANKSHAFT, PISTONS AND CONNECTING RODS - AD3.152 ENGINE | 6 |
| CYLINDER HEAD - AD3.152 ENGINE | 8 |
| ROCKER SHAFT - AD3.152 ENGINE | 11 |
| TIMING GEAR AND CAMSHAFT - AD3.152 ENGINE | 13 |
| FUEL INJECTION EQUIPMENT (DIESEL) - AD3.152 ENGINE | 16 |
| LUBRICATING OIL SUMP - AD3.152 ENGINE | 18 |
| LUBRICATING OIL FILTER AND INTEGRAL COOLER - AD3.152 ENGINE | 22 |
| WATER PUMP, THERMOSTAT AND HEAT EXCHANGER - AD3.152 ENGINE | 23 |
| LOW PRESSURE FUEL SYSTEM - AD3.152 ENGINE | 25 |
| AIR INDUCTION AND EXHAUST SYSTEM - AD3.152 ENGINE | 26 |
| ALTERNATOR POSITIONER - AD3.152 ENGINE | 27 |
| JOINTS AND GASKETS - AD3.152 ENGINE | 28 |
| HEATER - COLD CLIMATE | 29 |
| ALTERNATOR - ISKRA TYPE- . | 30 |
| ALTERNATOR - VALEO TYPE | 32 |
| ALTERNATOR-LUCAS - LUCAS- . | 34 |
| STARTER MOTOR - UP TO SERIAL NUMBER R35158- . | 36 |
| STARTER MOTOR - ISKRA TYPE- . | 37 |
| STARTER MOTOR - FROM SERIAL NO. R35159- . | 39 |
| STARTER MOTOR - FROM SERIAL NO. S12087- . | 41 |
| COOLING SYSTEM-ENGINE - FAN AND HOSES | 42 |
| EXHAUST SYSTEM-HORIZONTAL | 43 |
| EXHAUST SYSTEM-VERTICAL | 45 |
| AIR FILTER-DRY - DUAL ELEMENT - DRY AIR CLEANER- . | 46 |
| FUEL SYSTEM-FUEL TANK AND ATTACHMENTS | 48 |
| FUEL SYSTEM-FUEL FILTER | 50 |
| COOLING SYSTEM - RADIATOR AND BRACKET- . | 52 |
| THROTTLE CONTROLS | 55 |
| INSTRUMENT PANEL AND INSTRUMENTS | 57 |
| INSTRUMENT PANEL AND INSTRUMENTS | 61 |
| ELECTRICAL WIRING | 62 |
| ELECTRONIC HARNESS-INSTRUMENT PANEL | 67 |
| SENSORS HARNESS | 68 |
| LIGHTING EQUIPMENT-REAR | 69 |
| ELECTRICAL WIRING-TRACTOR CAB | 70 |
| LIGHTING EQUIPMENT | 71 |
| LIGHTING EQUIPMENT | 76 |
| BATTERY | 77 |
| CLUTCH-DUAL CLUTCH - LUK 11- - UP TO SERIAL NUMBER P50186- . | 79 |
| CLUTCH-DUAL CLUTCH - OMG 11- - UP TO SERIAL NUMBER P50186- . | 81 |
| CLUTCH-DUAL CLUTCH - O.M.G. FROM SERIAL N.P50187- . | 83 |
| CLUTCH-DUAL CLUTCH - LUK 11" FROM SERIAL N.P50187- . | 85 |
| CLUTCH PEDAL AND LINKAGE | 87 |
| CENTRE AXLE HOUSING AND TRANSMISSION HOUSING | 90 |
| CENTRE AXLE HOUSING AND TRANSMISSION HOUSING | 91 |
| 12 SPEED TRANSMISSION - STANDARD VERSION | 93 |
| 12 SPEED TRANSMISSION - STANDARD VERSION | 96 |
| SHIFT LEVERS-12 SPEED TRANSMISSION | 99 |
| SHIFT LEVERS-12 SPEED TRANSMISSION | 101 |
| GEAR BOX - FOR SHUTTLE VERSION ONLY. | 103 |
| REDUCER - FOR SHUTTLE VERSION ONLY. | 104 |
| REDUCER CONTROL - OVERDRIVE AND SHUTTLE VERSION | 107 |
| REDUCER - OVERDRIVE AND SHUTTLE VERSION | 109 |
| REDUCER CONTROL - OVERDRIVE AND UNDERDRIVE VERSION | 113 |
| REDUCER - OVERDRIVE AND UNDERDRIVE VERSION | 115 |
| REDUCER CONTROL - OVERDRIVE AND CREEPER VERSION | 119 |
| REDUCER - OVERDRIVE AND CREEPER VERSION | 121 |
| REDUCER CONTROL - UNDERDRIVE AND SHUTTLE VERSION | 124 |
| REDUCER - UNDERDRIVE AND SHUTTLE VERSION | 125 |
| REDUCER CONTROL - UNDERDRIVE E CREEPER VERSION | 129 |
| REDUCER - UNDERDRIVE E CREEPER VERSION | 130 |
| REDUCER CONTROL - SHUTTLE AND CREEPER VERSION | 133 |
| REDUCER - SHUTTLE AND CREEPER VERSION | 134 |

TABLE OF CONTENT

| | |
|--|-----|
| PTO SHAFT - 540 R.P.M.- . | 137 |
| PTO SHAFT - 540 R.P.M.- . | 139 |
| PTO SHAFT - 540/750/1000 R.P.M.- . | 141 |
| PTO SHAFT - 540/750/1000 R.P.M.- . | 144 |
| PTO-CONTROL - 540 R.P.M.- . | 146 |
| PTO-CONTROL - 540/750/1000 R.P.M.- . | 147 |
| TRANSFER GEAR BOX-4 WHEEL DRIVE | 149 |
| 4 WHEEL DRIVE CONTROLS | 151 |
| REAR AXLE-DIFFERENTIAL | 152 |
| REAR AXLE-HOUSING | 154 |
| REAR AXLE-DIFFERENTIAL LOCK MECHANISM - MECHANICAL CONTROL- . | 157 |
| BRAKE AND CONTROLS | 158 |
| BRAKE AND CONTROLS | 160 |
| BRAKES-HANDBRAKE | 162 |
| BRAKE CYLINDER | 164 |
| BRAKES-MASTER CYLINDER | 166 |
| REAR WHEELS | 167 |
| FRONT WHEELS | 170 |
| FRONT AXLE 2 WHEEL DRIVE-AXLE SUPPORT | 173 |
| FRONT AXLE 4 WHEEL DRIVE-DIFFERENTIAL | 176 |
| FRONT AXLE 4 WHEEL DRIVE-DIFFERENTIAL | 179 |
| FRONT AXLE 4 WHEEL DRIVE-FINAL DRIVE | 181 |
| FRONT AXLE 4 WHEEL DRIVE-DIFFERENTIAL | 183 |
| FRONT AXLE 4 WHEEL DRIVE-DIFFERENTIAL | 186 |
| FRONT AXLE 4 WHEEL DRIVE-FINAL DRIVE | 189 |
| STEERING ORBITROL UNIT - 2 WHEEL DRIVE | 192 |
| STEERING ORBITROL UNIT - 4 WHEELS DRIVE | 194 |
| STEERING HYDRAULIC LINES | 196 |
| STEERING HYDRAULIC LINES | 198 |
| STEERING CYLINDER-4 WHEEL DRIVE | 201 |
| STEERING CYLINDER-4 WHEEL DRIVE | 202 |
| STEERING CYLINDER-2 WHEEL DRIVE | 203 |
| STEERING-STEERING PUMP - UP TO SERIAL NUMBER R31000- . | 205 |
| STEERING-STEERING PUMP - FROM SERIAL NO- R31001. | 206 |
| HYDRAULIC LIFT PIPINGS - STANDARD VERSION | 207 |
| HYDRAULIC LIFT PIPINGS | 209 |
| HYDRAULIC LIFT PIPINGS - SINGLE HYDRAULIC LINES | 212 |
| HYDRAULIC PUMP - BOSCH | 214 |
| HYDRAULIC PUMP - TUROLLA | 215 |
| HYDRAULIC PUMP - CESSNA | 216 |
| HYDRAULIC LIFT VALVE | 218 |
| HYDRAULIC LIFT-LIFT ARMS | 220 |
| HYDRAULIC LIFT-LIFT ARMS | 222 |
| REAR CONTROLS-DRAFT AND POSITION | 224 |
| REAR CONTROLS-DRAFT AND POSITION | 227 |
| HYDRAULIC LIFT CYLINDER - HYDRAULIC LIFT CYLINDER,WITH 1'AND 2'AUXIL.HYDRAUL .VAL | 229 |
| AUXILIARY HYDRAULIC VALVE LINES - TILL TYPE | 231 |
| AUXILIARY HYDRAULIC VALVE LINES - TILL TYPE | 234 |
| AUXILIARY HYDRAULIC VALVE LINES - WITH AUXILIARY HYDRAULIC VALVE CLEARANCE- . | 237 |
| AUXILIARY HYDRAULIC VALVE LINES - WITH AUXILIARY HYDRAULIC VALVE CLEARANCE- . | 238 |
| AUXILIARY HYDRAULICS VALVE - TILL TYPE STANDARD- . | 239 |
| AUXILIARY HYDRAULICS VALVE - TILL TYPE FLOATING- . | 241 |
| AUXILIARY HYDRAULIC VALVE LINES- HIDROIRMA - HIDROIRMA TYPE FROM SERIAL N.B08001- . | 243 |
| AUXILIARY HYDRAULIC VALVE LINES- HIDROIRMA - HIDROIRMA TYPE FROM SERIAL N.B08001- . | 245 |
| AUXILIARY HYDRAULIC VALVE LINES- HIDROIRMA - HIDROIRMA TYPE FROM SERIAL N.B08001- . | 246 |
| LINKAGETOP LINK - HIDROIRMA TYPE FROM SERIAL N.B08001- . | 248 |
| PLATFORM AUTOMATIC HITCHWITH REMOTE CONTROL - HIDROIRMA TYPE FROM SERIAL N.B08001- . | 249 |
| CONTROL VALVE-VALVE - HIDROIRMA TYPE FROM SERIAL N.B08001- . | 250 |
| ACCESSORIES HYDRAULIC - ADDITIONAL POWER OUTLET UNIT | 251 |
| LINKAGE CAT 2 - UP TP SERIAL NUMBER- . | 252 |
| LINKAGE CAT 2 - UP TP SERIAL NUMBER- . | 255 |
| LINKAGE CAT 2 | 258 |
| LINKAGE CAT 2 | 261 |
| LINKAGE-LINK END | 264 |
| SHEET METAL-GRILLE | 265 |
| SHEET METAL-HOOD | 266 |
| SHEET METAL-PANELS | 268 |
| DECALS | 269 |

| | | |
|-----------------------------------|-----|----|
| TABLE OF CONTENT | | 00 |
| DECALS | 272 | |
| DECALS | 276 | |
| FENDERS - FRONT - 2WHEEL DRIVE | 278 | |
| FENDERS - FRONT - 4 WHEEL DRIVE | 279 | |
| FENDERS AND PLATFORM | 281 | |
| SAFETY FRAME | 286 | |
| ROTATING LIGHT | 287 | |
| SEAT-GRAMMER | 289 | |
| TRACTOR CAB-FRAME | 292 | |
| TRACTOR CAB-ROOF | 295 | |
| TRACTOR CAB-CAB DOOR | 298 | |
| TRACTOR CAB-WINDOWS - FRONT- . | 300 | |
| TRACTOR CAB-WINDOWS - REAR | 302 | |
| TRACTOR CAB-CAB INSULATION | 305 | |
| TRACTOR CAB-CAB INSULATION | 306 | |
| TRACTOR CAB-ELECTRICAL EQUIPMENT | 308 | |
| TRACTOR CAB-CAB INSULATION | 309 | |
| TRAILER BRAKES-PIPES AND FITTINGS | 311 | |
| WEIGHT FRAME AND WEIGHTS | 313 | |
| REAR HOOK-ADJUSTABLE | 314 | |
| DRAWBAR | 315 | |
| DRAWBAR | 316 | |
| REAR HOOK-ADJUSTABLE - STANDARD | 317 | |
| TOOL KIT | 318 | |

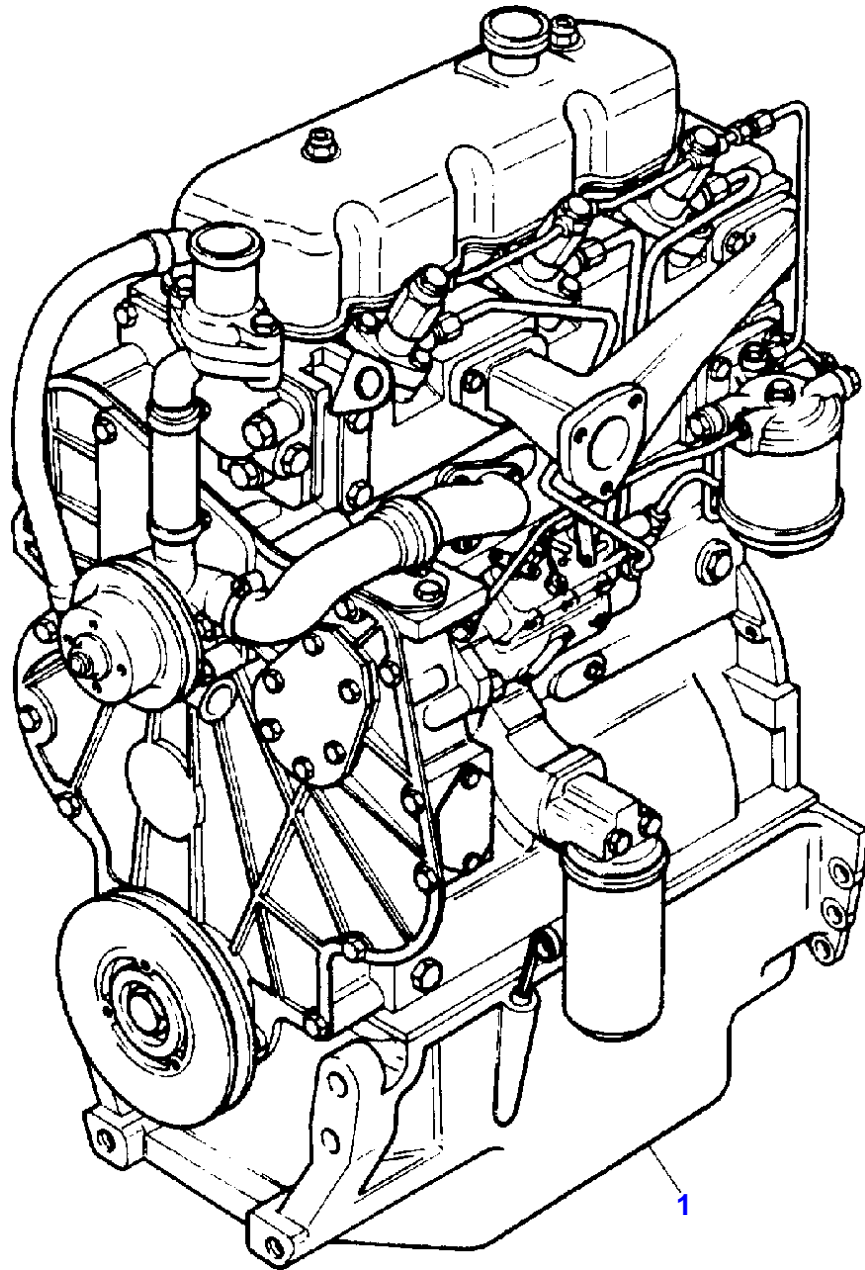

MASSEY FERGUSON

MF 354 F TRACTOR - 3311555

3311555

ENGINE - AD3.152 ENGINE

1

| Item | Part Number | Qty | Description | Comments |
|------|-------------|-----|-------------|-------------------------------------|
| | | | | AD3.152 ENGINE |
| 1 | 3553118M91 | X | Engine | (A) Repairs and replaces CE31197 |
| 1 | 3553128M91 | X | Engine | (B) Repairs and replaces CE31212 |
| | | | | (A) SINGLE STANDARD LINES |
| | | | | (B) SINGLE HYDRAULIC LINES |

Thank you so much for reading.
Please click the “Buy Now!”
button below to download the
complete manual.



After you pay.

You can download the most
perfect and complete manual in
the world immediately.

Our support email:

ebooklibonline@outlook.com