

48'' Snow Blade

for

Lawn & Garden Tractors

Model No. 79252 – 6900001 & Up

Model No. 99251 – 6900001 & Up

Model No. 9861907 – T6S0001 & Up

Operator's Manual

IMPORTANT: Read this manual carefully. It contains information about your safety and the safety of others. Also become familiar with the controls and their proper use before you operate the product.

Introduction

We want you to be completely satisfied with your new product, so feel free to contact your local Authorized Service Dealer for help with service, genuine replacement parts, or other information you may require.

Whenever you contact your Authorized Service Dealer or the factory, always know the model and serial numbers of your product. These numbers will help the Service Dealer or Service Representative provide exact information about your specific product. You will find the model and serial number plate located in a unique place on the product as shown below.

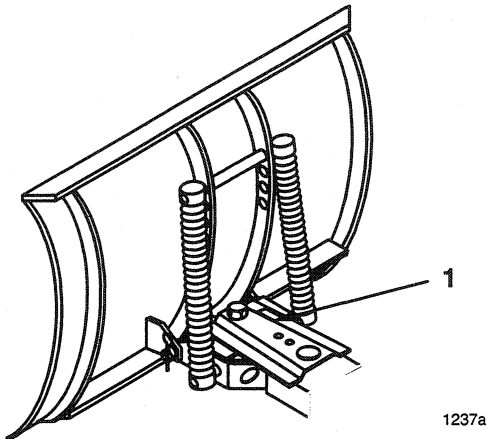

1. Model and Serial Number Plate

For your convenience, write the product model and serial numbers in the space below.

Model No: _____
Serial No. _____

The warning system in this manual identifies potential hazards and has special safety messages that help you and others avoid personal injury, even death. **DANGER**, **WARNING** and **CAUTION** are signal words used to identify the level of hazard. However, regardless of the hazard, be extremely careful.

DANGER signals an extreme hazard that will cause serious injury or death if the recommended precautions are not followed.

WARNING signals a hazard that may cause serious injury or death if the recommended precautions are not followed.

CAUTION signals a hazard that may cause minor or moderate injury if the recommended precautions are not followed.

Two other words are also used to highlight information. "Important" calls attention to special mechanical information and "Note" emphasizes general information worthy of special attention.

The left and right side of the machine is determined by sitting on the seat in the normal operator's position.

Contents

	Page		Page
Installation	2	Adjusting Dial-A-Height	11
Loose Parts	2	Adjusting Blade Index	12
Assemble Blade	4	Adjusting Blade Trip Springs	12
Tractor Set-Up	6	Tips for Using Snow Blade	13
Installing Snow Blade to Tractor	7	Maintenance	14
Removing the Snow Blade	8	Service Interval Chart	14
Operation	10	Greasing and Lubrication	15
Attachment Power Lift	10	Reversing the Scraper Blade	16
Attachment Lift Lever	11	Storage	16

Installation

Loose Parts

Note: Use the chart below to identify parts used for assembly.

DESCRIPTION	QTY.	USE
Channel assembly	1	Assemble blade to channel and frame
Tip spring	2	
Rod	3	
Cotter pin	4	
Hairpin cotter	2	
Bolt 3/4–16 x 3/4"	1	
Nut 3/4"	1	
Index rod	1	Assemble index plate to frame
Index plate	1	
Bolt 3/8–16 x 1"	1	
Washer 3/8"	1	
Lock nut 3/8"	1	
Index lever	1	Assemble index handle to frame
Bolt 1/2–13 x 1"	1	
Nut 1/2"	1	
Eyebolt	1	
Eyelet	1	
Washer #10	2	
Lock nut #10	3	
Control rod	1	
Washer 1/2"	1	
Hairpin cotter	1	
Cotter pin	1	

DESCRIPTION	QTY.	USE
Lift weldment	1	Mount lift assembly to frame
Plate	2	
Bolt 3/8–16 x 1"	4	
Lock nut 3/8"	4	
Washer 5/8"	3	
Cotter pin	3	
Lift rod	1	
Hitch assembly	1	Install front hitch
Carriage bolt 3/8–16 x 1'	4	
Washer 3/8"	4	
Lock nut 3/8"	4	
Rear mounting plate	1	Assemble rear hitch
Blade bracket	1	
Bolt 1/2–13 x 1-1/4"	3	
Lock nut 1/2"	5	
Latch lever	2	
Washer 3/8"	2	
Carriage bolt 3/8–16 x 1-1/4"	2	
Spindle stop	1	Install steering spindle stop
Self tapping bolt 5/16–18 x 3/4"	1	

Thank you so much for reading.
Please click the “Buy Now!”
button below to download the
complete manual.



After you pay.

You can download the most
perfect and complete manual in
the world immediately.

Our support email:

ebooklibonline@outlook.com