

m-3666

NEW HOLLAND

48" Vac-Bagger

For Garden Tractors

Model No.

716504006 – T8BJ0001 & Up

OPERATOR'S MANUAL



NEW HOLLAND

SERVICE

Introduction

Thank you for purchasing a New Holland product.

All of us at New Holland want you to be completely satisfied with your new product, so feel free to contact your local Authorized Service Dealer for help with service, genuine replacement parts, or other information you may require.

Whenever you contact your Authorized Service Dealer or the factory, always know the model and serial numbers of your product. These numbers will help the Service Dealer or Service Representative provide exact information about your specific product. You will find the model and serial number plate located in a unique place on the product as shown below.

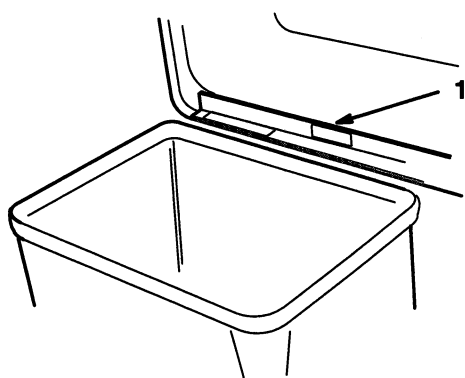

1. Model and Serial Number Plate

1375

For your convenience, write the product model and serial numbers in the space below.

 NEW HOLLAND	
MODEL NO.	SERIAL NO.
COMPONENT	
NEW HOLLAND NORTH AMERICA, INC.	
MADE IN U.S.A.	

Read this manual, and all related equipment manuals, carefully to learn how to operate and maintain your product correctly. Reading this manual will help you and others avoid personal injury and damage to the product. Although we design, produce and market safe, state-of-the-art products, you are responsible for using the product properly and safely. You are also responsible for training persons, who you allow to use the product, about safe operation.

The warning system in this manual identifies potential hazards and has special safety messages that help you and others avoid personal injury, even death. DANGER, WARNING and CAUTION are signal words used to identify the level of hazard. However, regardless of the hazard, be extremely careful.

DANGER signals an extreme hazard that will cause serious injury or death if the recommended precautions are not followed.

WARNING signals a hazard that may cause serious injury or death if the recommended precautions are not followed.

CAUTION signals a hazard that may cause minor or moderate injury if the recommended precautions are not followed.

Two other words are also used to highlight information. "Important" calls attention to special mechanical information and "Note" emphasizes general information worthy of special attention.

The left and right side of the machine is determined by sitting on the seat in the normal operator's position.

Contents

	Page		Page
Safety and Instruction Decals	2	Operation	19
Installation	3	Using the Full Bag Tester	19
Loose Parts	3	Emptying the Grass Bags	19
Preparing the Tractor	5	Clearing Obstructions from the Bagger ...	20
Preparing the Mower	5	Operating and Bagging Tips	20
Assemble the Blower	8	Maintenance	22
Installing the Vac-Bagger onto the Tractor	8	Inspecting the Bagger Attachment	22
Removing the Bagger	13	Inspecting the Mower Blades	22
Removing the Vac Bagger		Caring for the Grass Bags	22
from the Tractor	16	Cleaning the Bagger Attachment	22
		Storing the Bagger Attachment	23

Safety and Instruction Decals



Safety decals and instructions are easily visible to the operator and are located near any area of potential danger. Replace any decal that is damaged or lost.

INSIDE EDGE OF BAGGER TOP (PART NO. TR92D7113)



(1) ON TOP OF MOWER (LEFT SIDE) (1) ON MOWER BELT COVER (PART NO. TR92D7108)



MOLDED INTO BELT SHIELD



MOLDED INTO BELT SHIELD

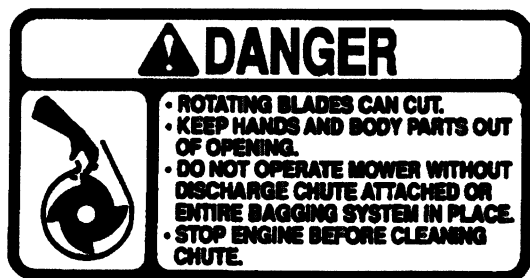

MOLDED INTO BELT SHIELD



Installation

Loose Parts

Note: Use the chart below to identify parts used for assembly.

DESCRIPTION	QTY.	USE
Bagger hitch	1	Mount bagger hitch
Bolt 3/8–16 x 1" (25 mm)	4	
Nut 3/8"	4	
Counterweight	1	Install counterweight
Bolt 3/8–16 x 2–1/4" (57 mm)	2	
Flat washer 3/8" (10 mm)	4	
Locknut 3/8"	2	
Danger decal	1	
Bolt 3/8–16 x 3/4" (19 mm)	2	Install in open holes when counterweight is removed
Locknut 3/8"	2	
Pivot support	1	Install blower pivot support
Bolt 5/16–18 x 3/4" (19 mm)	1	
Flange nut 5/16"	1	
Washer 3/8"	1	
Blower mounting plate	1	Assemble the blower
Blower housing assembly	1	
Carriage bolt 5/16–18 x 3/4" (19 mm)	3	
Flange nut 5/16"	4	
Bolt 5/16–18 x 1" (25 mm)	1	
L–support bracket	1	
Washer 5/16" (8 mm)	1	
Latch	1	
Tension spring	1	
Screw #10–24 x 3/4" (19 mm)	1	
Nut #10	2	
Washer #10 (5 mm)	2	
Bolt 1/4–20 x 3/4" (19 mm)	1	
Washer 1/4" (6 mm)	1	
Locknut 1/4"	1	

DESCRIPTION	QTY.	USE
Cover	1	Assemble the bagger
Indicator rod	1	
Handle	1	
Jam nut 1/4"	1	
Clips	2	
Screw 1/4–20 x 3/4" (19 mm)	2	
Locknut 1/4"	4	
Frame assembly	1	
Tube	1	Assemble the tube latch and knob
Knob	1	
Screw 1/4–20 x 3/4" (19 mm)	1	
Washer	1	
Rubber latch	1	
Flanged spacer	1	
Barbed fastener	1	
Pulley	1	Install the blower
Belt	1	
Belt cover bracket	1	
Screw 1/4–20 x 3/8" (10 mm)	3	
Mower belt cover	1	
Screw 1/4–20 x 1/2" (13 mm)	2	
Blower belt cover	1	
Bolt 1/4–20 x 5/8" (16 mm)	2	
Locknut 1/4"	2	
Quick-attach bracket	1	Install the bagger assembly
Hairpin cotter	2	
Grass bags	2	
Operator's Manual	1	Read before operating

Preparing the Tractor

Remove the Transaxle Cover

Remove the transaxle cover from the back of the tractor (Fig. 1).

Note: Save all parts and hardware for use when installing the transaxle cover.

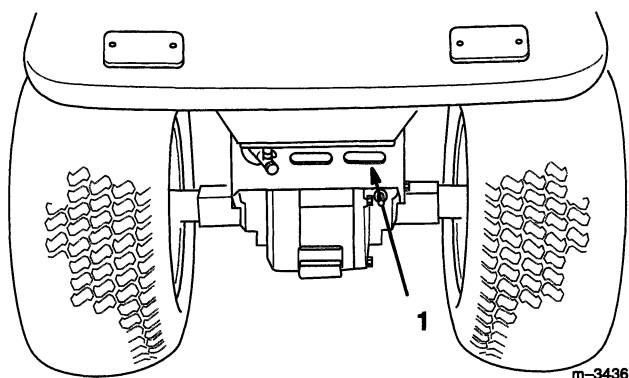

Figure 1

1. Rear transaxle cover

Mount the Vac Bagger Hitch to the Tractor

Install the vac bagger hitch to the tractor with 4 bolts and nuts (Fig. 2).

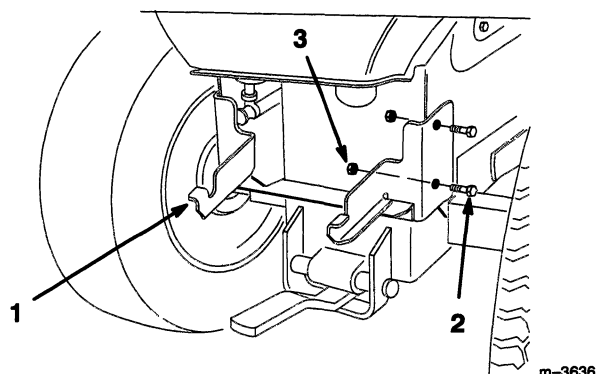

Figure 2

1. Bagger hitch
2. Bolt 3/8 x 1" (25 mm)
3. Nut 3/8"

Preparing the Mower

Remove the Discharge Chute

1. Remove the discharge chute from the mower (Fig. 3).

Note: Save all parts and hardware for use when installing the discharge chute.

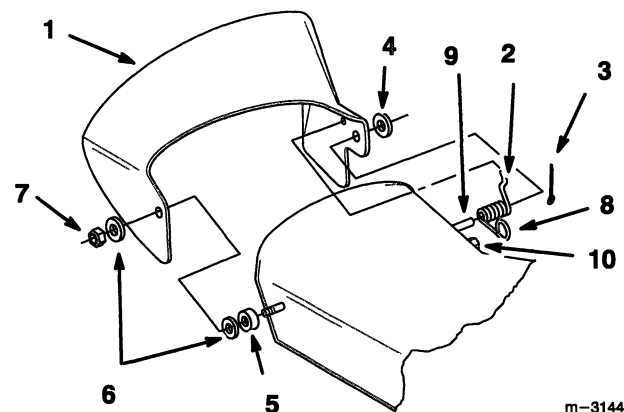

Figure 3

1. Discharge chute
2. Spring
3. Cotter pin 1/8" x 3/4" (19 mm)
4. Washer 1/2" (13 mm)
5. Rubber bushing
6. Plastic washer
7. Jam nut 3/8"
8. Loop in spring
9. Post on mower housing
10. Stud on mower housing

Thank you so much for reading.
Please click the “Buy Now!”
button below to download the
complete manual.



After you pay.

You can download the most
perfect and complete manual in
the world immediately.

Our support email:

ebooklibonline@outlook.com