

# OPERATOR'S MANUAL

---

**272GMS**

**Mid Mount / Side Discharge**

For Tractors with CVT Transmission

**Mower Deck**

**Part number 47547318**

2<sup>nd</sup> edition English

May 2013

*Replaces part number 47406430*



---

## IMPORTANT SAFETY PRECAUTIONS

### UNDERSTAND SIGNAL WORDS

**DANGER** indicates a hazardous situation which, if not avoided, will result in death or serious injury.

**WARNING** indicates a hazardous situation which, if not avoided, could result in death or serious injury.

**CAUTION** indicates a hazardous situation which, if not avoided could result in minor or moderate injury.

**NOTICE** is used to address practices not related to physical injury.



### SAFETY ALERT SYMBOL

This is the safety alert symbol. It is used to alert you to potential physical injury hazards. Obey all safety messages that follow this symbol to avoid possible injury or death.

In addition to the design and configuration of equipment, hazard control and accident prevention are dependent upon the awareness, concern, prudence and proper training of personnel in the operation, transport, maintenance and storage of equipment. Lack of attention to safety can result in accident, personal injury, reduction of efficiency and worst of all – loss of life. Watch for safety hazards and correct deficiencies promptly. Use the following safety precautions as a general guide to safe operations when using this machine. Additional safety precautions are used throughout this manual for specific operating and maintenance procedures. Read this manual and review the safety precautions often until you know the limitations. Do not allow children or untrained persons to operate equipment. Do not operate equipment under the influence of drugs or alcohol.

### THE TRACTOR

1. Read, understand and follow all instructions in the manual and on the machine before starting. Failure to do so could result in serious injury or death and equipment damage. Keep this manual in a safe place for future and regular reference and for ordering service parts.
2. Read and understand all Safety Precautions in the Tractor Operator's Manual.
3. Allow only responsible operators familiar with the instructions to operate the machine. Know the controls and how to stop tractor engine and mower quickly in an emergency.
4. Tractor must be equipped with Rollover Protective System (ROPS) and seat belt for all mower operations. Keep foldable ROPS systems locked in the up position at all times when operating the mower. Falling off or overturning a tractor can result in death from being run over or crushed.
5. Always wear seat belt on Rollover Protective System (ROPS) equipped tractors. Do not wear a seat belt if the tractor Rollover Protective System (ROPS) has been removed.
6. Wear personal protective equipment (PPE), such as, but not limited to, protection for eyes, ears, lungs, head, hair, hands and feet when operating, servicing, or repairing the equipment. Avoid wearing loose clothing or jewelry that may catch and entangle on equipment moving parts.
7. Stop tractor engine, place transmission in park (or neutral), engage parking brake, lower mower deck to ground, allow machine moving parts to stop, remove ignition key to prevent unauthorized person from starting tractor before servicing, repairing, or making adjustments to the equipment.
8. Never leave the tractor seat with the mower blades rotating, with the tractor in motion, or the engine running.
9. Use fender hand holds and steps when mounting and dismounting tractor to prevent falls. Keep steps and Operator's platform clean and free of debris.
10. Move and turn the tractor at low speeds. Avoid erratic operation and excessive speed.

- 
11. Keep the tractor in gear when traveling down hill.
  12. Do not mow near drop offs, ditches, or embankments. The tractor could suddenly over turn if a wheel travels over the edge of a ditch, or if an edge caves in.
  13. Add wheel ballast for stability when operating on slopes. Use extreme care when operating on slopes to maintain stability.
  14. Do not allow anyone but the operator on the tractor or mower. Never allow riders on tractor.
  15. Use extreme caution when loading or unloading the tractor and mower from a trailer or truck.

## **THE MOWER**

1. Do not operate the mower unless it is rigidly attached to the tractor. Failure to do so could result in serious injury or death and equipment damage.
2. Make sure spring activated locking collar on Drive Shaft slides freely and is seated firmly in tractor PTO spline groove.
3. Keep all shields and guards securely in place.
4. Never operate the mower with the discharge deflector in the raised position.
5. Stop tractor and mower immediately upon striking a foreign object. Exit tractor using proper technique and procedure. Inspect and repair any damage before continuing with mowing operation.
6. Stop tractor using proper procedure and wait until the mower blades come to a complete stop before unclogging discharge chute, making adjustments, or removing any grass or debris from mower deck.
7. Make sure all hardware is properly torqued before operating the tractor and mower. See torque chart specifications in this manual as well as the tractor manual. If none are available, contact your dealer for proper values.
8. Never adjust cutting height while tractor engine or mower is running.
9. Make sure all Safety Decals are installed, clean, and free of debris so they are readable. Replace if damaged or worn.
10. Wear gloves when installing belt. Be careful to prevent fingers from being caught between belt and pulleys.
11. Be careful when installing or removing belt from spring loaded idler. Springs store energy when extended and if released suddenly, can cause injury.

## **GENERAL OPERATION**

1. Know your controls. Read this operator's manual and the manual provided with your tractor. Learn how to stop the tractor, the engine, and the mower quickly in an emergency.
2. Watch overhead clearances carefully before driving under power lines, bridges, tree branches, or when exiting or entering buildings. These situations may allow the operator to be struck or pulled from the tractor, which could result in serious injury or death.
3. Do not put hands or feet under the mower deck or near rotating parts.
4. Always wear safety glasses with side shields or safety goggles during operation.

- 
5. Clear the area to be mowed of objects such as rocks, toys, wire, etc. which could be struck and thrown by the mower blades. A thrown object by the mower could travel in any direction and cause injury to the operator or a bystander. To help avoid injury, keep bystanders, children, and pets at least 75 feet from mower while in operation. Stop the mowing operation if anyone enters the area.
  6. Watch for hidden hazards in the area being cut during operation.
  7. Disengage the mower before shifting tractor into reverse and backing up. Always look down and behind before and while backing.
  8. Stop the mower blades when crossing gravel driveways, walks or roadways.
  9. Watch for traffic when operating near or crossing roadways.
  10. Never direct discharge towards people, pets or property.
  11. To avoid injury from thrown debris, never operate the mower when it is raised in the transport position.
  12. Never allow riders on tractor.
  13. Operate only in daylight or with good artificial light.
  14. Do not attempt to mow through unusually tall, dry grass or piles of dry leaves. Debris may build up on the mower deck or contact the tractor exhaust presenting a potential fire hazard.

## **SLOPE OPERATION**



**WARNING** – Slopes are a major factor leading to loss of control and tip over accidents, which can result in severe injury or death. All slopes require extra caution. If slopes are greater than 15 degrees, do not operate the mower on that area or serious injury or death could result.

1. Add wheel ballast for stability when operating on slopes. Use extreme care when operating on slopes to maintain stability.
2. Use extreme caution and reduce ground speed on slopes.
3. Do not stop, start, or change directions suddenly on slopes. If the tractor tires lose traction, stop mower and proceed slowly straight down the slope.
4. To prevent loss of control and overturning the tractor and mower, always mow up and down slopes, never across.
5. Do not operate or transport on steep slopes.
6. Do not mow on wet grass. Reduced traction could cause sliding on slopes.
7. Keep the tractor in gear when traveling down hill.

## **TRANSPORTATION**

1. Always engage lift lockouts before transporting the mower.
2. Never allow riders on tractor.
3. Always use accessory lights and devices when transporting on a road or highway to warn operators of other vehicles. Check your local government regulations.

- 
4. Be sure the Slow Moving Vehicle (SMV) emblem is visible to the rear. If the SMV sign is worn, faded, or damaged replace immediately.
  5. Use caution and reduce speed when transporting under adverse conditions, turning, or on inclines.
  6. Do not operate PTO during transport.

## **MAINTENANCE**

1. Protect your eyes – Wear Safety Glasses.
2. Never run the tractor and mower inside a closed area. Engine exhaust fumes can be lethal.
3. Always engage lift lockouts before servicing the mower.
4. Before performing any service work make sure hoists, floor jacks, and jack stands are in good working order and are properly rated to support the tractor and mower.
5. Do not work under the tractor or mower unless they are secured by a hoist and jack stands. Never place any body part underneath equipment or between moveable parts even after tractor has been turned off. Hydraulic system leak downs, hydraulic system failures, mechanical failures, or control lever movement can cause mower and tractor components to drop or rotate unexpectedly and cause serious injury or death.
6. Avoid injury, do not adjust, service, clean, or unclog the mower when the tractor engine is running.
7. Frequently check the mower blades. They must be sharp and free of nicks, cracks and securely fastened.
8. Do not handle mower blades with bare hands. Wear leather gloves or wrap blades in the area where they will be handled. Improper handling may result in serious injury.
9. Your Dealer can supply genuine replacement blades. Substitute blades may not meet original equipment specifications and may be dangerous if installed.
10. To reduce fire hazard, keep the tractor and mower free of grass, leaves, or other debris build up. Debris may build up on the mower deck or contact the tractor exhaust presenting a potential fire hazard.
11. Never alter safety devices. Check their proper operation regularly. Use all guards as instructed in this manual.
12. It is not recommended to use a pressure washer to clean the mower assembly. High pressure water may cause damage to spindles, pulleys, belts, or bearings shortening life and reducing serviceability.



### **AVOID HIGH-PRESSURE FLUIDS**

ESCAPING fluid under pressure can have sufficient force to penetrate the skin and cause serious injury. Be sure to stop engine and relieve all pressure before disconnecting lines. Be sure all connections are tight and that lines, pipes, and hoses are not damaged before applying pressure to the system. Fluid escaping from a very small hole can be almost invisible. Use a piece of cardboard or wood – not your hands – to search for suspected leaks.

SEE A DOCTOR at once if injured by escaping fluid. Serious infection or gangrene can develop if proper medical treatment is not administered immediately.

## SAFETY DECALS

The safety of the operator was the prime consideration in the design of the mower. Proper shielding, convenient controls, simple adjustments, and other safety features have been built into this implement. The following decals are located on the mower deck. Keep decals clean and replace them immediately if they are missing or damaged. Contact your dealer for replacements.

**⚠ DANGER**

	<b>STAND CLEAR</b> • DO NOT stand near mower when in operation.
	<b>ROTATING BLADES</b> • DO NOT put hands or feet under or into mower when engine is running.
	<b>THROWN OBJECTS</b> • Before mowing, clear area of bystanders and objects that may be thrown by mower blades.
	<b>DO NOT OPERATE MOWER</b> • DO NOT operate without entire grass discharge deflector in place or without entire grass catcher installed. • DO NOT ALLOW children to ride on mowing unit.

Failure to comply will result in death or serious injury.

102029

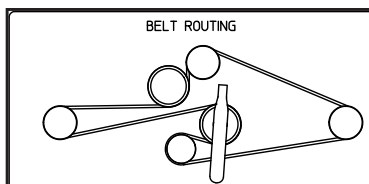

"A" HEIGHT OF CUT	"B" NO. OF HOLES
1"	4
1-3/4"	3
2-1/2"	2
3-1/4"	1
4"	0

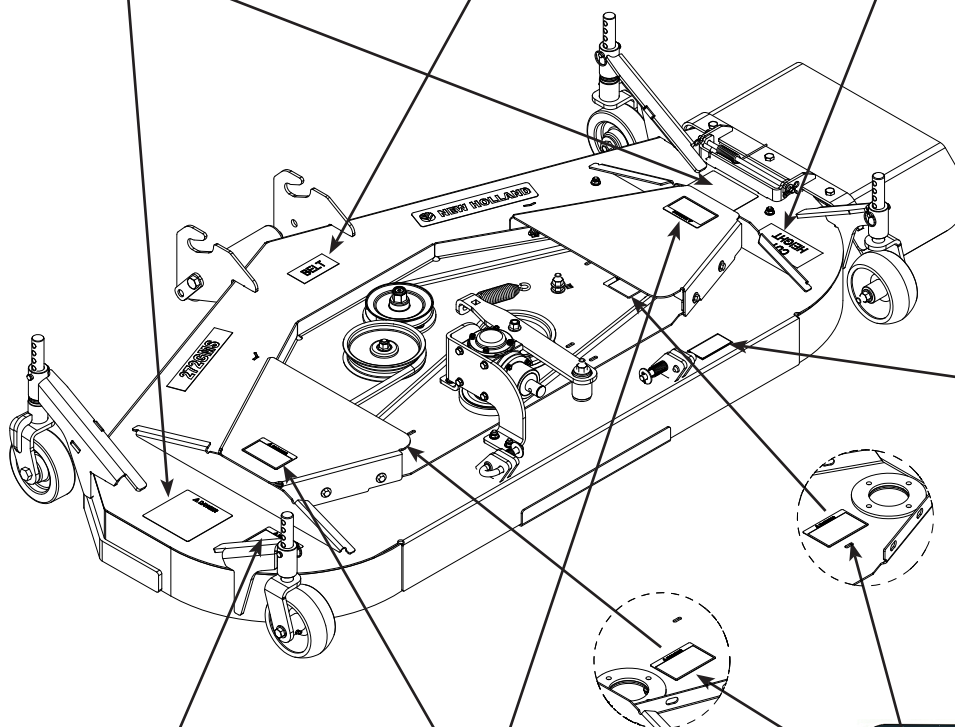

### SERIAL NUMBER INFORMATION

A product identification label is provided for your mower. The numbers on this label are important if your mower should require dealer service, or if you need additional information on the equipment. Prior to using the mower for the first time, record the numbers from the identification label in the appropriate spaces provided below.

MODEL NO. \_\_\_\_\_

SERIAL NO. \_\_\_\_\_

		CNH America LLC Racine, WI 53404 U.S.A. Made in U.S.A.
Model Number	272GMS	
Product Identification Number	*YCWWG0001*	

**⚠ WARNING**

- Before operating, read and understand all safety and instructional labels, as well as all safety precautions found in the Operator's Manual, on this machine.
- DO NOT modify, alter, or permit anyone else to modify or alter this equipment, including any of its components or operating functions.

Failure to comply could result in death or serious injury.

020356

**⚠ WARNING**

- Moving parts under this cover
- Do not open cover while operating.

Failure to comply could result in death or serious injury.

020356

**⚠ WARNING**

SHIELD MISSING / OPEN  
DO NOT OPERATE

Replace or close shield before operating machine. Failure to comply could result in death or serious injury.

020357

Thank you so much for reading.  
Please click the “Buy Now!”  
button below to download the  
complete manual.



After you pay.

You can download the most  
perfect and complete manual in  
the world immediately.

Our support email:

[ebooklibonline@outlook.com](mailto:ebooklibonline@outlook.com)