

ORIGINAL INSTRUCTIONS

OPERATOR'S MANUAL

I05LC

For Boomer™ 25 Compact
Front Loader

Part number 51562809

1st edition English
February 2019



Contents

1 GENERAL INFORMATION

Note to the Owner	1-1
Intended use.....	1-2
Product Identification Number (PIN).....	1-4
Operator's manual storage on the machine	1-5
Machine orientation.....	1-6
Machine components.....	1-7

2 SAFETY INFORMATION

Safety rules and signal word definitions	2-1
Safety rules.....	2-2
Do not operate tag.....	2-6
Ecology and the environment	2-7
Safety signs	2-8
Safety bar.....	2-13

3 CONTROLS AND INSTRUMENTS

Forward controls

Two-spool loader control valve lever	3-1
--	-----

4 OPERATING INSTRUCTIONS

Commissioning the unit

Machine preparation.....	4-1
Installing the loader.....	4-2
Installing the quick-attach bucket.....	4-7

Parking the unit

Removing the loader	4-9
Removing the quick-attach bucket	4-13

5 TRANSPORT OPERATIONS

Road transport

Transporting	5-1
--------------------	-----

6 WORKING OPERATIONS

General information

Operating the two-spool loader control valve.....	6-1
Bucket level indicator.....	6-2
Operating the loader.....	6-3
Ballast weight requirements	6-12
Ballast options	6-13

7 MAINTENANCE

General information

Basic instructions	7-1
Daily inspection	7-2
Consumables	7-3

Maintenance planning

Maintenance chart	7-4
-------------------------	-----

Every 8 hours or daily

Front loader and bucket - Check	7-4
Front loader and bucket - Grease	7-5

First 10 hours

Front loader and bucket - Check	7-6
---------------------------------------	-----

Every 25 hours

Front loader and bucket - Check	7-6
---------------------------------------	-----

8 TROUBLESHOOTING

Symptom(s)

Troubleshooting - Foreword	8-1
Front loader and bucket - Troubleshooting	8-1

9 SPECIFICATIONS

Loader specifications	9-1
Tire inflation pressures	9-3

10 FORMS AND DECLARATIONS

Pre-delivery report - Dealer's copy	10-1
Pre-delivery report - Owner's copy	10-3

1 - GENERAL INFORMATION

Note to the Owner

This manual contains information concerning the adjustment and maintenance of your new equipment. You have purchased a dependable machine, but only by proper care and operation can you expect to receive the performance and long service built into this equipment. Please have all operators read this manual carefully and keep it available for ready reference.

Your NEW HOLLAND dealer will instruct you in the general operation of your new equipment. (Refer to the 'Delivery Report' at the back of this manual.) Your dealer's staff of factory-trained service technicians will be glad to answer any questions that may arise regarding the operation of your machine. New Holland Top Service is also available. Call 1-866-NEWHLND (1-866-639-4563) or email na.topservice@cnh.com.

Your NEW HOLLAND dealer carries a complete line of genuine NEW HOLLAND service parts. These parts are manufactured and carefully inspected to insure high quality and accurate fitting of any necessary replacement parts. Be prepared to give your dealer the model and product identification number of your new equipment when ordering parts. Locate these numbers now and record them below. Refer to the 'General Information' section of this manual for the location of the model and product identification numbers of your machine.

PLEASE RECORD THE FOLLOWING INFORMATION

Loader Model

Product Identification Number (PIN)

Date Purchased

Attachment Model

Attachment Model



This is the safety alert symbol. It is used with and without signal words to alert you to potential personal injury hazards. Obey all safety messages that follow this symbol to avoid possible death or injury.

WARNING

Illustrations in this manual may show protective shielding open or removed to better illustrate a particular feature or adjustment.

Replace all shields before operating the machine.

Failure to comply could result in death or serious injury.

W0012A

Improvements

CNH America LLC is continually striving to improve its products. We reserve the right to make improvements or changes when it becomes practical and possible to do so, without incurring any obligation to make changes or additions to the equipment sold previously.

Intended use

CAUTION

Equipment failure could cause accident or injury!
Never exceed the maximum safe working load of the loader.
Failure to comply could result in minor or moderate injury.

C0161A

Your loader is designed and made to move material(s), dig, grade, and level, although within some physical limits. The working speed and performance may depend on a number of various parameters, such as weather and terrain conditions. Though the machine is designed to perform satisfactory in most materials and conditions, there may be a number of combinations of above parameters, for which there is severe degradation of performance of the machine. If you notice degradation of performance, contact your NEW HOLLAND dealer for assistance. He may have useful information for improvements, or a kit may be available to enhance the performance.

- The loader was designed to mount on NEW HOLLAND approved tractors. The loader is designed to load and move materials with a variety of buckets and approved NEW HOLLAND attachments.
- Do not use the machine for another purpose than intended by the manufacturer and outlined in this manual.
- Do not use the machine beyond its limits of terrain gradient and stability as outlined further in this manual. Using the machine beyond these limits may result in roll-over or tip-over. Observe the recommendations in this manual.
- Use only approved accessories and attachments that are designed for your machine. Consult your dealer on changes, additions or modifications that may be required for your machine. Do not make any unauthorized modifications to your machine.
- Do not use the machine near or on soft verges of canals and brooks or banks and verges that are undermined by rodents. The machine may sink sideways and roll-over.
- Do not use the machine on brittle bridge heads and poor bridge floors. These constructions may collapse and cause roll-over of the machine. Always check out the condition and carrying capacity of bridges and ramps prior to engage.
- Do not use the machine without wearing the seat restraint system during activities where roll-over or tip-over hazards exist. The Roll Over Protection Structure (ROPS) structure will only be fully effective when the driver remains attached to his seat.
- Do not use the machine beyond its limits of dynamic stability. High speed, abrupt maneuvers, and fast and short cornering will increase the risk of roll-over.
- Be cautious that the center of gravity of the machine may increase when loads on the bucket or attachment are raised. In these conditions, the machine may roll-over earlier than expected.
- You shall take the necessary precautions to always be aware of the possible presence of bystanders, certainly when maneuvering in confined areas, such as the farm yard and sheds. Keep people away from the machine during work; ask bystanders to leave the field. There is not only the risk to be overrun by the machine, but objects may be dropped from a loader. The path of the fallen objects are unknown. Keep bystanders away from the work area.
- Do not allow riders on the machine.
- A machine has only one operator station and is a one man operated vehicle. Other people on or around the machine during normal operation are not allowed.
- All persons who will be operating this machine shall possess a valid local vehicle operating permit and/or other applicable local age work permits.
- The machine is designed and produced exclusively for agricultural use.
- The machine is not designed for light/heavy forestry applications; usage is prohibited for forestry applications.
- All other use will be considered to be contrary to the use specified by CNH INDUSTRIAL AMERICA LLC, who cannot be held liable for damage to property or the machine, or for personal injuries which may result.
- Persons who risk improper use will therefore assume the responsibility for any consequences arising from such use.
- Compliance with the instructions for use, maintenance and repairs described in this manual, are the essential pre-conditions for the use specified by CNH INDUSTRIAL AMERICA LLC.

- The machine must only be used, serviced, or repaired by personnel trained in the relevant working methods and safety regulations and who have been authorized to work on the machine.
- The user must also observe the rules concerning general safety and accident prevention, including the Highway Code when driving on public highways.
- Any arbitrary modifications made to this machine will release CNH INDUSTRIAL AMERICA LLC from any liability resulting from damage or injury.
- CNH INDUSTRIAL AMERICA LLC and all its distribution organizations, inclusive of, but not restricted to, national, regional, or local distributors, cannot be held liable for damage resulting from the malfunction of parts and/or components not approved by CNH INDUSTRIAL AMERICA LLC.
- Under no circumstances will a guarantee be issued for products made or sold by CNH INDUSTRIAL AMERICA LLC that are damaged as a result of the malfunction of parts and/or components not approved by CNH INDUSTRIAL AMERICA LLC.

Product Identification Number (PIN)

Product identification plate

A product identification plate (1) is located on the inside of the left-hand loader arm.

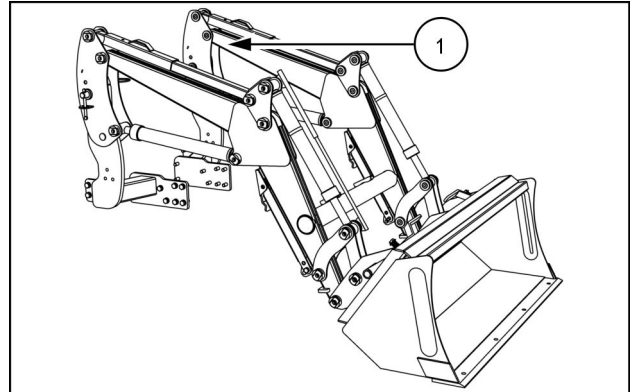

NHIL19CT00081AA 1

The identification numbers on this plate are important in the event that your loader should require future service.

CNH INDUSTRIAL		NEW HOLLAND AGRICULTURE	
Model Name			
Serial Number			
Production Date			
Max. Lift Capacity			
Safety Working Load			
F/Loader Weight			

CNH Industrial America LLC, Racine, WI 53404 USA CE

40407417/00

NHIL19CT00087AA 2

Operator's manual storage on the machine

There is no operator's manual storage on the machine.
Keep the operator's manual in a safe place and have it
available for use by all operators.

Machine orientation

NOTE: On this equipment, left-hand and right-hand are determined by standing behind the unit, looking in the direction of travel.

Left-hand view

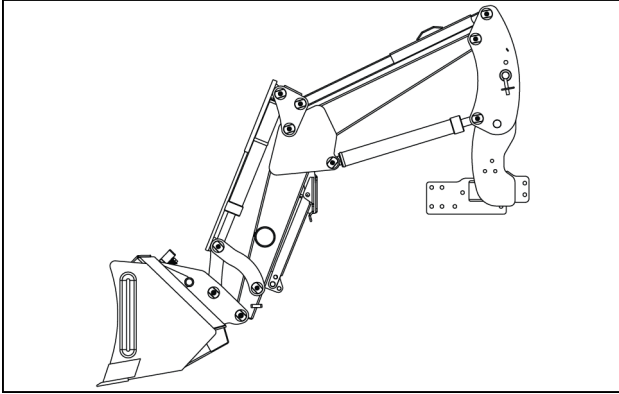

NHIL18CT00677AA 1

Right-hand view

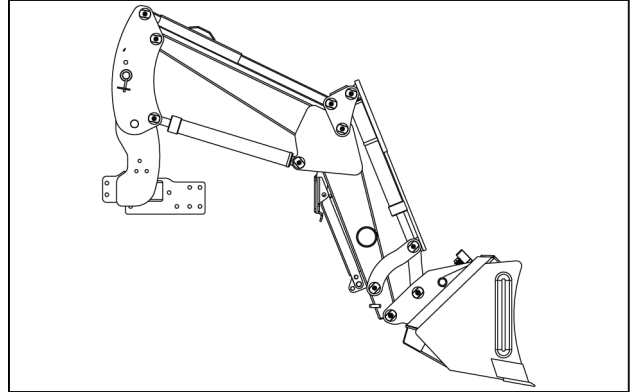

NHIL18CT00674AA 2

Rear view

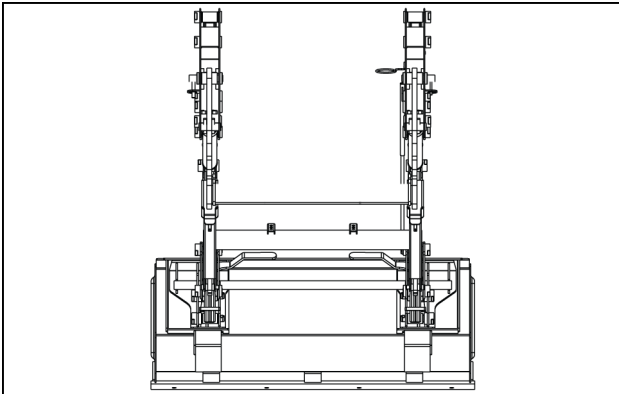

NHIL18CT00676AA 3

Front view

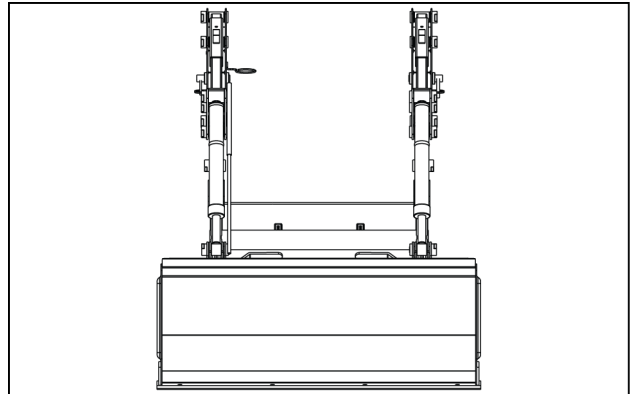

NHIL18CT00673AA 4

Machine components

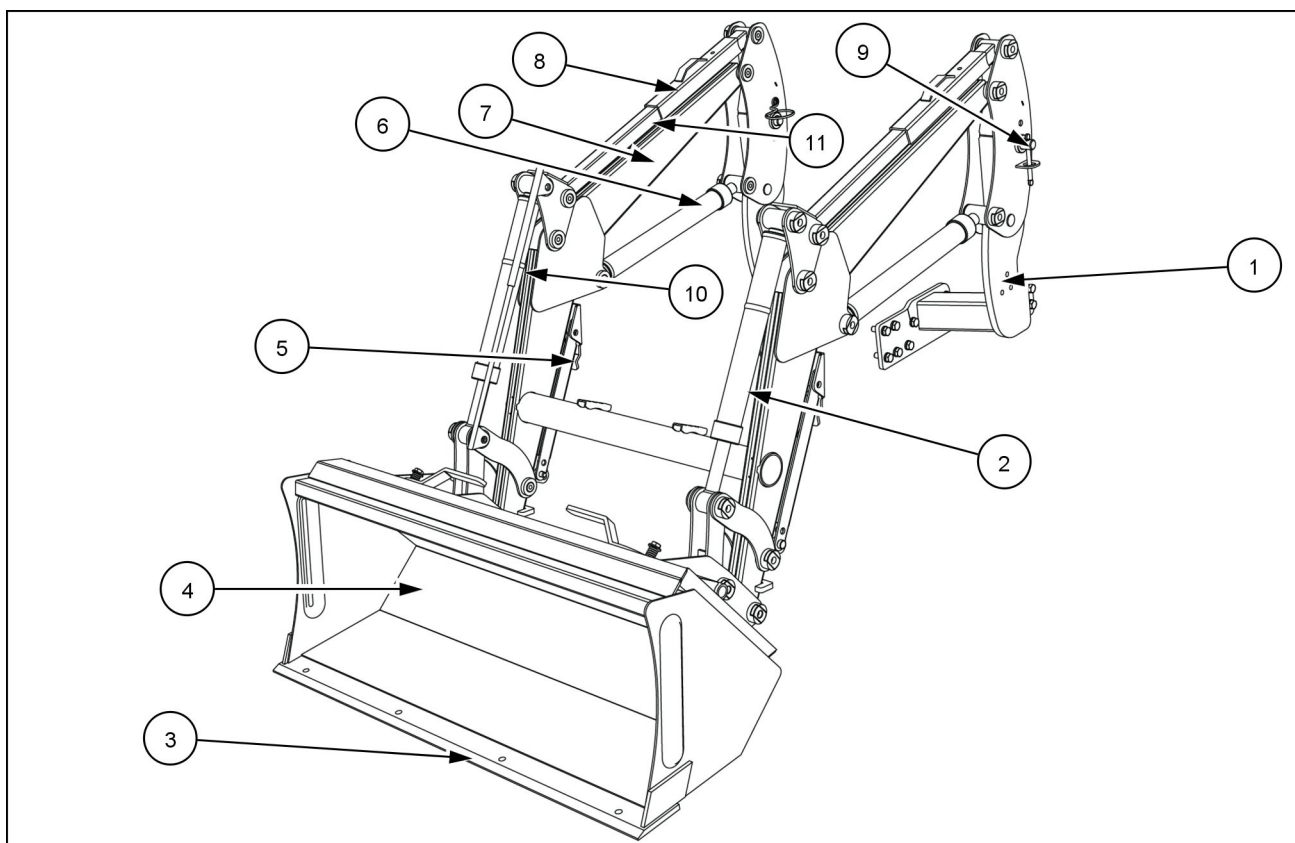

NHIL19CT00070FA 1

Machine components	
(1) Loader tower	(6) Boom cylinder
(2) Bucket cylinder	(7) Loader arm
(3) Cutting edge	(8) Safety bar
(4) Bucket	(9) Mounting pin
(5) Parking stand	(10) Bucket position gauge
	(11) Self leveling arm

2 - SAFETY INFORMATION

Safety rules and signal word definitions

Personal safety





This is the safety alert symbol. It is used to alert you to potential personal injury hazards. Obey all safety messages that follow this symbol to avoid possible death or injury.

Throughout this manual you will find the signal words DANGER, WARNING, and CAUTION followed by special instructions. These precautions are intended for the personal safety of you and those working with you.

Read and understand all the safety messages in this manual before you operate or service the machine.

 DANGER indicates a hazardous situation that, if not avoided, will result in death or serious injury.

 WARNING indicates a hazardous situation that, if not avoided, could result in death or serious injury.

 CAUTION indicates a hazardous situation that, if not avoided, could result in minor or moderate injury.

FAILURE TO FOLLOW DANGER, WARNING, AND CAUTION MESSAGES COULD RESULT IN DEATH OR SERIOUS INJURY.

Machine safety

NOTICE: Notice indicates a situation that, if not avoided, could result in machine or property damage.

Throughout this manual you will find the signal word Notice followed by special instructions to prevent machine or property damage. The word Notice is used to address practices not related to personal safety.

Information

NOTE: Note indicates additional information that clarifies steps, procedures, or other information in this manual.

Throughout this manual you will find the word Note followed by additional information about a step, procedure, or other information in the manual. The word Note is not intended to address personal safety or property damage.

Thank you so much for reading.
Please click the “Buy Now!”
button below to download the
complete manual.



After you pay.

You can download the most
perfect and complete manual in
the world immediately.

Our support email:

ebooklibonline@outlook.com