

m-3786

# **NEW HOLLAND**

## **44" Snowthrower**

# **OPERATOR'S MANUAL**

For Garden Tractors  
Model No.  
716505006—T9BL0001 & Up



**NEW HOLLAND**

**SERVICE**

Publication Number:  
86602580 4/2000

Reprinted

# Introduction

Thank you for purchasing a New Holland product.

All of us at New Holland want you to be completely satisfied with your new product, so feel free to contact your local Authorized Service Dealer for help with service, genuine replacement parts, or other information you may require.

Whenever you contact your Authorized Service Dealer or the factory, always know the model and serial numbers of your product. These numbers will help the Service Dealer or Service Representative provide exact information about your specific product. You will find the model and serial number plate located in a unique place on the product as shown below.

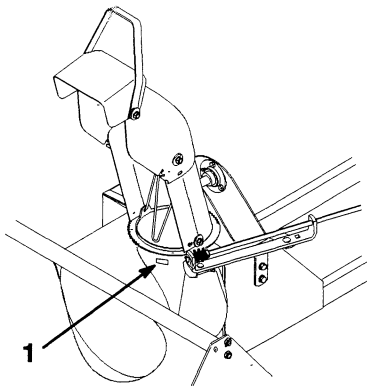

m-3732

1. Model and Serial Number Plate

For your convenience, write the product model and serial numbers in the space below.

 <b>NEW HOLLAND</b>	
<b>MODEL NO.</b>	<b>SERIAL NO.</b>
<b>COMPONENT</b>	
<b>NEW HOLLAND NORTH AMERICA, INC.</b>	
<small>MADE IN U.S.A.</small>	

Read this manual, and all related equipment manuals, carefully to learn how to operate and maintain your product correctly. Reading this manual will help you and others avoid personal injury and damage to the product. Although we design, produce and market safe, state-of-the-art products, you are responsible for using the product properly and safely. You are also responsible for training persons, who you allow to use the product, about safe operation.

The warning system in this manual identifies potential hazards and has special safety messages that help you and others avoid personal injury, even death. **DANGER**, **WARNING** and **CAUTION** are signal words used to identify the level of hazard. However, regardless of the hazard, be extremely careful.

**DANGER** signals an extreme hazard that will cause serious injury or death if the recommended precautions are not followed.

**WARNING** signals a hazard that may cause serious injury or death if the recommended precautions are not followed.

**CAUTION** signals a hazard that may cause minor or moderate injury if the recommended precautions are not followed.

Two other words are also used to highlight information. “Important” calls attention to special mechanical information and “Note” emphasizes general information worthy of special attention.

The left and right side of the machine is determined by sitting on the seat in the normal operator’s position.

# Contents

	<b>Page</b>		<b>Page</b>
Safety and Instruction Decals .....	2	Maintenance .....	20
Installation .....	3	Service Interval Chart .....	20
Loose Parts .....	3	Greasing and Lubrication .....	20
Assembling the Snowthrower .....	4	Replacing the Snowthrower Belt .....	22
Setting Up the Tractor .....	6	Adjusting the Skids .....	24
Installing the Snowthrower on the Tractor ..	7	Replacing the Scraper Blade .....	24
Removing the Snowthrower .....	12	Adjusting Drive Chain Tension .....	25
Operation .....	16	Storage .....	25
Operating the Power Take Off (PTO) .....	16		
Operating the Attachment Lift Lever .....	17		
Adjusting The Discharge Chute .....	18		
Tips for Throwing Snow .....	18		

## Safety and Instruction Decals



Safety decals and instructions are easily visible to the operator and are located near any area of potential danger. Replace any decal that is damaged or lost.

**ON UPPER DISCHARGE  
CHUTE**  
(Part No. TR94D8079)



**ON TOP OF HOUSING**  
(Part No. TR92D8652)



**(2) ON TOP OF HOUSING**  
(Part No. TR63D2380)



**ON TOP OF PULLEY COVER**  
(Part No. TR98D8705)



# Installation

## Loose Parts

**Note:** A rear-mount quick attach hitch and rear wheel weights and chains, all of which must be purchased separately, are required to operate the tractor equipped with this snowthrower. Use the chart below to identify parts used for assembly.

DESCRIPTION	QTY.	USE
Snowthrower frame assembly	1	Attach lift tube
Lift tube	1	
Clevis pin 1/2 in. x 2 5/8 in. (67 mm)	1	
Clevis clip	1	
Discharge chute assembly	1	Assemble discharge chute
Washer 5/16 in. (8 mm)	3	
Locknut 5/16 in.	3	
Carriage bolt 5/16-18 x 3/4 in. (19 mm)	3	
Clevis pin 3/8 in. x 1 in. (25 mm)	2	Prepare tractor attachment lift
Hairpin cotter—small	2	

Thank you so much for reading.  
Please click the “Buy Now!”  
button below to download the  
complete manual.



After you pay.

You can download the most  
perfect and complete manual in  
the world immediately.

Our support email:

[ebooklibonline@outlook.com](mailto:ebooklibonline@outlook.com)