

NEW HOLLAND

48" Snow Blade

OPERATOR'S MANUAL

For
LS Yard Tractors
Model No.
715648006-T1S0001 & Up



NEW HOLLAND

SERVICE

Contents

	Page
Introduction	2
Assembly	3
Loose Parts	3
Assembling the Blade	4
Setting Up the Tractor	4
Installing the Blade	5
Removing the Blade	8
Operation	9
Raising and Lowering the Blade	9
Adjusting Dial-A-Height	10
Adjusting the Blade Angle	10
Adjusting the Blade Trip Springs	10
Tips for Using the Blade	11
Maintenance	11
Recommended Maintenance Schedule	11
Greasing and Lubrication	11
Reversing the Scraper Blade	12
Storage	12

For your convenience, write the product model and serial numbers in the space below.

Model No: _____
Serial No. _____

Read this manual carefully to learn how to operate and maintain your product correctly. Reading this manual will help you and others avoid personal injury and damage to the product. Although we design, produce and market safe, state-of-the-art products, you are responsible for using the product properly and safely. You are also responsible for training persons, who you allow to use the product, about safe operation.

The warning system in this manual identifies potential hazards and has special safety messages that help you and others avoid personal injury, even death. **Danger**, **Warning**, and **Caution** are signal words used to identify the level of hazard. However, regardless of the hazard, be extremely careful.

Danger signals an extreme hazard that will cause serious injury or death if the recommended precautions are not followed.

Warning signals a hazard that may cause serious injury or death if the recommended precautions are not followed.

Caution signals a hazard that may cause minor or moderate injury if the recommended precautions are not followed.

Two other words are also used to highlight information. **Important** calls attention to special mechanical information, and **Note** emphasizes general information worthy of special attention.

Determine the left and right side of the machine from the normal operating position.

Introduction

Thank you for purchasing a New Holland product.

All of us at New Holland want you to be completely satisfied with your new product, so feel free to contact your local Authorized Service Dealer for help with service, genuine replacement parts, or other information you may require.

Whenever you contact your Authorized Service Dealer or the factory, always know the model and serial numbers of your product. These numbers will help the Service Dealer or Service Representative provide exact information about your specific product. You will find the model and serial number plate at the location shown in Figure 1.

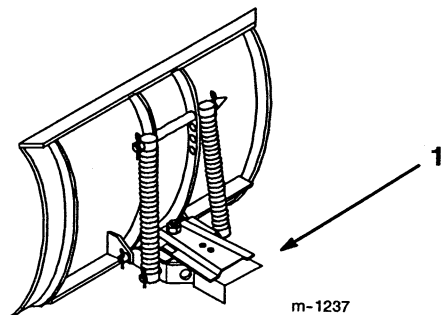

Figure 1

1. Model and serial number plate

Assembly

Loose Parts

Note: Use the chart below to identify parts used for assembly.

DESCRIPTION	QTY.	USE
Blade assembly	1	Assemble the blade to the frame
Rod	1	
Control rod	1	
Cotter pin, 1/8 x 1 in. (25 mm)	2	
Frame assembly	1	
Bolt, 3/4-16 x 3-3/4 in. (95 mm)	1	
Locknut, 3/4 in.	1	
Front hitch assembly	1	Install the front hitch to the tractor
Carriage bolt, 3/8-16 x 1 in. (25 mm)	4	
Locknut, 3/8 in.	4	
Rear hitch assembly	1	Install the rear hitch to the tractor
Bolt, 1/2-13 x 1-1/4 in. (32 mm)	3	
Locknut, 1/2 in.	3	
Lift plate	1	Install the lift plate and lift rod
Trunnion	1	
Lift rod	1	
Washer, 9/16 in.	1	
Hairpin cotter, large	1	
Hairpin cotter, medium	1	
Spindle stop	2	Install the steering spindle stop
Self tapping bolt, 5/16-18 x 3/4 in. (19 mm)	2	
Control handle assembly	1	Assemble the control handle and control rod to the frame
Pivot bolt, 1/2-13 x 1 in. (25 mm)	1	
Jam nut, 1/2 in.	1	
Hairpin cotter, large	1	
Cable clip	3	
Bolt, 1/4 x 1 in. (25 mm)	3	
Locknut, 1/4-20	3	
Cable	1	
Cable bracket	1	
Cotter pin, 1-1/4 in (32 mm)	1	

Assembling the Blade

1. Lift and rotate the channel and trip spring assembly so that the holes align with the lower blade mounts.
2. Slide the rod through the holes and secure with two 1 in. (25 mm) cotter pins (Fig. 2).

Note: If you have difficulty sliding the rod through the holes, partially remove the upper rod and use a hammer to drive the rod through. Then, install the upper rod.

3. Bend the ends of the cotter pins to secure the rod.

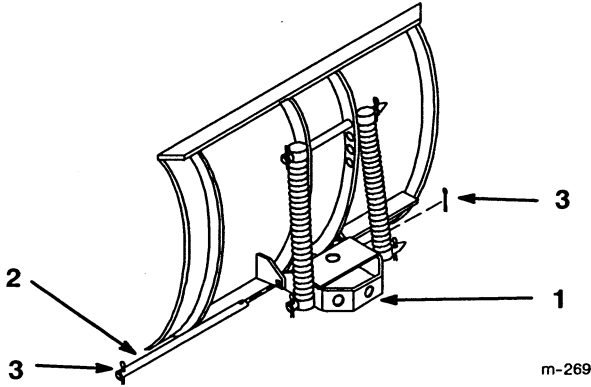

Figure 2

- | | |
|------------|------------------------------------|
| 1. Channel | 3. Cotter pin, 1/8 x 1 in. (25 mm) |
| 2. Rod | |

4. Insert the end of the control rod without the welded washer through the 1/2 in. (13 mm) hole in the bottom plate of the channel (Fig. 3).

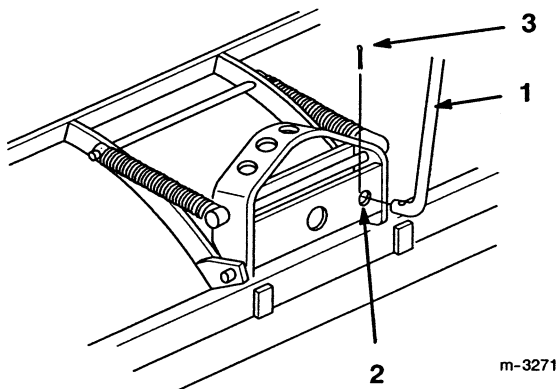

Figure 3

- | | |
|-------------------------|------------------------------------|
| 1. Control rod | 3. Cotter pin, 1/8 x 1 in. (25 mm) |
| 2. 1/2 in. (13 mm) hole | |

5. Insert a 1/8 x 1 in. (25 mm) cotter pin through the hole in the rod and bend the ends of the pin (Fig. 3).
6. Apply general purpose grease to the pivot area of the frame and channel.

7. Slide the channel between the frame mount and secure it with a 3/4-16 x 3-3/4 in. (95 mm) bolt and a 3/4 in. locknut (Fig. 4).

Note: Insert the bolt up from the underside of the frame (Fig. 4).

Important Do not tighten the nut and bolt excessively, thereby causing binding on the channel as it pivots from side to side.

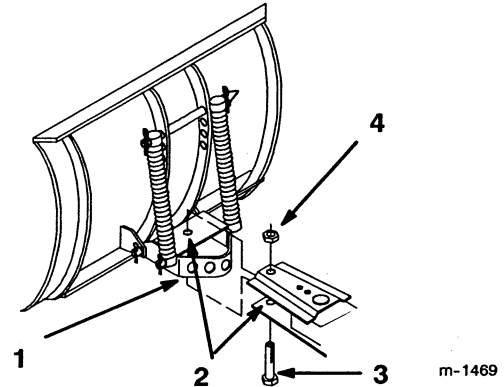

Figure 4

- | | |
|----------------|-------------------------------------|
| 1. Channel | 3. Bolt, 3/4-16 x 3-3/4 in. (95 mm) |
| 2. Grease here | 4. Locknut, 3/4 in. |

Setting Up the Tractor

Installing the Front Hitch

1. Remove the E-ring and all washers except one thick washer from the front axle pivot pin of the tractor (Fig. 5).

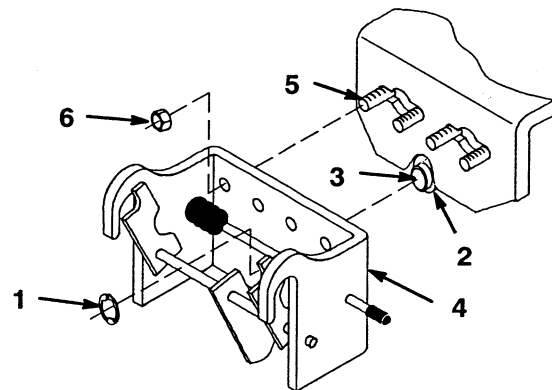

Figure 5

- | | |
|----------------------------|--|
| 1. E-ring | 5. Carriage bolt, 3/8-16 x 1 in. (25 mm) |
| 2. Thick washer (existing) | 6. Locknut, 3/8 in. |
| 3. Axle pivot | |
| 4. Front hitch | |

2. Discard the unused washers.

Thank you so much for reading.
Please click the “Buy Now!”
button below to download the
complete manual.



After you pay.

You can download the most
perfect and complete manual in
the world immediately.

Our support email:

ebooklibonline@outlook.com