

NEW HOLLAND TV145

87639930 2/07
Replaces 87575449

OPERATOR'S MANUAL

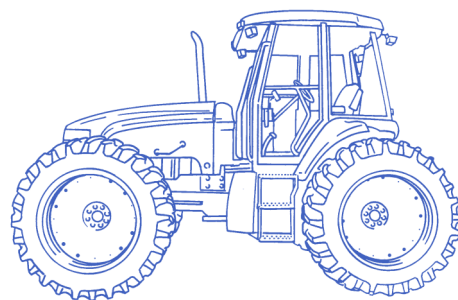

TO THE OWNER

The warranty coverage that is extended to your tractor is explained in the Warranty and Limitation of Liability form. Your dealer will provide you with a copy of the warranty and retain a copy which you have signed. After you read the warranty, ask your dealer to explain any points that you may not understand.

This tractor was designed to power and propel itself. It is intended for use in normal and customary agricultural, municipal and light duty industrial applications.

Do not modify or alter or permit anyone else to modify or alter this tractor or any of its components or any tractor function without first consulting an authorized New Holland dealer. If you have any questions regarding tractor modification, contact New Holland North America, Inc., 500 Diller Ave., New Holland, PA 17557.

A safety cab incorporating a Roll Over Protection Structure (ROPS) and a seat belt were standard equipment for the tractor at the time of factory assembly. If the safety cab/ROPS has been modified or removed by the original purchaser, it is recommended that you equip your tractor with a safety cab/ROPS and seat belt. A safety cab/ROPS is effective in reducing injuries during tractor overturn accidents. Overturning a tractor without a ROPS can result in serious injury or death. Safety cab/ROPS and seat belts are available for your tractor. If your tractor is not equipped with a safety cab/ROPS and seat belt, see your New Holland dealer.

Your safety and the safety of those around you depends upon the care and good judgement you use while operating this equipment. Read the safety precautions carefully.

For a complete list of the delivery service checks performed by your dealer, refer to DELIVERY REPORT in this manual. The first copy is your record of the service performed and the second copy, which is to be removed from the manual, is your dealer's record. **MAKE SURE THAT YOU AND THE DEALER SIGN BOTH COPIES.**

After you have operated the tractor for 50 hours, take your tractor and this manual to your selling dealer. He will perform the factory recommended 50-hour service. You will be responsible for the cost of lubricants, fluids, filters and other items replaced as part of normal maintenance. Prior to taking the tractor to your selling dealer for service, it is recommended that you contact them to determine any other charges for which you may be responsible.

All data given in this book is subject to production variations. Dimensions and weights are approximate only and the illustrations do not necessarily show tractors in standard condition. For exact information about any particular tractor please consult your New Holland dealer. Refer to the General Information Section of this manual for location of the model and serial numbers of your tractor.

Model _____ Engine Model _____

P.I.N. _____ Engine Serial Number _____



CAUTION



CAUTION: THIS SYMBOL IS USED THROUGHOUT THIS BOOK WHENEVER PERSONAL SAFETY IS INVOLVED. TAKE TIME TO READ AND FOLLOW THE INSTRUCTIONS. BE CAREFUL!



CAUTION



CAUTION: PICTURES IN THIS MANUAL MAY SHOW PROTECTIVE SHIELDING OPEN OR REMOVED TO BETTER ILLUSTRATE A PARTICULAR FEATURE OR ADJUSTMENT.

BE CERTAIN, HOWEVER, TO CLOSE OR REPLACE ALL SHIELDING BEFORE OPERATING THE MACHINE.

IMPROVEMENTS

New Holland North America, Inc. is continually striving to improve its products. We reserve the right to make improvements or changes when it becomes practical and possible to do so, without incurring any obligation to make changes or additions to the equipment sold previously.

CONTENTS

SAFETY	0-4
GENERAL INFORMATION	1-1
OPERATION	2-1
LUBRICATION AND MAINTENANCE	3-1
TROUBLESHOOTING	4-1
OPTIONAL EQUIPMENT	5-1
SPECIFICATIONS	6-1
INDEX	6-11
FIRST 50-HOUR SERVICE	6-15
DELIVERY REPORT	6-19

FEDERAL EMISSIONS WARRANTY

(California owner's emissions warranty is covered elsewhere)

New Holland warrants that your new 1996 and later heavy-duty off-road diesel engine was designed, built, and equipped to conform to applicable U.S. Environmental Protection Agency regulations for a period of use of five years or 3,000 hours of operation, whichever occurs first.

The new model year, class of diesel engine, and emission application determination for your engine are identified on the emission control information label affixed to the top of your engine's rocker arm cover. The warranty period begins on the date the new equipment is sold to the first retail purchaser.

Any emission control system parts which are proven defective during normal use will be repaired or replaced during the warranty period. The warranty repairs and service will be performed by any authorized New Holland dealer at the dealer's place of business, with no charge for parts or labor (including diagnosis).

As the engine owner, you are responsible to perform all the required maintenance listed in your owner's manual. New Holland will not deny an emission warranty claim solely because you have no record of maintenance; however, a claim may be denied if your failure to perform maintenance resulted in the failure of a warranted part. Receipts covering regular maintenance should be retained in the event of questions and these receipts should be passed on to each subsequent owner of the engine.

It is recommended replacement parts used for maintenance or repairs be New Holland Service Parts to maintain the quality originally designed into your emission certified engine. The use of non-New Holland parts does not invalidate the warranty on other components unless the use of such parts causes damage to warranted parts.

New Holland wishes to assure the emission control systems warranty is being properly administered. If you believe you have not received the service entitled to under this warranty, you should contact the nearest New Holland Branch Office for assistance. The address and phone number of each Branch Office is in your vehicle owner's manual. If additional assistance or information is needed, contact:

Service Department
New Holland North America, Inc.
500 Diller Avenue
New Holland, PA 17557
(717) 355-1121

Please note that the Emission Warranty does not cover:

1. Systems and parts that were not first installed on the new equipment or engine as original equipment by New Holland.
2. Part malfunctions caused by abuse, misuse, improper adjustment, modification, alteration, tampering, disconnection, improper or inadequate maintenance, or use of non-recommended fuels and lubricating oils.
3. Accident caused damage, acts of nature, or other events beyond New Holland's control.
4. Replacement of expendable items made in connection with scheduled maintenance.
5. Parts requiring replacement, inspection or adjustment maintenance intervals for reasons other than being defective.
6. Parts which are not New Holland Service Parts.
7. Loss of time, inconvenience, loss of use of equipment/engine or commercial loss.
8. Equipment with altered or disconnected hourmeter where the hours cannot be determined.
9. Equipment normally operated outside the United States.
10. Non-defective parts replaced by other than New Holland dealers.

Coverage

This emission control system warranty applies to the following emission control parts.

Fuel Injection Pump
Fuel Injectors
Turbocharger
Intake Manifold
Exhaust Manifold
Boost Pressure Tubing-connection to Aneroid Device ON F.I.P.

CALIFORNIA EMISSION CONTROL WARRANTY STATEMENT (California Only)

Your Warranty Rights and Obligations

The California Air Resources Board and New Holland are pleased to explain the emission control system warranty on your engine. In California, new 1997 and later heavy-duty off-road engines from 100 to 150 HP must be designed, built, and equipped to meet the State's stringent anti-smog standards. New Holland must warrant the emission control system on your engine for the periods of time listed below, provided there has been no abuse, neglect, or improper maintenance of your engine.

Your emission control system includes parts such as the fuel injection system and the air induction system.

Where a warrantable condition exists, New Holland will repair your heavy-duty off-road engine at no cost to you, including diagnosis, parts, and labor.

Manufacturer's Warranty Coverage:

The 1997 and later heavy-duty off-road engines are warranted from the original date of delivery for five years or 3,000 hours of operation, whichever occurs first. If any emission-related part on your engine is defective, the part will be repaired or replaced by New Holland.

Owner's Warranty Responsibilities:

- As the heavy-duty off-road engine owner, you are responsible for the performance of the required maintenance listed in your owner's manual. New Holland recommends that you retain all receipts covering maintenance on your heavy-duty off-road engine, but New Holland cannot deny warranty solely for the lack of receipts or for your failure to ensure the performance of all scheduled maintenance.
- As the heavy-duty off-road engine owner, you should, however, be aware that New Holland may deny you warranty coverage if your heavy-duty off-road engine or a part has failed due to abuse, neglect, improper maintenance, or unapproved modifications.
- Your engine is designed to operate on commercially available diesel fuel only. Use of any other fuel may result in your engine no longer operating in compliance with California's emissions requirements.
- You are responsible for initiating the warranty process. The ARB suggests that you present your heavy-duty off-road engine to a New Holland dealer as soon as a problem exists. The warranty repairs should be completed by the dealer as expeditiously as possible.

If you have questions regarding your warranty rights and responsibilities, you should contact your Branch Office at the address and phone number listed on the Owner Assistance page of your equipments operator manual.

- Prior to the expiration of the warranty, you must give notice of any failure of an emission control warranted part. Such notice must be given to New Holland or an authorized dealer, and you must deliver the engine to the repair location.
- You, the owner, are responsible for incidental costs incurred by yourself or your employees as a result of a warrantable failure. Examples of such costs are communication expenses, meals and lodging.
- The owner is responsible for any business costs or losses, any "downtime" expenses and any "cargo" damage which result from the failure of a warranted part. New Holland is not responsible for other incidental or consequential damages, including but not limited to fines, theft, vandalism or collisions.

Parts covered:

This emission control system warranty applies to the following emission control parts.

Fuel Injection Pump
Fuel Injectors
Turbocharger
Intake Manifold
Exhaust Manifold
Boost Pressure Tubing-connection to Aneroid Device ON F.I.P.

Any replacement part, equivalent in performance and durability, may be used in the performance of any maintenance or repairs and must be provided without charge to the owner. The use of these parts does not reduce the warranty obligations of New Holland. However, New Holland recommends the use of new, genuine New Holland service parts or New Holland approved rebuilt parts and assemblies. New Holland also recommends that the engine be serviced by a New Holland authorized dealer.

New Holland Responsibilities

Warranty work will be provided at no charge to the owner at any authorized dealer, using new genuine New Holland service parts or New Holland approved rebuilt parts or assemblies..

The owner will not be charged for diagnostic labor which leads to the determination that a warranted part is defective, if the diagnostic work was performed at a warranty station.

New Holland is liable for damages to other engine components caused by the failure under warranty of any warranted part.

Warranty Limitations

New Holland is not responsible for failures resulting from abuse or neglect by owner or operator.

New Holland warrants to the ultimate purchaser and each subsequent purchaser that the engine is designed, built, and equipped so as to conform with all applicable regulations adopted by the Air Resources Board, and that it is free from defects in materials and workmanship which cause the failure of a warranted part.

Any warranted part which is not scheduled for replacement as required maintenance, or which is scheduled only for regular inspection to the effect of "repair or replace as necessary" is warranted for the warranty period.

Any warranted part which is scheduled for replacement as required maintenance is warranted for the period of time prior to the first scheduled replacement point for that part.

New Holland is liable for damages to other engine components caused by the failure under warranty of any warranted part.

(California Only)

CALIFORNIA

Proposition 65 Warning

Diesel engine exhaust and some of its constituents are known to the State of California to cause cancer, birth defects, and other reproductive harm.

Battery posts, terminals and related accessories contain lead and lead compounds, chemicals known to the State of California to cause cancer and birth defects or other reproductive harm. Wash hands after handling.

SECTION 0 SAFETY

PERSONAL SAFETY

Throughout this manual and on machine decals, you will find precautionary statements (“**DANGER**”, “**WARNING**”, and “**CAUTION**”) followed by specific instructions. These precautions are intended for the personal safety of you and those working with you. Please take the time to read them.



DANGER



This word “**DANGER**” indicates an immediate hazardous situation that, if not avoided, will result in death or serious injury. The color associated with Danger is **RED**.



WARNING



This word “**WARNING**” indicates a potentially hazardous situation that, if not avoided, could result in death or serious injury. The color associated with Warning is **ORANGE**.



CAUTION



This word “**CAUTION**” indicates a potentially hazardous situation that, if not avoided, may result in minor or moderate injury. It may also be used to alert against unsafe practices. The color associated with Caution is **YELLOW**.

FAILURE TO FOLLOW THE “DANGER”, “WARNING”, AND “CAUTION” INSTRUCTIONS MAY RESULT IN SERIOUS BODILY INJURY OR DEATH.

MACHINE SAFETY

IMPORTANT: *The word “IMPORTANT” is used to inform the reader of something he needs to know to prevent machine damage if a certain procedure is not followed.*

INFORMATION

NOTE: *Instructions used to identify and present supplementary information.*

PRECAUTIONARY STATEMENTS

National Safety Council statistics indicate many people die or suffer serious injury each year as a result of farm accidents.

Don't become a statistic or victim.

Carefully review the procedures given in this manual with all operators ANNUALLY. It is important that all operators be familiar with AND FOLLOW safety precautions.

Operating instructions must be given to everyone using the tractor before operation and at least once yearly thereafter in compliance with OSHA Regulation 1928.57 (United States).

A careful operator is the best operator. Most accidents can be avoided by observing certain precautions. To help prevent accidents, read and take the following precautions before operating the tractor. Equipment should be operated only by those who are responsible and instructed to do so.

THE TRACTOR

1. Read the Operator's Manual carefully before using the tractor. Lack of operating knowledge can lead to accidents.
2. Allow only properly trained and qualified persons to operate the tractor. All persons training to operate, or who will be operating this tractor, should be old enough to possess a valid local vehicle operating permit (or other applicable local age requirement) and must have demonstrated the ability to operate and service the tractor correctly and safely.
3. Do not permit anyone but the operator to ride on the tractor. There is no safe place for extra riders.
4. Replace all missing, illegible or damaged safety decals.
5. Keep safety decals free of dirt or grime.
6. Do not modify, alter or permit anyone else to modify or alter the tractor or any of its components or any tractor function without first consulting an authorized New Holland dealer.
7. Install all shields before starting or operating the tractor.
8. To provide a better view, certain photos and illustrations in this manual show safety shields removed. It is important that the machine never be operated this way. Keep all shields in place.
9. Never jump from the tractor. There is a danger of catching clothing on protruding parts.
10. Always disengage the differential locks when driving the tractor on the road.

DRIVING THE TRACTOR

1. Always sit in the driver's seat with the seat belt buckled while starting or driving the tractor.
2. Lock the rotating seat console in position and buckle the seat belt before operating the tractor.
3. When driving on public roads, have consideration for other road users. Pull to the side of the road so that any following traffic may pass.
4. Dim the tractor lights when meeting a vehicle at night. Make sure the lights are adjusted to prevent blinding the driver of an oncoming vehicle.
5. The tractor is equipped with a hydrostatic transmission which can provide dynamic braking. Slowly move the hydrostatic control lever to the neutral position.
6. Reduce ground speed before turning or applying the brakes.
7. Any towed vehicle whose total weight exceeds that of the towing tractor must be equipped with brakes for safe operation.
8. Always check overhead clearance, especially when transporting the tractor. Watch where you are going, especially at row ends, on roads and around trees and low overhanging obstacles.
9. Never apply the differential locks when turning. When engaged, the differential lock will increase the effort required to turn the tractor and increase the turning radius.
10. When operating over rough ground, reduce speed to maintain complete control.

SECTION 0 – SAFETY

11. Keep the tractor in the same transmission range when going downhill as would be used when going uphill.
12. When descending steep grades, select a sufficiently slow speed to maintain control with minimum braking.
13. Drive the tractor slowly on hillsides and curves to eliminate the danger of tipping. Avoid slopes which are too steep for safe operation. Avoid sharp uphill turns.
14. When driving out of a ditch, gully or up a steep hillside, engage the hydrostatic control lever slowly. Avoid sharp uphill turns.
15. Avoid driving near the edge of a ditch or gully. It may cave in, causing the tractor to roll over.
16. Before transporting the tractor and implement on public roadways, check with authorities for local regulations.
17. Equip towed implements with slow-moving vehicle (SMV) signs when traveling on public roads.
18. When towing an implement or wagon on roads during the day or at night, use implement warning lamps for the safety of the tractor operator and other vehicle operators.
19. Use hazard warning flashers, as required by law, when transporting or driving the tractor on public roads.
20. To maintain tractor control when pulling heavy loads at road speeds, avoid hard application of the tractor brakes.
8. Do not operate the tractor engine in an enclosed building without adequate ventilation. Exhaust fumes can cause death.
9. The cab air filters are designed to remove dust from the air but will not exclude chemical vapor. Follow the chemical manufacturer's directions regarding protection from dangerous chemicals.
10. If the power steering ceases to operate, stop the tractor immediately as the tractor will be more difficult to control.
11. Stop the engine and relieve pressure before connecting or disconnecting hydraulic couplers.
12. Pull only from the drawbar or three point hitch. Use only a drawbar pin that is retained in place. Pulling from the tractor axle or any point above the axle may cause the tractor to overturn.
13. Be sure hydraulic couplers are properly connected and will disconnect safely in case of accidental detachment of the implement.
14. Do not leave equipment in the raised position when the tractor is stopped or unattended.
15. Ensure any attached equipment or accessories are correctly installed, are approved for use with the tractor and are operated and maintained in accordance with the instructions issued by the equipment or accessory manufacturer.
16. Remember that your tractor, if abused or incorrectly used, can be dangerous and become a hazard both to the operator and to bystanders. Do not overload or operate with attached equipment which is unsafe, not designed for the particular task or is poorly maintained.

OPERATING THE TRACTOR

1. Before starting the tractor, apply the parking brake, place the remote control valve levers in neutral.
2. Do not start the engine or operate cab controls while standing beside the tractor. Always sit in the tractor seat when starting the engine or operating the cab controls.
3. Do not bypass the tractor's neutral start circuit. Consult your authorized dealer if your neutral start controls malfunction.
4. Avoid accidental contact with the hydrostatic control lever or range control switch while the engine is running. Unexpected tractor movement can result from such contact.
5. Do not get off the tractor while it is in motion.
6. When in stationary PTO applications, apply the park brake before getting off the tractor.
7. Do not park the tractor on a steep incline.
17. The cab is designed to provide the minimum noise level at the operator's ears and, in fact, meets or exceeds applicable standards in this respect. However, noise (sound pressure level) in the workplace can exceed 86dB(A) when the cab windows are open. Therefore, it is recommended that operators wear suitable ear protectors when operating in high noise level conditions.
18. Always keep sleeves, jackets or other clothing relatively tight and belted. Loose clothing may catch in moving parts and result in personal injury or death.
19. Jumping on or off the tractor can cause an injury. Always face the tractor, use hand holds and steps and get on or off slowly. Maintain a three point contact to avoid falling, (both hands on rails and one foot on the step, or one hand on the hand rail and both feet on the steps).
20. Do not operate the tractor when you are tired, sick or impaired in any way.

21. Reduce speed for better control before operating in confined areas or reduced visibility. Keep by-standers clear of the work area.
22. Put the FNR lever in neutral and apply the park brake before hitching implements to the tractor.
23. Use transport locks, or lower the implement to the ground and securely block the frame before servicing the implement. Relieve pressure from the hydraulic system and shut off the tractor.
24. Never attach any PTO, three point hitch or drawbar equipment to the cab-end of the tractor when the loader is attached.

OPERATING THE PTO

1. When operating PTO-driven equipment, shut off the engine and wait until the PTO(s) stop before getting off the tractor and disconnecting the equipment.
2. Do not wear loose clothing when operating the power take-off or when near rotating equipment.
3. When using the PTO in stationary applications be sure the articulation lock is installed, the park brake is set, the hydrostatic control lever is in neutral. Do not leave the tractor unattended.
4. To avoid injury, do not clean, adjust, unclog or service PTO driven equipment when the tractor engine is running.
5. Make sure all PTO shields are in position at all times.

SERVICING THE TRACTOR

1. Stop the engine before performing any service on the tractor.
2. The cooling system operates under pressure which is controlled by the radiator cap. It is dangerous to remove the cap while the system is hot. Always turn the cap slowly to the first stop and allow the pressure to escape before removing the cap entirely. Wear gloves when removing the cap.
3. Do not smoke while refueling the tractor. Keep any type of open flame away.
4. Keep the tractor and equipment, particularly brakes and steering, maintained in a reliable and satisfactory condition to ensure your safety and comply with legal requirements.
5. To prevent fire or explosion, keep open flames away from the battery or cold weather starting aids. To prevent sparks which could cause explosion, use jumper cables according to instructions.
6. Do a daily walk around inspection of the tractor, and remove any crop residue build up. Follow the

instructions in OPERATION 57 “Additional Daily Cleaning on page 3–57 of this manual.

7. Do not attempt to service the air conditioning system. It is possible to suffer severe frost bite or injury from escaping refrigerant. Special equipment and instruments are required to service the air conditioning system. See your authorized New Holland dealer for service.
8. Escaping diesel/hydraulic fluid under pressure can penetrate the skin causing serious injury.
 - DO NOT use your hand to check for leaks. Use a piece of cardboard or paper to search for leaks.
 - Stop the engine and relieve pressure before connecting or disconnecting lines.
 - Tighten all connections before starting the engine or pressurizing lines.
 - If fluid is injected into the skin, obtain medical attention immediately.
9. Do not modify, alter or permit anyone else to modify or alter the tractor or any of its components or any tractor function without first consulting an authorized New Holland dealer.
10. The fuel oil in the injection system is under high pressure and can penetrate the skin. Unqualified persons should not remove or attempt to adjust a pump, injector, nozzle or any other part of the fuel injection system. Failure to follow these instructions can result in serious injury.
11. Continuous long term contact with used engine oil may cause skin cancer. Avoid prolonged contact with used engine oil. Wash skin promptly with soap and water.
12. Tractor wheels are very heavy. Handle with care and ensure, when stored, they cannot fall and cause injury.
13. Dispose of all drained fluids and removed filters properly. Follow local laws governing disposal of used engine oil.
14. Never oil, grease or adjust the tractor while it is running. Do not leave the engine running while the tractor or drawn equipment is being adjusted, repaired or cleaned.
15. Starting fluid is highly flammable. Do not use near fire, sparks or open flames.
16. Remove mud, crop residue, chains and tools from steps and operator’s platform. They may interfere with pedal operation or entry/exit from the tractor.

DIESEL FUEL

1. Under no circumstances should gasoline, alcohol or blended fuels be added to diesel fuel. These combinations can create an increased fire or explosive hazard. In a closed container, such as a fuel tank, these blends are more explosive than pure gasoline. Do not use these blends.
2. Do not smoke while refueling the tractor or when standing near fuel. Keep any type of open flame away.
3. Do not overfill the fuel tank. Allow room for expansion.
4. Clean up spilled fuel immediately.
5. Always tighten the fuel tank cap securely.
6. If the original fuel tank cap is lost, replace it with a genuine replacement cap. A non-approved cap may not be safe.
7. Keep fuel equipment clean and properly maintained.
8. Do not drive equipment near open fires.

SAFETY CAB

1. Do not modify, drill, weld or alter the safety cab in any way. Doing so could render you liable to legal prosecution in some countries.
2. Never attempt to straighten or weld any part of the main frame or retaining brackets which have suffered damage. By doing so you may weaken the structure and endanger your safety. Replace all damaged parts.
3. Do not carry harmful chemicals in the cab.
4. The cab air filter is not designed to filter out harmful chemicals. Follow the instructions in the implement operator's manual and those given by the chemical manufacturer when using agricultural chemicals.

LOADER SAFETY INFORMATION

GENERAL SAFETY

1. Improper use of the loader or attachments can cause serious injury or death. Be sure that everyone operating the loader or attachments is aware of safe operating practices and potential hazards.
2. Keep children away from the loader and attachments.
3. Lower the loader arms and attachments, stop the engine and apply the parkbrake before leaving the operator's seat for any reason, unless the loader arm supports are to be used immediately.
4. Never leave the loader bucket raised. When not in use, the bucket should rest on the ground. Hydraulic hoses can rupture under pressure, causing the loader to collapse.
5. Never stand or work under a raised bucket.
6. Never allow anyone to ride in the loader bucket.
7. Maintain the recommended wheel spacing.
8. Ballast the tractor per the operating recommendations in Section 2 of this manual.
9. When removing the loader from the tractor, park the loader on a hard, level surface and follow the instructions in the loader operator manual.
10. Avoid overhead powerlines when raising the loader. Electrocutation may result.

OPERATING SAFETY

1. Drive the tractor at low speed, allowing additional length for the loader and attachments when making turns.
2. When transporting a load, keep the bucket as low as safely possible with out hitting any obstruction.

3. Operate the cab controls only from the operator's seat. Before starting the tractor, be sure all controls are in neutral and the seat belt is fastened securely.
4. Never operate the loader or attachments with frayed or damaged hoses or leaking fittings.
5. Operate the tractor/loader on solid ground. Use caution when handling loose or shiftable loads.
6. Keep the bucket low when operating on ramps or slopes.
7. Never use the loader or attachments to push or pull a load.
8. With heavy loads, avoid rapid changes in travel speed or loader manipulation.
9. Avoid overhead powerlines when the bucket is raised; electrocution may result.
10. When operating in low light, position the bucket in the lower position so that lights are not obstructed.

MAINTENANCE SAFETY

1. Never service or adjust the loader or tractor with the engine running.
2. When the loader must be raised for service, support the loader in the raised position with the loader support arms or other mechanical means.
3. Do not use the loader support arms to support the loader when there is a load in the bucket.
4. Escaping hydraulic oil under pressure can penetrate the skin causing personal injury. Be sure all connections are tight and lines and hoses are undamaged. Before disconnecting hydraulic lines, relieve all hydraulic pressure.

SAFETY DECALS

The following safety decals have been placed on your machine in the areas indicated. They are intended for your personal safety and for those working with you. Please take this manual and walk around your machine to note the content and location of these warning signs. Review these warning signs

and the operating instructions detailed in this manual with your machine operators.

Keep the decals legible. If they are not, obtain replacements from your New Holland dealer. The decal replacement part numbers are listed with each decal.

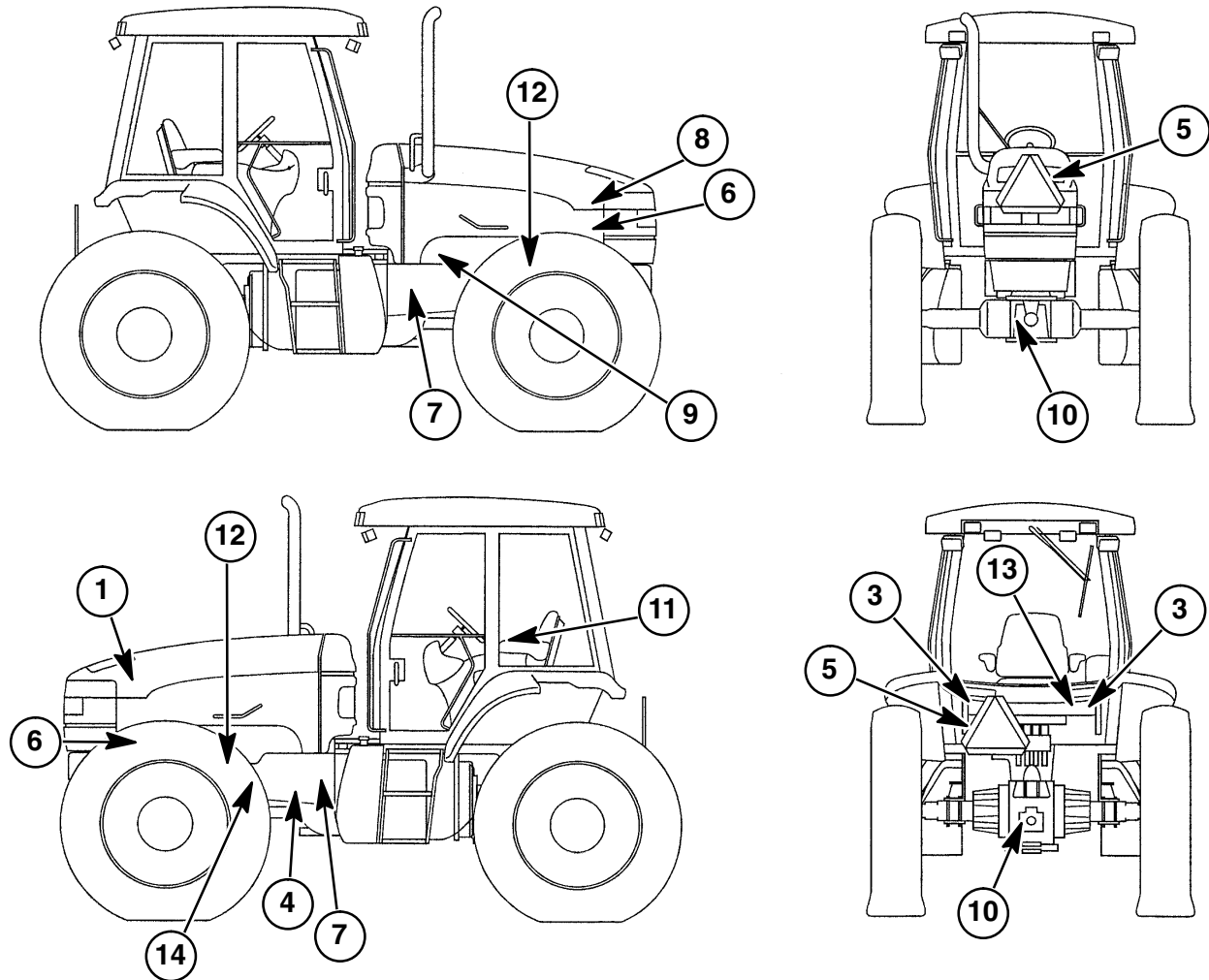

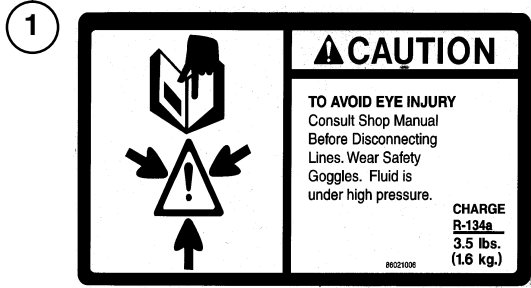

Part #86021006



Part #86501507

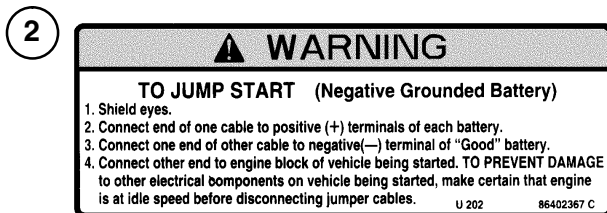

Part #86402367-C

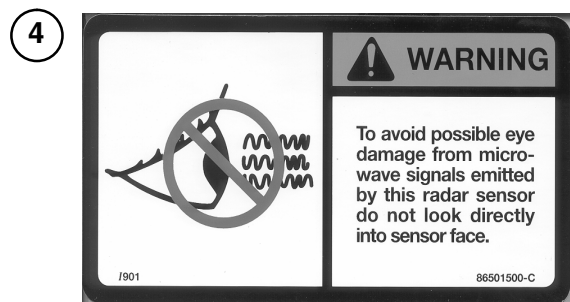

Part #86501500-C

5

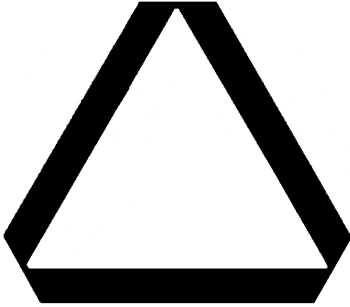

Part #86500632

7



Part #86017547

6



Part #86501511

8

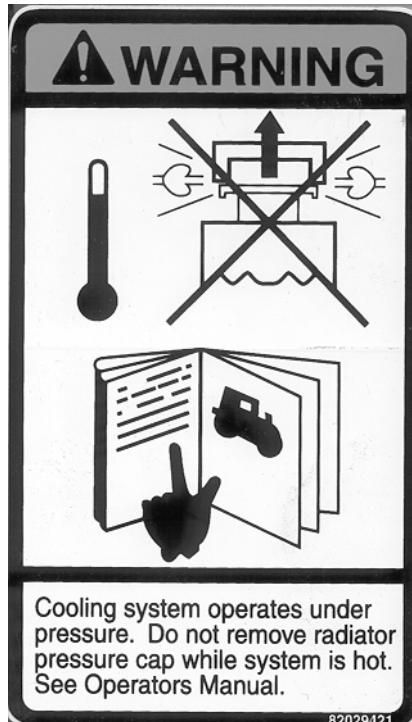

Part #82029421

Thank you so much for reading.
Please click the “Buy Now!”
button below to download the
complete manual.



After you pay.

You can download the most
perfect and complete manual in
the world immediately.

Our support email:

ebooklibonline@outlook.com