

**M172 Mower
Operators Manual
Parts Catalog**
for 1130-1140 Tractors

9-23100

Reprinted



TO THE OWNER:

Read this manual before operating your mower. The information presented will prepare you to do a better and safer job. Keep this manual handy for ready reference.

The mower you have purchased has been carefully engineered and manufactured to provide dependable and satisfactory use. Like all mechanical products, it will require cleaning and upkeep. Lubricate the mower as specified. Observe all safety information in this manual and safety decals on the mower and tractor.

For service, your authorized dealer has trained mechanics, genuine service parts, and the necessary tools and equipment to handle all your needs.

Use only genuine service parts. Substitute parts will void the warranty and may not meet standards required for safe and satisfactory operation. Record the model and serial number of your mower:

Model: _____

Serial Number: _____
(see Safety Decal page for location)

Provide this information to your dealer to obtain correct repair parts.

GENERAL TABLE OF CONTENTS

Specifications	3
General Information.....	3
Safety Rules	4-7
Safety Decals	8-9
Operation.....	10-16
Owner Service	17-22
Dealer Maintenance	23-35
Trouble Shooting.....	36-38
Assembly Instructions	39-58
Parts Catalog	59-80

Throughout this manual, the term IMPORTANT is used to indicate that failure to observe can cause damage to equipment. The terms CAUTION, WARNING and DANGER are used in conjunction with the Safety-Alert Symbol, (a triangle with an exclamation mark), to indicate the degree of hazard for items of personal safety.



The Safety-Alert Symbol means ATTENTION! BECOME ALERT! YOUR SAFETY IS INVOLVED!



CAUTION

Denotes a reminder of safety practices or directs attention to unsafe practices which could result in personal injury if proper precautions are not taken.



WARNING

Denotes a hazard exists which can result in injury or death if proper precautions are not taken.



DANGER

Denotes an extreme intrinsic hazard exists which would result in high probability of death or irreparable injury if proper precautions are not taken.

SPECS/GENERAL INFORMATION

SPECIFICATIONS

Cutting Width.....	72"
Cutting Height Range:	1" to 4"
Tractor Mid-PTO Speed	2,000 RPM
Blade RPM	2,400
Blade Tip Speed (feet per minute)	15,700
Blade Spindles	3
Number of Blades	3
Universal Drive	0600
Caster Wheels	4
Caster Size	3-1/2 x 7-3/4"
Mower Frame Thickness.....	8 GA Deck

GENERAL INFORMATION

The purpose of this manual is to assist the operator in maintaining and operating this mower. Read it carefully. It furnishes information and instructions that will help you achieve years of dependable performance. These operating and maintenance instructions have been compiled from extensive field experience and engineering data. Some information may be general in nature due to unknown and varying conditions. However, you should be able to develop operating procedures suitable to your particular situation.

The illustrations and data used in this manual were current at the time of printing, but due to possible in-line production changes, your machine may vary slightly in detail. We reserve the right to redesign and change the machine as may be necessary without notification.



WARNING *Some illustrations in this manual show the mower with safety shields removed to provide a better view. The mower should never be operated with any safety shielding removed.*

Throughout this manual, references are made to right and left directions. These are determined by standing behind the equipment and facing the direction of forward travel. Blade rotation is clockwise as viewed from the top of the mower

SAFETY RULES

SAFETY RULES



ATTENTION! BECOME ALERT!



YOUR SAFETY IS INVOLVED!

Safety is a primary concern in the design and manufacture of our products. Unfortunately, our efforts to provide safe equipment can be wiped out by a single careless act of an operator.

In addition to the design and configuration of equipment, hazard control and accident prevention are dependent upon the awareness, concern, prudence and proper training of personnel involved in the operation, transport, maintenance and storage of equipment.

It has been said *'the best safety device is an informed, careful operator'*. We ask you to be that kind of an operator.

The designed and tested safety of this equipment depends on it being operated within the limitations as explained in this manual.

TRAINING

- Safety instructions are important! Read this manual, the tractor manual and all safety rules.
- Know your controls and how to stop tractor engine and mower quickly in an emergency.
- Operators must be instructed in and be capable of the safe operation of the equipment, its attachments and all controls. Do not allow anyone to operate this equipment without proper instructions.
- Keep hands and body away from pressurized lines. Use paper or cardboard, not body parts to check for leaks. Hydraulic fluid (oil) under pressure will penetrate skin causing serious injury.
- Make sure that all operating and service personnel know that in the event hydraulic fluid penetrates skin, it must be surgically removed within a few hours by a doctor familiar with this form of injury, or gangrene may result.
- Do not allow children or unqualified persons to operate equipment.

SAFETY RULES

PREPARATION

- Always wear relatively tight and belted clothing to avoid entanglement in moving parts. Wear sturdy, rough-soled work shoes and protective equipment for eyes, hands, hearing and head.
- Ensure that mower is properly mounted, adjusted and in good operating condition.
- Make sure mower driveline spring-activated locking collar slides freely and the balls are seated in mid-PTO shaft groove.
- Remove accumulated debris from mower to avoid fire hazard.
- Ensure all safety decals are installed and in good condition. (See Safety Decals section for location drawing.)
- Ensure shields and guards are properly installed and in good condition.
- Inspect area to be cut and remove stones, branches or other hard objects that might be thrown, causing injury or damage.
- A minimum 20% of tractor and equipment weight must be on tractor front wheels with mower in transport position. Without this weight, tractor could tip over causing personal injury or death.

OPERATIONAL SAFETY

- You may not be able to stop the tractor safely if the clutch or brake pedal mechanisms are improperly adjusted, allowing them to contact mower components.
- When the mower lift stops are installed as instructed in this manual, properly adjusted clutch and brake pedal mechanisms will not contact mower components. You should frequently check that the tractor clutch and brake pedal mechanisms are in adjustment.
- If the clutch or brake pedal mechanisms can contact mower components, do not operate until properly adjusted.
- Do not operate mower unless discharge chute is installed.
- Keep bystanders away from equipment while it is in operation.
- Never direct discharge toward anyone.
- Operate only in daylight or good artificial light.
- Keep hands and feet away from mower while tractor engine is running. Stay clear of all moving parts.

SAFETY RULES

- No riders are allowed on tractor or mower.
- Start engine from operator's seat after disengaging tractor PTO and placing transmission in neutral.
- Always sit in tractor seat when starting the engine or operating controls.
- Disengage power take-off, shift tractor into neutral or park, and place all controls in neutral before starting tractor engine.
- Operate tractor mid-PTO at 2000 rpm.
- Make sure area behind you is clear before operating in reverse.
- Do not operate on steep slopes.
- Do not stop, start or change directions suddenly on slopes.
- Use extreme care and reduce ground speed on slopes and rough terrain.
- Watch for hidden hazards on the terrain during operation.
- Stop mower and tractor immediately upon striking an obstruction. Turn off engine, remove key, inspect and repair any damage before resuming operation.
- Before working underneath, raise mower, install transport lock and block mower securely. Hydraulic system leak down and failure of mechanical or hydraulic system can cause equipment to drop.
- Disengage power to mower, lower to ground, stop engine, set parking brake and remove key before dismounting tractor.

SAFETY RULES

MAINTENANCE SAFETY

- Always wear relatively tight and belted clothing to avoid entanglement in moving parts. Wear sturdy, rough-soled work shoes and protective equipment for eyes, hands, hearing and head.
- Lower mower to ground or block securely, turn tractor engine off, remove key and disconnect mower driveline from tractor PTO before performing any service or maintenance.
- Never perform service or maintenance with tractor engine running.
- Before working underneath, raise mower, install transport lock and block mower securely. Hydraulic system leak down and failure of mechanical or hydraulic system can cause equipment to drop.
- Keep all persons away from operator control area while performing adjustments, service or maintenance.
- Frequently check blades. They should be sharp, free of nicks and cracks and securely fastened.
- Your dealer can supply genuine replacement blades. Substitute blades may not meet original equipment specifications and may be dangerous.
- Tighten all bolts, nuts and screws, and check that all cotter pins are installed securely to ensure mower is in a safe condition before operating.
- Ensure all safety decals are installed and in good condition. (See Safety Decals section for location drawing.)
- Ensure shields and guards are properly installed and in good condition.
- Do not disconnect hydraulic lines until machine is securely blocked or placed in lowest position and system pressure is released by operating valve.

STORAGE

- Block mower securely for storage.

SAFETY DECALS

SAFETY DECALS



ATTENTION! BECOME ALERT!
YOUR SAFETY IS INVOLVED!



Replace Immediately If Damaged!

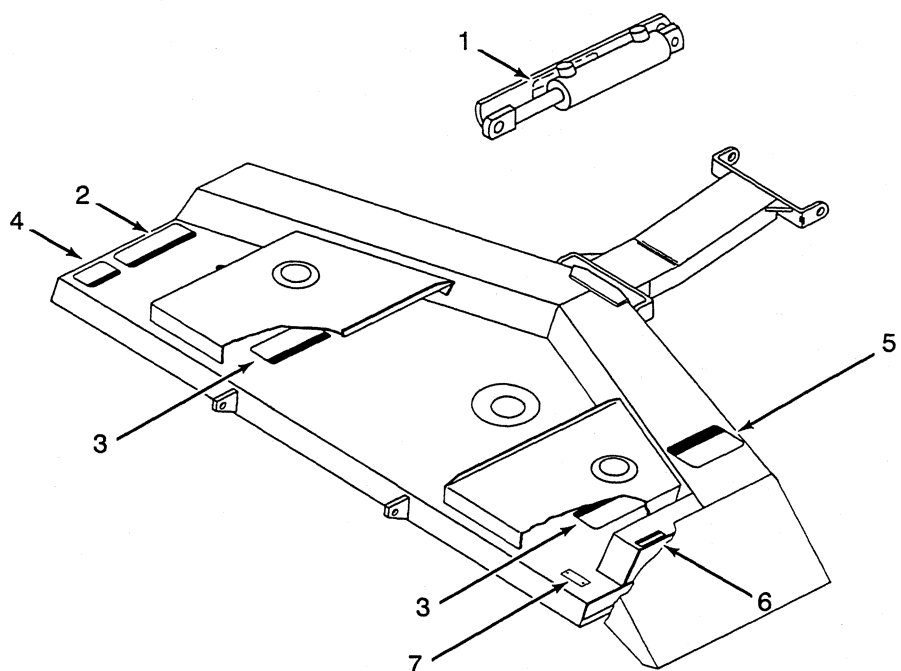

DC3518

- 1. Decal Part No. 1993154C1
- 2. Decal Part No. 1993152C1
- 3. Decal Part No. 1993150C1
- 4. Decal Part No. 1993153C1
- 5. Decal Part No. 1993151C1
- 6. Decal Part No. 1993155C1
- 7. Serial Number Plate

SAFETY DECALS

⚠ CAUTION

- ★ HIGH PRESSURE OIL LEAKS CAN PENETRATE SKIN, CAUSING SERIOUS INJURY AND GANGRENE. SEE OPERATOR'S MANUAL AND CONSULT A PHYSICIAN IMMEDIATELY.
- ★ DO NOT USE FINGER OR OTHER SKIN TO CHECK FOR LEAKS.
- ★ LOWER LOAD, RELEASE PRESSURE AND BE SURE OIL IS COOL BEFORE LOOSENING FITTING.

32005

1

DB1733

⚠ WARNING

TO AVOID SERIOUS INJURY OR DEATH:

- ★ READ OPERATOR'S MANUAL & FOLLOW ALL SAFETY PRECAUTIONS. (CONTACT DEALER FOR MANUALS.)
- ★ KEEP SHIELDS AND GUARDS IN PLACE. KEEP CLEAR OF DRIVES AND BELTS.
- ★ LOWER IMPLEMENT, STOP ENGINE AND REMOVE KEY BEFORE DISMOUNTING.
- ★ CLEAR MOWING AREA OF DEBRIS.
- ★ DO NOT OPERATE MOWER IN VICINITY OF OTHER PERSONS. NO RIDERS.
- ★ KNOW HOW TO STOP TRACTOR AND EQUIPMENT QUICKLY IN AN EMERGENCY.
- ★ BLOCK UP IMPLEMENT AND REMOVE KEY BEFORE WORKING UNDERNEATH.
- ★ ALLOW NO CHILDREN OR UNQUALIFIED PERSONS TO RUN EQUIPMENT.
- ★ BE CAREFUL ON UNEVEN TERRAIN. DECREASE SPEED WHEN TURNING.
- ★ DO NOT OPERATE IN TRANSPORT POSITION.

31399

2

DB1519

⚠ DANGER

KEEP AWAY!

SHIELD MISSING FROM THIS AREA TO AVOID SERIOUS INJURY, DO NOT OPERATE WITHOUT THIS & ALL OTHER SHIELDS IN PLACE & IN GOOD CONDITION.

31516

3

DB2021

⚠ DANGER

KEEP AWAY!

THROWN OBJECTS OR BLADE CONTACT CAN CAUSE SERIOUS INJURY OR DEATH. KEEP DISCHARGE CHUTE AND SHIELDS IN PLACE.

34624

5

DB2911

⚠ WARNING

- PTO SPEED MUST NOT EXCEED 2000 RPM.
- LOCK DRIVELINE SECURELY TO PTO.
- A LOOSE DRIVELINE OR A HIGHER PTO RPM CAN CAUSE PERSONAL INJURY AND EQUIPMENT FAILURE.

66845

4

66845

⚠ DANGER

KEEP AWAY!

SHIELD MISSING. DO NOT OPERATE.

34860

6

DB3108

OPERATION

OPERATION

Safety is a primary concern in the design and manufacture of our products. Unfortunately, our efforts to provide safe equipment can be wiped out by a single careless act of an operator.

In addition to the design and configuration of equipment, hazard control and accident prevention are dependent upon the awareness, concern, prudence and proper training of personnel involved in the operation, transport, maintenance and storage of equipment.

It has been said '*the best safety device is an informed, careful operator*'. We ask you to be that kind of an operator.

The operator is responsible for the safe operation of this mower. The operator must be properly trained and qualified. Operators should be familiar with the mower and tractor and all safety practices before starting operation. Read the safety information on pages 4 to 7.

This mower is designed for lawn or grass mowing. It is not designed for rough conditions or heavy weed mowing. It is equipped with suction type blades for best results in lawn mowing.

Recommended mowing speed for most conditions is from two to five mph.



WARNING *Do not allow children or unqualified persons to operate equipment.*

Keep bystanders away from equipment while it is in operation.

Before working underneath, raise mower, install transport lock and block mower securely. Hydraulic system leak down and failure of mechanical or hydraulic system can cause equipment to drop.

Keep all persons away from operator control area while performing adjustments, service or maintenance.

Operate tractor mid-PTO at 2000 rpm.

Make sure mower driveline spring-activated locking collar slides freely and the balls are seated in mid-PTO shaft groove.



CAUTION *Stop mower and tractor immediately upon striking an obstruction. Turn off engine, remove key, inspect and repair any damage before resuming operation.*

Always wear relatively tight and belted clothing to avoid entanglement in moving parts. Wear sturdy, rough-soled work shoes and protective equipment for eyes, hands, hearing and head.

OPERATION

Cutting Height Adjustment

Mower cutting height is raised, lowered, and maintained by adjusting caster and gauge wheels. Refer to figure 1 and accompanying chart for approximate cutting heights.

Raise mower with tractor hydraulics to adjust gauge and caster wheels.

It is important that all four adjustments be the same. To set cutting height, match numbers shown in illustration.

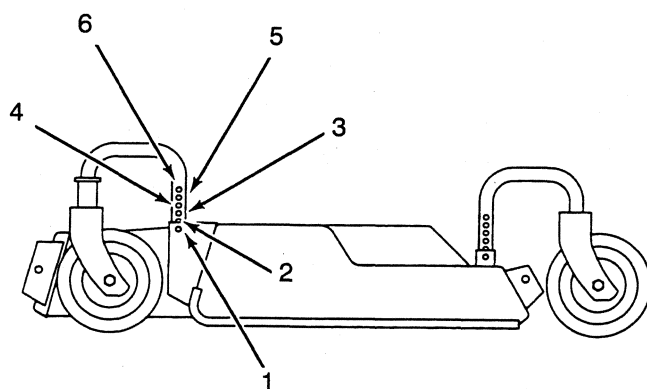

DB3513

Approximate Cutting Height	Position
1.0"	1
1.6"	2
2.2"	3
2.8	4
3.4"	5
4.0"	6

Figure 1 - Cutting Height Adjustment

IMPORTANT - Avoid very low cutting heights. Striking the ground with blades gives one of the most damaging shock loads a mower can encounter and, if this occurs repeatedly it will cause damage to mower and drive.



Our support email:

ebooklibonline@outlook.com