



Service Repair Manual

Models

14M Motor Grader

Product: MOTOR GRADER

Model: 14M MOTOR GRADER R9J

Configuration: 14M Motor Grader R9J00001-UP (MACHINE) POWERED BY C11 Engine

Disassembly and Assembly 14M Motor Grader Power Train

Media Number -REN8639-07

Publication Date -01/05/2017

Date Updated -16/05/2017

i07035129

Service Brake (Wheel Spindle) - Assemble

SMCS - 4002-016

Assembly Procedure

Table 1

Required Tools			
Tool	Part Number	Part Description	Qty
A	439-3939	Link Bracket As	2
B	1P-2420	Transmission Repair Stand	1
C	140-7742	Sleeve	2
F	169-0503	Installation Kit	1
	1U-8698 ⁽¹⁾	Duo-Cone Seal Installer As	1
	1U-6441 ⁽²⁾	Duo-Cone Seal Installer As	1
G	6V-2055	Grease - High Vacuum	1
H	-	Loctite 5127	-
J	8T-4132	Nut	6
	-	M16 - 2.00 × 180mm Bolt	3
K	8T-4140	Bolt	4
L	-	Loctite 243	-

⁽¹⁾ For a Duo-cone Seal with a diameter of 160.09 ± 0.58 mm (6.303 ± 0.023 inch)

⁽²⁾ For a Duo-cone Seal with a diameter of 191.26 ± 0.25 mm (7.529 ± 0.009 inch)

NOTICE

Keep all parts clean from contaminants.

Contaminants may cause rapid wear and shortened component life.

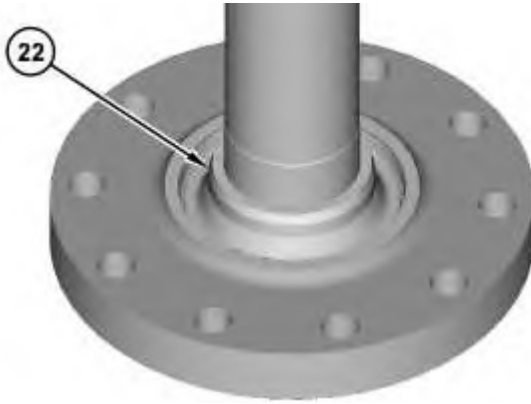

Illustration 1

g01378162

1. Install spacer (22).



Illustration 2

g01349477

2. Raise the temperature of bearing cone (21). Install bearing cone (21). Ensure that bearing cone (21) is seated correctly against the spacer.
-

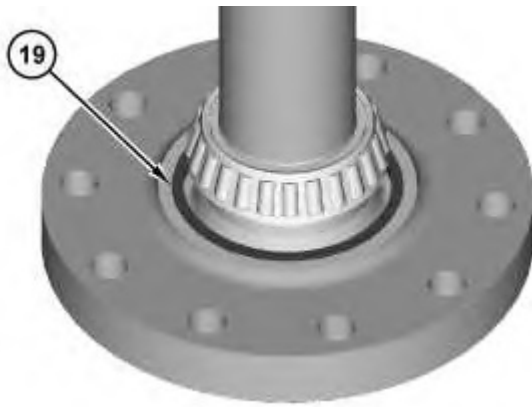

Illustration 3

g01349462

3. Use Tooling (F) to install the second half of Duo-Cone seal (19). Refer to Disassembly and Assembly, "Duo-Cone Conventional Seals - Install".

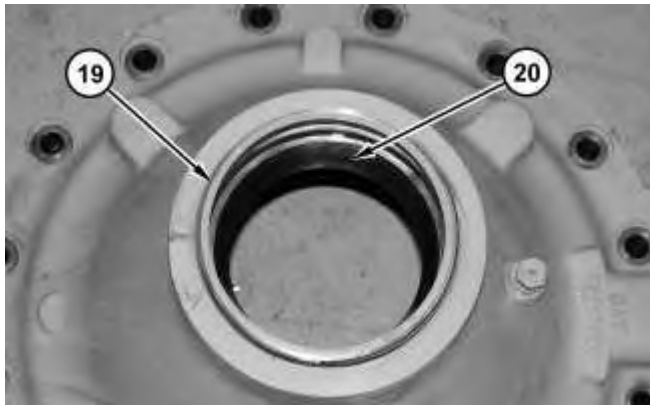

Illustration 4

g01349436

4. Lower the temperature of bearing cup (20). Install bearing cup (20). Ensure that bearing cup (20) is seated correctly. Use Tooling (F) to install the first half of Duo-Cone seal (19). Refer to Disassembly and Assembly, "Duo-Cone Conventional Seals - Install".

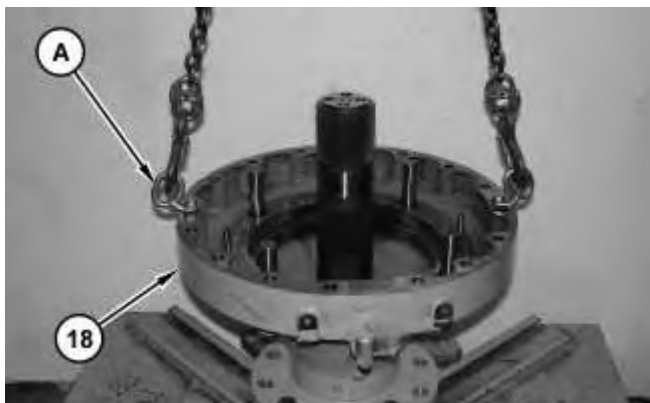

Illustration 5

g01349430

5. Use Tooling (A) and a suitable lifting device to install housing (18). Apply Tooling (G) onto the bores of housing (18). The weight of housing (18) is approximately 77 kg (170 lb).



Illustration 6

g01349359



Illustration 7

g06277637

6. Install seals (17).

Note: Some machines require the seals to be installed on the piston, while others require the seals to be installed in the housing.



Illustration 8

g06048340

Thank you so much for reading.
Please click the “Buy Now!”
button below to download the
complete manual.



After you pay.

You can download the most
perfect and complete manual in
the world immediately.

Our support email:

ebooklibonline@outlook.com