



Service Repair Manual

Models

311B EXCAVATOR

Product: EXCAVATOR

Model: 311B EXCAVATOR 2LS

Configuration: 311B TRACK-TYPE EXCAVATORS 2LS00001-UP (MACHINE) POWERED BY 3064 ENGINE

Disassembly and Assembly 3064 and 3066 Engines for Caterpillar Built Machines

Media Number -SEN5553-10

Publication Date -01/05/2012

Date Updated -15/05/2012

i01615533

Rocker Shaft - Assemble

SMCS - 1102-016

Assembly Procedure

Table 1

Required Tools			
Tool	Part Number	Part Description	Qty
A	1P-0510	Driver Group	1

NOTICE

Keep all parts clean from contaminants.

Contaminants may cause rapid wear and shortened component life.

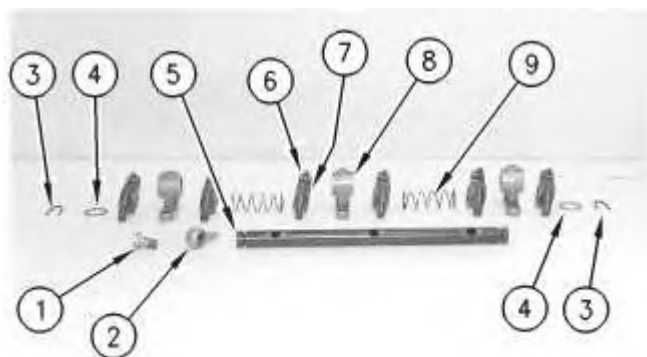

Illustration 1

g00609491



Illustration 2

g00609490

1. Use Tool (A) to install bushing (7) into rocker arm (6), if the bushing was removed.
Refer to Specifications, "Rocker Shaft" for more information.

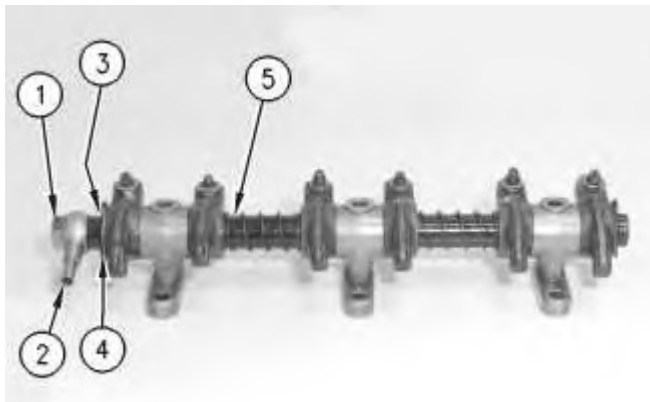

Illustration 3

g00609488

2. Install spacer (4) and clip (3) onto one end of shaft assembly (5) .
3. Slide components onto shaft (5) in the correct order. Refer to Illustration 1 in order to install the components correctly.
4. The shaft assembly includes the following components:
 - Bolt (1)
 - Oil tube (2)
 - Clip (3)

- Spacer (4)
- Shaft assembly (5)
- Rocker arm (6)
- Bushing (7)
- Rocker shaft bracket (8)
- Spring (9)

5. Install spacer (4) and clip (3) onto the other end of shaft assembly (5) .

6. Install bolt (1) and oil supply tube (2) into the end of shaft assembly (5) .

End By: Install the rocker shaft and pushrods. Refer to Disassembly and Assembly, "Rocker Shaft and Pushrod - Install".

Product: EXCAVATOR

Model: 311B EXCAVATOR 2LS

Configuration: 311B TRACK-TYPE EXCAVATORS 2LS00001-UP (MACHINE) POWERED BY 3064 ENGINE

Disassembly and Assembly 3064 and 3066 Engines for Caterpillar Built Machines

Media Number -SEN5553-10

Publication Date -01/05/2012

Date Updated -15/05/2012

i01576835

Rocker Shaft and Pushrod - Install

SMCS - 1102-012; 1208-012

Installation Procedure

NOTICE

Keep all parts clean from contaminants.

Contaminants may cause rapid wear and shortened component life.

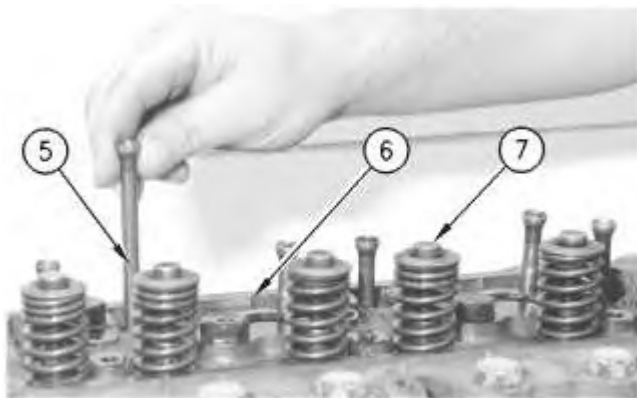

Illustration 1

g00609287

1. Install valve caps (7) on the end of the valve stem.
2. Install pushrods (5) in the cylinder head assembly (6) .

Thank you so much for reading.
Please click the “Buy Now!”
button below to download the
complete manual.



After you pay.

You can download the most
perfect and complete manual in
the world immediately.

Our support email:

ebooklibonline@outlook.com