

Product: EXCAVATOR

Model: 315B FM L EXCAVATOR 7RZ

Configuration: 315B FOREST MACHINE 7RZ00001-UP (MACHINE) POWERED BY 3046 ENGINE

Disassembly and Assembly 315B Excavator Machine Systems

Media Number -REN1131-07

Publication Date -01/03/2004

Date Updated -09/03/2004

i01388910

Final Drive and Travel Motor - Disassemble

SMCS - 4050-015; 4351-015

Disassembly Procedure

Table 1

| Required Tools | | | |
|----------------|-------------|-------------------------|-----|
| Tool | Part Number | Part Description | Qty |
| A | 1P-2420 | Repair Stand | 1 |
| B | 8B-7548 | Crossblock | 1 |
| | 3H-0465 | Cap | 2 |
| C | 138-7573 | Link Bracket | 3 |
| E | 156-5875 | Spanner Wrench Assembly | 1 |

Start By:

- A. Remove the travel motor and final drive. Refer to Disassembly and Assembly, "Travel Motor and Final Drive - Remove" in this manual.
 1. Thoroughly clean the outside of the travel motor and the final drive prior to disassembly.
 2. Put an alignment mark across the sections of the travel motor and the final drive for assembly purposes. The parts must be installed in the original locations.
-

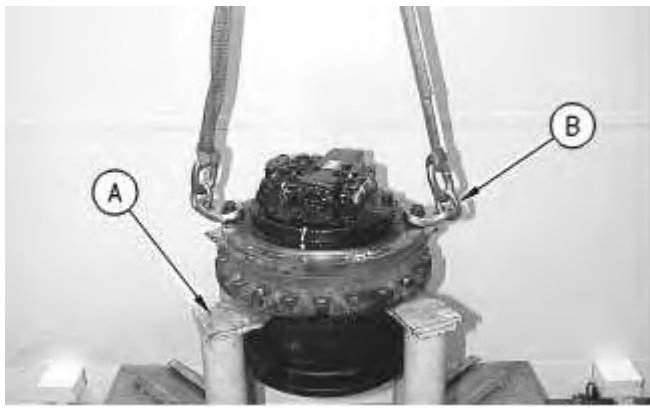

Illustration 1

g00374032

Note: A hydraulic oil sample should be obtained before any maintenance is performed in order to establish the system contaminant level. Refer to Fluid Analysis Laboratory Guide, SEBF3116, "Obtaining an Oil Sample for S·O·S Analysis". Refer to Operation and Maintenance Manual, "Sampling Interval and Location of Sampling Valve" for the correct location.

3. Fasten the travel motor and final drive to Tooling (A), as shown. Remove the drain plug in order to drain the oil. The capacity of the 315B final drive is 2.5 L (0.66 US gal). Drain the oil into a suitable container for storage or disposal.

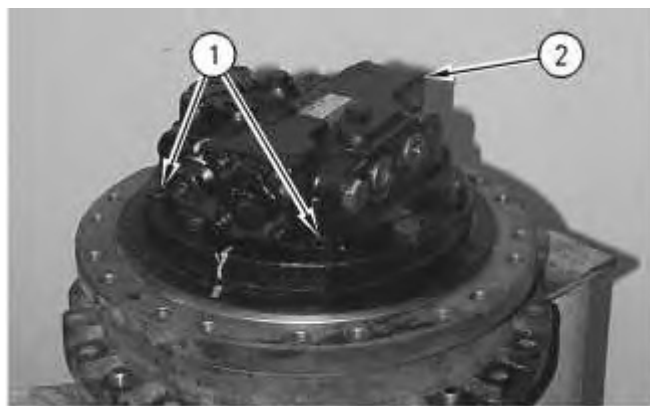

Illustration 2

g00374052

4. Remove nine bolts (1) and travel brake valve (2) .



WARNING

Personal injury can result from being struck by parts propelled by a released spring force.

Make sure to wear all necessary protective equipment.

Follow the recommended procedure and use all recommended tooling to release the spring force.



Illustration 3

g00731872

5. Remove two plugs (3) .

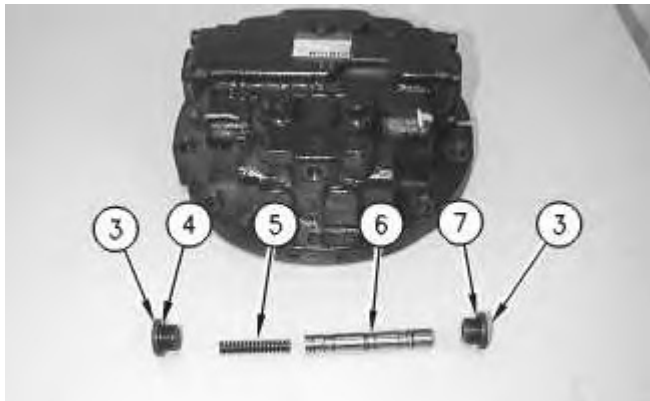

Illustration 4

g00374056

Note: Spool assembly (6) should not be disassembled. That component is serviced as an assembly.

6. Remove spring (5) and spool assembly (6) from the travel brake valve. Remove two O-ring seals (4) and (7) from the two plugs (3) .
 7. Remove four screws (8) and cap (9) .
-

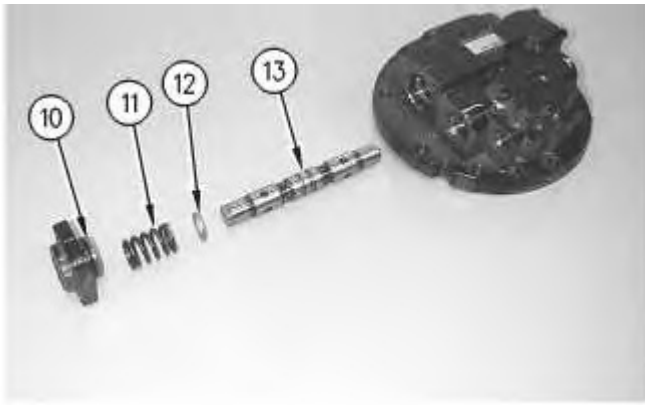

Illustration 5

g00374057

8. Remove O-ring seal (10), spring (11), retainer (12), and spool (13) from the travel brake valve.

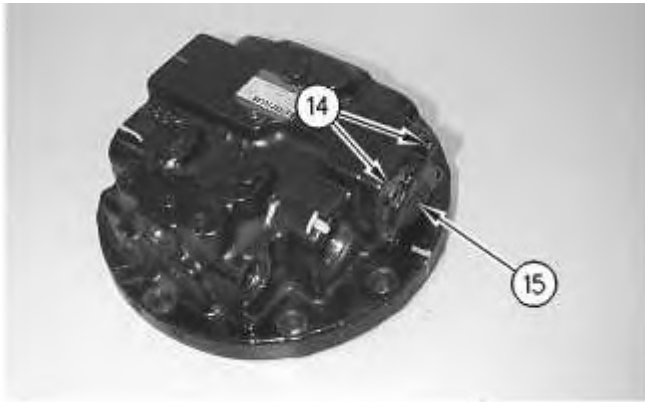

Illustration 6

g00374058

9. Remove two screws (14) and cap (15) .

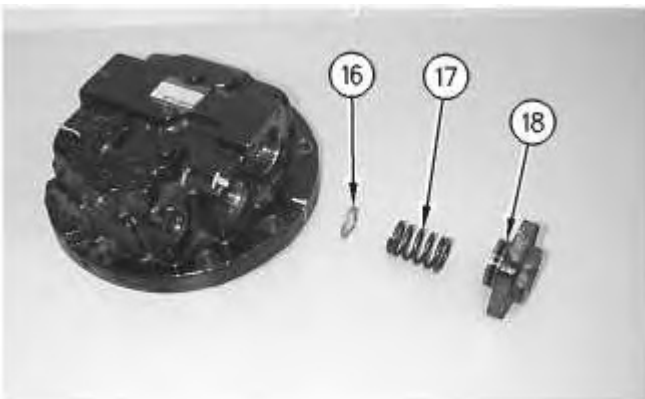

Illustration 7

g00374059

10. Remove O-ring seal (18) from the cap. Remove spring (17) and retainer (16) from the travel brake valve.

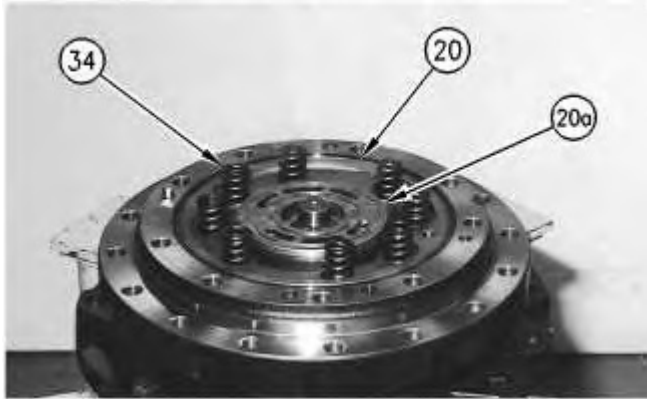

Illustration 8

g00731225

11. Remove eight springs (34) from brake piston (20) .
12. Remove port plate (20a) .

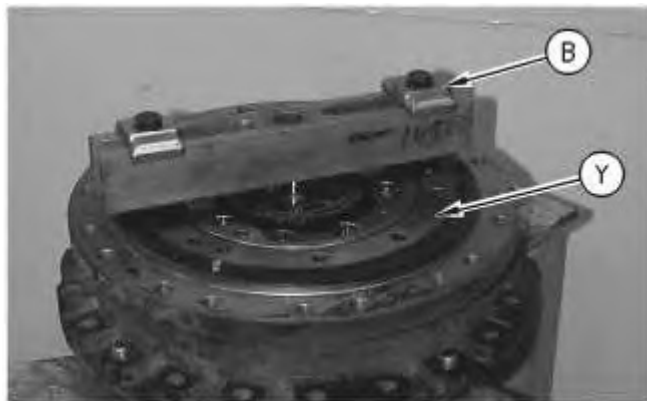

Illustration 9

g00374061

13. Install Tooling (B), as shown.
 - a. Apply shop air pressure of approximately 525 kPa (76 psi) to brake release port (Y) .
 - b. Brake piston (20) will move out of the travel motor body.
 - c. Remove brake piston (20) from the travel motor body.
-



Illustration 10

g00731881

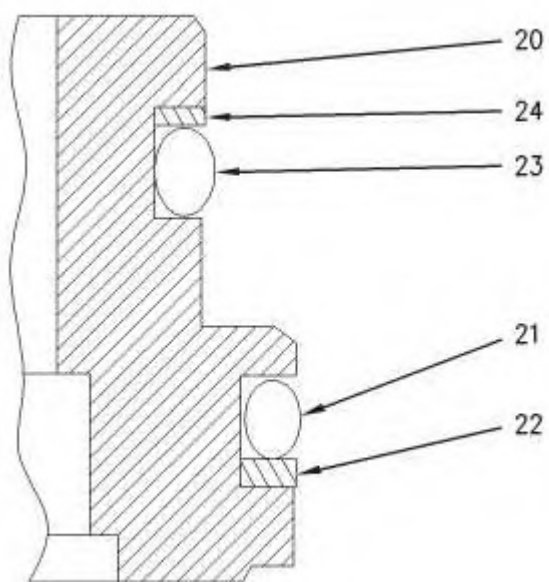
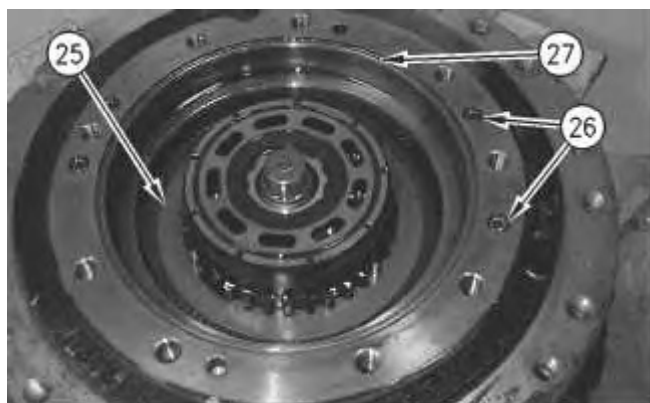

Illustration 11

g00730242

14. Remove O-ring seals (21) and (23) and backup rings (22) and (24) from brake piston (20) .



15. Remove friction plate (25), four O-rings (26) and seal (27) from the travel motor body.

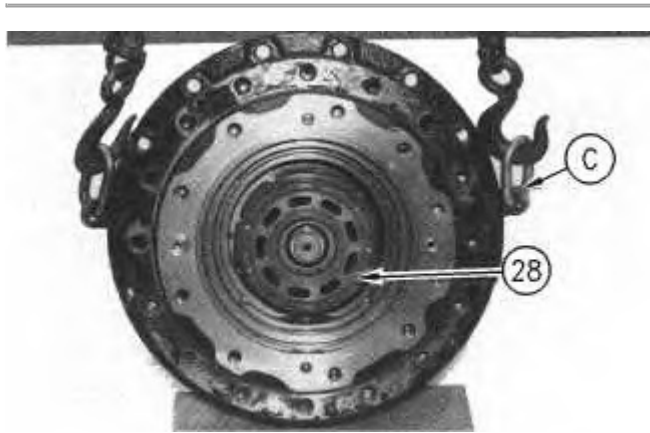

Illustration 13

g00731901

Note: Do not permit the components of barrel assembly (28) to come apart during the removal from the travel motor body. All of the components in the barrel assembly must be reinstalled in the original locations.

16. Fasten Tooling (C) to the travel motor. Position the travel motor and final drive, as shown. Remove barrel assembly (28) from the travel motor body.



Illustration 14

g00374112

17. Shoe retainer (29) and piston shoe assemblies (30) are not serviced separately. Prior to removal of the shoe retainer and the piston shoe assemblies from barrel (31), put identification marks on piston shoe assemblies (30) in order to identify the location in shoe retainer (29) and barrel (31). The piston shoe assemblies must be reinstalled in the original bores in the shoe retainer and the barrel.
18. Remove shoe retainer (29) and piston shoe assemblies (30) from barrel (31). Separate the piston shoe assemblies from the shoe retainer.

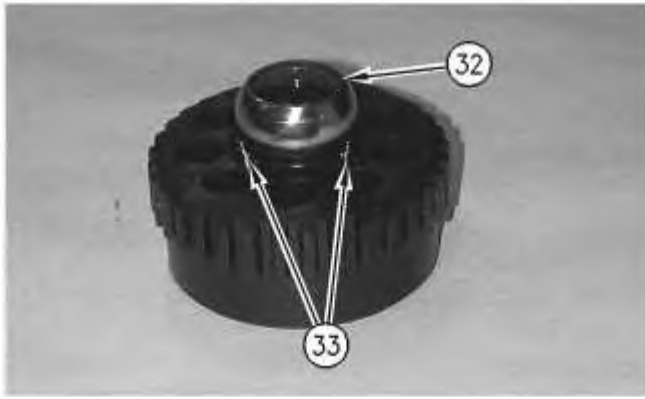

Illustration 15

g00374113

19. Remove bushing (33) from the barrel.



Illustration 16

g00730230

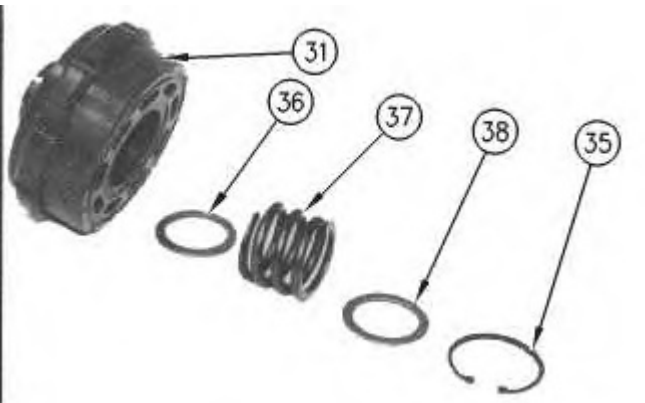

Illustration 17

g00731903

Thank you so much for reading.
Please click the “Buy Now!”
button below to download the
complete manual.



After you pay.

You can download the most
perfect and complete manual in
the world immediately.

Our support email:

ebooklibonline@outlook.com