



Service Repair Manual

Models

330C FM EXCAVATOR

Product: EXCAVATOR

Model: 330C FM EXCAVATOR B1K

Configuration: 330C Forest Swing Machines B1K00001-UP (MACHINE) POWERED BY C-9 Engine

Disassembly and Assembly

C9

Engine For Caterpillar Built Machines

Media Number -SEN9502-16

Publication Date -01/03/2014

Date Updated -06/03/2014

i04506590

Rocker Arm and Shaft - Install

SMCS - 1102-012

Installation Procedure

Table 1

| Required Tools | | | |
|----------------|-------------|------------------|-----|
| Tool | Part Number | Part Description | Qty |
| A | 8T-2998 | Lubricant | - |

NOTICE

Keep all parts clean from contaminants.

Contaminants may cause rapid wear and shortened component life.

1. Apply Tooling (A) to both ends of the pushrods.
 2. Lubricate the pushrods with clean engine oil. Install the pushrods and the valve bridges.
-

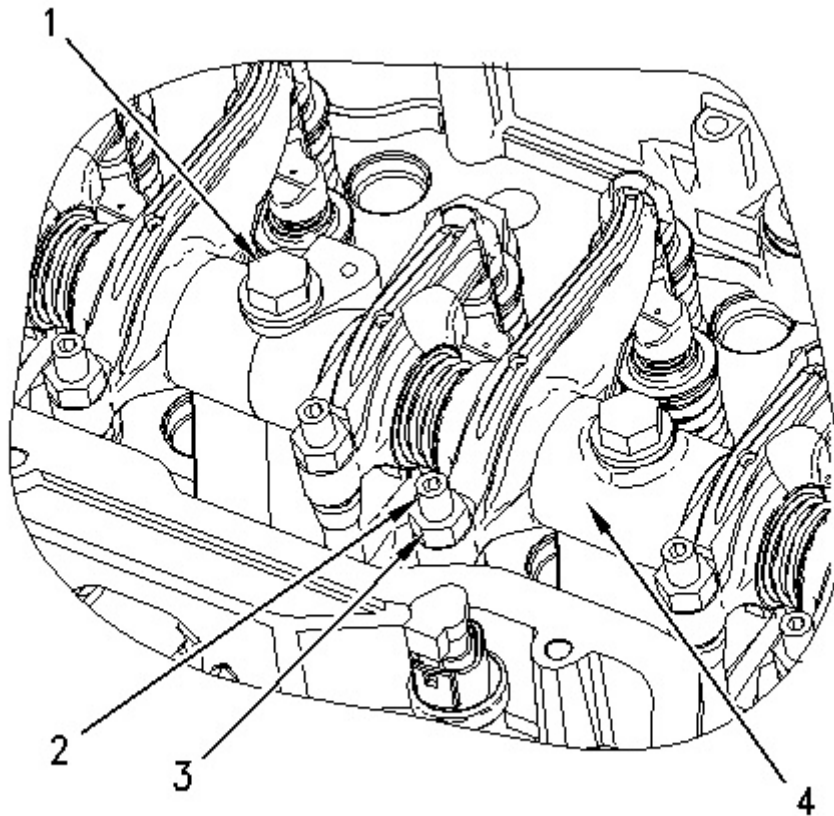

Illustration 1

g00953116

3. Position rocker shaft (4) on the cylinder head. Install bolts (1).

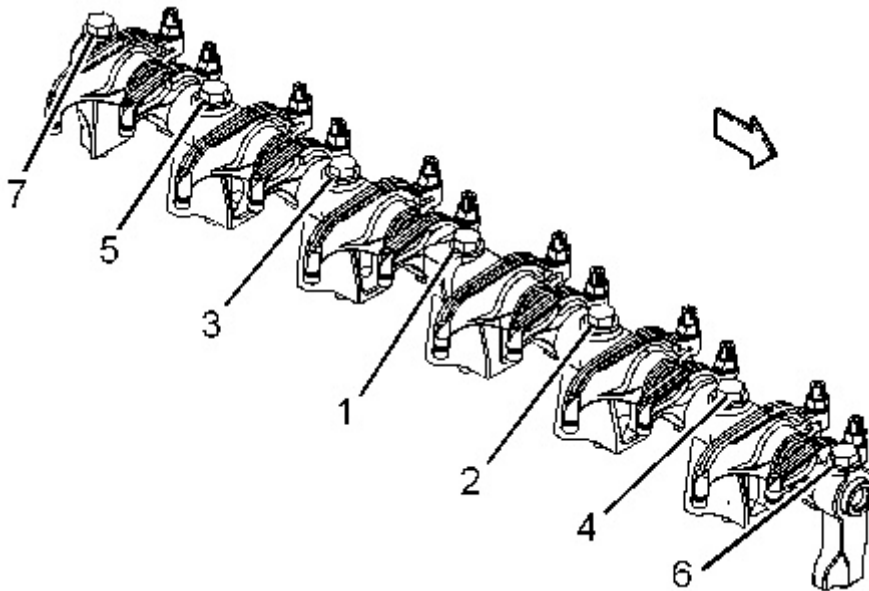

Illustration 2

g02685496

Rocker shaft hold down bolts tightening sequence

4. Tighten bolts (1) in the sequence shown. Tighten bolts (1) to standard torque.

5. Apply Tooling (A) to each of the bottom faces of the rocker arms.
6. Position rocker arm adjustment screws (2) and tighten nuts (3). Adjust the valve lash of the rocker arms. Refer to Testing and Adjusting, "Engine Valve Lash - Inspect/Adjust".

End By:

- a. Install the valve mechanism cover. Refer to Disassembly and Assembly, "Valve Mechanism Cover - Remove and Install".

Product: EXCAVATOR

Model: 330C FM EXCAVATOR B1K

Configuration: 330C Forest Swing Machines B1K00001-UP (MACHINE) POWERED BY C-9 Engine

Disassembly and Assembly

C9

Engine For Caterpillar Built Machines

Media Number -SEN9502-16

Publication Date -01/03/2014

Date Updated -06/03/2014

i02273201

Cylinder Head - Remove

SMCS - 1100-011

Removal Procedure

Table 1

| Required Tools | | | |
|----------------|-------------|------------------|-----|
| Tool | Part Number | Part Description | Qty |
| A | 138-7575 | Link Bracket | 2 |

Start By:

- A. Remove the rocker arm and shaft. Refer to Disassembly and Assembly, "Rocker Arm and Shaft - Remove".
- B. Remove the unit injectors. Refer to Disassembly and Assembly, "Unit Injector - Remove".
- C. Remove the alternator. Refer to Disassembly and Assembly, "Alternator - Remove and Install".
- D. Remove the valve mechanism cover base. Refer to Disassembly and Assembly, "Valve Mechanism Cover Base - Remove and Install".

NOTICE

Keep all parts clean from contaminants.

Contaminants may cause rapid wear and shortened component life.

NOTICE

Thank you so much for reading.
Please click the “Buy Now!”
button below to download the
complete manual.



After you pay.

You can download the most
perfect and complete manual in
the world immediately.

Our support email:

ebooklibonline@outlook.com