



Service Repair Manual

Models

330D and 330D L Excavator

Product: EXCAVATOR

Model: 330D L EXCAVATOR GBC

Configuration: 330D & 330D L Excavators GBC00001-UP (MACHINE) POWERED BY C9 Engine

Disassembly and Assembly C9 Engines for Caterpillar Built Machines

Media Number -REN9579-20

Publication Date -01/02/2015

Date Updated -15/08/2018

i04506590

Rocker Arm and Shaft - Install

SMCS - 1102-012

Installation Procedure

Table 1

Required Tools			
Tool	Part Number	Part Description	Qty
A	8T-2998	Lubricant	-

NOTICE

Keep all parts clean from contaminants.

Contaminants may cause rapid wear and shortened component life.

1. Apply Tooling (A) to both ends of the pushrods.
 2. Lubricate the pushrods with clean engine oil. Install the pushrods and the valve bridges.
-

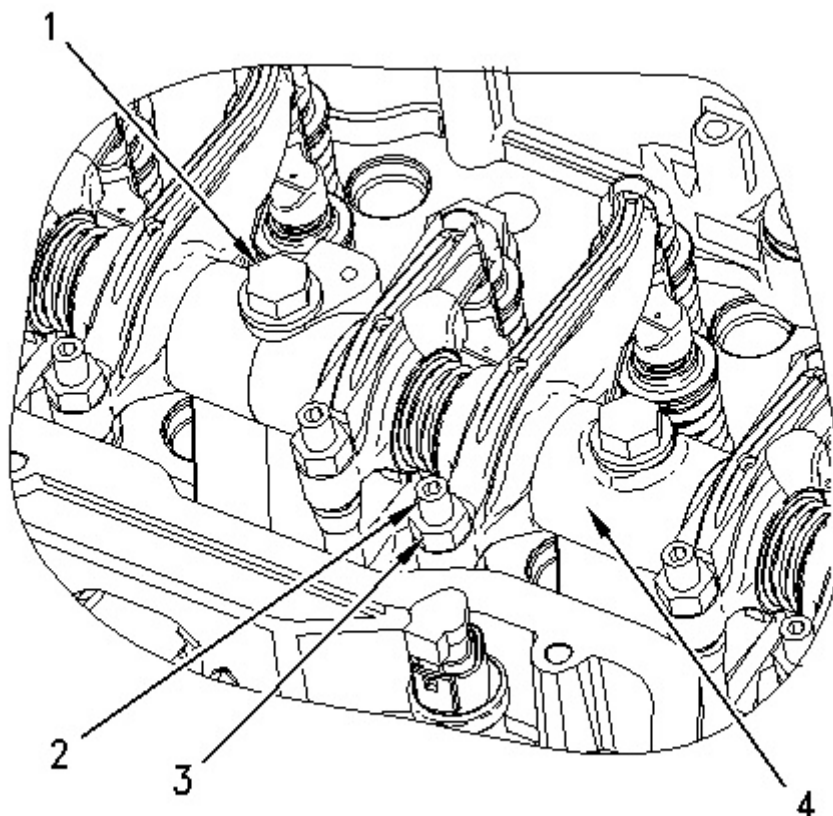

Illustration 1

g00953116

3. Position rocker shaft (4) on the cylinder head. Install bolts (1).

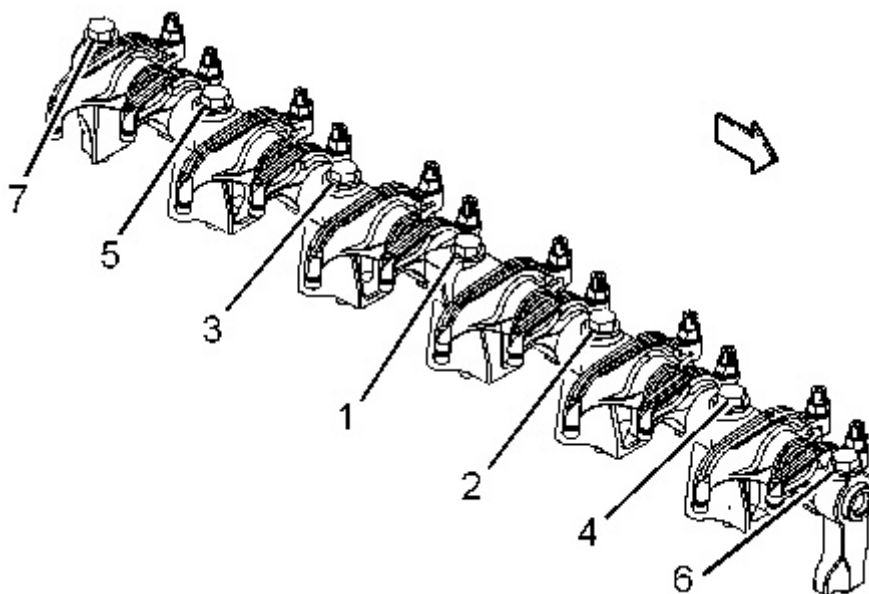

Illustration 2

g02685496

Rocker shaft hold down bolts tightening sequence

4. Tighten bolts (1) in the sequence shown. Tighten bolts (1) to standard torque.

5. Apply Tooling (A) to each of the bottom faces of the rocker arms.
6. Position rocker arm adjustment screws (2) and tighten nuts (3). Adjust the valve lash of the rocker arms. Refer to Testing and Adjusting, "Engine Valve Lash - Inspect/Adjust".

End By:

- a. Install the valve mechanism cover. Refer to Disassembly and Assembly, "Valve Mechanism Cover - Remove and Install".

Product: EXCAVATOR

Model: 330D L EXCAVATOR GBC

Configuration: 330D & 330D L Excavators GBC00001-UP (MACHINE) POWERED BY C9 Engine

Disassembly and Assembly C9 Engines for Caterpillar Built Machines

Media Number -REN9579-20

Publication Date -01/02/2015

Date Updated -15/08/2018

i02308888

Cylinder Head - Remove

SMCS - 1100-011

Removal Procedure

Table 1

Required Tools			
Tool	Part Number	Part Description	Qty
A	138-7575	Link Bracket	1

Start By:

- Remove the rocker arm and shaft. Refer to Disassembly and Assembly, "Rocker Arm and Shaft - Remove".
- Remove the valve mechanism cover base. Refer to Disassembly and Assembly, "Valve Mechanism Cover Base - Remove and Install".
- Remove the fan drive. Refer to Disassembly and Assembly, "Fan Drive - Remove".

NOTICE

Care must be taken to ensure that fluids are contained during performance of inspection, maintenance, testing, adjusting, and repair of the product. Be prepared to collect the fluid with suitable containers before opening any compartment or disassembling any component containing fluids.

Refer to Special Publication, NENG2500, "Dealer Service Tool Catalog" for tools and supplies suitable to collect and contain fluids on Cat® products.

Thank you so much for reading.
Please click the “Buy Now!”
button below to download the
complete manual.



After you pay.

You can download the most
perfect and complete manual in
the world immediately.

Our support email:

ebooklibonline@outlook.com