



Service Repair Manual

Models

336D2, 336D2 L and
336D2 GC Excavator

Product: EXCAVATOR

Model: 336D2 GC EXCAVATOR FBT

Configuration: 336D2, 336D2 L & 336D2 GC Excavators FBT00001-UP (MACHINE) POWERED BY C9 Engine

Disassembly and Assembly 336D2/336D2 GC Excavator Engine Supplement

Media Number -M0065624-02

Publication Date -01/09/2015

Date Updated -10/08/2018

i06902221

Engine Oil Filter and Oil Filter Base - Remove and Install

SMCS - 1306-010; 1308-010

Removal Procedure

Table 1

Required Tools			
Tool	Part Number	Part Description	Qty
A	187-2718	Filter Wrench	1
B	-	LOCTITE 263	-
	-	LOCTITE 270 ⁽¹⁾	-

⁽¹⁾ Europe Only



Illustration 1

g06033894

1. Open door (1).

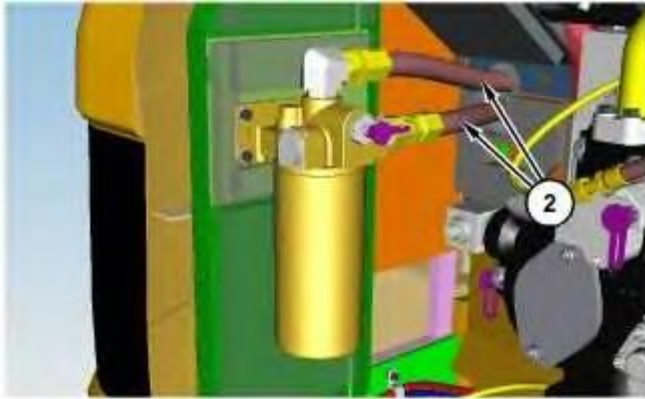

Illustration 2

g06037216

2. Disconnect hose assemblies (2).

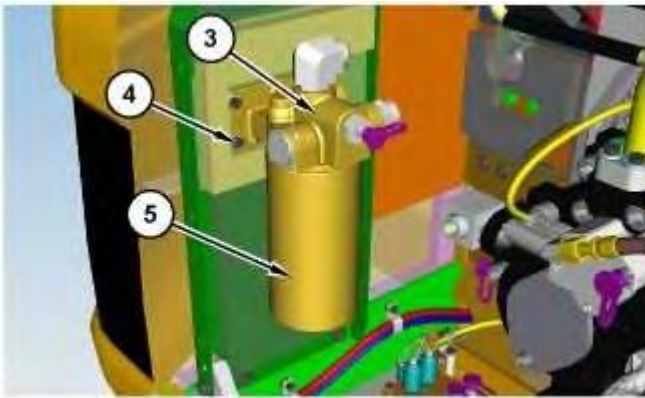

Illustration 3

g06037217

3. Use Tooling (A) to remove engine oil filter (5).
4. Remove bolts (4) and engine oil filter base (3).

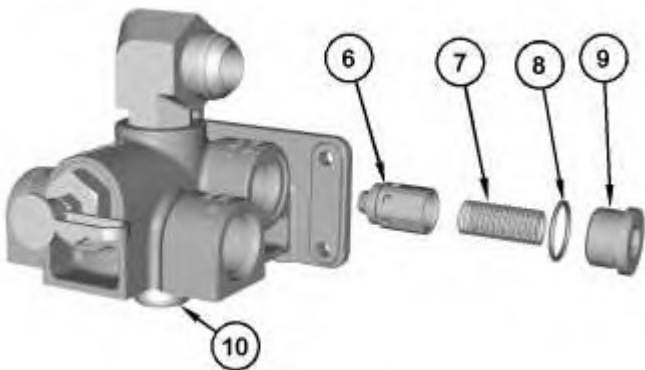

Illustration 4

g06037218

 **WARNING**

Personal injury can result from being struck by parts propelled by a released spring force.

Make sure to wear all necessary protective equipment.

Follow the recommended procedure and use all recommended tooling to release the spring force.

5. Remove plug (9), O-ring seal (8), spring (7), and plunger (6).
6. If necessary, remove stud (10).

Installation Procedure

1. Install engine oil filter base (3) in the reverse order of removal.
 - a. Apply Tooling (B) to the threads of stud (10). Apply Tooling (B) to a length of 20.0 ± 0.8 mm (0.79 ± 0.03 inch) on stud (10).
 - b. Tighten stud (10) to a torque of 68 ± 7 N·m (50 ± 5 lb ft).

Product: EXCAVATOR

Model: 336D2 GC EXCAVATOR FBT

Configuration: 336D2, 336D2 L & 336D2 GC Excavators FBT00001-UP (MACHINE) POWERED BY C9 Engine

Disassembly and Assembly 336D2/336D2 GC Excavator Engine Supplement

Media Number -M0065624-02

Publication Date -01/09/2015

Date Updated -10/08/2018

i06598847

Engine Oil Cooler - Remove and Install

SMCS - 1378-010

Removal Procedure

Table 1

Required Tools			
Tool	Part Number	Part Description	Qty
A	-	Loctite 242	-

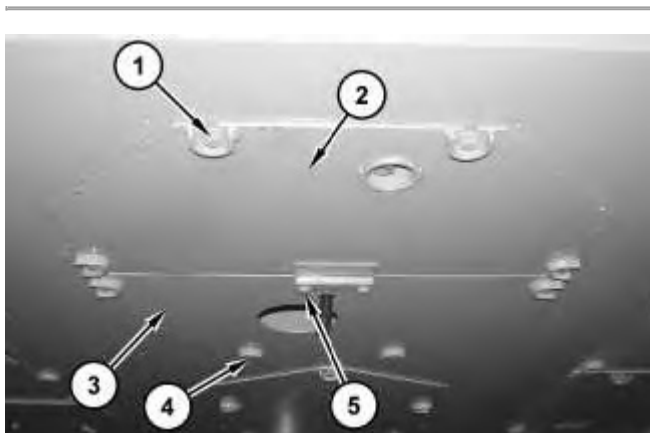

Illustration 1

g02177953

1. Remove two bolts (5).
2. Remove bolts (1) and plate assembly (2).
3. Remove bolts (4) and plate assembly (3).

Thank you so much for reading.
Please click the “Buy Now!”
button below to download the
complete manual.



After you pay.

You can download the most
perfect and complete manual in
the world immediately.

Our support email:

ebooklibonline@outlook.com