



# Service Repair Manual

## **Models**

336D2 and 336D2 L Excavator

---

Product: EXCAVATOR

Model: 336D2 EXCAVATOR WDC

Configuration: 336D2 & 336D2 L Excavators WDC00001-UP (MACHINE) POWERED BY C9 Engine

## Disassembly and Assembly

### 330D, 336D, 336D2, 340D and 340D2 Excavators and 336D MHPU Mobile Hydraulic Power Unit Machine Systems

Media Number -REN8648-30

Publication Date -01/03/2015

Date Updated -15/08/2018

i02415273

## Piston Motor (Hydraulic Fan) - Assemble

SMCS - 1386-016-QP; 5058-016-FM; 5058-016-HFN

## Assembly Procedure

Table 1

Required Tools			
Tool	Part Number	Part Description	Qty
B	1P-1861	Retaining Ring Pliers	1
C	1P-0510	Driver Gp	1

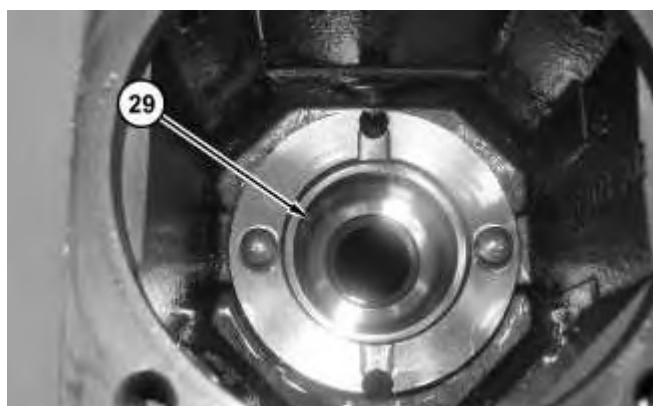

Illustration 1

g01207288

1. Install bearing cup (29).

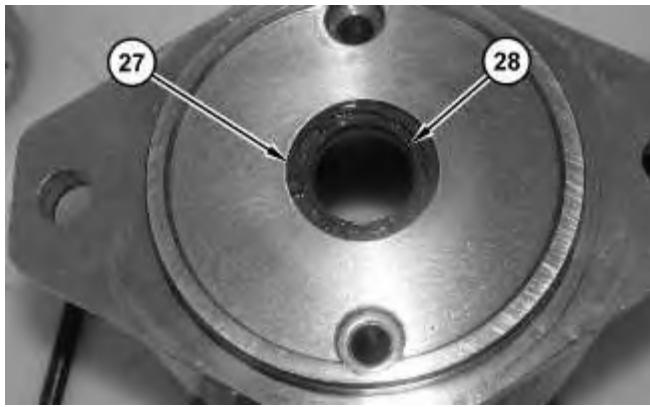

Illustration 2

g01207286

2. Install lip seal (28).
3. Use Tooling (C) in order to install retaining ring (27).

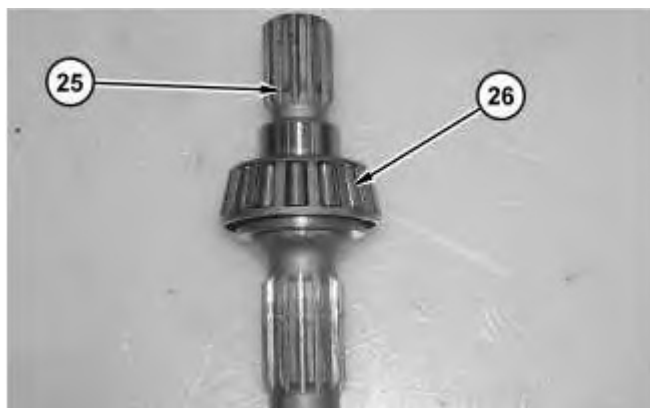

Illustration 3

g01207624

4. Raise the temperature of bearing cone (26).
5. Install bearing cone (26) onto shaft (25).

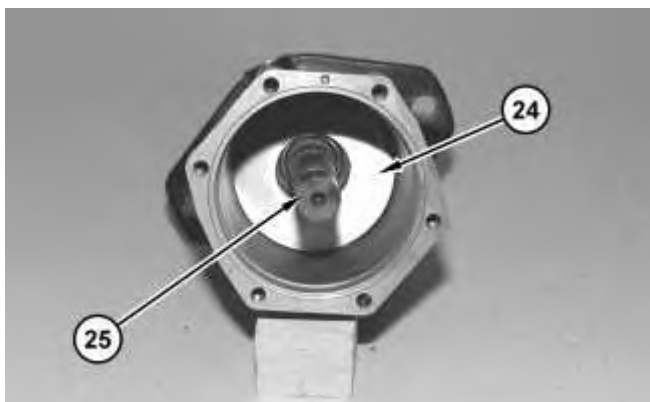

Illustration 4

g01207285

6. Install shaft (25) and swashplate (24).

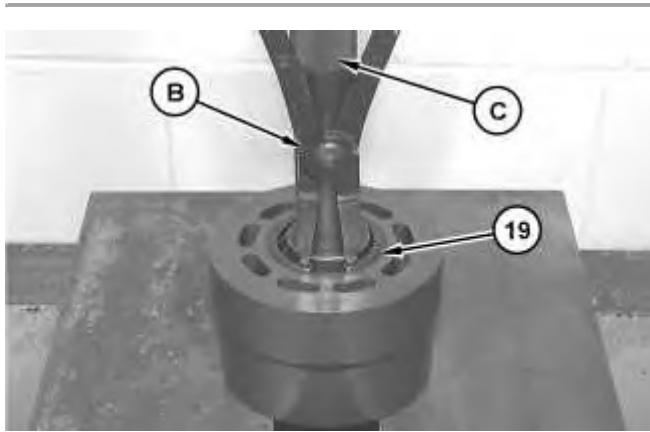

Illustration 5

g01207283

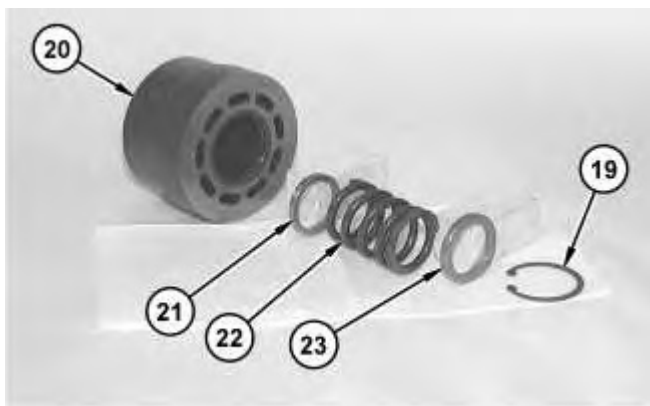

Illustration 6

g01207284



**Improper assembly of parts that are spring loaded can cause bodily injury.**

**To prevent possible injury, follow the established assembly procedure and wear protective equipment.**

- 
7. Install shim (21), spring (22), and shim (23).
  8. Use Tooling (C) and Tooling (B) in order to install retaining ring (19).
-

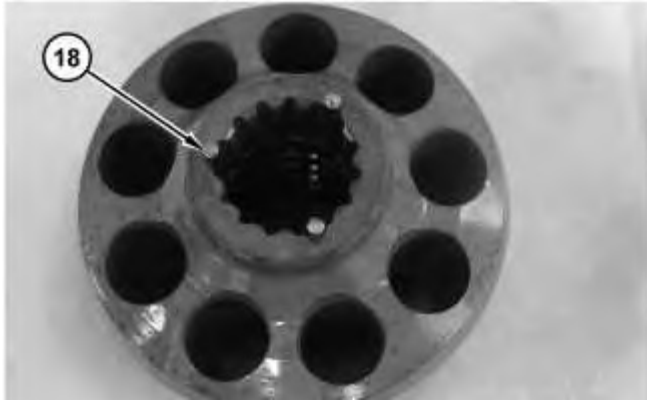

Illustration 7

g01207282

9. Install pins (18).

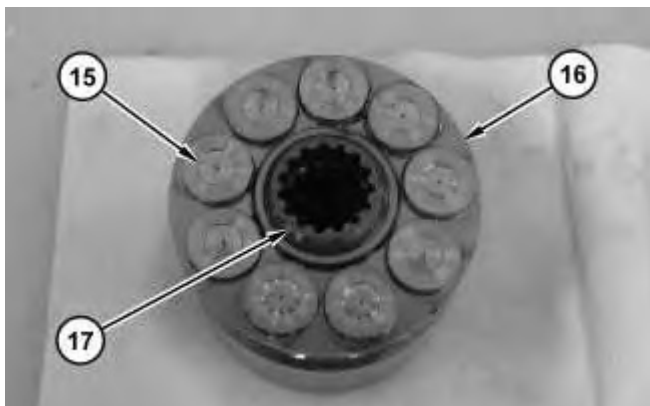

Illustration 8

g01207281

10. Install bearing (17).
11. Install pistons (15) and retainer (16).

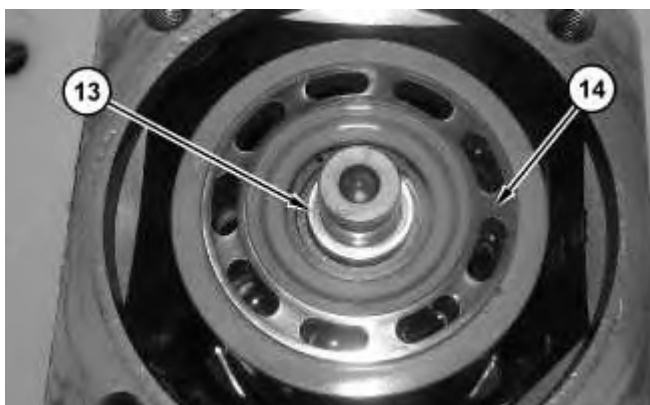

Illustration 9

g01207280

12. Install rotating group (14) and shim (13).

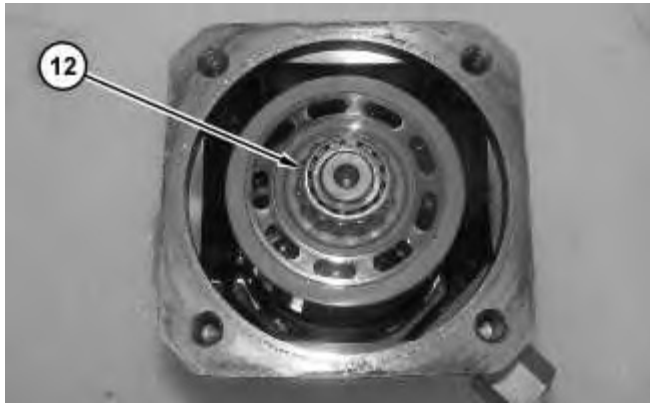

Illustration 10

g01207279

13. Install bearing cone (12).

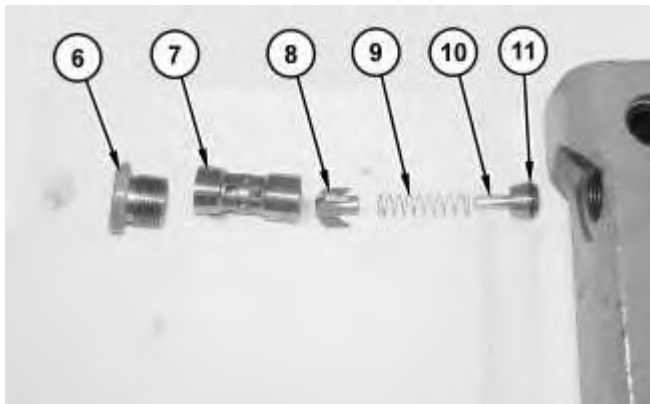

Illustration 11

g01207278



**WARNING**

**Improper assembly of parts that are spring loaded can cause bodily injury.**

**To prevent possible injury, follow the established assembly procedure and wear protective equipment.**

14. Install O-ring seal (11), poppet (10), spring (9), poppet (8), sleeve (7), and plug (6).

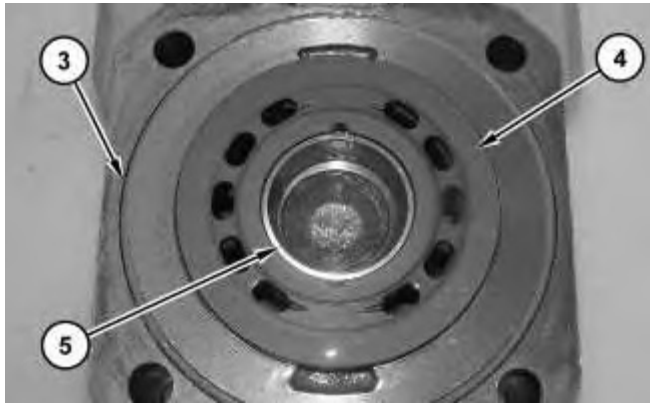

Illustration 12

g01207276

15. Lower the temperature of bearing cup (5).
16. Install bearing cup (5), port plate (4), and O-ring seal (3).

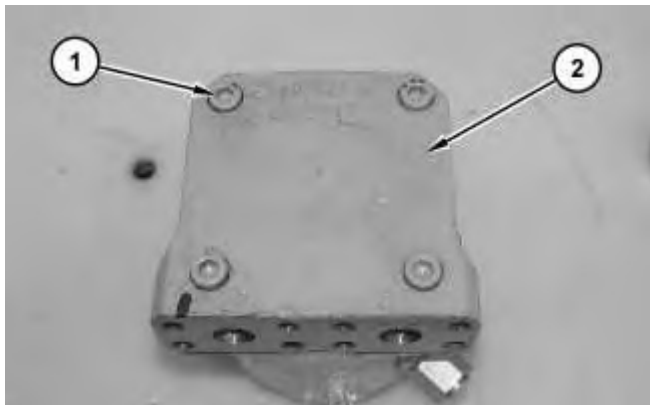

Illustration 13

g01207275



**Improper assembly of parts that are spring loaded can cause bodily injury.**

**To prevent possible injury, follow the established assembly procedure and wear protective equipment.**

17. Install head (2) and bolts (1).

**End By:**

- a. Install the piston motor. Refer to Disassembly and Assembly, "Piston Motor (Hydraulic Fan) - Install".

Thank you so much for reading.  
Please click the “Buy Now!”  
button below to download the  
complete manual.



After you pay.

You can download the most  
perfect and complete manual in  
the world immediately.

Our support email:

[ebooklibonline@outlook.com](mailto:ebooklibonline@outlook.com)