



# Service Repair Manual

## **Models**

340F Excavator

---

Product: EXCAVATOR

Model: 340F EXCAVATOR SGH

Configuration: 340F Excavator SGH00001-UP (MACHINE) POWERED BY C9.3 Engine

## Disassembly and Assembly 340F Excavator Machine Systems

Media Number -UENR6797-01

Publication Date -01/09/2015

Date Updated -21/12/2016

i05393341

### Swing Drive - Disassemble

SMCS - 5459-015

S/N - DKF1-UP

S/N - RBC1-UP

S/N - SGH1-UP

S/N - ZBJ1-UP

### Disassembly Procedure

Table 1

Required Tools			
Tool	Part Number	Part Description	Qty
A	138-7573	Link Bracket	2
B	5P-5197	Retaining Ring Pliers As	1

#### Start By:

- a. Remove the swing drive.
    1. Position the swing drive onto suitable cribbing. The weight of the swing drive is approximately 281 kg (620 lb).
    2. Put an alignment mark on the cover and the housing of the swing drive for assembly purposes.
-

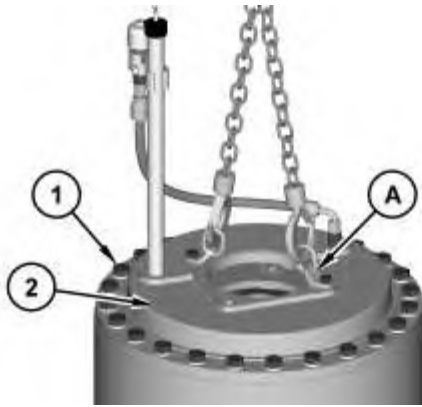

Illustration 1

g02115775

3. Attach Tooling (A) and a suitable lifting device to cover (2). The weight of cover (2) is approximately 23 kg (51 lb). Remove bolts (1) and cover (2).
- 

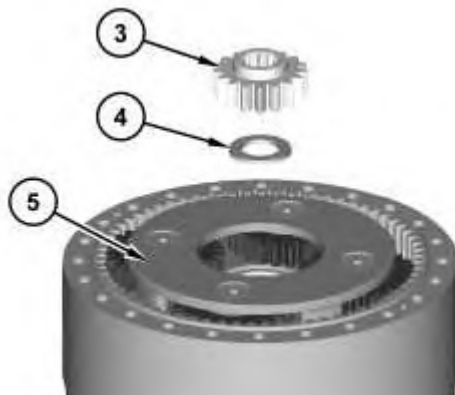

Illustration 2

g02115813

4. Remove sun gear (3) and spacer (4).
  5. Use two people in order to remove carrier assembly (5). The weight of carrier assembly (5) is approximately 23 kg (50 lb).
- 

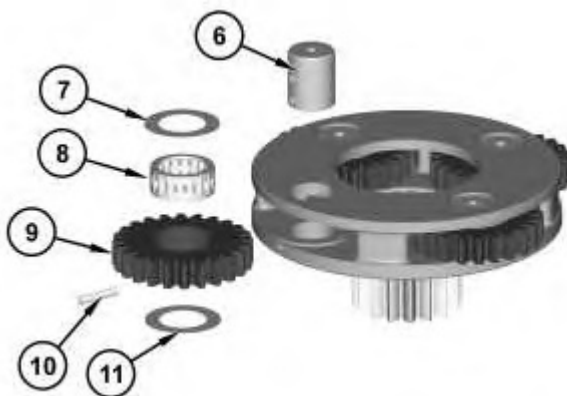

Illustration 3

g02115814

6. Drive spring pin (10) into planetary shaft (6) with a suitable hammer and a suitable punch.
7. Remove planetary shaft (6), thrust washer (7), thrust washer (11), planetary gear (9), and bearing assembly (8) from the carrier assembly.
8. Remove spring pin (10) from planetary shaft (6) with a suitable hammer and a suitable punch.
9. Repeat Step 6 through Step 8 in order to remove the other three planetary gears from the carrier assembly.



---

Illustration 4

g02115853

10. Remove retaining ring (12) and sun gear (14) from the carrier.
11. Remove retaining ring (13) from sun gear (14).

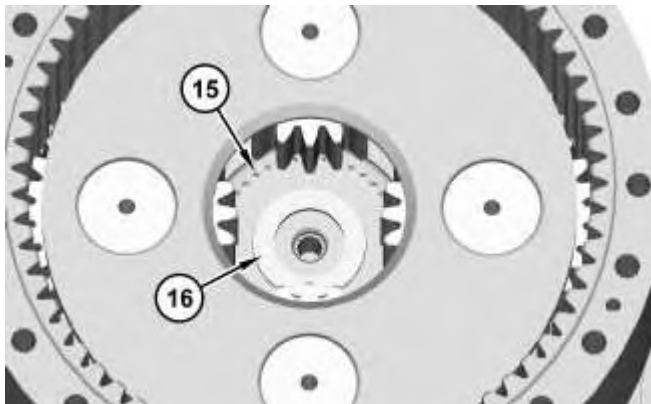

---

Illustration 5

g02115915

---

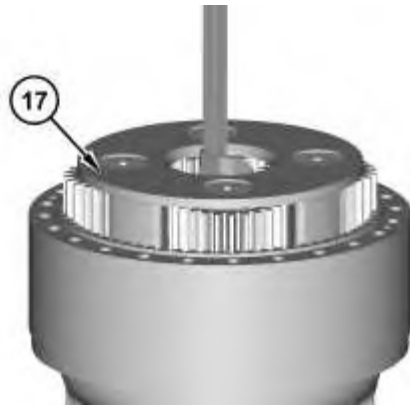

---

Illustration 6

g02115916

12. Remove spacer (16).
13. Remove retaining ring (15) that holds carrier assembly (17) in position.
14. Use a suitable piece of steel bar stock between the planetary gears in carrier assembly (17). Make sure that the steel bar stock is centered in carrier assembly (17). Attach a suitable lifting device to the steel bar stock. Slowly lift carrier assembly (17) from the swing drive housing. The weight of carrier assembly (17) is approximately 39 kg (86 lb).

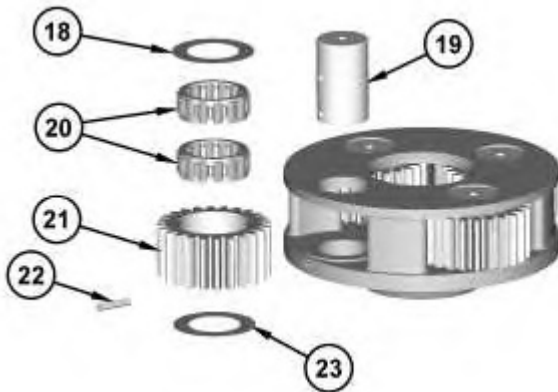

---

Illustration 7

g02115917

15. Drive spring pin (22) into planetary shaft (19) with a suitable hammer and a suitable punch.
  16. Remove planetary shaft (19), thrust washer (18), thrust washer (23), planetary gear (21), and bearing assemblies (20) from the carrier assembly.
  17. Remove spring pin (22) from planetary shaft (19) with a suitable hammer and a suitable punch.
  18. Repeat Step 15 through Step 17 in order to remove the other three planetary gears from the carrier assembly.
-

Thank you so much for reading.  
Please click the “Buy Now!”  
button below to download the  
complete manual.



After you pay.

You can download the most  
perfect and complete manual in  
the world immediately.

Our support email:

[ebooklibonline@outlook.com](mailto:ebooklibonline@outlook.com)