



Service Repair Manual

Models

345B II EXCAVATOR

Table 1

Required Tools			
Tool	Part Number	Part Description	Qty
A	138-7574	Link Bracket	2
B	1P-2420	Transmission Repair Stand	1
C	5P-5197	Retaining Ring Pliers As	1
	1U-8759	Tip Set	1
D	1P-0510	Driver Gp	1

Start By:

- A. Remove the swing drive. Refer to Disassembly and Assembly, "Swing Drive - Remove and Install".

NOTICE

Care must be taken to ensure that fluids are contained during performance of inspection, maintenance, testing, adjusting and repair of the product. Be prepared to collect the fluid with suitable containers before opening any compartment or disassembling any component containing fluids.

Refer to Special Publication, NENG2500, "Caterpillar Tools and Shop Products Guide" for tools and supplies suitable to collect and contain fluids on Caterpillar products.

Dispose of all fluids according to local regulations and mandates.

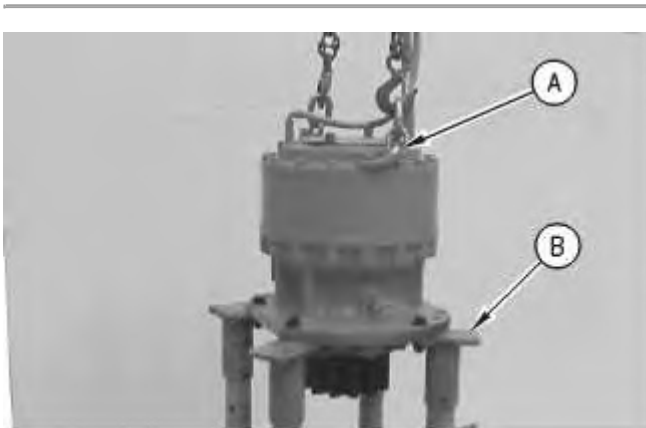

Illustration 1

g00724836

1. Attach Tooling (A) and a suitable lifting device to the swing drive.
2. Position the swing drive on Tooling (B). The weight of the swing drive is approximately 268 kg (570 lb).
3. Open the drain valve, and drain the oil from the swing drive into a suitable container for storage or disposal. The capacity of the swing drive is approximately 11 L (2.9 US gal). If necessary, remove the drain valve from the swing drive housing.

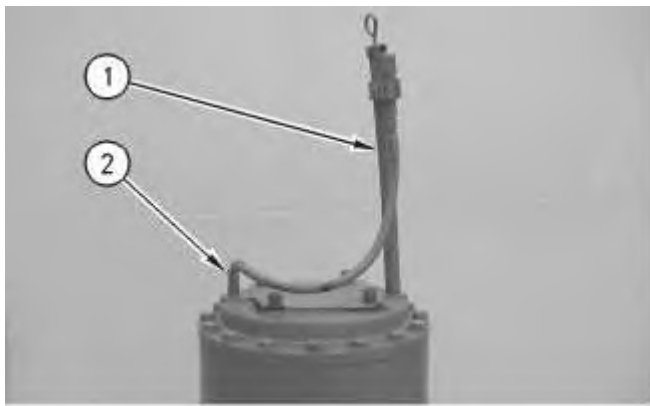

Illustration 2

g00724832

4. Remove oil level gauge (Dipstick) (1), the filler breather cap assembly, and hose assembly (2) from the swing drive.

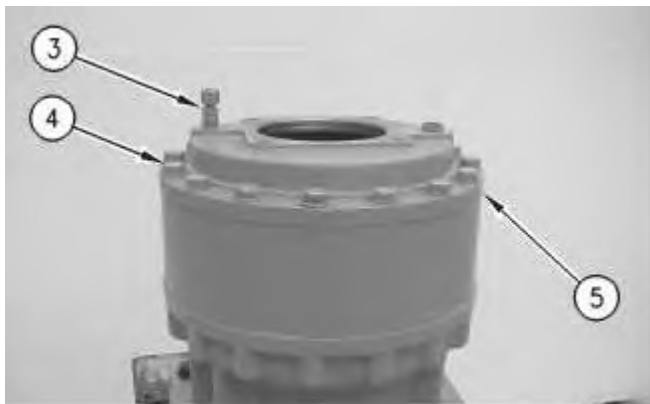

Illustration 3

g00724843

5. Remove fitting (3) from cover (5) .
 6. Remove bolts (4) and the washers from cover (5) .
-

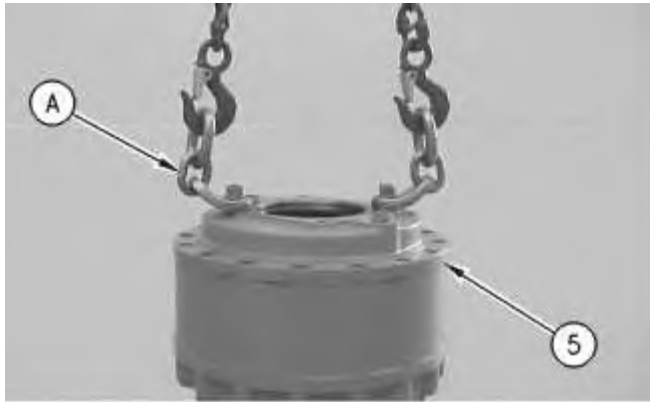

Illustration 4

g00724840

7. Attach Tooling (A) and a suitable lifting device to cover (5). Remove cover (5) .



Illustration 5

g00724854

8. Remove sun gear (6) from the carrier assembly (7) .



Illustration 6

g00724856

9. Remove spacer (8) from carrier assembly (7) .

10. Remove carrier assembly (7) from the swing drive.

11. Disassemble carrier assembly (7), as follows:

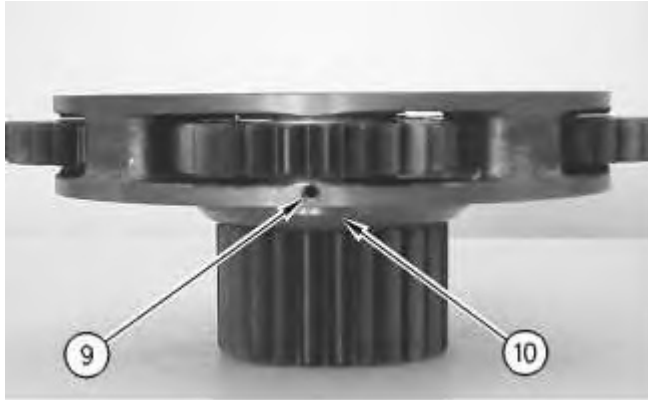

Illustration 7

g00724860

a. Use a hammer and a punch in order to drive spring pin (9) into planetary shaft (10) .

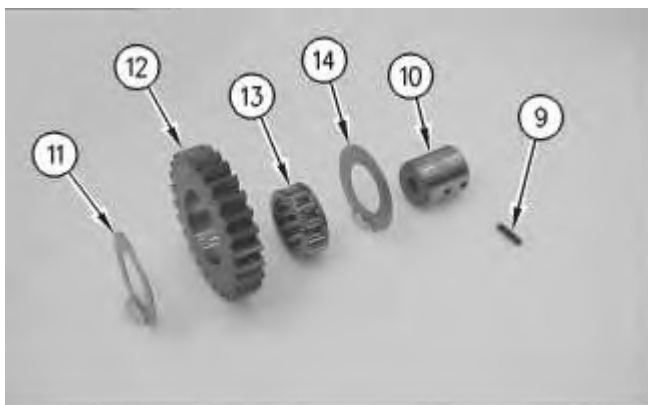

Illustration 8

g00724862

b. Remove planetary shaft (10), thrust washers (11) and (14), and planetary gear (12) from the carrier.

c. Remove bearing (13) from planetary gear (12) .

d. Use a hammer and a punch in order to remove spring pin (9) from the planetary shaft (10) .

e. Repeat Steps 11.a through 11.d in order to remove the remaining planetary gears from the carrier.

Thank you so much for reading.
Please click the “Buy Now!”
button below to download the
complete manual.



After you pay.

You can download the most
perfect and complete manual in
the world immediately.

Our support email:

ebooklibonline@outlook.com