



# Service Repair Manual

## **Models**

# 385B EXCAVATOR

---

Product: EXCAVATOR  
Model: 385B EXCAVATOR BKX  
Configuration: ISJ HEX COMMONALITY CHART BKX00001-UP (MACHINE)

## Disassembly and Assembly 385B and 5090B Excavators Excavator Systems

Media Number -REN5407-06

Publication Date -01/02/2016

Date Updated -12/02/2016

i01674800

## Final Drive - Disassemble

SMCS - 4050-015

## Disassembly Procedure

Table 1

Required Tools			
Tool	Part Number	Part Description	Qty
A	1P-2420	Transmission Repair Stand	1
B	138-7575	Link Bracket	3
C	138-7576	Link Bracket	2
D	132-8119	Hydraulic Wrench	1
	132-8223	Hydraulic Pump and Motor Gp	1
	9U-7418	Hex Bit Socket	1
E	176-6536	Forcing Bolt	2

### Start By:

- a. Remove the final drive. Refer to Disassembly and Assembly, "Final Drive - Remove".
    1. Thoroughly clean the outside of the final drive prior to disassembly.
-



Illustration 1

g00865168

2. Fasten the final drive to Tooling (A). Put an alignment mark across the sections of the final drive for assembly purposes. All parts must be reinstalled in the original locations. The weight of the final drive is approximately 1020 kg (2250 lb).

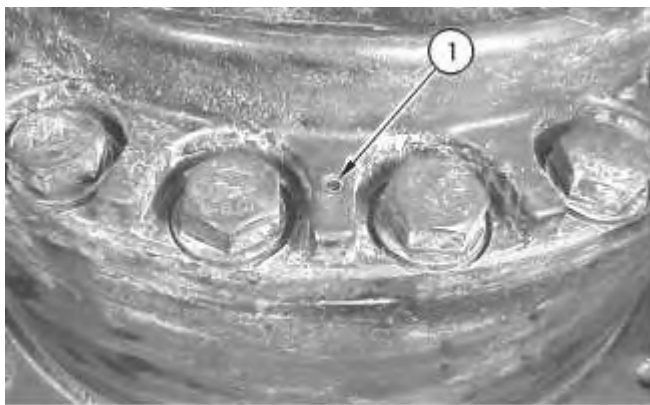

Illustration 2

g00865172

3. Remove socket head bolts (1) from the final drive cover.



Illustration 3

g00865173

4. Fasten Tooling (B) and a suitable lifting device to cover (2).

- Remove bolts (3). Use a soft faced hammer to break the seal between the cover and the ring gear. Remove cover (2). The weight of the cover is approximately 95 kg (210 lb).

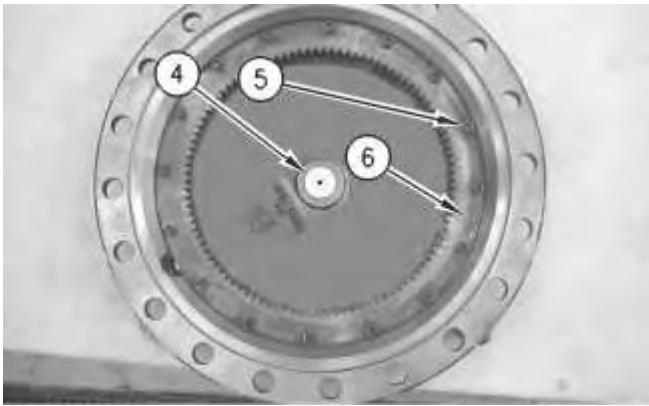

Illustration 4

g00865183

- Remove spacer (4) and the shims from the cover.
- Remove socket head bolts (5) and ring gear (6) from the cover.

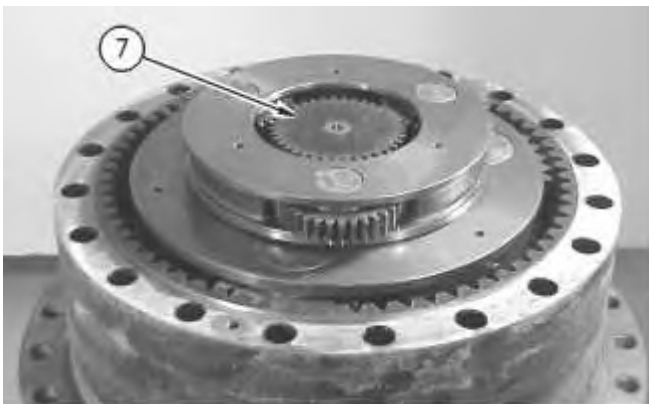

Illustration 5

g00865487

- Remove sun gear (7).



Illustration 6

g00865501

9. Use a hoist and Tooling (B) to remove carrier assembly (8). The weight of the carrier assembly is approximately 43 kg (95 lb).



Illustration 7

g00865534

10. Remove retaining ring (9), spacer (10), and sun gear (11).

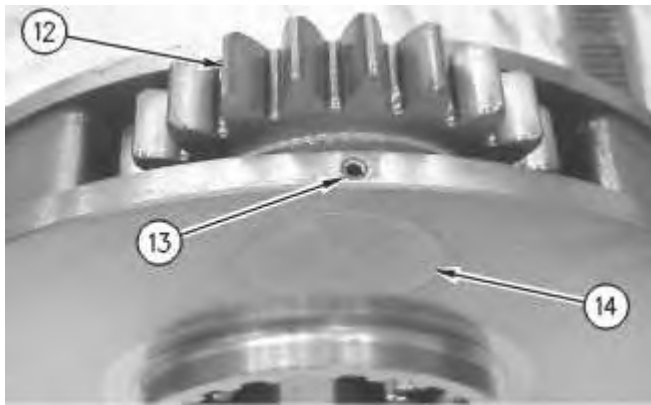

Illustration 8

g00865551

11. Drive spring pin (13) into shaft (14). Remove shaft (14) and gear assembly (12).

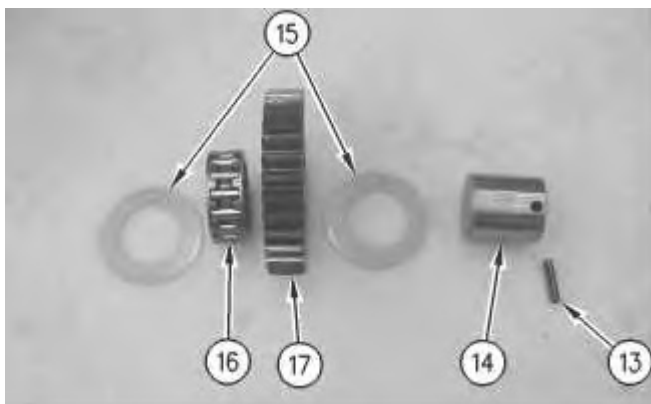

Illustration 9

g00865614

Thank you so much for reading.  
Please click the “Buy Now!”  
button below to download the  
complete manual.



After you pay.

You can download the most  
perfect and complete manual in  
the world immediately.

Our support email:

[ebooklibonline@outlook.com](mailto:ebooklibonline@outlook.com)