



Service Repair Manual

Models

5090B FRONT SHOVEL

Product: FRONT SHOVEL

Model: 5090B FRONT SHOVEL CLD

Configuration: 5090B Excavator CLD00001-UP (MACHINE) POWERED BY 3456 Engine

Disassembly and Assembly 385B and 5090B Excavators Excavator Systems

Media Number -REN5407-06

Publication Date -01/02/2016

Date Updated -12/02/2016

i02011964

Swing Drive - Assemble

SMCS - 5459-016

Assembly Procedure

Table 1

Required Tools			
Tool	Part Number	Part Description	Qty
A	5P-5197	Pliers	1
B	138-7574	Link Brackets	2
C	138-7575	Link Bracket	3

Note: Cleanliness is an important factor. Before assembly, all parts should be thoroughly cleaned in cleaning fluid. Allow the parts to air dry. Wiping cloths or rags should not be used to dry parts. Lint may be deposited on the parts which may cause later trouble. Inspect all parts. If any parts are worn or damaged, use new parts for replacement.

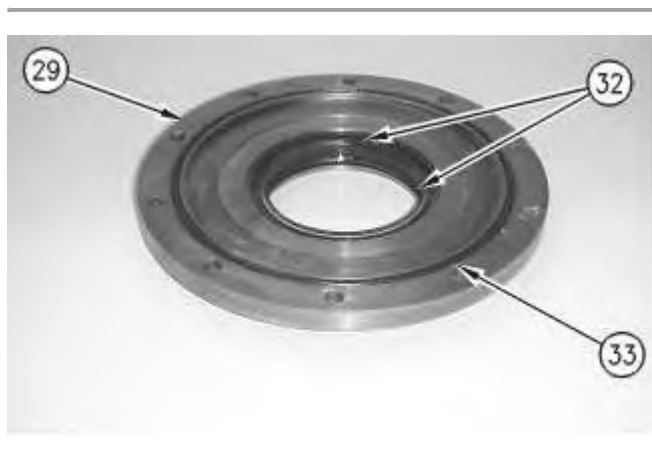

1. Install lip type seals (32) and O-ring seal (33) in bearing cage (29).

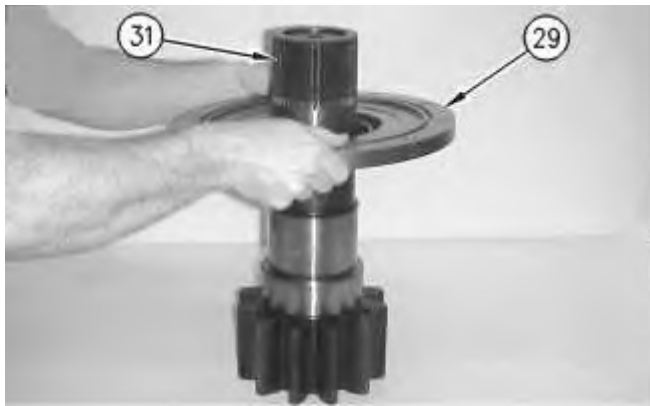

Illustration 2

g00870134

Note: Lubricate the seals and the seal surface of the shaft before you install the cage assembly.

2. Carefully install cage (29) on shaft (31).

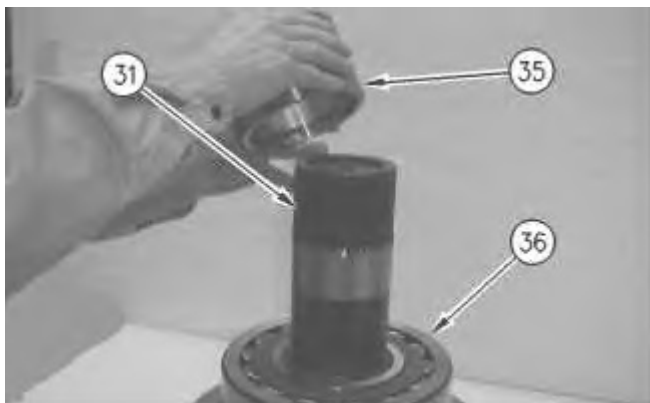

Illustration 3

g00870142

3. Raise the temperature of bearing (36) to 135 °C (275 °F) and use two people to install the bearing on shaft (31). The weight of bearing (36) is approximately 35 kg (77 lb).
 4. Install spacer (35) on shaft assembly (31). Install the spacer with relief against bearing (36).
-



Illustration 4

g00870160

5. Raise the temperature of bearing (34) to 135 °C (275 °F). Install the bearing on shaft (31) and against spacer (35).

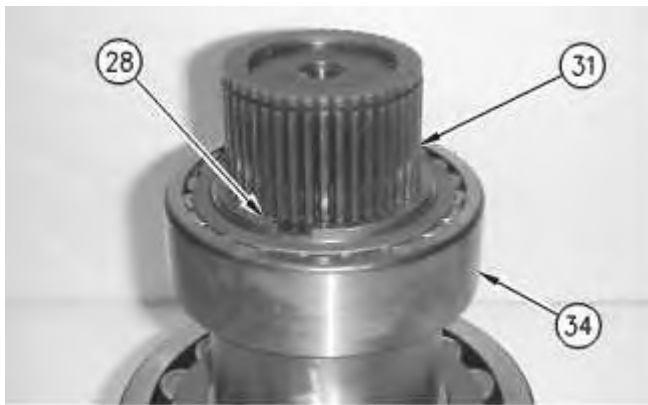

Illustration 5

g00870169

6. Use Tooling (A) to install retaining ring (28) on shaft (31) and against bearing (34).

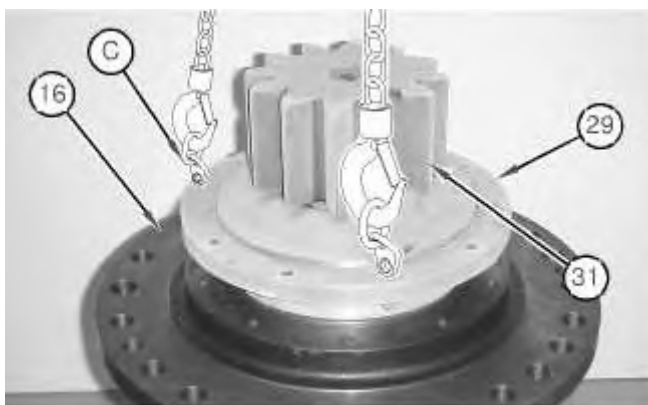

Illustration 6

g01040433

7. Install shaft assembly (31) in swing drive housing (16).

- a. Apply **5P-3931** Anti-Seize Compound on the inside diameter of swing drive housing (16).
- b. Lower the temperature of shaft assembly (31).
- c. Attach Tooling (C) and a suitable lifting device to shaft assembly (31).
- d. Install the shaft assembly into swing drive housing (16). Bearing (34) must be within the bore of the swing drive housing.
- e. Remove Tooling (C) and the lifting device from shaft assembly (31). Attach the tooling and the lifting device to the swing drive housing.
- f. Lift the swing drive vertically. Use a hammer and a drift to align bearing (34) in the lower bore of the swing drive housing. When the bearing is properly aligned in the bore, shaft assembly (31) will drop into the proper position within the swing drive housing.

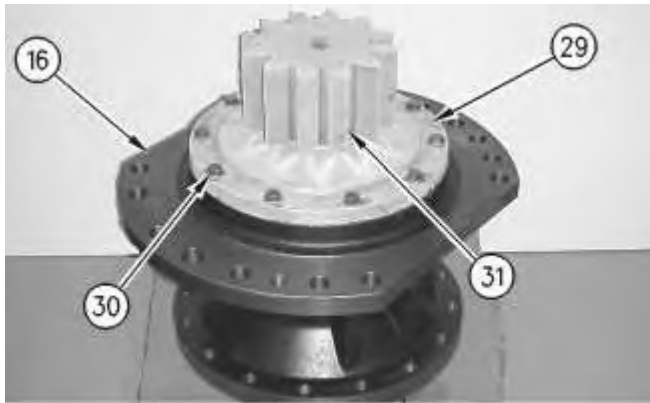

Illustration 7

g00870264

8. Apply **1U-8846** Sealant on the threads of bolts (30).
9. Install bolts (30) and washers in bearing cage (29) and swing drive housing (16).

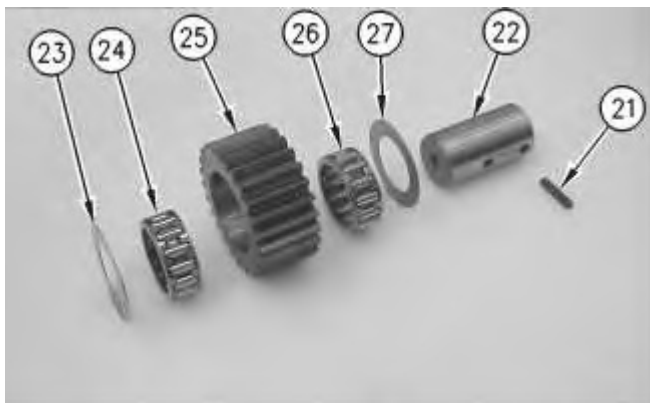

Illustration 8

g00869483

Thank you so much for reading.
Please click the “Buy Now!”
button below to download the
complete manual.



After you pay.

You can download the most
perfect and complete manual in
the world immediately.

Our support email:

ebooklibonline@outlook.com