

Product: WHEEL TRACTOR  
Model: 637D WHEEL TRACTOR 71W  
Configuration: 637D TRACTOR 71W00001-UP (MACHINE)

## Disassembly and Assembly 3408E and 3412E Engines for Caterpillar Built Machines

Media Number -SEN1013-11

Publication Date -01/07/2015

Date Updated -22/08/2016

i04977629

# Flywheel Housing - Remove and Install

SMCS - 1157-010

## Removal Procedure

Table 1

Required Tools			
Tool	Part Number	Part Description	Qty
A	138-7575	Link Bracket	2
B	138-7573	Link Bracket	2

### Start By:

- A. Remove the turbocharger. Refer to Disassembly and Assembly, "Turbocharger - Remove".
- B. Remove the crankshaft rear seal and the wear sleeve. Refer to Disassembly and Assembly, "Crankshaft Rear Seal - Remove".
- C. Remove the engine oil pan. Refer to Disassembly and Assembly, "Engine Oil Pan - Remove and Install".

---

### NOTICE

**Keep all parts clean from contaminants.**

**Contaminants may cause rapid wear and shortened component life.**

---

**Note:** There are many possible configurations of the rear gear group and the flywheel housing. The following procedure illustrates a typical example.

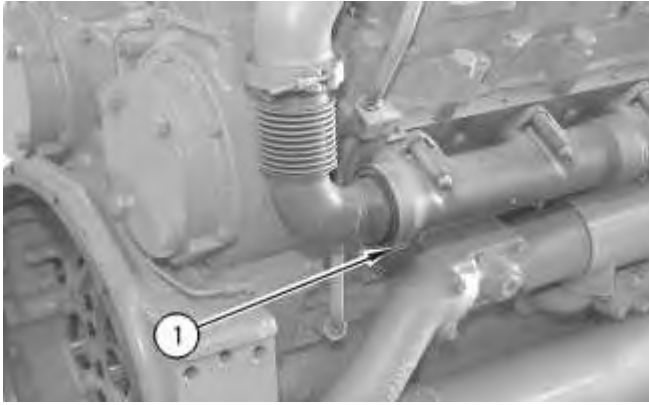

Illustration 1

g00585225

Typical example

1. Remove exhaust clamp (1) from the right side of the engine.

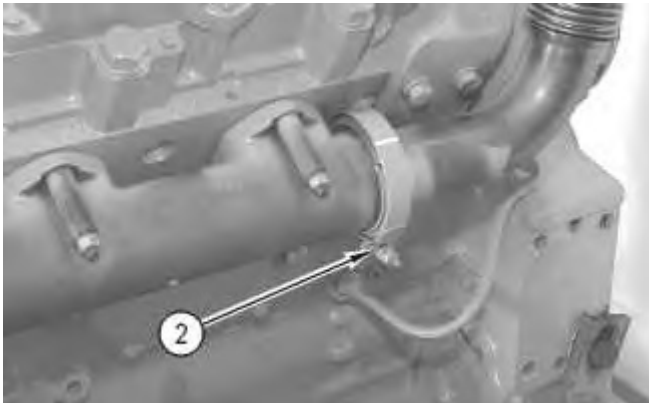
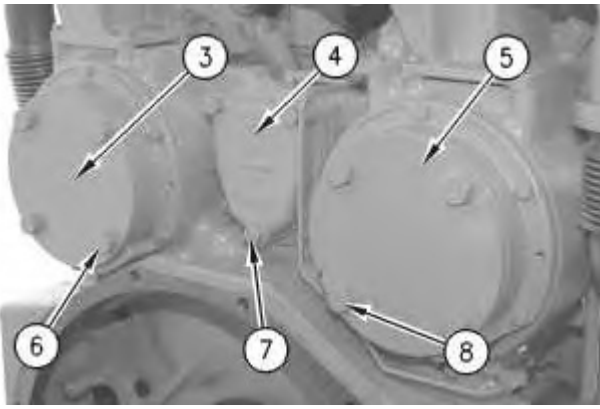

Illustration 2

g00585471

Typical example

2. Remove exhaust clamp (2) from the left side of the engine.
-



---

Illustration 3

g00585475

Typical example

3. Remove bolts (6), cover (3), bolts (7), cover (4), bolts (8), cover (5), and the gaskets.

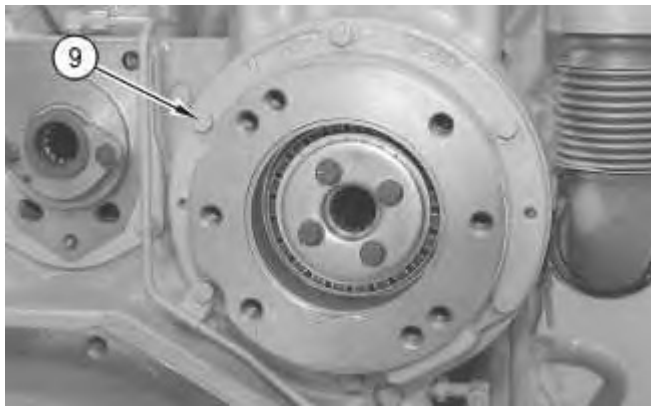

---

Illustration 4

g00585472

Typical example

4. Remove bolts (9) .
-

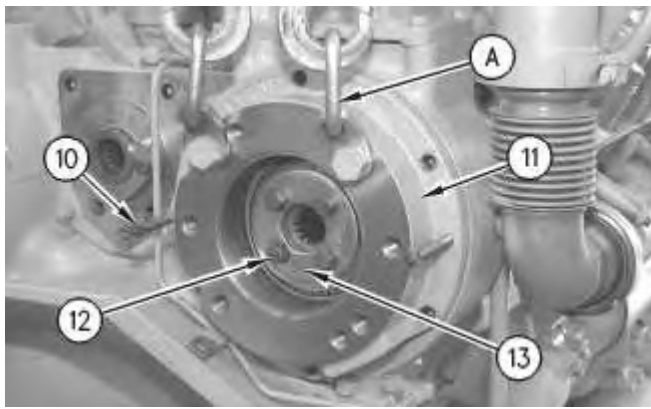

Illustration 5

g00585510

Typical example

5. Install Tools (A), and a suitable lifting device to adapter assembly (11) .
6. Use the correct sized forcing screws (10) in order to separate adapter assembly (11) from the flywheel housing.

The weight of the adapter assembly is approximately 31 kg (68 lb).

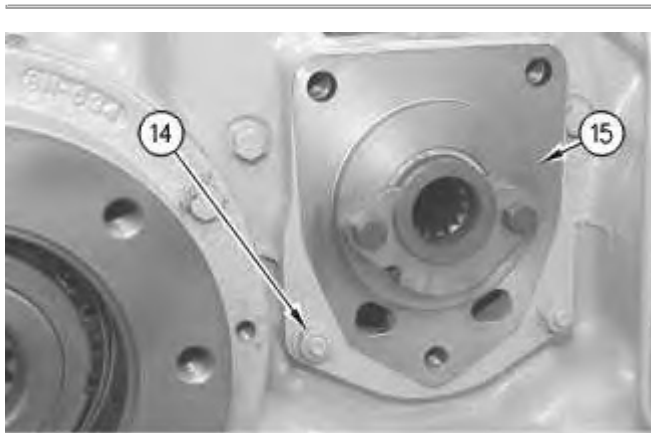

Illustration 6

g00585514

Typical example

7. Remove two nuts (14) and the washers.
8. Remove adapter assembly (15) .



---

Illustration 7

g00585525

Typical example

9. Remove O-ring seal (16) from adapter assembly (15), if necessary.

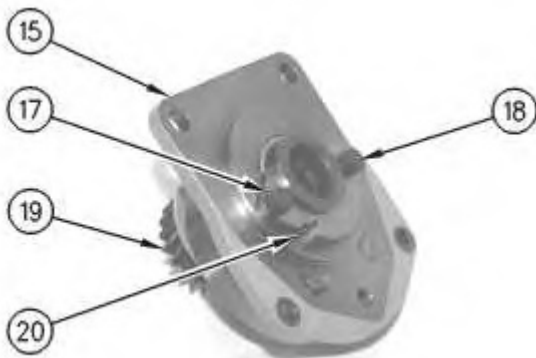

---

Illustration 8

g00585528

Typical example

10. Remove pin (20), bolts (18), washer (17), and gear (19) from adapter assembly (15), if necessary.
-

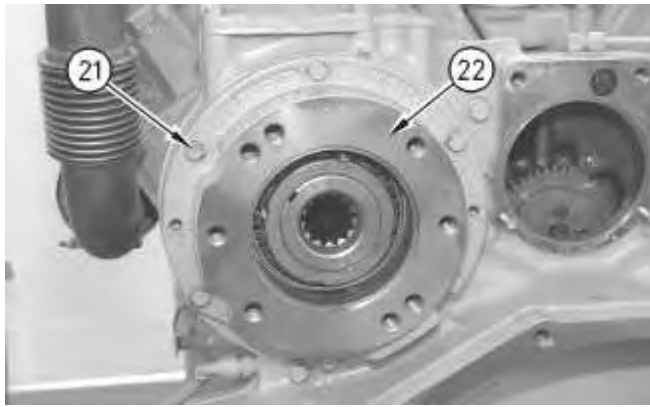

Illustration 9

g00585611

Typical example

11. Remove bolts (21) from adapter assembly (22) .

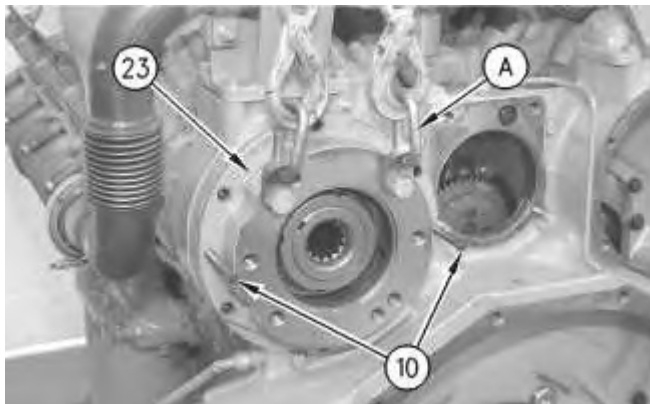

Illustration 10

g00585651

Typical example

12. Install Tools (A). Attach a suitable lifting device to adapter assembly (22) .
13. Use the correct sized forcing screws (10) in order to remove adapter assembly (22) .

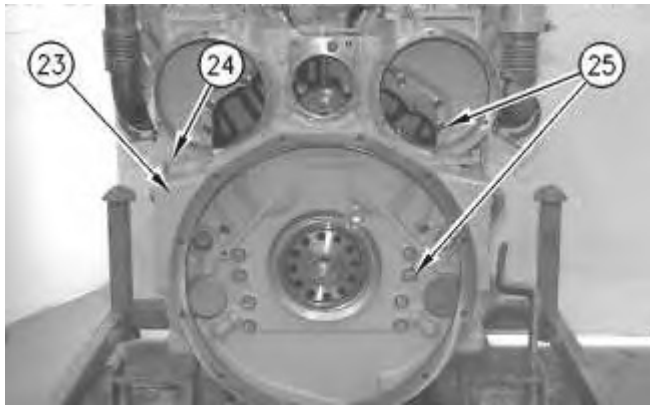

Illustration 11

g00585657

Typical example

14. Install Tools (B). Attach a suitable lifting device to flywheel housing (23) .  
The weight of the flywheel housing is approximately 160 kg (350 lb).
15. Remove hose assembly (24) .
16. Remove bolts (25) .
17. Remove flywheel housing (23) .
18. Remove all of the gasket material from the flywheel housing and the cylinder block.

## Installation Procedure

Table 2

Required Tools			
Tool	Part Number	Part Description	Qty
A	138-7575	Link Bracket	1
B	138-7573	Link Bracket	2
C	-	Loctite 596	-

---

### NOTICE

**Keep all parts clean from contaminants.**

**Contaminants may cause rapid wear and shortened component life.**

---

Thank you so much for reading.  
Please click the “Buy Now!”  
button below to download the  
complete manual.



After you pay.

You can download the most  
perfect and complete manual in  
the world immediately.

Our support email:

[ebooklibonline@outlook.com](mailto:ebooklibonline@outlook.com)