

Product: TRACK LOADER

Model: 953D TRACK LOADER LBP

Configuration: 953D TRACK-TYPE LOADER LBP00001-UP (MACHINE) POWERED BY C6.6 Engine

## Disassembly and Assembly C6.6 Engines for Caterpillar Built Machines

Media Number -KENR6081-15

Publication Date -01/03/2014

Date Updated -04/03/2014

i02786808

# Valve Mechanism Cover Base - Remove and Install

SMCS - 1120-010

## Removal Procedure

Table 1

Required Tools			
Tool	Part Number	Part Description	Qty
A	1P-1860	Retaining Ring Pliers	1

### Start By:

- a. Remove the valve mechanism cover. Refer to Disassembly and Assembly, "Valve Mechanism Cover - Remove and Install".
- b. Remove the fuel injection lines. Refer to Disassembly and Assembly, "Fuel Injection Lines - Remove".

---

### NOTICE

**Keep all parts clean from contaminants.**

**Contaminants may cause rapid wear and shortened component life.**

---

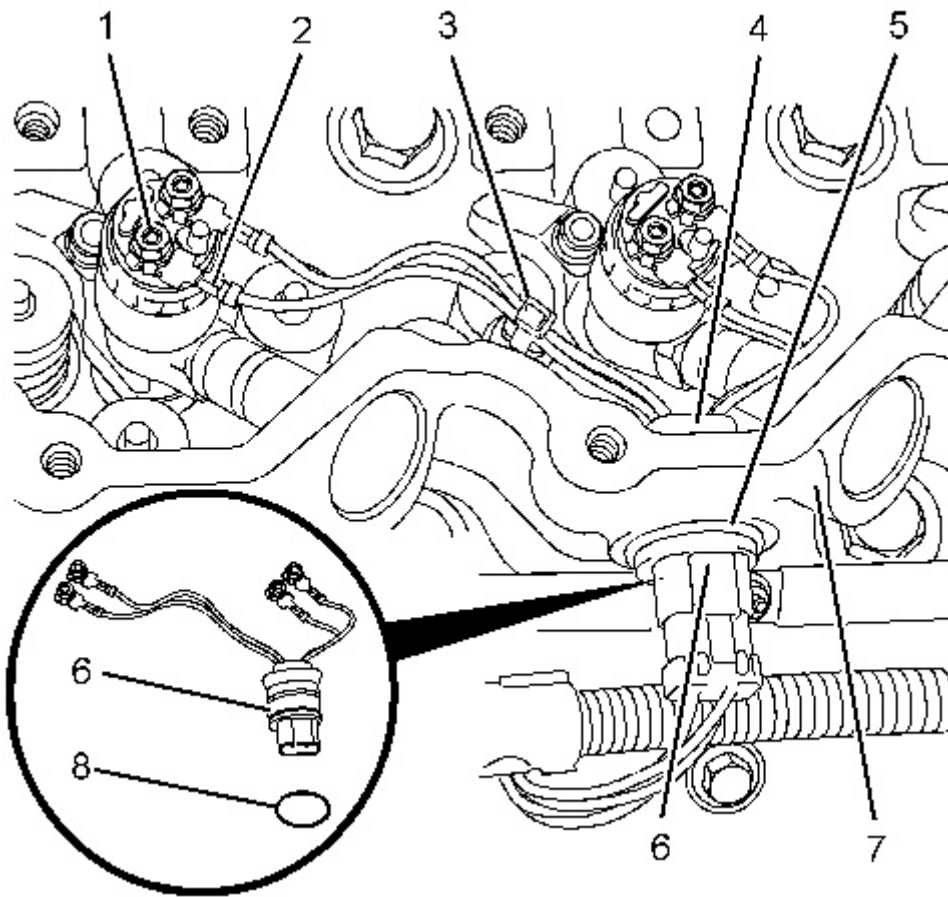

Illustration 1

g01342484

1. Place a temporary identification mark on connections (1) for harness assembly (4).
2. Use a deep socket to remove connections (1) from electronic unit injectors (2).
3. If necessary, follow steps 3.a through 3.f in order to remove harness assemblies (4) from valve mechanism cover base (7).
  - a. Cut cable strap (3).
  - b. Disconnect plug (6) from harness assembly (4).
  - c. Use Tooling (A) to remove circlip (5).
  - d. From the outside of valve mechanism cover base (7), push harness assembly (4) inward. Withdraw the harness assembly from valve mechanism cover base (7).
  - e. Remove O-ring seal (8) from harness assembly (4).
  - f. Repeat steps 3.b through 3.e in order to remove the remaining harness assemblies.

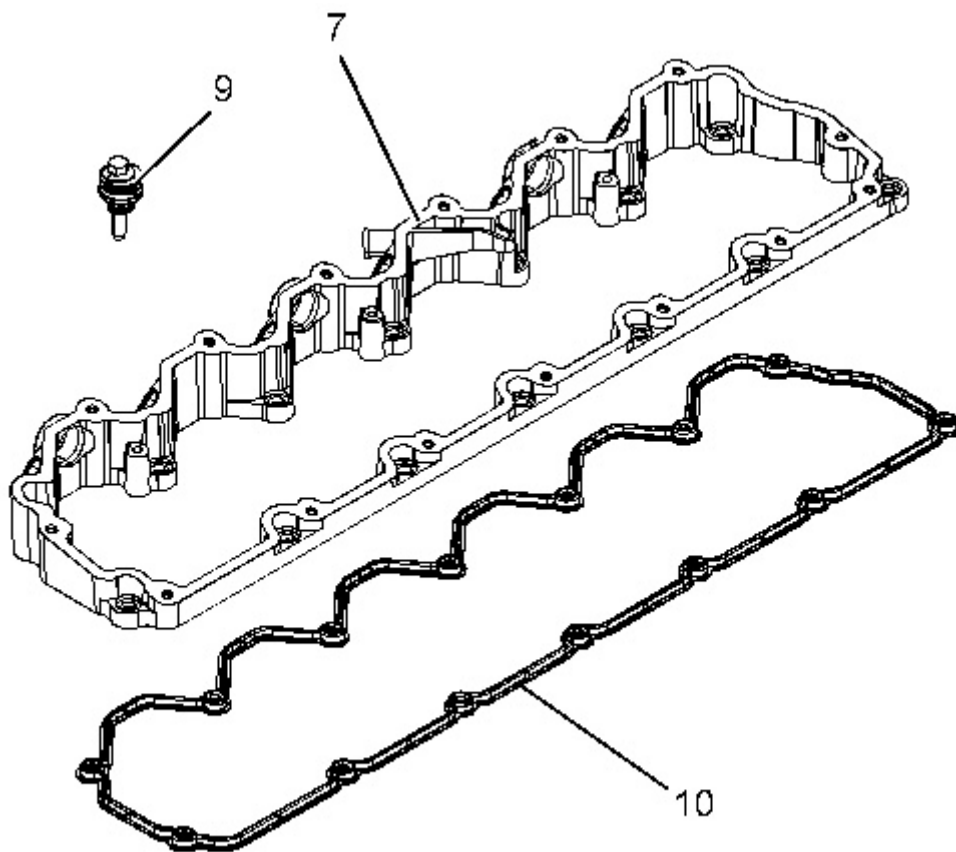

Illustration 2

g01342485

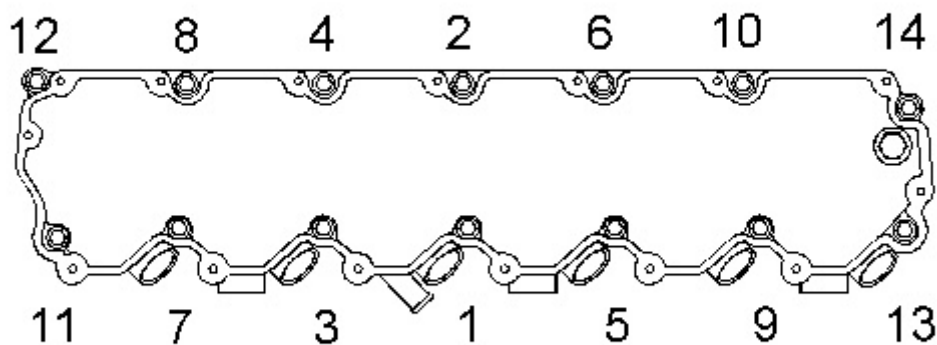

Illustration 3

g01342487

4. Loosen isolated screws (9) in reverse numerical order. Refer to illustration 3. This will help prevent distortion of valve mechanism cover base (6).
5. Remove valve mechanism cover base (7) from the cylinder head.

6. Remove isolated screws (9) from valve mechanism cover base (7).
7. Remove seal (10) from valve mechanism cover base (7).

## Installation Procedure

Table 2

Required Tools			
Tool	Part Number	Part Description	Qty
A	1P-1860	Retaining Ring Pliers	1
B	1U-6396	O-Ring Assembly Compound	1
C	247-5377	Torque wrench	1

---

### NOTICE

**Keep all parts clean from contaminants.**

**Contaminants may cause rapid wear and shortened component life.**

---

1. Clean the valve mechanism cover base. Ensure that the mating surfaces are free from damage.
-

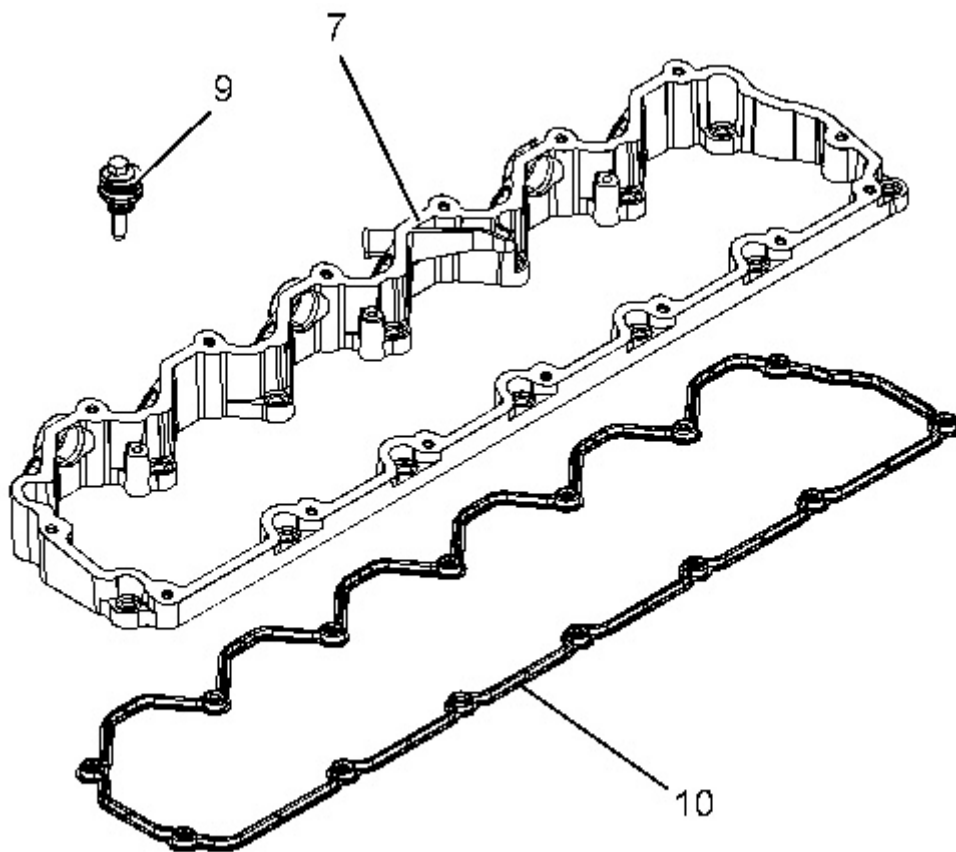

Illustration 4

g01342485

2. Install seal (10) to valve mechanism cover base (7). Ensure that seal (10) is seated correctly in the groove in the machined face of valve mechanism cover base (7).
3. Install isolated screws (9) to valve mechanism cover base (6).

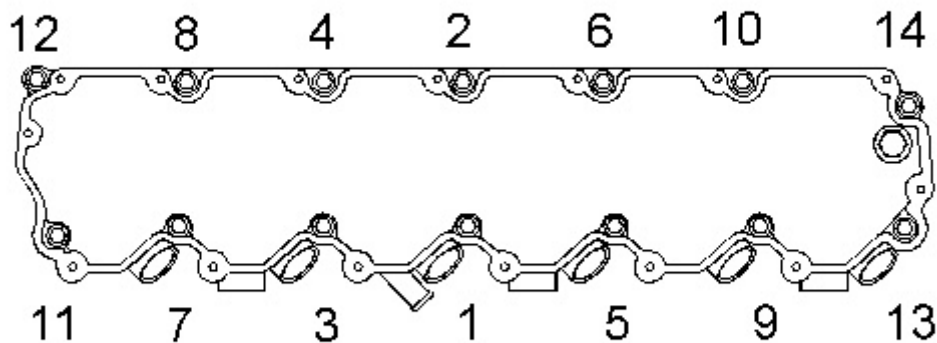

Illustration 5

g01342487

4. Position valve mechanism cover base (7) on the cylinder head. Tighten isolated screws (9) to a torque of 9 N·m (79 lb in) in the sequence that is shown in illustration 5.

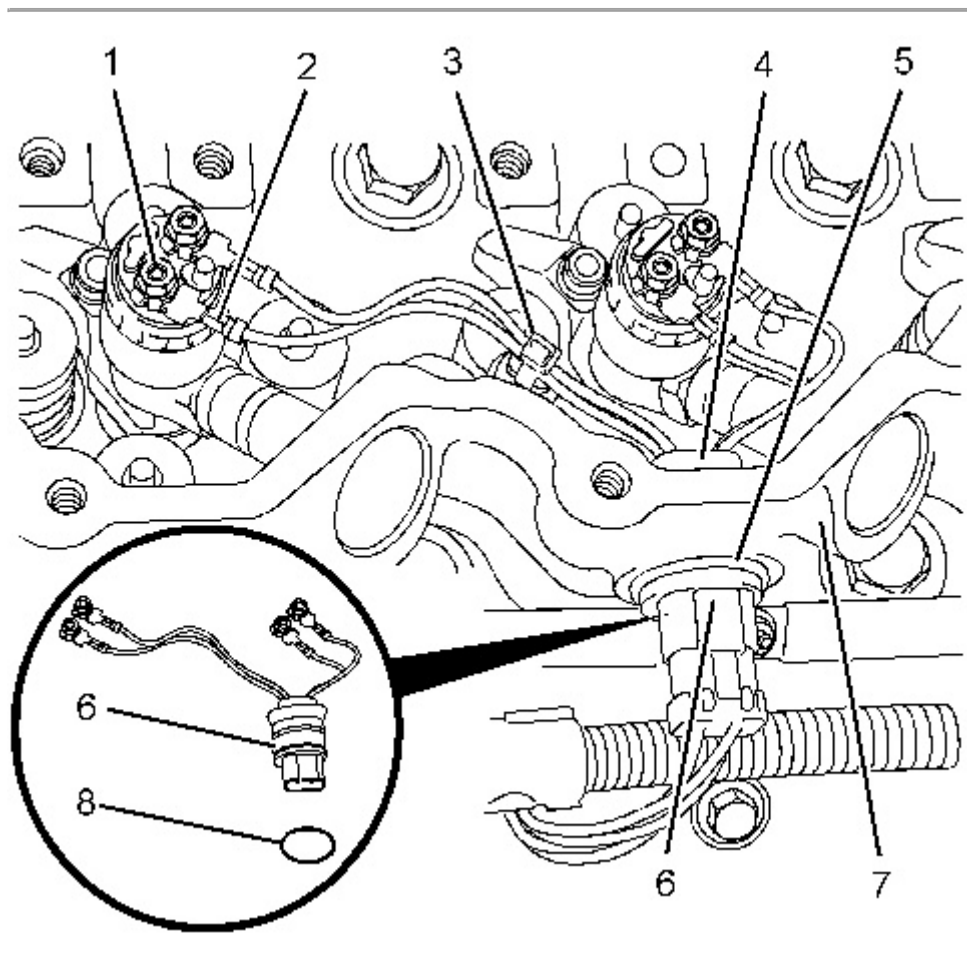

Illustration 6

g01342484

5. If necessary, install the harness assemblies for the electronic unit injectors. Follow steps 5.a through 5.h in order to install the harness assemblies for the electronic unit injectors.
- Ensure that harness assembly (4) and the bore in valve mechanism cover base (7) are clean and free from damage. Replace any damaged components.
  - Use Tooling (B) to lubricate a new O-ring seal (8). Install the new O-ring seal (8) onto harness assembly (4).
  - From the inside of valve mechanism cover base (7), push harness assembly (4) into valve mechanism cover base (7).
  - Use Tooling (A) to install circlip (5).
  - Connect plug (6) to harness assembly (4).
  - Use a deep socket to connect harness (4) to electronic unit injectors (2). Use Tooling (C) to tighten connectors (1) to a torque of 2.4 N·m (21 lb in).
  - Install a new cable strap (3) to harness assembly (4).

**Note:** Ensure that cable strap to OE specification.

h. Repeat steps 5.a through 5.g for remaining harness assemblies (4).

**End By:**

- a. Install new fuel injection lines. Refer to Disassembly and Assembly, "Fuel Injection Lines - Install".
- b. Install the valve mechanism cover. Refer to Disassembly and Assembly, "Valve Mechanism Cover - Remove and Install".

---

[Copyright 1993 - 2021 Caterpillar Inc.](#)

Tue Dec 21 09:55:28 UTC+0800 2021

[All Rights Reserved.](#)

[Private Network For SIS Licensees.](#)

Thank you so much for reading.  
Please click the “Buy Now!”  
button below to download the  
complete manual.



After you pay.

You can download the most  
perfect and complete manual in  
the world immediately.

Our support email:

[ebooklibonline@outlook.com](mailto:ebooklibonline@outlook.com)