

Product: WHEEL LOADER

Model: 966M WHEEL LOADER R8D

Configuration: 966M Wheel Loader R8D00001-UP (MACHINE) POWERED BY C9.3 Engine

Disassembly and Assembly

966M T3, 972M T3, 966L T3 and 972L T3 Wheel Loader Power Train

Media Number -M0071452-04

Publication Date -01/02/2018

Date Updated -26/02/2018

i06909951

Transmission Planetary - Disassemble

SMCS - 3160-015

Disassembly Procedure

Table 1

Required Tools			
Tool	Part Number	Part Description	Qty
A	1P-2420	Transmission Repair Stand	1
B	439-3940	Bracket As	3
C	1P-0520	Driver Gp	1
D	8B-7551	Bearing Puller	1

Start By:

- Separate the transmission from the output transfer gears.

Note: Cleanliness is an important factor. Before the disassembly procedure, clean the exterior of the component . Cleaning will help to prevent dirt from entering the internal mechanism.

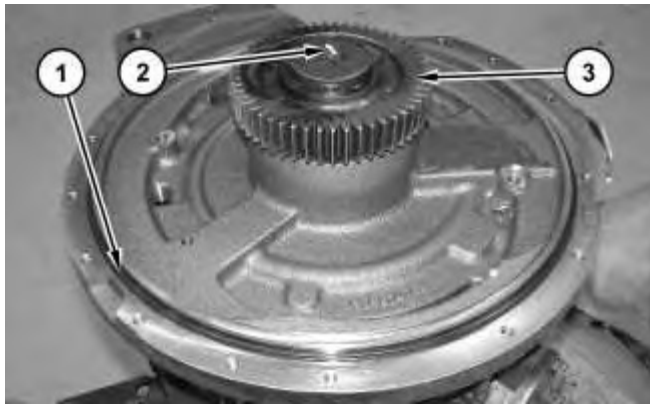

Illustration 1

g03371891

1. Remove O-ring seal (1) from the housing.
2. Remove bolt (2). Remove drive gear (3) from the end of the input shaft.

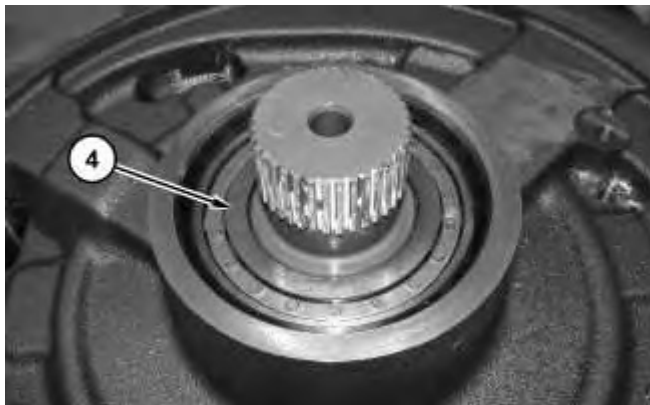

Illustration 2

g02146314

3. Remove plate (4).

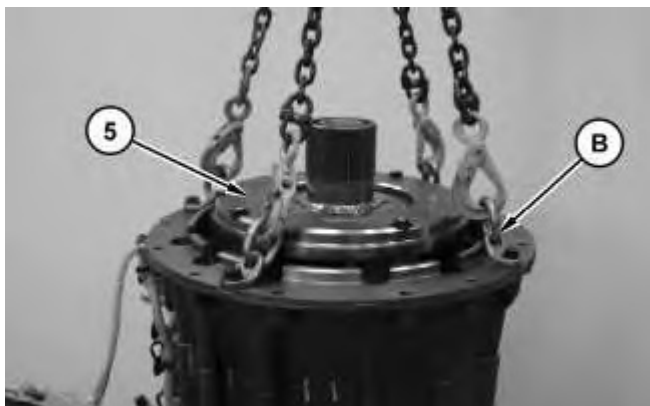

Illustration 3

g03368860

4. Attach Tooling (B) and a suitable lifting device to the transmission, as shown. The weight of the transmission is approximately 425 kg (936 lb).

5. Carefully position the transmission on the opposite end so that No. 6 clutch housing (5) is facing upward, as shown.

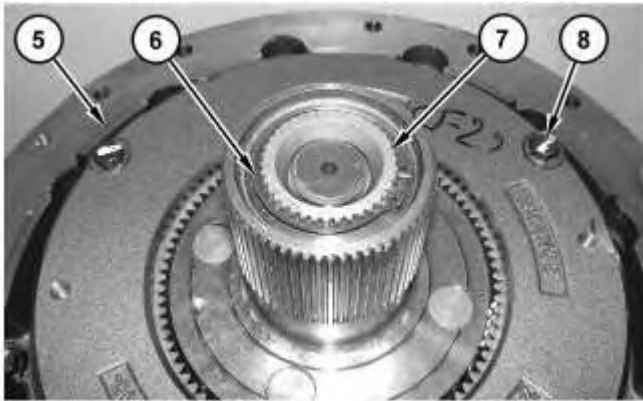

Illustration 4

g03371894



WARNING

Personal injury can result from being struck by parts propelled by a released spring force.

Make sure to wear all necessary protective equipment.

Follow the recommended procedure and use all recommended tooling to release the spring force.

6. Remove retaining ring (6) from output shaft assembly (7). Remove bolts (8) and No. 6 clutch housing (5). Mark the location of the long bolts.

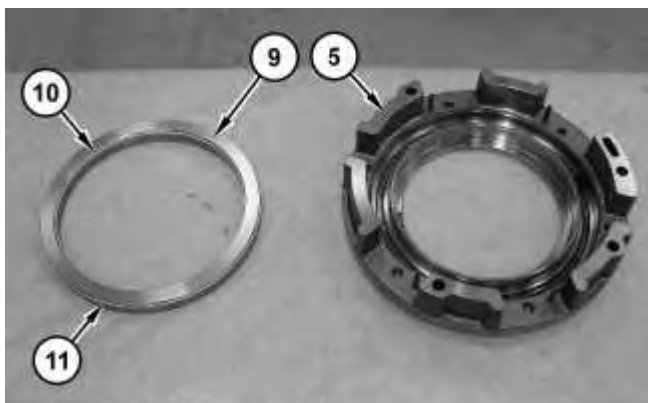

Illustration 5

g02146318

7. Remove clutch piston (9) from No. 6 clutch housing (5).
8. Remove seal rings (10) and (11) from clutch piston (9).



Illustration 6

g02146333

9. Remove clutch plate (12), springs (13), and the pins.



Illustration 7

g02146353

10. Remove clutch plates (12) and friction discs (14). Remove dowels (15).



Illustration 8

g02146354

11. Remove ring gear (16).
-



Illustration 9

g02146356

12. Remove carrier assembly (17). Remove bolts (18).

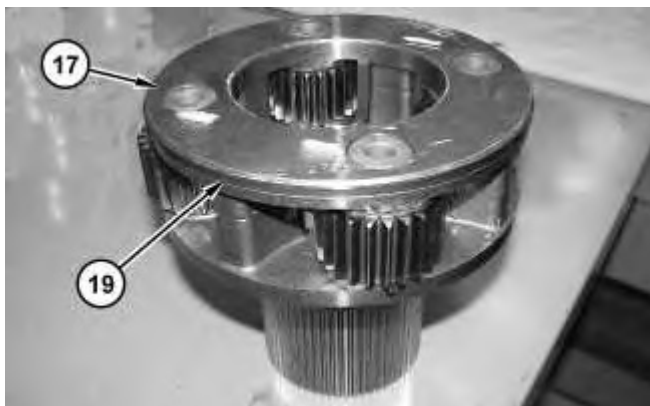

Illustration 10

g02146358

13. Remove metal seal ring (19) from carrier assembly (17).

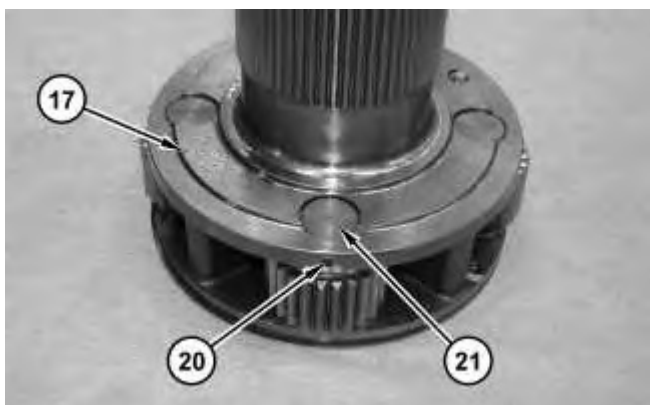

Illustration 11

g03369514

14. Push the spring pins (20) through carrier assembly (17) and into planetary shafts (21). Remove planetary shafts (21) from carrier assembly (17).

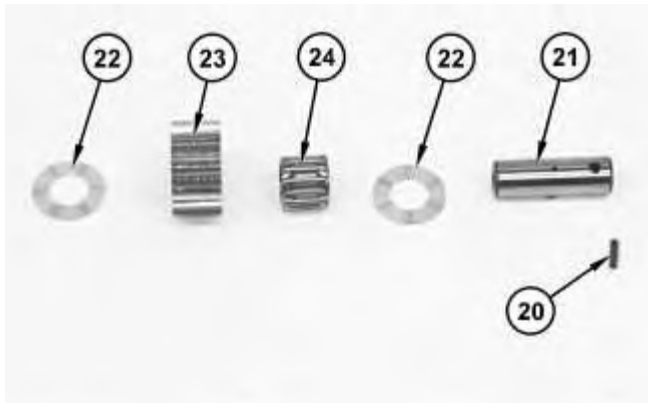

Illustration 12

g02146362

15. Remove thrust discs (22), planetary gears (23), and bearings (24) from the carrier assembly. Remove spring pins (20) from planetary shafts (21).



Illustration 13

g03369518

16. Disconnect the harness assemblies (26) which are attached to transmission modulating valves (25). Remove transmission modulating valves (25) from the transmission housing.

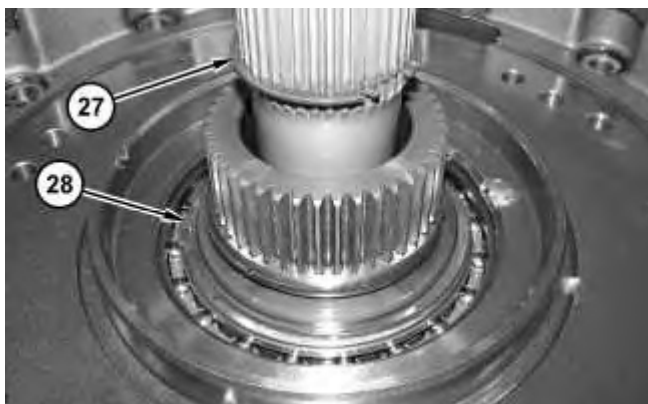

Illustration 14

g02146368

17. Remove retaining ring (27) and (28).



Illustration 15

g03368870

18. Use Tooling (B) and a suitable lifting device to remove housing assembly (29). The weight of housing assembly (29) is approximately 88 kg (195 lb).



Illustration 16

g02146402

19. Remove bearing (30) from housing assembly (29).

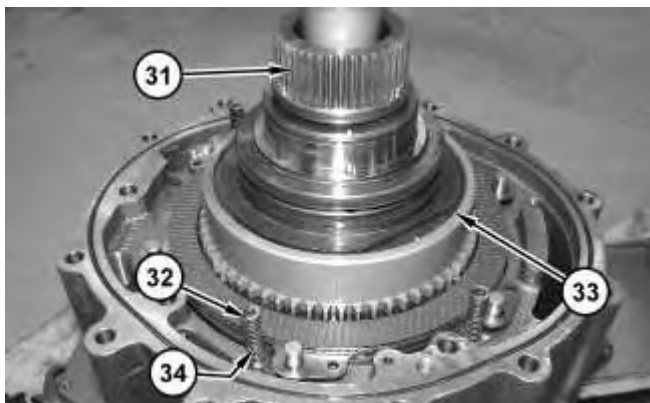

Illustration 17

g03369527

20. Remove retaining ring (33) and clutch assembly (31). Remove springs (32) and rods (34) (not shown).

Thank you so much for reading.
Please click the “Buy Now!”
button below to download the
complete manual.



After you pay.
You can download the most
perfect and complete manual in
the world immediately.

Our support email:
ebooklibonline@outlook.com