



# Service Repair Manual

## **Models**

# 972H Wheel Loader

---

Product: WHEEL LOADER

Model: 972H WHEEL LOADER GTA

Configuration: 972H Wheel Loader GTA00001-UP (MACHINE) POWERED BY C13 Engine

## Disassembly and Assembly 966H and 972H Wheel Loaders Power Train

Media Number -REN8847-07

Publication Date -01/03/2013

Date Updated -04/03/2013

i06064263

## Transmission Planetary - Assemble

SMCS - 3160-016

S/N - A7D1-UP

S/N - A7G1-UP

S/N - A7J1-UP

S/N - GTA1-UP

S/N - LCC1-UP

## Assembly Procedure

Table 1

Required Tools			
Tool	Part Number	Part Description	Qty
A	138-7575	Link Bracket	3
B	1P-0520	Driver Gp	1
D	FT-2746	Guide Pin	2
E	1P-0510	Driver Gp	1
F	-	Loctite 5127	1

**Note:** Cleanliness is an important factor. Before assembly, all parts should be cleaned in cleaning fluid. Allow the parts to air dry. Wiping cloths or rags should not be used to dry parts. Lint may be deposited on the parts.

---

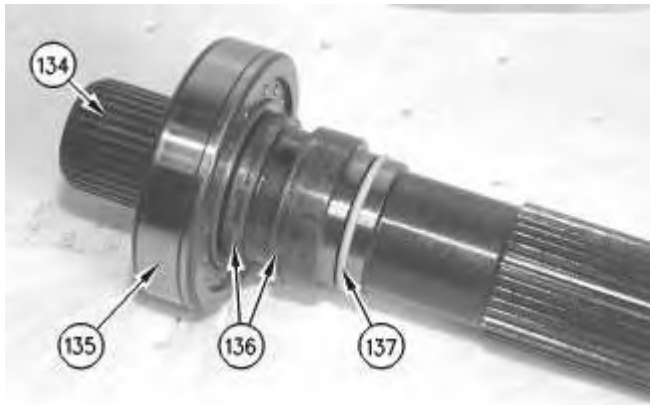

Illustration 1

g00460318

**Note:** O-ring seal (137) is not installed at this time. The O-ring seal is shown in order to clarify the installation in Step 11.

1. Raise the temperature of bearing (135) and the race. Install bearing (135) and the race onto input shaft (134) , as shown.
2. Apply clean transmission oil to ring seals (136) . Install two ring seals (136) on input shaft (134) .

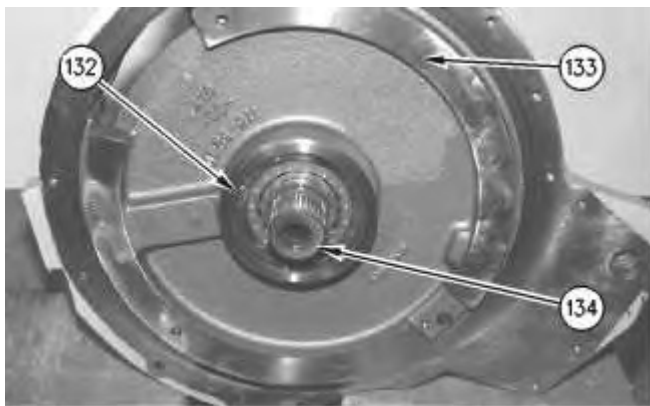

Illustration 2

g00460315

3. Carefully install input shaft (134) in housing (133) .
4. Install retaining ring (132) in order to hold the input shaft and the bearing in place.

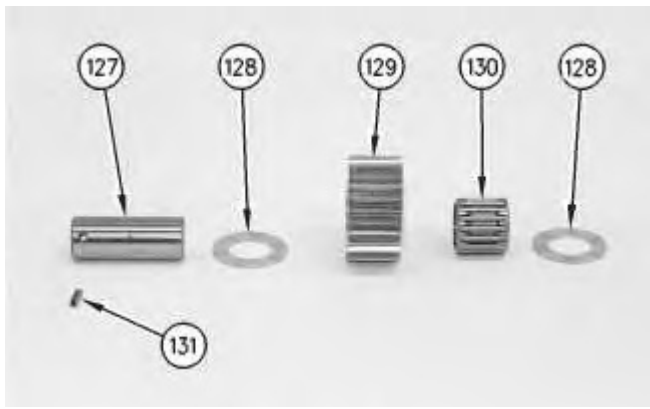

Illustration 3

g00460313

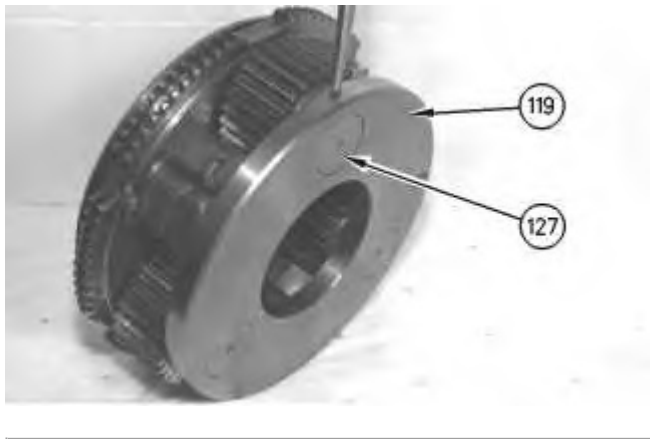

Illustration 4

g00460237

5. Install bearings (130) in planetary gears (129) . Install the gear assemblies, thrust discs (128) , and planetary shafts (127) in carrier assembly (119) .
6. Use a hammer and a punch to install spring pins (131) that hold planetary shafts (127) in carrier assembly (119) . Make sure that the spring pins are flush with the counterbore in the carrier.



Illustration 5

g00460233

7. Install seal ring (126) on carrier assembly (119) .
8. Use Tooling (B) to install bearing (125) . Install retaining ring (124) .

**Note:** Coupling (120) may be installed on carrier assembly (119) at this time. Refer to Step 13 for the procedure.



Illustration 6

g00460209

9. Install seal rings (122) and (123) on clutch piston (121) .

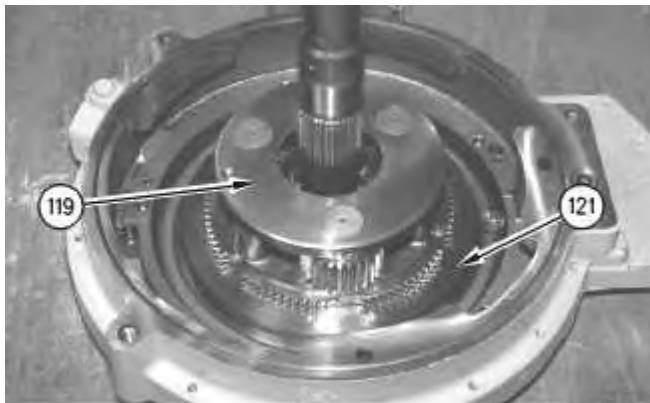

Illustration 7

g00460208

10. Place suitable cribbing under the housing. Install clutch piston (121) in the clutch housing. Make sure that the lips of the seals are facing downward.
  11. Install O-ring seal (137) . Apply clean transmission oil to O-ring seal (137) and the O-ring seal groove on the shaft. Refer to Illustration 1 for the location of the O-ring seal.
  12. Install carrier assembly (119) .
-

Thank you so much for reading.  
Please click the “Buy Now!”  
button below to download the  
complete manual.



After you pay.

You can download the most  
perfect and complete manual in  
the world immediately.

Our support email:

[ebooklibonline@outlook.com](mailto:ebooklibonline@outlook.com)