



Service Repair Manual

Models

992G Wheel Loader

Product: WHEEL LOADER

Model: 992G WHEEL LOADER AZX

Configuration: 992G Wheel Loader AZX00001-UP (MACHINE) POWERED BY 3508B Engine

Disassembly and Assembly 854G Wheel Tractor and 992G Wheel Loader Power Train

Media Number -SEN5894-13

Publication Date -01/11/2008

Date Updated -24/11/2008

i01270892

Transmission Planetary - Disassemble

SMCS - 3160-015

Disassembly Procedure

Table 1

Required Tools			
Tool	Part Number	Part Description	Qty
A	1P-2420	Transmission Stand	1
B	138-7575	Link Bracket	2
C	138-7573	Link Bracket	2
D	1P-1863	Pliers	1
E	1P-0520	Driver Group	1
F	FT-0833	Clamp	2
G	1P-1861	Pliers	1

Start By:

- Separate the input transfer gears and the output transfer gears from the transmission. Refer to Disassembly and Assembly, "Transmission from Input Transfer Gears and Output Transfer Gears - Separate".

Note: When the transmission is disassembled, keep the clutch plates and the clutch discs in the original sequence.

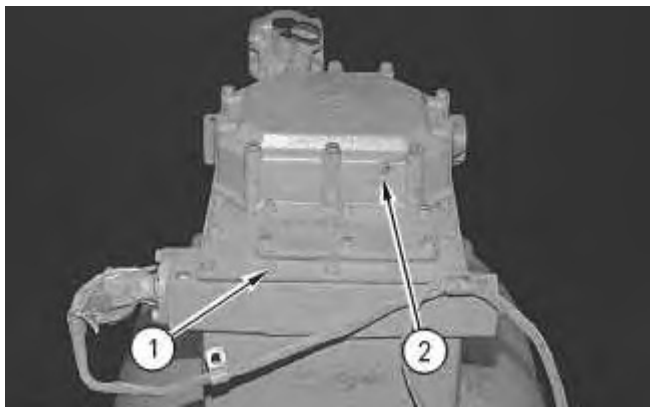

Illustration 1

g00392140

1. Remove bolts (1), cover (2) and the gasket from the transmission case assembly.

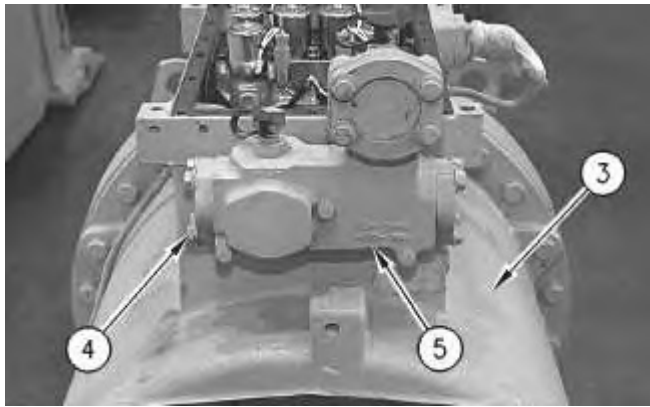

Illustration 2

g00392143

2. Remove bolts (4) and the washers.
3. Remove manifold (5) from transmission case assembly (3) .

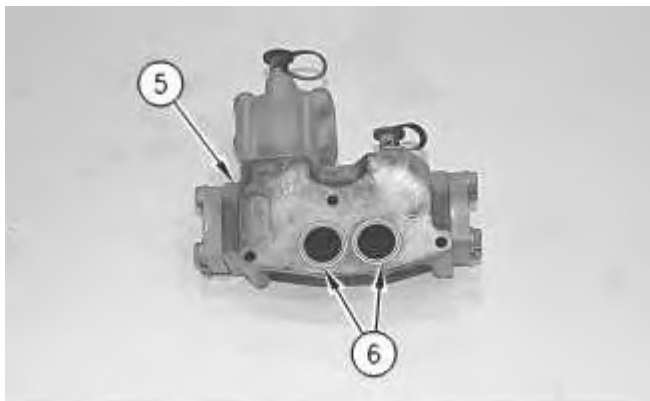

Illustration 3

g00392145

4. Remove two O-ring seals (6) from manifold (5) .

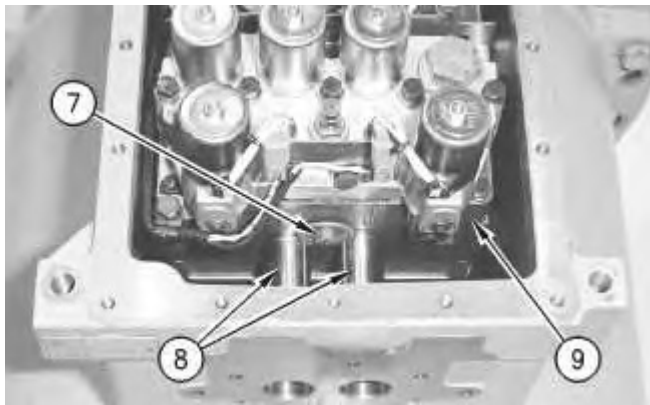

Illustration 4

g00392863

5. Remove bolt (7) and the washer. Remove two sleeves (8) from transmission hydraulic control valve (9) .

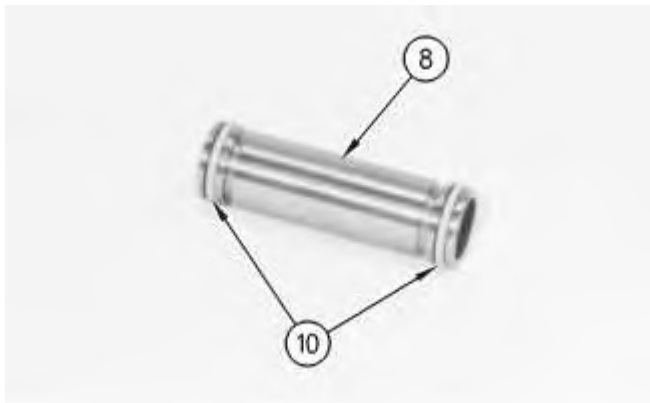

Illustration 5

g00392865

6. Remove two O-ring seals (10) from each sleeve (8) .
-

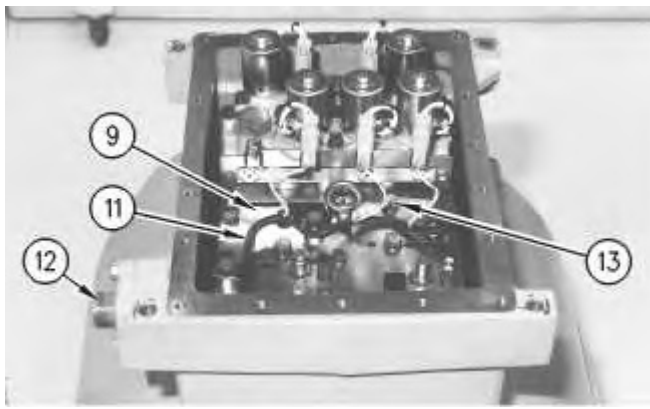

Illustration 6

g00392866

7. Remove nut (11) from wiring harness connector plug (12) .
8. Remove bolts (13) from transmission hydraulic control valve (9) .

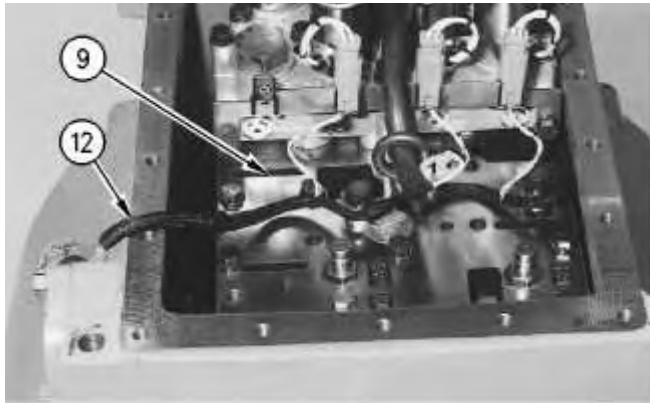

Illustration 7

g00392870

9. Slide transmission hydraulic control valve (9) to the side. Pull wiring harness connector plug (12) from transmission case assembly (3) .
10. Use a hoist and a suitable lifting sling to remove transmission hydraulic control valve (9) from the transmission. The weight of the transmission hydraulic control valve is 55 kg (120 lb).

Thank you so much for reading.
Please click the “Buy Now!”
button below to download the
complete manual.



After you pay.

You can download the most
perfect and complete manual in
the world immediately.

Our support email:

ebooklibonline@outlook.com