



Service Repair Manual

Models

C18 Industrial Engine

Product: INDUSTRIAL ENGINE
Model: C18 INDUSTRIAL ENGINE WRH
Configuration: C18 Industrial Engine WRH00001-UP

Disassembly and Assembly C15 and C18 Industrial Engines

Media Number -REN8630-07

Publication Date -01/11/2017

Date Updated -15/11/2017

i03203779

Crankshaft Front Seal - Install

SMCS - 1160-012

Installation Procedure

Table 1

Required Tools			
Tool	Part Number	Part Description	Qty
D	5P-1733	Seal Locator	1
E	5P-1737	Bolt	3
F	9S-8858	Nut (Seal Installer)	1
G	6V-6142	Seal Installer	1

NOTICE

Keep all parts clean from contaminants.

Contaminants may cause rapid wear and shortened component life.

Note: The crankshaft front seal and the wear sleeve must be replaced at the same time. Once the crankshaft front seal and the wear sleeve are separated, these components cannot be used again.

Note: Do not use any type of lubricant during the installation of the crankshaft front seal and the wear sleeve.

1. Before installation of the crankshaft front seal and the wear sleeve, inspect the crankshaft for scratches. Also, inspect the crankshaft for any distortion on the surface that may lead to

an out of round condition. Use a polishing cloth in order to remove any imperfections on the crankshaft.

2. Clean the outside diameter of the crankshaft.

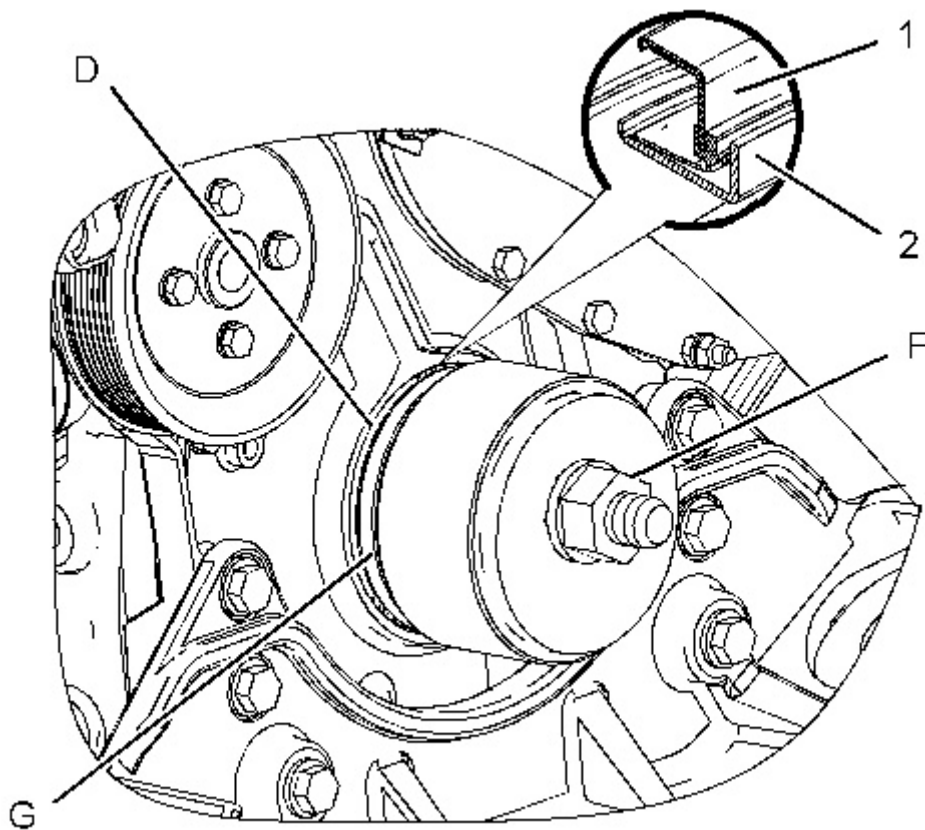

Illustration 1

g01635160

3. Fasten Tooling (D) to the crankshaft with Tooling (E).

Note: Install the crankshaft front seal with the arrow that shows the direction of crankshaft rotation toward the front of the engine.

4. Position wear sleeve (2) and crankshaft front seal (1) on Tooling (D). Install Tooling (G) on Tooling (D). Lubricate the face of the washer on Tooling (F). Install Tooling (F) on Tooling (D).
5. Tighten Tooling (F) until Tooling (G) contacts Tooling (D).
6. Remove Tooling (F) and Tooling (G) from Tooling (D).
7. Remove Tooling (E) and Tooling (D) from the crankshaft.

End By:

- a. Install the vibration damper and the pulley. Refer to Disassembly and Assembly, "Vibration Damper and Pulley - Remove and Install".
-

Product: INDUSTRIAL ENGINE
Model: C18 INDUSTRIAL ENGINE WRH
Configuration: C18 Industrial Engine WRH00001-UP

Disassembly and Assembly C15 and C18 Industrial Engines

Media Number -REN8630-07

Publication Date -01/11/2017

Date Updated -15/11/2017

i04275771

Front Cover - Remove

SMCS - 1166-011

Removal Procedure

NOTICE

Keep all parts clean from contaminants.

Contaminants may cause rapid wear and shortened component life.

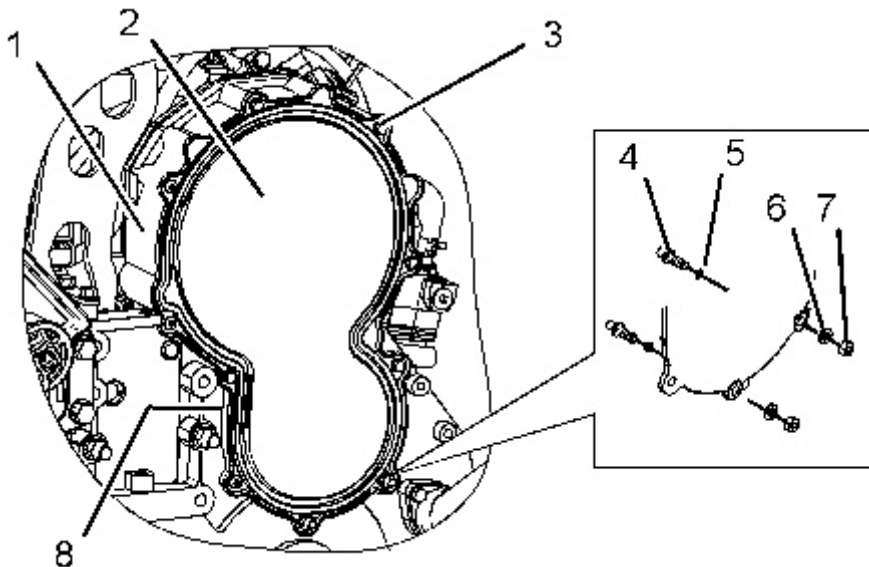

1. Remove button head screws (3).
2. Remove nuts (7) and washers (6) from studs (4).
3. Remove front cover (2) from front housing (1).
4. Remove O-ring seal (5) from studs (4).
5. Remove seal (8) from front cover (2).

Thank you so much for reading.
Please click the “Buy Now!”
button below to download the
complete manual.



After you pay.

You can download the most
perfect and complete manual in
the world immediately.

Our support email:

ebooklibonline@outlook.com