



Service Repair Manual

Models

CS-433E and CP-433E
Vibratory Compactor

Product: VIBRATORY COMPACTOR

Model: CS-433E VIBRATORY COMPACTOR DAC

Configuration: CS-433E,CP-433E Vibratory Compactor DAC00001-UP (MACHINE) POWERED BY 3054 Engine

Disassembly and Assembly CP-433E, CS-423E and CS-433E Vibratory Compactors Machine Systems

Media Number -KENR3584-05

Publication Date -01/09/2008

Date Updated -29/09/2008

i02162125

Piston Motor (Drum Propel) - Assemble

SMCS - 4351-016; 5058-016

Assembly Procedure

Table 1

Required Tools			
Tool	Part Number	Part Description	Qty
A	1P-1861	Retaining Ring Pliers	1
B	2P-8312	Retaining Ring Pliers	1
C	1P-1861	Retaining Ring Pliers	1
D	5P-0960	Molybdenum Grease	1

1. Inspect all parts and clean all parts. If any parts are worn or damaged, use new Caterpillar parts for replacement.
 2. Inspect all seals. Damaged seals must be replaced. Use new Caterpillar seals for replacement.
-

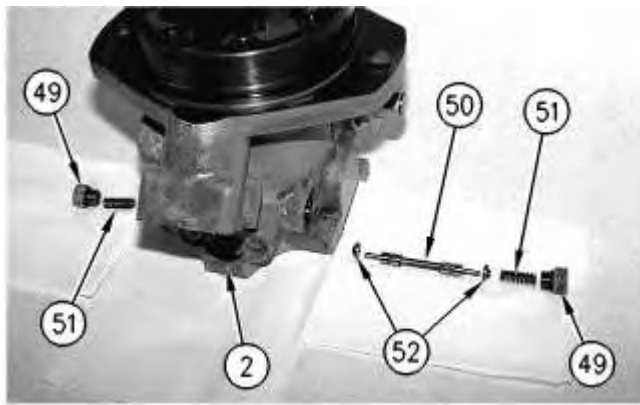

Illustration 1

g00826833

WARNING

Sudden release of spring force can cause injury.

To prevent the possibility of injury, follow the procedure to relieve the spring pressure.

3. Install the O-ring seals on plugs (49). Install valve spool (50), spring guides (52), springs (51), and plugs (49) in housing (2) .

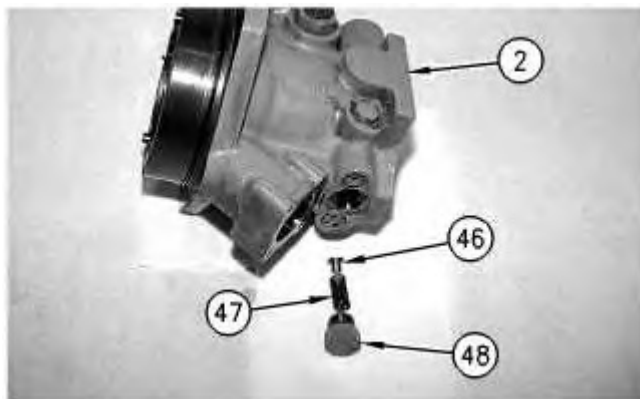

Illustration 2

g00826832

WARNING

Sudden release of spring force can cause injury.

To prevent the possibility of injury, follow the procedure to relieve the spring pressure.

4. Install the O-ring seal on plug (48). Install poppet (46), spring (47), and plug (48) in housing (2) .

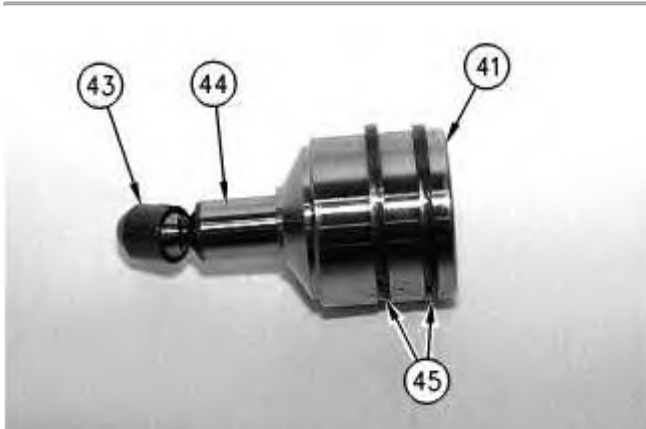

Illustration 3

g00826831

5. Install slipper (43) on hollow piston (44). Install seal rings (45) on hollow piston (44) .
6. Repeat Step 5 for hollow piston (41) .

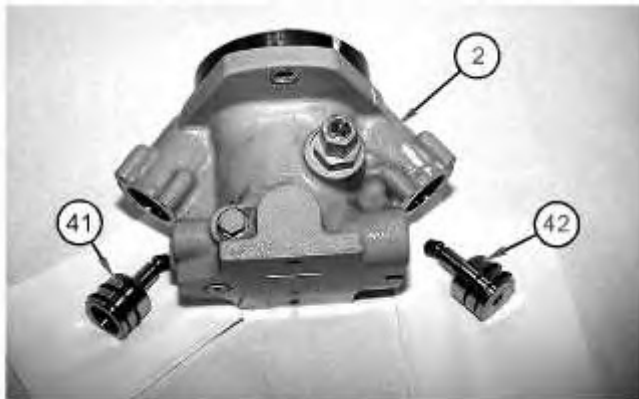

Illustration 4

g01067010

7. Install servo pistons (41) and (42) in housing (2) .
-

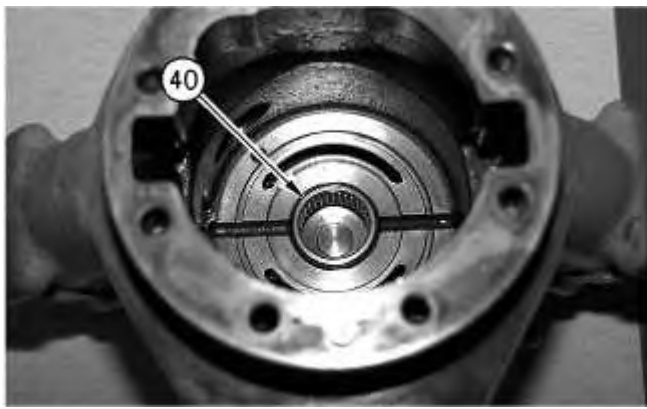

Illustration 5

g00826828

8. Install needle bearing (40) in the housing.

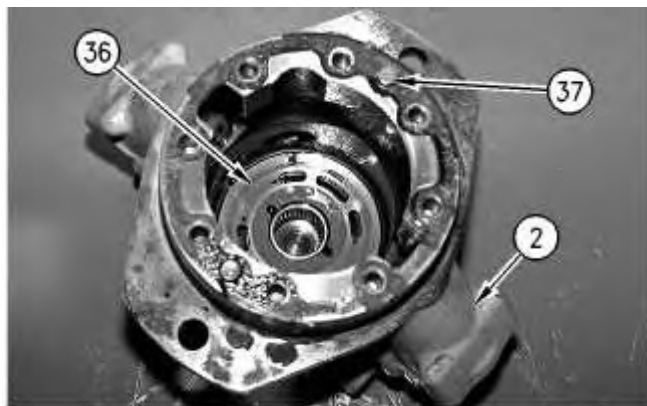

Illustration 6

g00826826

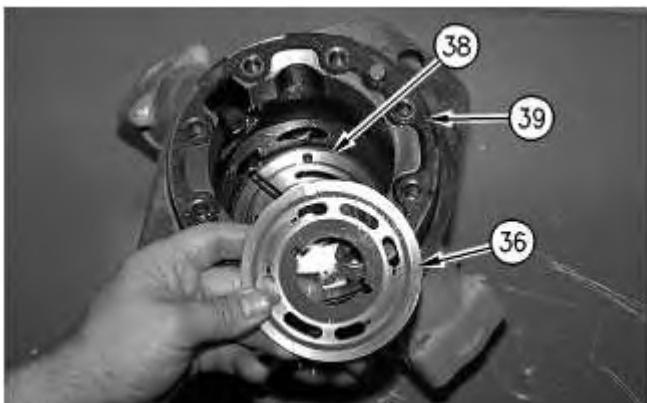

Illustration 7

g00826827

9. Install locating pin (38) and valve plate (36) in housing (2) .
10. Install dowels (37) and gasket (39) on housing (2) .

Thank you so much for reading.
Please click the “Buy Now!”
button below to download the
complete manual.



After you pay.

You can download the most
perfect and complete manual in
the world immediately.

Our support email:

ebooklibonline@outlook.com