

Product: TRACK-TYPE TRACTOR

Model: D6K2 XL TRACK-TYPE TRACTOR DFR

Configuration: D6K2 XL Track-Type Tractor DFR00001-UP (MACHINE) POWERED BY C4.4 Engine

## Disassembly and Assembly D6K Track Type Tractor Power Train

Media Number -M0066522-04

Publication Date -01/07/2018

Date Updated -25/07/2018

i06874294

# Final Drive and Sprocket - Disassemble

SMCS - 4050-015; 4164-015

## Disassembly Procedure

Table 1

Required Tools			
Tool	Part Number	Part Description	Qty
A	439-3941	Link Brackets	3
B	1U-9200	Lever Puller Hoist Gp	1
	386-6031 <sup>(1)</sup>	Lever Puller Hoist Gp	1
C	3E-3879	Eyebolt	1
D	160-2245	Abrasion Sleeve	1
E	150-1782	Crossblock	1
	360-6965	Hydraulic Cylinder Gp	1
	439-5245	Hydraulic Hand Pump Gp	1
F	1P-0520	Driver Gp	1
G	1P-2322	Combination Puller	1
H	439-3941	Link Brackets	2
J	1P-0074	Slide Hammer Puller Gp	1
	4C-5655	Threaded Adapter	1
K	1P-0510	Driver Gp	1

<sup>(1)</sup> This part number complies with European requirements.

## Start By:

- a. Remove the final drive and brake.
- b. Remove the track brake.



**When you are using hydraulic cylinders and puller studs, always ensure that the rated capacity of the puller stud meets or exceeds the rated capacity of the hydraulic cylinder. If the puller stud does not meet or exceed the rated capacity of the hydraulic cylinder, a sudden failure of the puller stud could occur. The sudden failure of the puller stud could result in personal injury or death.**

---

1. Drain the final drive oil. Refer to Operation and Maintenance Manual, "Final Drive Oil - Change" for the correct draining procedure.

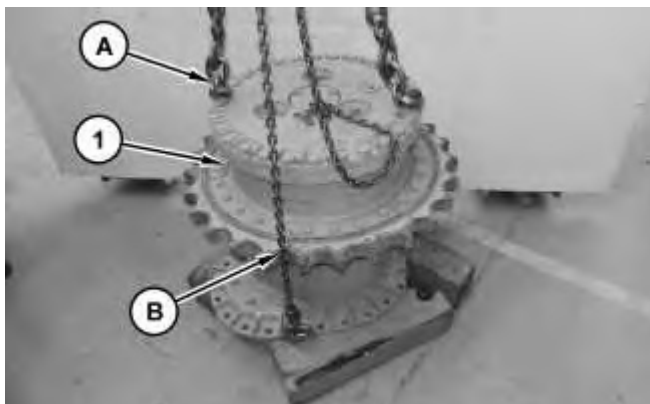
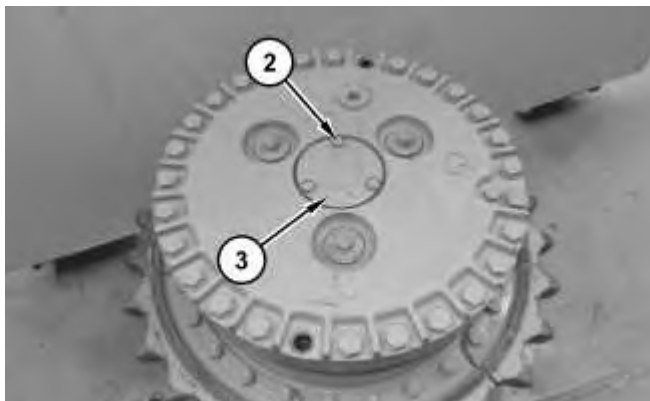

Illustration 1

g03039906

2. Attach Tooling (A), Tooling (B), and a suitable lifting device to final drive (1). The weight of final drive (1) is approximately 590 kg (1300 lb). Position final drive (1) onto suitable cribbing.



3. Remove bolts (2), cover (1), and the O-ring seal.
- 

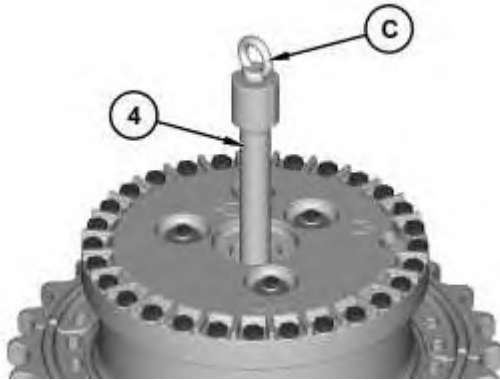

Illustration 3

4. Use Tooling (C) to remove sun gear shaft assembly (4).
- 

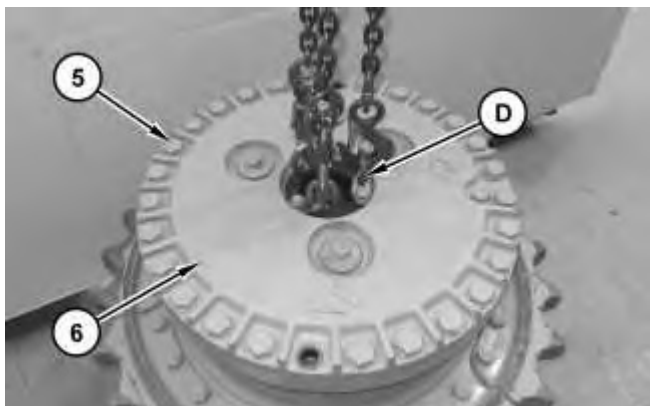
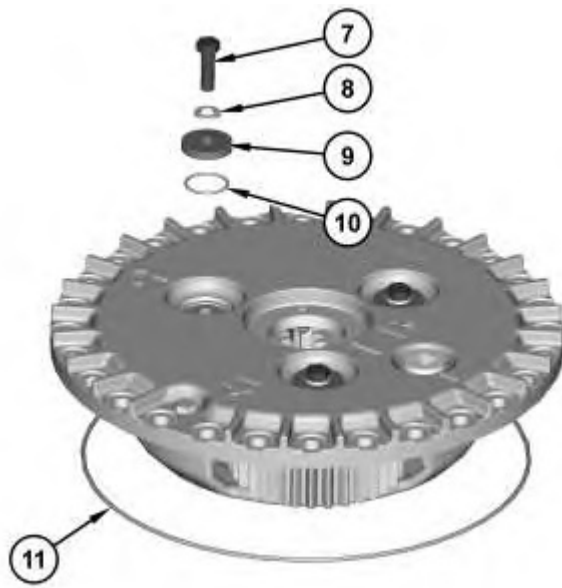

Illustration 4

5. Attach Tooling (D) and a suitable lifting device to planetary assembly (6). The weight of planetary assembly (6) is approximately 109 kg (240 lb). Remove bolts (5) and planetary assembly (6).
-



---

Illustration 5

g03041719

6. Remove O-ring seal (11).
7. Remove bolt (7), washer (8), retainer (9), and O-ring seal (10). Repeat for the remaining planetary gears.

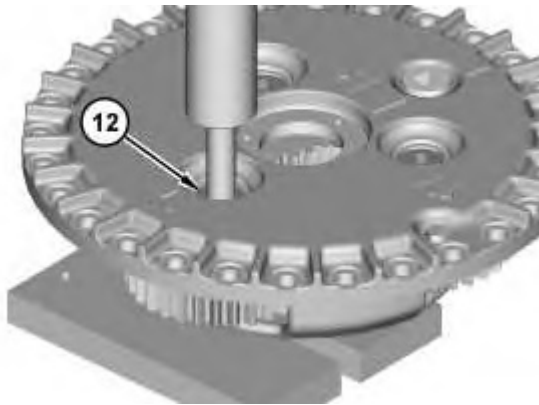

---

Illustration 6

g03041721

---

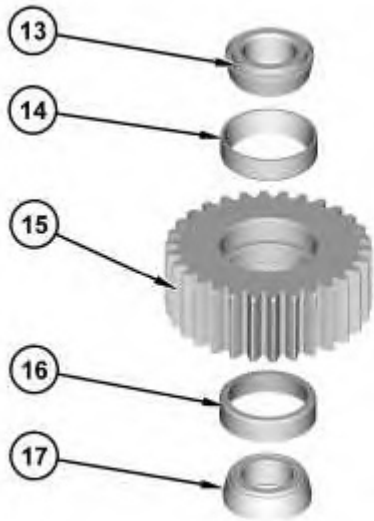

---

Illustration 7

g03041776

8. Use a suitable press to remove shaft (12). Remove shaft (12), bearing cone (13), planetary gear (15), and bearing cone (17) from the planetary carrier. Remove bearing cup (14) and bearing cup (16) from planetary gear (15). Repeat for the remaining planetary gears.

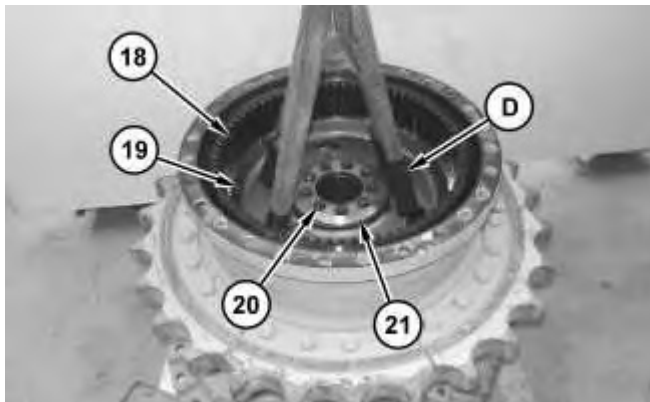

---

Illustration 8

g03042099

9. Attach Tooling (D) and a suitable lifting device to ring gear (18) and hub (19). The combined weight of ring gear (18) and hub (19) is approximately 40 kg (88 lb). Remove bolts (20) and retainer plate (21). Remove ring gear (18) and hub (19) as a unit.
-

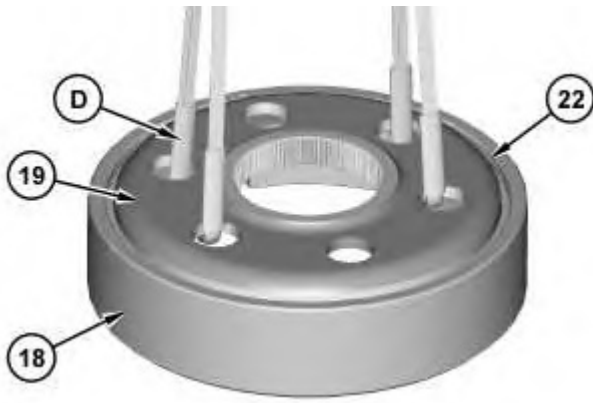

Illustration 9

g03042177

10. Attach Tooling (D) and a suitable lifting device to hub (19). The weight of hub (19) is approximately 18 kg (40 lb). Remove retaining ring (22). Remove hub (19) from ring gear (18).

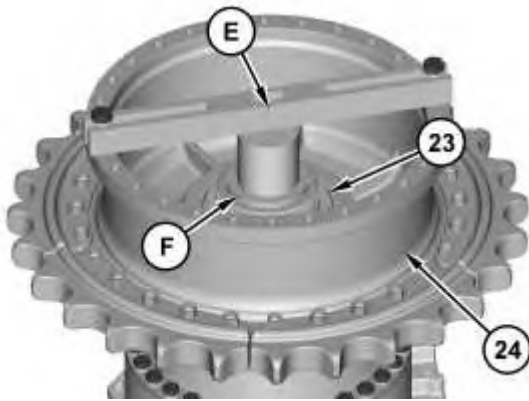
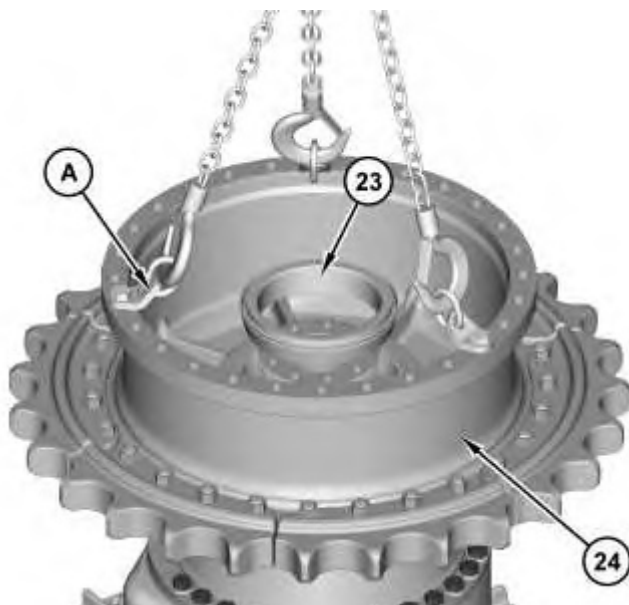

Illustration 10

g03042296

11. Attach Tooling (E) and Tooling (F) to separate bearing cone (23) and sprocket hub (24).



12. Remove bearing cone (23).
13. Attach Tooling (A) and a suitable lifting device to sprocket hub (24). The combined weight of sprocket hub (24) and the sprocket segments is approximately 186 kg (410 lb). Remove sprocket hub (24) and the sprocket segments as a unit.



Illustration 12

14. Remove Duo-Cone seal (25) and bearing cups (26) from sprocket hub (24). Refer to Special Instruction, SEHS8364, "Assembly and Installation of Conventional Duo-Cone Seals" for installation instructions.



Illustration 13

15. Remove Duo-Cone seal (27). Refer to Special Instruction, SEHS8364, "Assembly and Installation of Conventional Duo-Cone Seals" for installation instructions.
-

Thank you so much for reading.  
Please click the “Buy Now!”  
button below to download the  
complete manual.



After you pay.

You can download the most  
perfect and complete manual in  
the world immediately.

Our support email:

[ebooklibonline@outlook.com](mailto:ebooklibonline@outlook.com)