

Product: TRACK-TYPE TRACTOR

Model: D6R II TRACK-TYPE TRACTOR BNL

Configuration: D6R SERIES II TRACK-TYPE TRACTOR DS STD BNL00501-UP (MACHINE) POWERED BY C9 ENGINE

## Disassembly and Assembly

### D6R Series II Track-Type Tractor Power Train

Media Number -REN4271-03

Publication Date -01/10/2007

Date Updated -12/10/2007

i06983834

## Steering Differential and Brake - Disassemble

SMCS - 4131-015

## Disassembly Procedure

Table 1

Required Tools			
Tool	Part Number	Description	Qty
A	138-7573	Link Bracket	2
B	3K-4897	Spring Pin	8
C	6V-4072	Spanner Wrench	1
D	9S-9154	Step Plate	1
	6V-3009	Bar	1
	8S-6470	Forcing Screw 3/4 inch - 16 by 4 inch	1
	8S-5133	Plug	1
	5P-8245	Washer	4
	1D-4719	Nut 1/2 inch - 13	2
	2H-6488	Bolt 1/2 inch - 13 by 5 inch	2
E	9S-9154	Step Plate	1
	6V-3009	Bar	1
	8S-6470	Forcing Screw 3/4 inch - 16 by 4 inch	1
	8S-5133	Plug	1
	5P-8245	Washer	4

	1D-4719	Nut 1/2 inch - 13	2
	1D-4574	Bolt 1/2 inch - 13 by 6 inch	2
	8H-0663	Bearing Puller	1
F	138-7575	Link Bracket	3
G	8B-7550	Leg	2
	8B-7559	Adapter	2
	3H-0465	Plate	4
	1P-0498	Plate	1
	1B-4207	Nut 3/4 inch - 16	2
	5H-9976	Forcing Screw 1 inch - 14 by 5 3/4 inch	1
	5B-0637	Nut 1 inch - 14	1
	8H-0684	Ratchet Wrench	1
	8B-7563	Handle	1
	5F-7353	Washer (Thrust)	1
	8B-7548	Push-Puller Tool Gp	1

**Start By:**

- a. Remove the left final drive, the steering differential, and the brake. Refer to Disassembly and Assembly, "Final Drive, Steering Differential, and Brake (Left Side) - Remove"

---

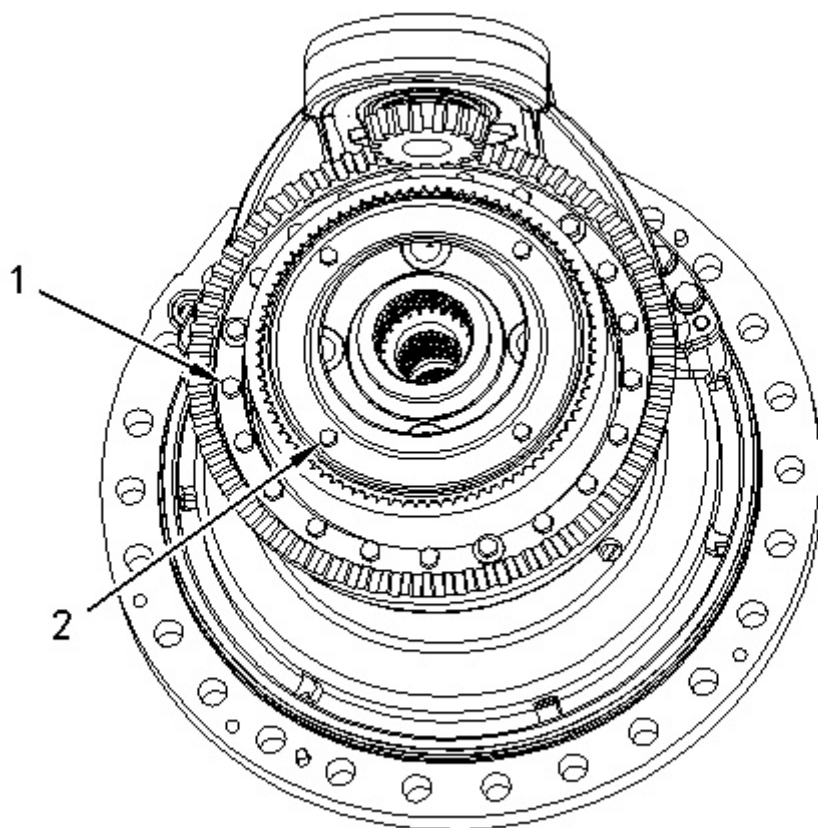

---

Illustration 1

g00823680

1. Remove bolts (1) and washers.
  2. Remove two opposite bolts (2).
-

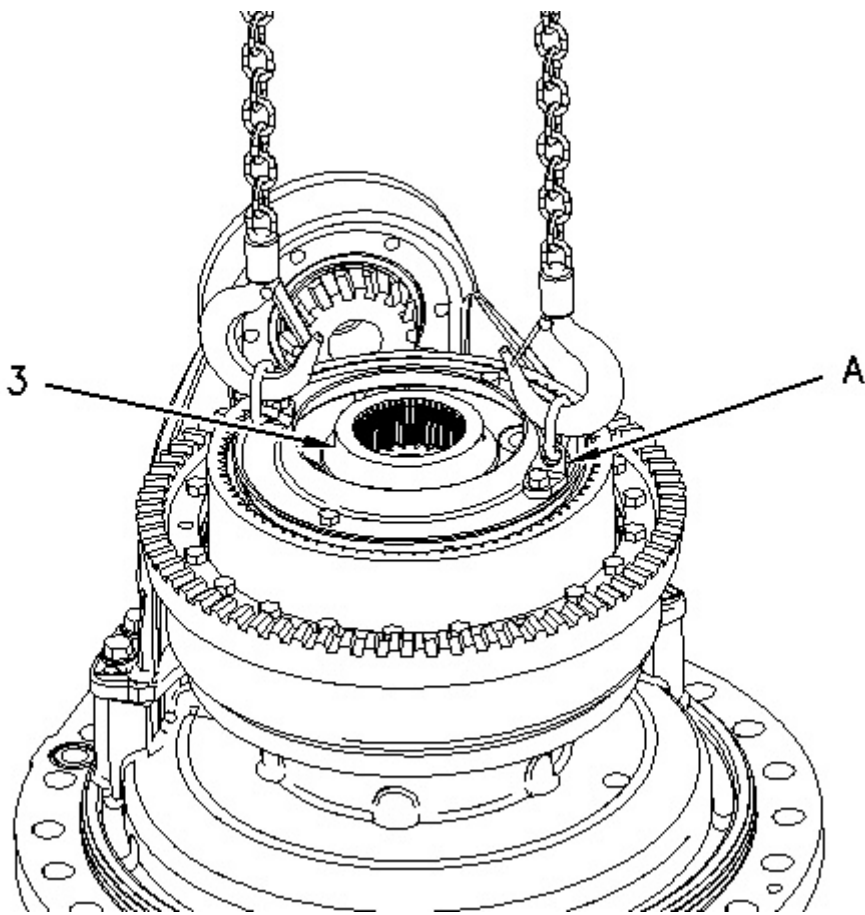
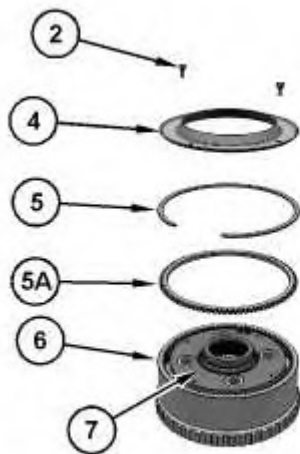

Illustration 2

g00823691

3. Attach Tooling (A) and a suitable lifting device.
4. Remove sliding carrier (3). The weight of sliding carrier (3) is approximately 48 kg (105 lb).
5. Remove Tooling (A).



6. Remove remaining bolts (2) and slinger (4) from planetary carrier (7).
  7. Remove retaining ring (5), thrust ring (5A), and planetary carrier (7) from ring gear (6).
- 

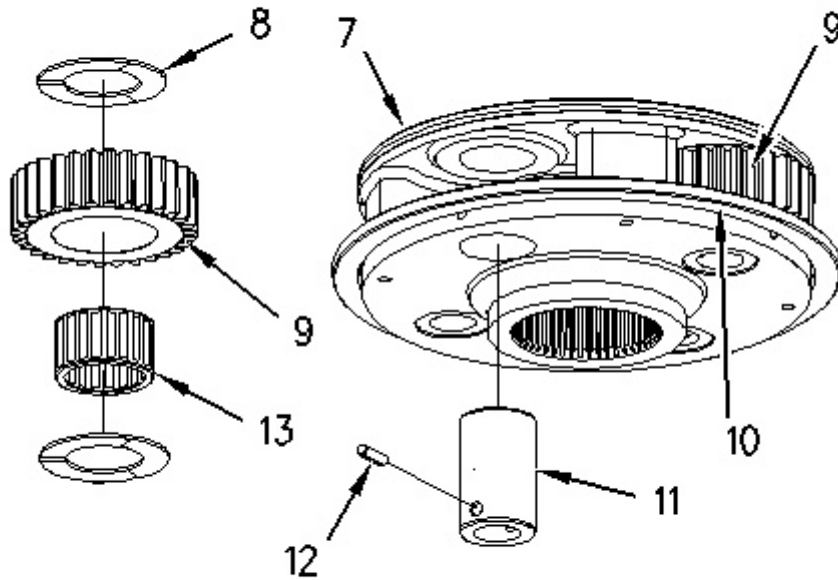
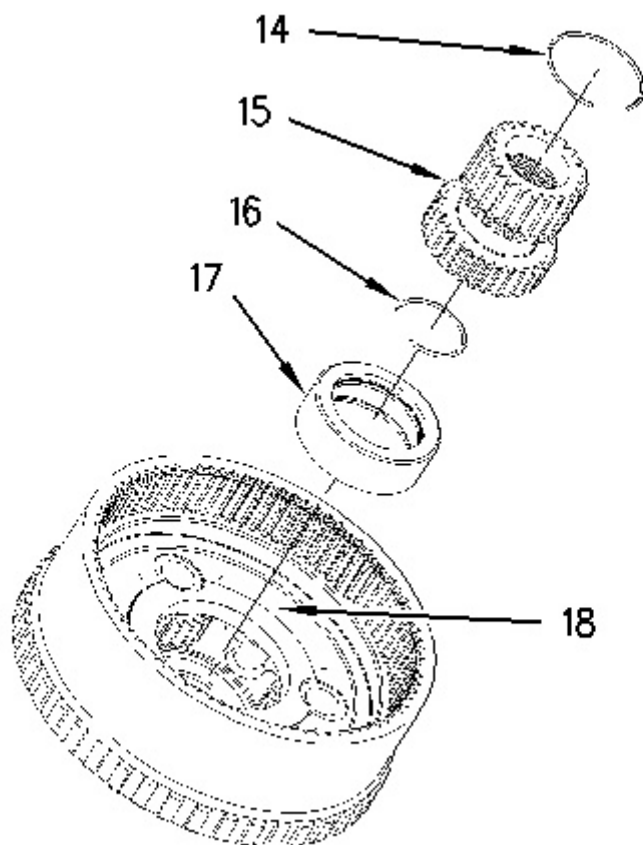

Illustration 4

g00823775

8. Remove seal ring (10) from planetary carrier (7).
  9. Use a hammer and a punch to push pin (12) in shaft (11).
  10. Remove shaft (11), planetary gear (9), discs (8), and bearing (13) from planetary carrier (7).
  11. Remove pin (12) from shaft (11).
  12. Repeat Steps 9 through 11 for the remaining planetary gears.
-



---

Illustration 5

g00823759

13. Remove lockring (14) and remove retaining ring (16).
  14. Remove sun gear (15) from planetary carrier (18).
  15. Remove spacer (17).
-

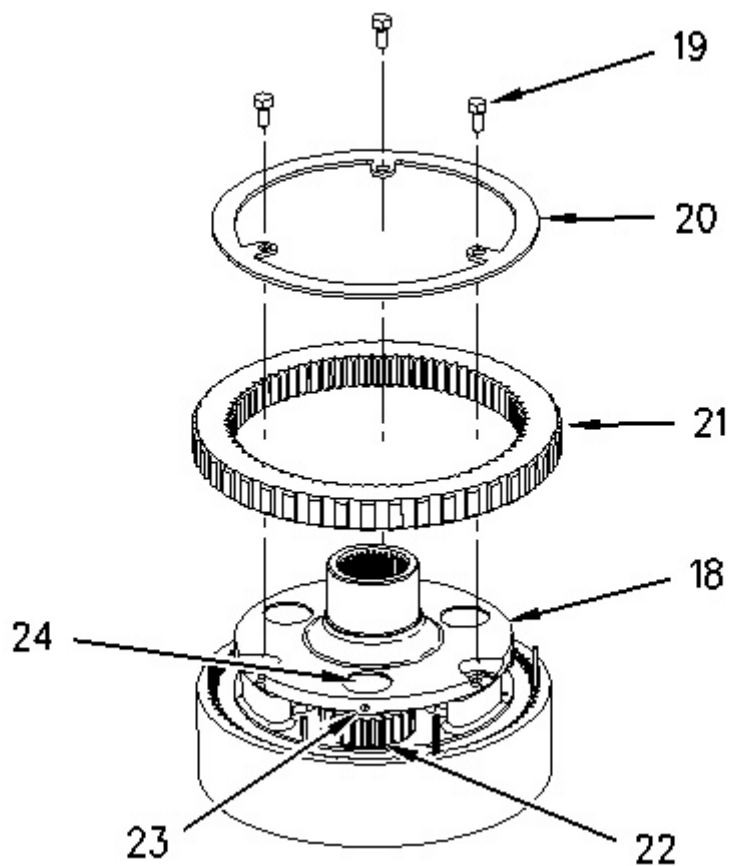

Illustration 6

g00823816

16. Remove bolts (19), plate (20), and gear (21) from planetary carrier (18).
17. Use Tooling (B) to compress the retaining ring that holds planetary carrier (18) in ring gear (6).
18. Separate planetary carrier (18) from ring gear (6).
19. Remove the retaining ring from planetary carrier (18).
20. Use a hammer and a punch to push pin (23) in shaft (24).

Thank you so much for reading.  
Please click the “Buy Now!”  
button below to download the  
complete manual.



After you pay.

You can download the most  
perfect and complete manual in  
the world immediately.

Our support email:

[ebooklibonline@outlook.com](mailto:ebooklibonline@outlook.com)