



Service Repair Manual

Models

D6R III TRACK-TYPE TRACTOR

Product: TRACK-TYPE TRACTOR

Model: D6R III TRACK-TYPE TRACTOR WRG

Configuration: D6R Series III TRACK-TYPE TRACTOR XW,LGP Differential Steering WRG00001-UP (MACHINE) POWERED BY C9 Engine

Disassembly and Assembly

D6R Series III Track-Type Tractor Power Train

Media Number -REN8173-06

Publication Date -01/04/2018

Date Updated -26/04/2018

i02409676

Transmission - Assemble

SMCS - 3030-016

Assembly Procedure

Table 1

Required Tools			
Tool	Part Number	Part Description	Qty
A	1P-2420	Transmission Repair Stand	1
B	5P-5197	Retaining Ring Pliers	1
C	138-7575	Link Bracket	3
D	5P-4758	Internal Pliers	1
E	FT-0947	Spring Compressor	2
F	138-7574	Link Bracket	2
G	3K-4897	Spring Pin	8
H	1P-0510	Driver Gp	1

1. Inspect all the parts for wear or for damage. If necessary, replace any parts that are worn or damaged. Put clean oil on the parts during the assembly procedure. Be certain that all the passages in the shafts and in the housings are clean.
-



Illustration 1

g01203718

2. Install carrier (105) and O-ring seal (107).

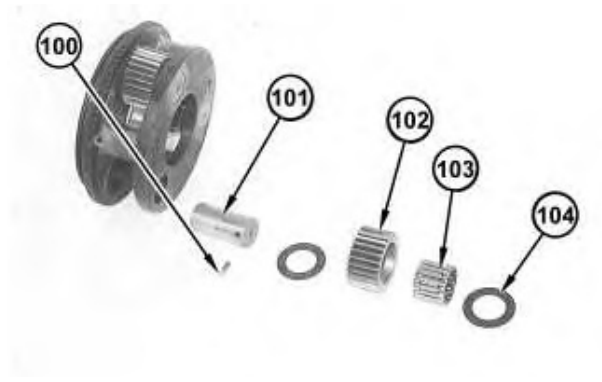

Illustration 2

g01203717

3. Install bearing (103) in gear (102).
4. Install gear (102) and thrust washers (104) into the planetary carrier housing. Thrust washers (104) should be on each side of gear (102) for the installation.
5. Install planetary gear shaft (101) and pin (100).
6. Repeat this procedure for all of the planetary gears.



Illustration 3

g01203714

7. Install bearing (99). Use Tooling (D) to install retaining ring (98).

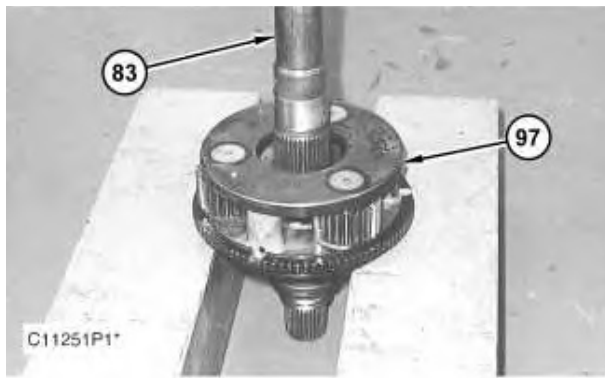

Illustration 4

g01203712

8. Position planetary carrier (97) and install input shaft (83).



Illustration 5

g01203710

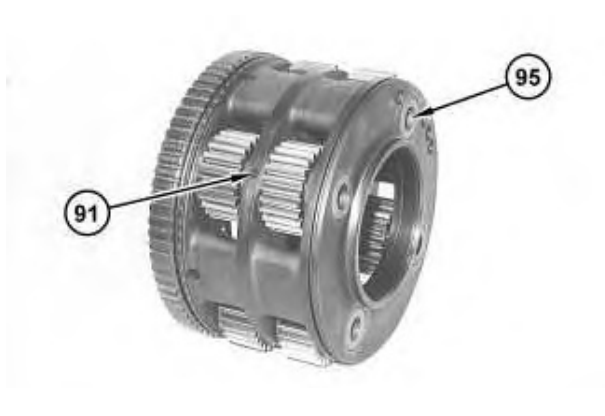

Illustration 6

g01204240

9. Install bearings (93) into gears (92) and (94).
10. Install gears (92) and (94) and thrust washers (96) into the planetary carrier .
11. Install shaft (95) and pin (91).

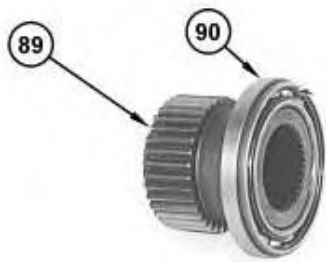

Illustration 7

g01204271

12. Install the seal on gear (89).
13. Put oil on the O-ring seal immediately before the assembly. Install bearing (90) on gear (89).



Illustration 8

g01204275

14. Install gear (89) in the planetary carrier. Install retaining ring (88).



Illustration 9

g01203706

15. Install retaining ring (86) on the planetary carrier. Use Tooling (G) to compress the retaining ring during the installation of the planetary carrier into gear (87). Remove Tooling (G).

Thank you so much for reading.
Please click the “Buy Now!”
button below to download the
complete manual.



After you pay.

You can download the most
perfect and complete manual in
the world immediately.

Our support email:

ebooklibonline@outlook.com