

Product: TRACK-TYPE TRACTOR

Model: D6T XW PAT TRACK-TYPE TRACTOR WRN

Configuration: D6T TRACK-TYPE TRACTOR XL VPAT, XW VPAT, LGP VPAT, Differential Steering WRN00001-UP (MACHINE) POWERED BY C9.3 Engine

Disassembly and Assembly D6T Track-Type Tractor Power Train

Media Number -UENR4055-03

Publication Date -01/12/2017

Date Updated -15/12/2017

i04905930

Steering Planetary and Brake - Disassemble

SMCS - 4132-015

Disassembly Procedure

Table 1

Required Tools			
Tool	Part Number	Description	Qty
A	138-7575	Link Bracket	3
B	1P-0520	Driver Group	1
C	5B-4274	Forcing Bolt 3/8 - 16 by 3.5 inches	3

Start By:

- A. Remove the final drive, the planetary group, and the brake.

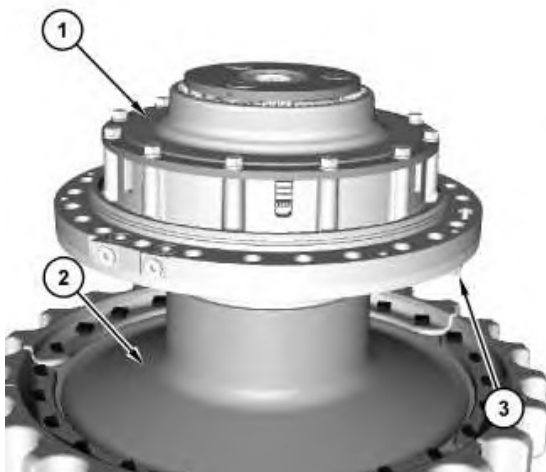

Illustration 1

g02355593

1. Position the final drive, the planetary group, and the brake, as shown.
2. Remove bolts (3) that hold the planetary group and brake (1) to final drive (2) .

3. Attach Tooling (A) and a suitable lifting device to the planetary group and brake.
4. Install Tooling (C) in the final drive hub.
5. Tighten the forcing screws evenly in order to remove the planetary group and brake (1) from final drive (2) .
The weight of planetary group and brake (1) is approximately 136 kg (300 lb).

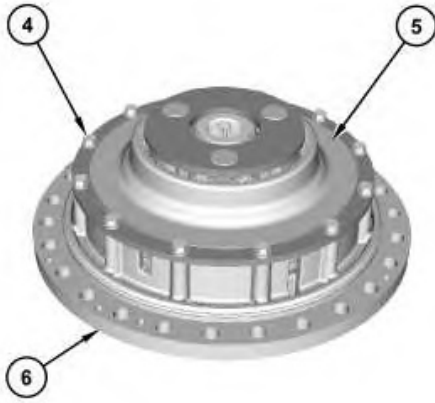

Illustration 2

g02355596



WARNING

Personal injury can result from parts and/or covers under spring pressure.

Spring force will be released when covers are removed.

Be prepared to hold spring loaded covers as the bolts are loosened.

6. Remove bolts (4) . Remove ring gear (5) from housing (6) .



Illustration 3

g02355619

7. Remove friction discs (7) and the brake plates from the housing.

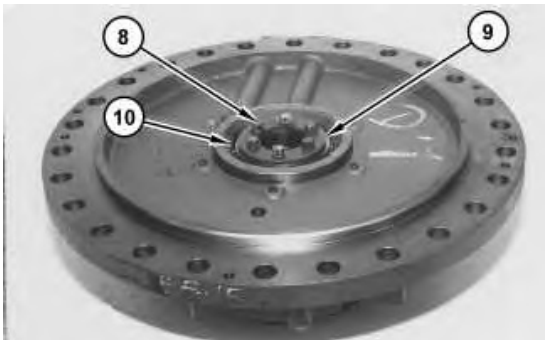

Illustration 4

g02355621

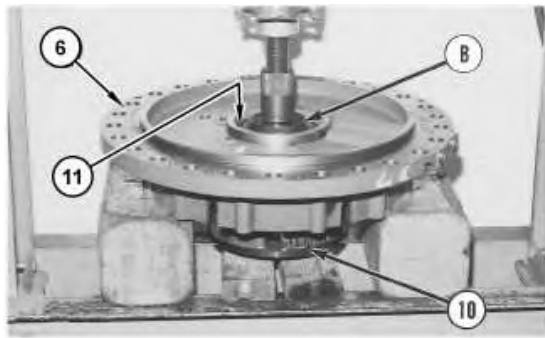

Illustration 5

g02355623

8. Remove bolts (8) and plate (9) .
9. Position the housing on suitable cribbing.

Note: Do not allow planetary carrier (10) to fall when the carrier is pressed from housing (6) .

Note: If a shim pack is present between the plate (9) and planetary carrier (10) . Reuse the same shim pack during assembly only if reusing the same planetary carrier (10) . If a new planetary carrier (10) is being used the shim pack should be discarded.

10. Use Tooling (B) and a suitable press to remove planetary carrier (10) from housing (6) .
11. Remove bearing cone (11) from the housing.



Illustration 6

g01205303

12. Remove ring (14) from planetary carrier (10) . Remove bolts (13) . Remove slinger (12) from the planetary carrier.

NOTICE

The bearing is destroyed if the bearing is removed.

13. If necessary, remove bearing cone (15) from planetary carrier (10) .



Illustration 7

g00622128

14. Use a hammer and a punch to push pin (17) in shaft (16) .

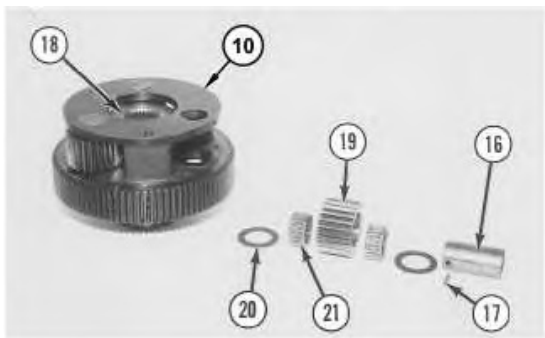

Illustration 8

g01205304

15. Remove shaft (16) , planetary gear (19) , discs (20) , and bearings (21) from planetary carrier (10) .
 16. Remove pin (17) from shaft (16) .
 17. Repeat Steps 14 through 16 for the remaining planetary gears.
 18. Remove sun gear (18) from planetary carrier (10) .
-



Illustration 9

g00622132



WARNING

Personal injury can result from parts and/or covers under spring pressure.

Spring force will be released when covers are removed.

Be prepared to hold spring loaded covers as the bolts are loosened.

19. Remove bolts (22) and washers.
20. Remove retainer (23) from piston (24) .



Illustration 10

g00622155

21. If necessary, remove bearing cups (25) and seal ring (26) from retainer (23) .



Illustration 11

g00622156

22. Remove piston (24) and O-ring seal (27) from the housing.



Illustration 12

g00622157

23. Remove seal ring (28) from piston (24) .

Note: Inspect the O-ring seals. If necessary, replace the O-ring seals.



Illustration 13

g00819345

24. Remove spring (29) and ring (30) from housing (5) .

Product: TRACK-TYPE TRACTOR

Model: D6T XW PAT TRACK-TYPE TRACTOR WRN

Configuration: D6T TRACK-TYPE TRACTOR XL VPAT, XW VPAT, LGP VPAT, Differential Steering WRN00001-UP (MACHINE) POWERED BY C9.3 Engine

Disassembly and Assembly D6T Track-Type Tractor Power Train

Media Number -UENR4055-03

Publication Date -01/12/2017

Date Updated -15/12/2017

i04905929

Steering Planetary and Brake - Assemble

SMCS - 4132-016

Assembly Procedure

Table 1

Required Tools			
Tool	Part Number	Description	Qty
A	138-7575	Link Bracket	3
D	6V-6640	Sealant	1

Reference Refer to Specifications, "Brake and Planetary" in the Service Manual for your machine.



Illustration 1

g00819345

Note: Orient the disc spring with the outer edge downward.

1. Install ring (30) and spring (29) in housing (5) .



Illustration 2

g00622157

2. Apply clean oil to seal ring (28) .

Note: Orient the seal ring with the lip downward. Refer to Illustration 2.

3. Install seal ring (28) in piston (24) .



Illustration 3

g00622156

4. Install piston (24) and O-ring seal (27) in the housing.



Illustration 4

g00622155

5. Lower the temperature of bearing cups (25). Install bearing cups (25) in retainer (23) .

Note: Orient the seal ring with the lip downward. Refer to Illustration 4.

6. Apply clean oil to seal ring (26). Install seal ring (26) in retainer (23) .

Thank you so much for reading.
Please click the “Buy Now!”
button below to download the
complete manual.



After you pay.

You can download the most
perfect and complete manual in
the world immediately.

Our support email:

ebooklibonline@outlook.com