

Product: TRACK-TYPE TRACTOR
Model: D7F TRACK-TYPE TRACTOR 94N
Configuration: D7F TRACTOR 94N00001-05191 (MACHINE)

Disassembly and Assembly D7F ENGINE

Media Number -REG00822-00

Publication Date -01/11/1971

Date Updated -17/03/2010

REG008220034

Crankshaft Rear Seal

SMCS - 1161-11; 1161-12

Remove Crankshaft Rear Seal

Tools Required	A
1P3075 Seal Puller Group	1

preparatory step:

a) remove flywheel

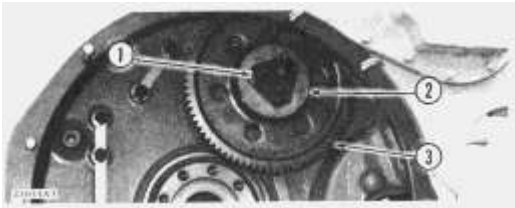

1. Remove the hydraulic pump drive idler gear mounting bolts (1) and lock.
2. Remove idler gear (3) and shaft (2).



3. Using seal puller group (A), remove the crankshaft rear seal.

Install Crankshaft Rear Seal

Tools Required		A
9S8543	Seal Installer Ring	1
9S8548	Seal Pilot	1
9S8890	Screw	3
9S8871	Locator Assembly	1
9S8864	Pusher Plate	1
9S8858	Nut	1

1. Using tool setup (A), install the crankshaft rear seal as follows:

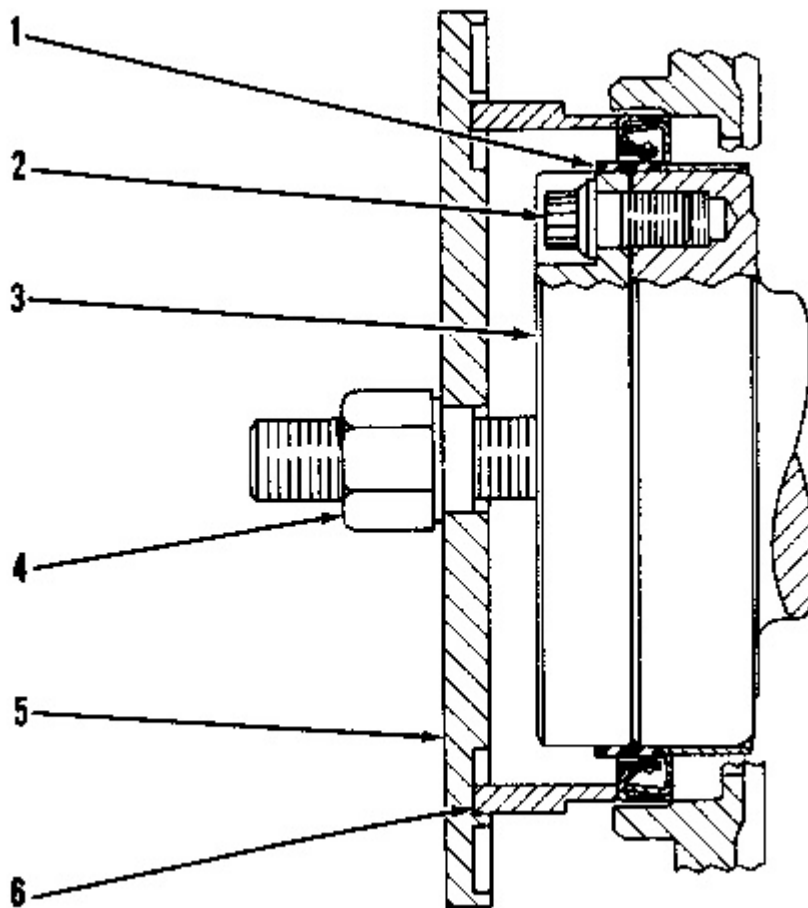

28799X1

TYPICAL EXAMPLE

a) Install the locator assembly (3) and retaining screws (2) on the crankshaft.

b) Lubricate the lip of seal and the seal pilot (1) with clean SAE 30 engine oil. Place the seal on the seal pilot (1) with thickest portion of seal outer metal shell toward the flywheel. Coat the seal

outer metal shell with 8M8059 Loctite Sealant. Slide the seal pilot (1) onto the locator assembly (3) and the crankshaft.

c) Place the seal installer ring (6) on the pusher plate (5), and slide the pusher plate onto the stud of the locator assembly (3).

d) Lubricate the nut (4) with clean SAE 30 engine oil, and install nut on stud of locator assembly (3).

e) Tighten the nut (4) until the seal bottoms.

2. Remove tool setup (A).

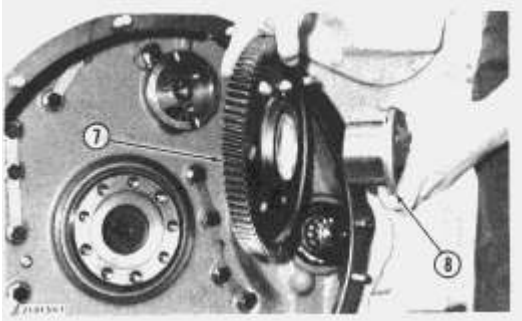

3. Install the idler gear (7) and shaft (8). Install retaining bolts and lock.

concluding step:

a) install flywheel

Product: TRACK-TYPE TRACTOR
Model: D7F TRACK-TYPE TRACTOR 94N
Configuration: D7F TRACTOR 94N00001-05191 (MACHINE)

Disassembly and Assembly D7F ENGINE

Media Number -REG00822-00

Publication Date -01/11/1971

Date Updated -17/03/2010

REG008220035

Power Take-Off Drive Gears & Bearings

SMCS - 1165-11; 1165-12

Remove Power Take-Off Drive Gears And Bearings

Tools Required		A
1P487	Drive Plate	1
1P483	Drive Plate	1
1P531	Handle	1

preparatory step:

a) remove transmission oil pump

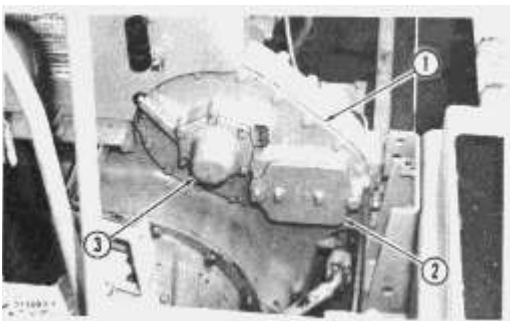

1. Remove the front right floor plate and the access plate. Remove the cover assembly (1).
2. Remove the covers (2) and (3) from the cover assembly. Using tool setup (A), remove the bearings from the cover assembly. Remove the thrust washers from the cover assembly.

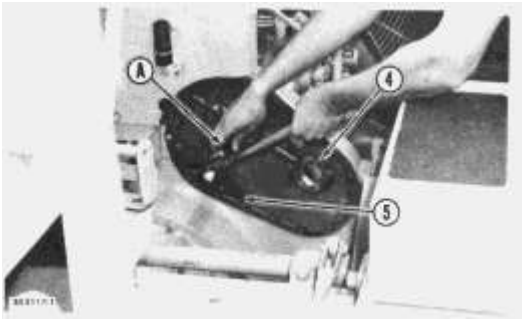

3. Remove the two drive gears. Remove the cover on front side of flywheel housing. Using tool setup (A), remove the bearings from flywheel housing. Remove the thrust washers (4) from housing.

NOTE: If idler gear (5) and drive gear on crankshaft are to be removed, it will be necessary to remove the flywheel. See REMOVE FLYWHEEL.

Install Power Take-Off Drive Gears And Bearings

Tools Required		A
1P487	Drive Plate	1
1P483	Drive Plate	1
1P531	Handle	1

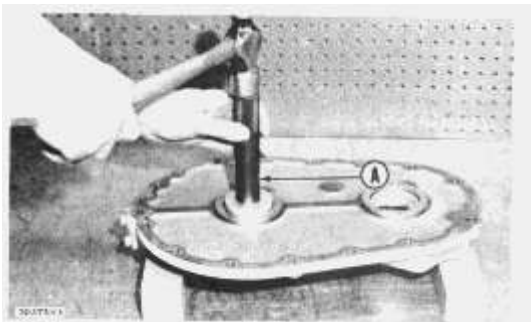

1. Using tool setup (A), install the bearings in flywheel housing with hole in bearing aligned with hole in flywheel housing. Install the thrust washers in housing.

2. Using tool setup (A), install bearings in the cover assembly with hole in bearing aligned with hole in cover assembly. Install thrust washers in cover assembly. Install the two covers on the cover assembly.



- 3.** Thoroughly lubricate all bearings and thrust washers with clean SAE 30 engine oil.
- 4.** Install the two drive gears in flywheel housing. Install the front cover on flywheel housing.
- 5.** Install the cover assembly on flywheel housing.

concluding step:

- a)** install transmission oil pump
-

Product: TRACK-TYPE TRACTOR
Model: D7F TRACK-TYPE TRACTOR 94N
Configuration: D7F TRACTOR 94N00001-05191 (MACHINE)

Disassembly and Assembly D7F ENGINE

Media Number -REG00822-00

Publication Date -01/11/1971

Date Updated -17/03/2010

REG008220036

Engine

SMCS - 1000-11; 1000-12

Remove Engine

preparatory step:

a) remove hood

1. Drain the engine cooling system - capacity 12 U.S. Gal. (45 liters).
2. Drain the oil from the flywheel housing.
3. Remove the cover plates from bottom of fuel tank, and shut off the fuel supply line.

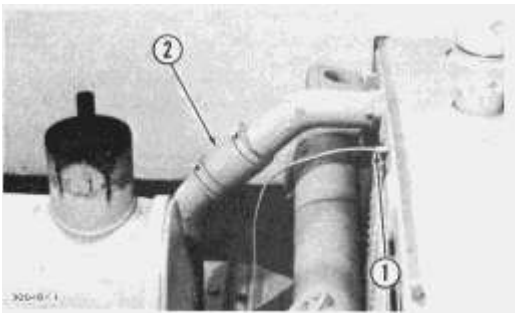

4. Disconnect the water pressure gauge sensing line (1) from the radiator top tank.
5. Disconnect radiator water outlet line hose from the water pump. Disconnect hose (2) from radiator water inlet elbow.

Thank you so much for reading.
Please click the “Buy Now!”
button below to download the
complete manual.



After you pay.

You can download the most
perfect and complete manual in
the world immediately.

Our support email:

ebooklibonline@outlook.com