

TM113419 - X115R, X135R, X155R, 92H, 107H Tractors

Install Oil Pump Single Cylinder

Install Oil Pump Single Cylinder

1. **IMPORTANT:**

Oil pump cover (A) should be removed when installing sump.

Install sump and gasket.

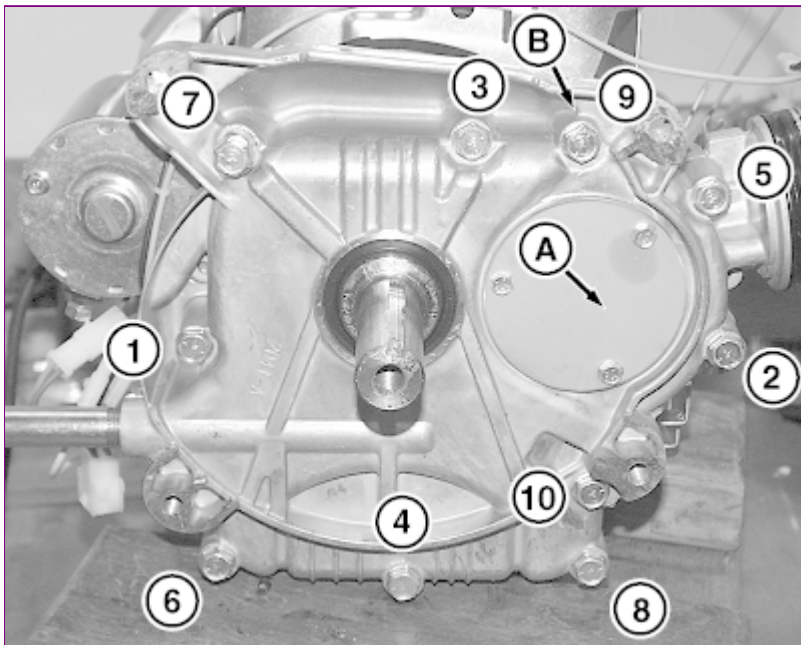

2. GXT001600-UN: Cover Torque Sequence

Tighten all screws, using the pattern shown, to specification.

Item	Measurement	Specification
Oil Sump Cover Screws	Torque	20 N·m (175 lb.-in.)

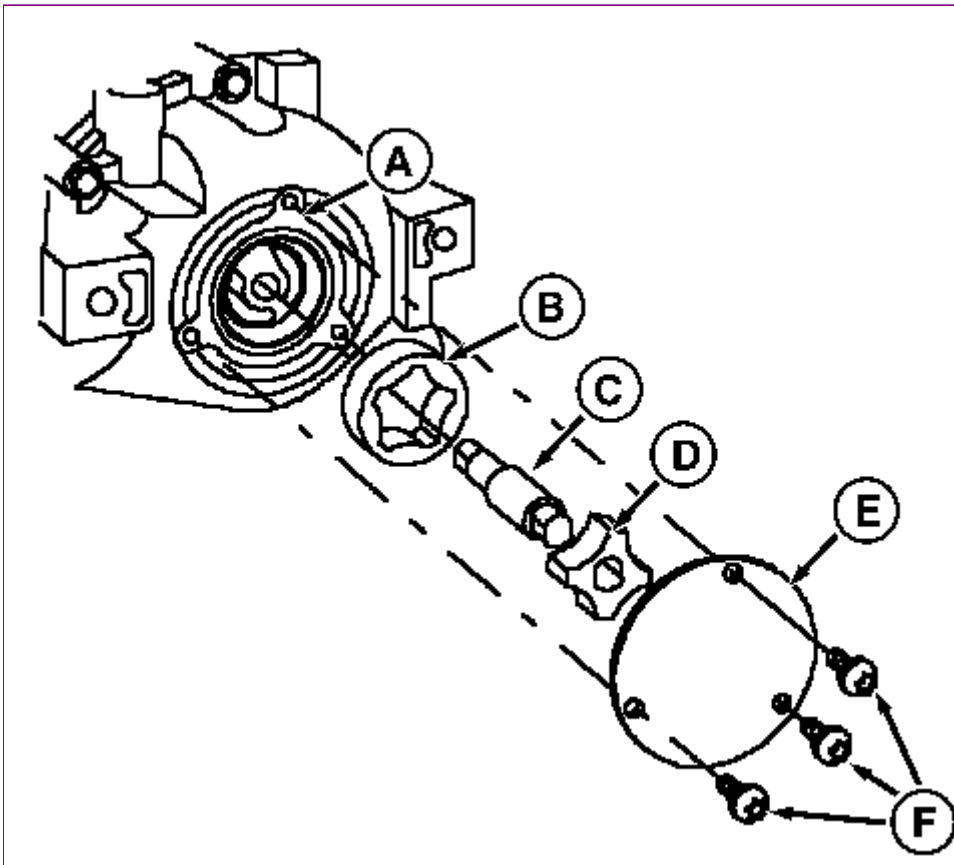

3. MXT002447-UN: Oil Pump Cover

LEGEND:

- A - O-ring
- B - Inner Rotor
- C - Drive Shaft
- D - Outer Rotor
- E - Cover
- F - Screws

Install the oil pump drive shaft (C), ensuring that it engages with camshaft.

4. Lightly coat the rotors with new motor oil. Install the inner (D) then the outer (B) rotor.
5. Insert the O-ring (A) into the O-ring groove in the sump and secure cover (E) with the 3 screws (F). Tighten the screws to specification.

Item	Measurement	Specification
Oil Pump Cover Screws	Torque	6 N·m (50 lb.-in.)

6. Complete installation of remaining governor linkage and carburetor.
7. Adjust governor. (See [Governor Static Adjustment](#) and [Governor Dynamic Adjustment](#) .)

NOTE:

Engine oil pressure will vary with oil viscosity, ambient air temperature differences, operating temperatures and engine load.

8. Check that engine oil pressure meets specification.

Item	Measurement	Specification
Oil pressure	Pressure	103—345 kPa (15—50 psi)

BS62576,000180F-19-20141114

TM113419 - X115R, X135R, X155R, 92H, 107H Tractors Remove Balance System Single Cylinder

Remove Balance System Single Cylinder

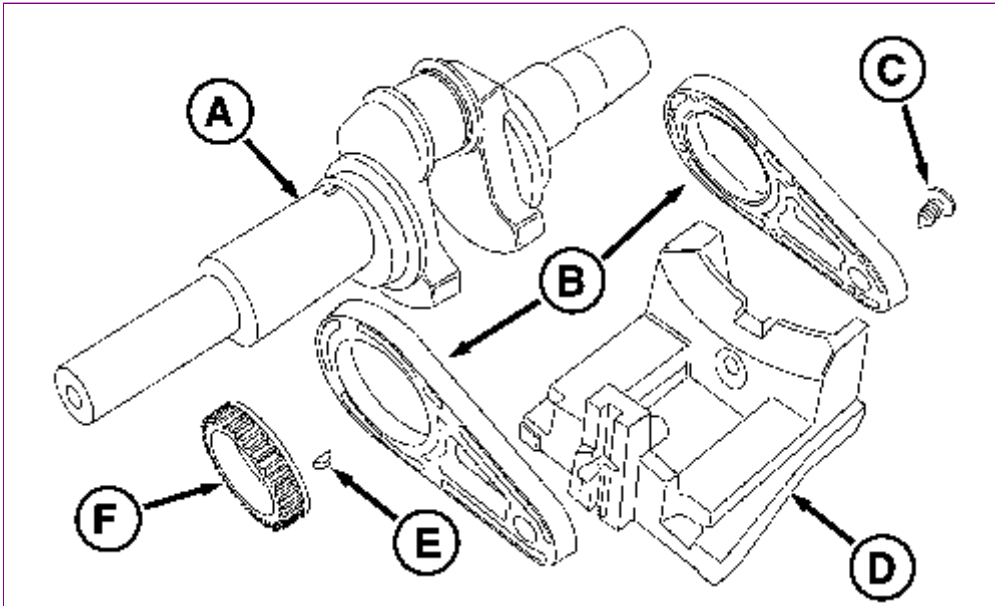

MXT003049-UN: Crankshaft and Balance System

LEGEND:

- A - Crankshaft
- B - Counterweight Links
- C - Alignment Plug
- D - Counterweight
- E - Woodruff Key
- F - Crankshaft Gear

1. Remove crankshaft.
 2. Remove the crankshaft gear (F) from the crankshaft (A). If the gear is tight pry it off using two screwdrivers, being careful not to damage the gear.
 3. Remove the woodruff key (E) from the crankshaft.
 4. Remove and discard the plastic alignment plug (C) from the magneto side of the counterweight (D). Slide the counterweight from the counterweight links (B).
 5. Remove the counterweight links from the crankshaft.
-

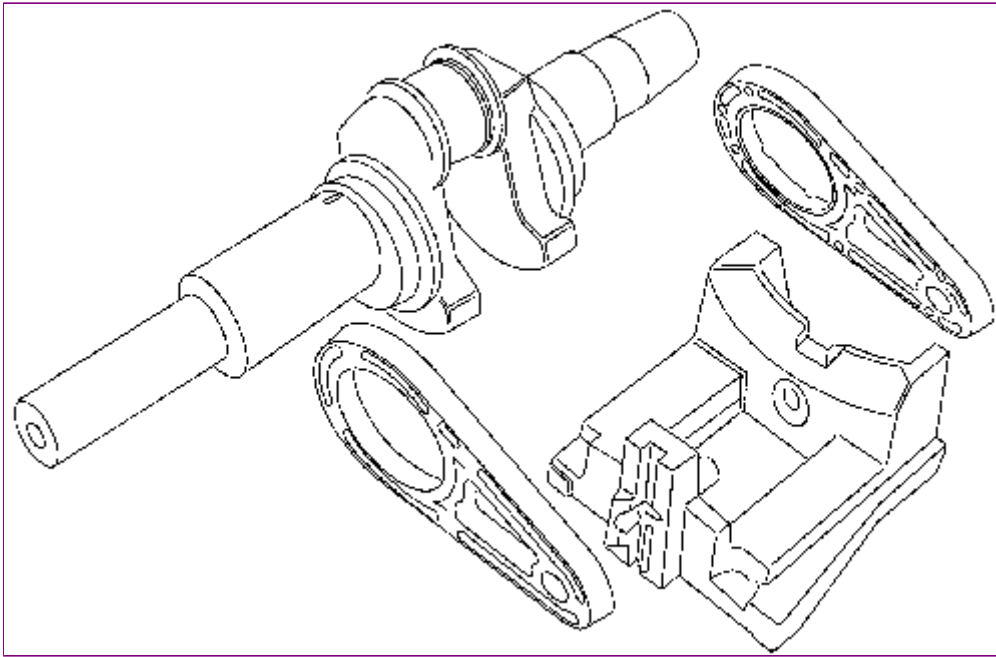

6. MXT003050-UN: Crankshaft, Links, and Counterweight

Check counterweight pins, counterweight link bearing surfaces, and crankshaft eccentric surfaces for wear.

7. If counterweight link bearing surfaces are discolored, scored or worn to or over reject size, the links must be replaced.

Item	Measurement	Specification
Balance System Wear Limits		
Crankshaft Eccentric Journal	OD	55.93 mm (2.202 in.)
Counterweight Link Bearing	ID	56.13 mm (2.210 in.)

Thank you so much for reading.
Please click the “Buy Now!”
button below to download the
complete manual.



After you pay.

You can download the most
perfect and complete manual in
the world immediately.

Our support email:

ebooklibonline@outlook.com