

**100 ENGINE SUSPENSION 1)**

Pos.	Part No.	Description	Dimension	Quantity	Conditions
1	<b>00 1302 287 0</b>	DIESEL ENGINE	TCD 2012 LO4 2V 103 KW/2	1	2)
2	<b>00 1300 828 1</b>	CLUTCH		1	
3	<b>00 0237 874 0</b>	HEXAGON HEAD BOLT	M10X35	8	
4	<b>00 1300 444 0</b>	FLANGE		1	
5	<b>00 0235 495 1</b>	SOCKET HEAD SCREW	M10X 25	12	
6	<b>00 0242 380 0</b>	HEXAGON HEAD BOLT	M12X120	4	
7	<b>00 0238 315 0</b>	HEXAGONAL NUT	M12	4	
8	<b>00 1301 651 0</b>	SPACER PIECE		4	
9	<b>00 1301 652 0</b>	WASHER		4	
10	<b>00 1301 630 0</b>	SHUT OFF PLATE		2	
11	<b>00 0237 573 0</b>	HEXAGON HEAD BOLT	M12X50	2	
12	<b>00 0214 777 0</b>	SOCKET HEAD SCREW	M12X 40	2	
13	<b>00 1300 481 0</b>	BEARING PLATE		1	
14	<b>00 1300 364 0</b>	BEARING PLATE		1	
15	<b>77 0102 992 4</b>	HEXAGON HEAD SCREW		4	
16	<b>00 1301 870 0</b>	STAND		2	
<b>1)</b>	<b>machine no.</b>		+ up to 403030056		
<b>2)</b>	<b>Remarks</b>		103 KW		

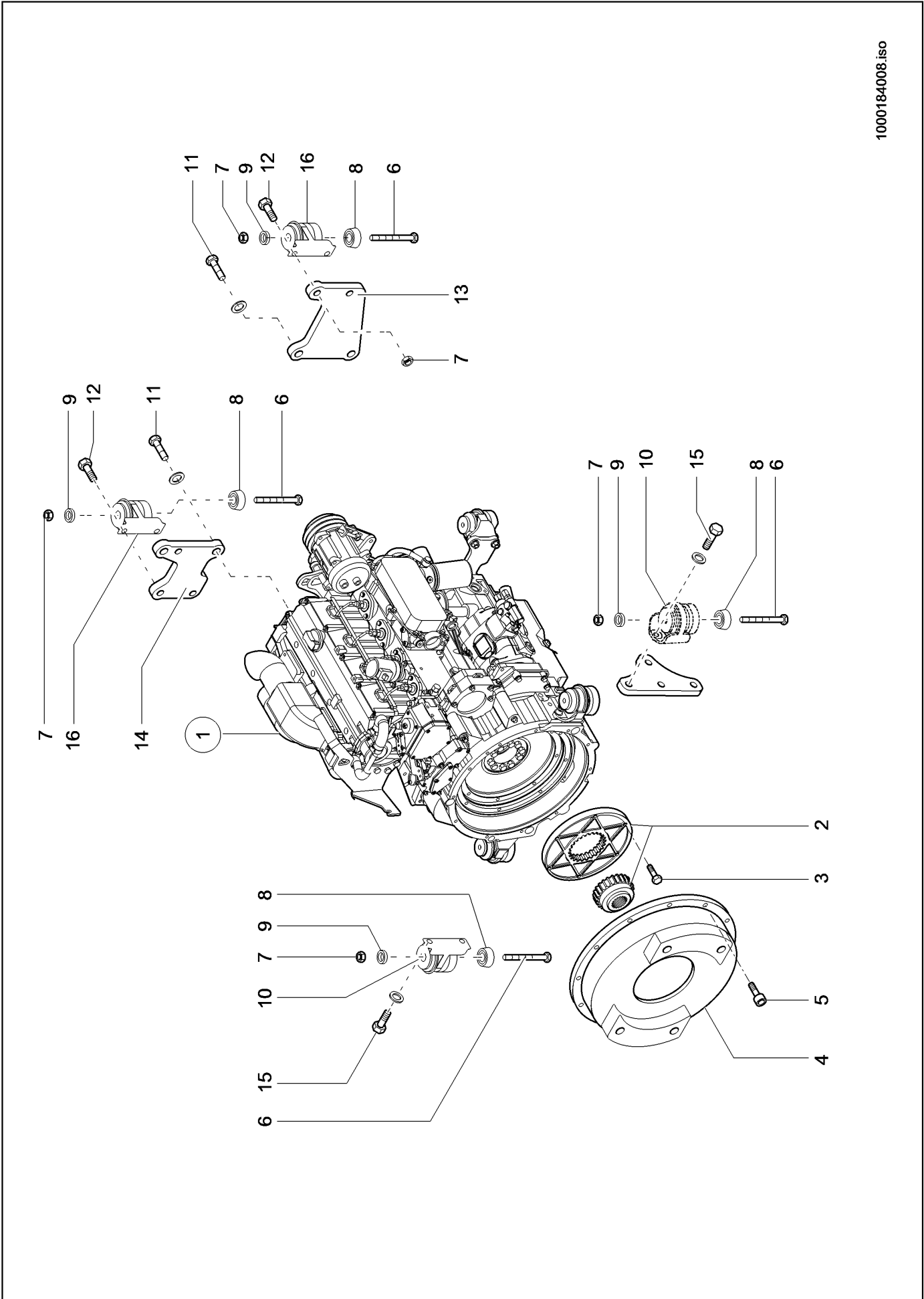

**100 ENGINE SUSPENSION 1)**

Pos.	Part No.	Description	Dimension	Quantity	Conditions
1	<b>00 1302 287 1</b>	DIESEL ENGINE	TCD 2012 LO4 2V 103 KW/2	1	2)
2	<b>00 1300 828 1</b>	CLUTCH		1	
3	<b>00 0237 874 0</b>	HEXAGON HEAD BOLT	M10X35	8	
4	<b>00 1300 444 0</b>	FLANGE		1	
5	<b>00 0235 495 1</b>	SOCKET HEAD SCREW	M10X 25	12	
6	<b>00 0242 380 0</b>	HEXAGON HEAD BOLT	M12X120	4	
7	<b>00 0238 315 0</b>	HEXAGONAL NUT	M12	4	
8	<b>00 1301 651 0</b>	SPACER PIECE		4	
9	<b>00 1301 652 0</b>	WASHER		4	
10	<b>00 1301 630 0</b>	SHUT OFF PLATE		2	
11	<b>00 0237 573 0</b>	HEXAGON HEAD BOLT	M12X50	2	
12	<b>00 0214 777 0</b>	SOCKET HEAD SCREW	M12X 40	2	
13	<b>00 1300 481 0</b>	BEARING PLATE		1	
14	<b>00 1300 364 0</b>	BEARING PLATE		1	
15	<b>77 0102 992 4</b>	HEXAGON HEAD SCREW		4	
16	<b>00 1301 870 0</b>	STAND		2	
<b>1)</b>	<b>machine no.</b>		+ from 403030057		
<b>2)</b>	<b>Remarks</b>		103 KW		

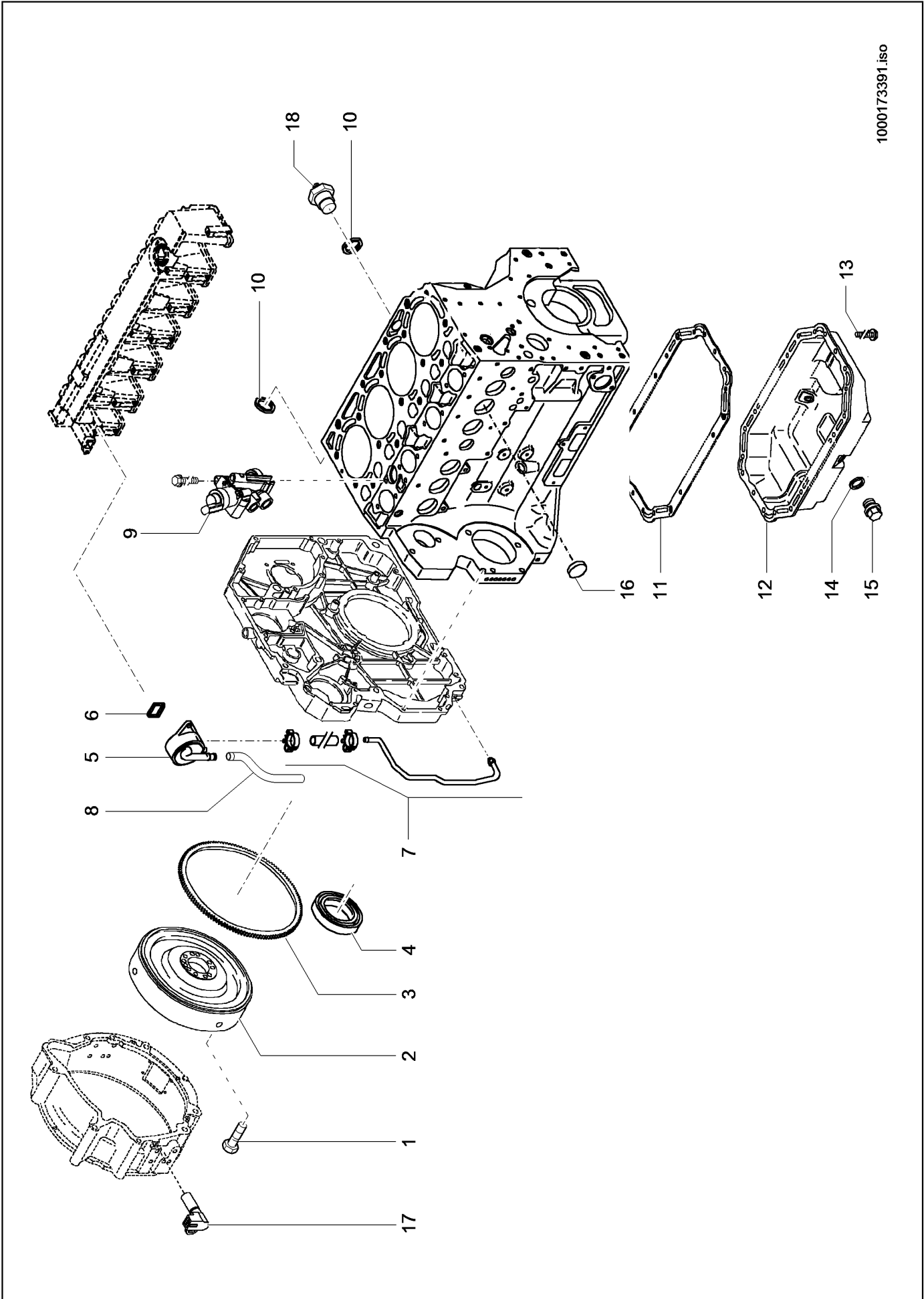

1000173391.iso

**100 CRANKCASE 1)**

Pos.	Part No.	Description	Dimension	Quantity	Conditions
1	<b>00 1301 721 0</b>	HEXAGON HEAD BOLT	N. Z.	8	
2	<b>00 1301 657 0</b>	FLYWHEEL		1	2)
3	<b>00 1134 889 0</b>	TOOTHED RIM		1	
4	<b>00 1301 663 0</b>	ROTARY SHAFT SEAL		1	
5	<b>00 1302 414 0</b>	BREATHER VALVE		1	
6	<b>00 1302 424 0</b>	GASKET		1	
7	<b>00 1302 425 0</b>	RETURN PIPE		1	
8	<b>00 1302 410 0</b>	HOSE		1	
9	<b>00 1302 445 0</b>	CONTROL BLOCK		1	
10	<b>60 0500 090 3</b>	SEALING RING		2	
11	<b>00 1301 660 0</b>	GASKET		1	
12	<b>00 1301 658 0</b>	OIL SUMP		1	
13	<b>60 0502 649 7</b>	HEXAGON HEAD BOLT	M08X16	22	
14	<b>60 0502 632 1</b>	SEALING RING	18X24-1,34	1	
15	<b>00 1300 046 0</b>	DRAIN COUPLING	ÖL E-A-M18X1,5 - M22X1,5	1	
16	<b>00 1301 654 0</b>	LOCKING COVER	A 45	6	
17	<b>00 1301 656 0</b>	RPM SENSOR		1	
18	<b>00 1302 352 0</b>	TEMP. SWITCH	50 - 150°C	1	
<b>1)</b>	<b>machine no.</b>		+ up to 403030415 103 KW		
<b>2)</b>	<b>Remarks</b>		complete		

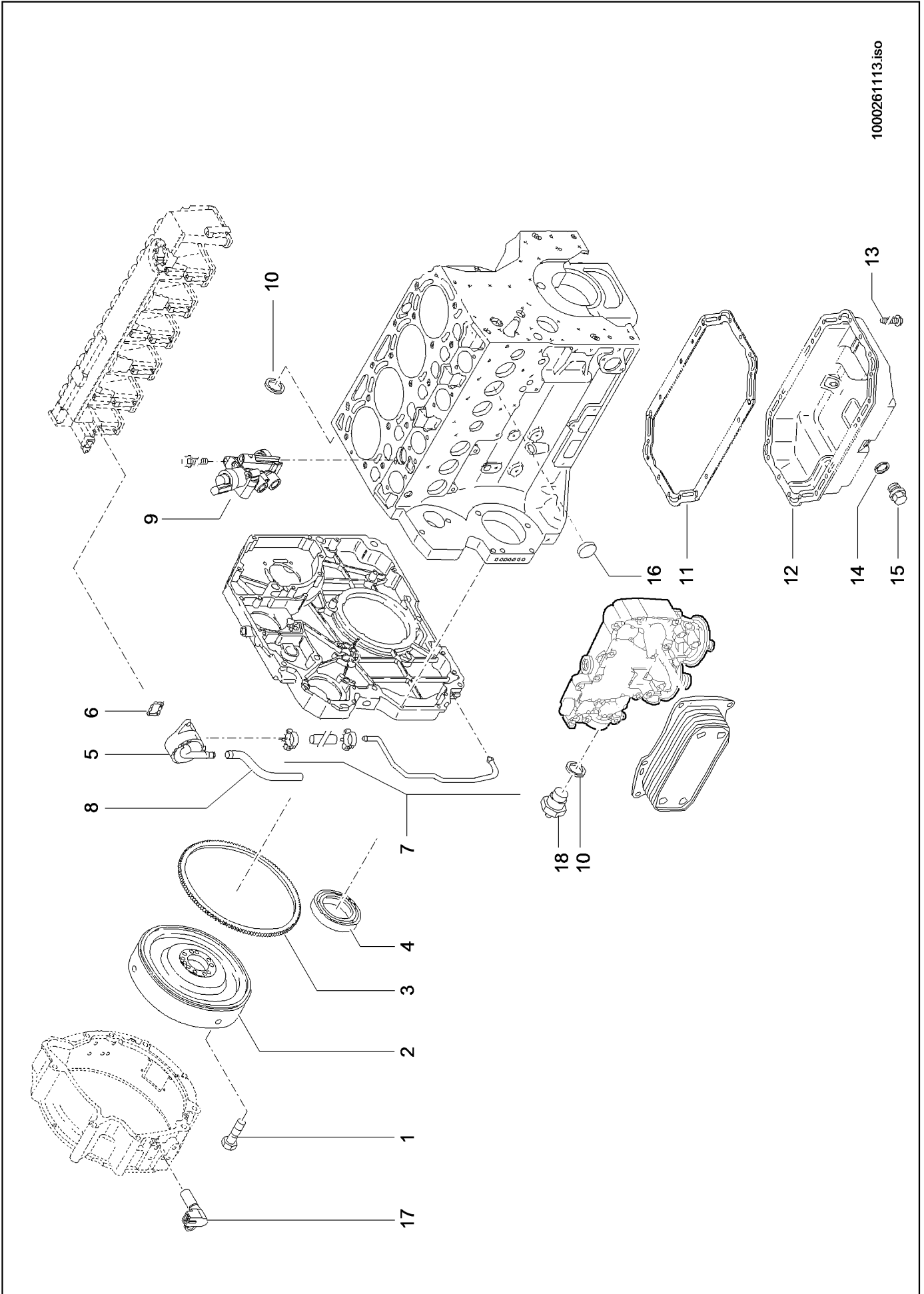

1000261113.iso

**100 CRANKCASE 1)**

Pos.	Part No.	Description	Dimension	Quantity	Conditions
1	<b>00 1301 721 0</b>	HEXAGON HEAD BOLT	N. Z.	8	
2	<b>00 1301 657 0</b>	FLYWHEEL		1	2)
3	<b>00 1134 889 0</b>	TOOTHED RIM		1	
4	<b>00 1301 663 0</b>	ROTARY SHAFT SEAL		1	
5	<b>00 1302 414 0</b>	BREATHER VALVE		1	
6	<b>00 1302 424 0</b>	GASKET		1	
7	<b>00 1302 425 0</b>	RETURN PIPE		1	
8	<b>00 1302 410 0</b>	HOSE		1	
9	<b>00 1302 445 0</b>	CONTROL BLOCK		1	
10	<b>60 0500 090 3</b>	SEALING RING		2	
11	<b>00 1301 660 0</b>	GASKET		1	
12	<b>00 1301 658 0</b>	OIL SUMP		1	
13	<b>60 0502 649 7</b>	HEXAGON HEAD BOLT	M08X16	22	
14	<b>60 0502 632 1</b>	SEALING RING	18X24-1,34	1	
15	<b>00 1300 046 0</b>	DRAIN COUPLING	ÖL E-A-M18X1,5 - M22X1,5	1	
16	<b>00 1301 654 0</b>	LOCKING COVER	A 45	6	
17	<b>00 1301 656 0</b>	RPM SENSOR		1	
18	<b>00 1303 750 0</b>	TEMPERAT.FEELER		1	
<b>1)</b>	<b>machine no.</b>		+ from 403030416 103 KW		
<b>2)</b>	<b>Remarks</b>		complete		



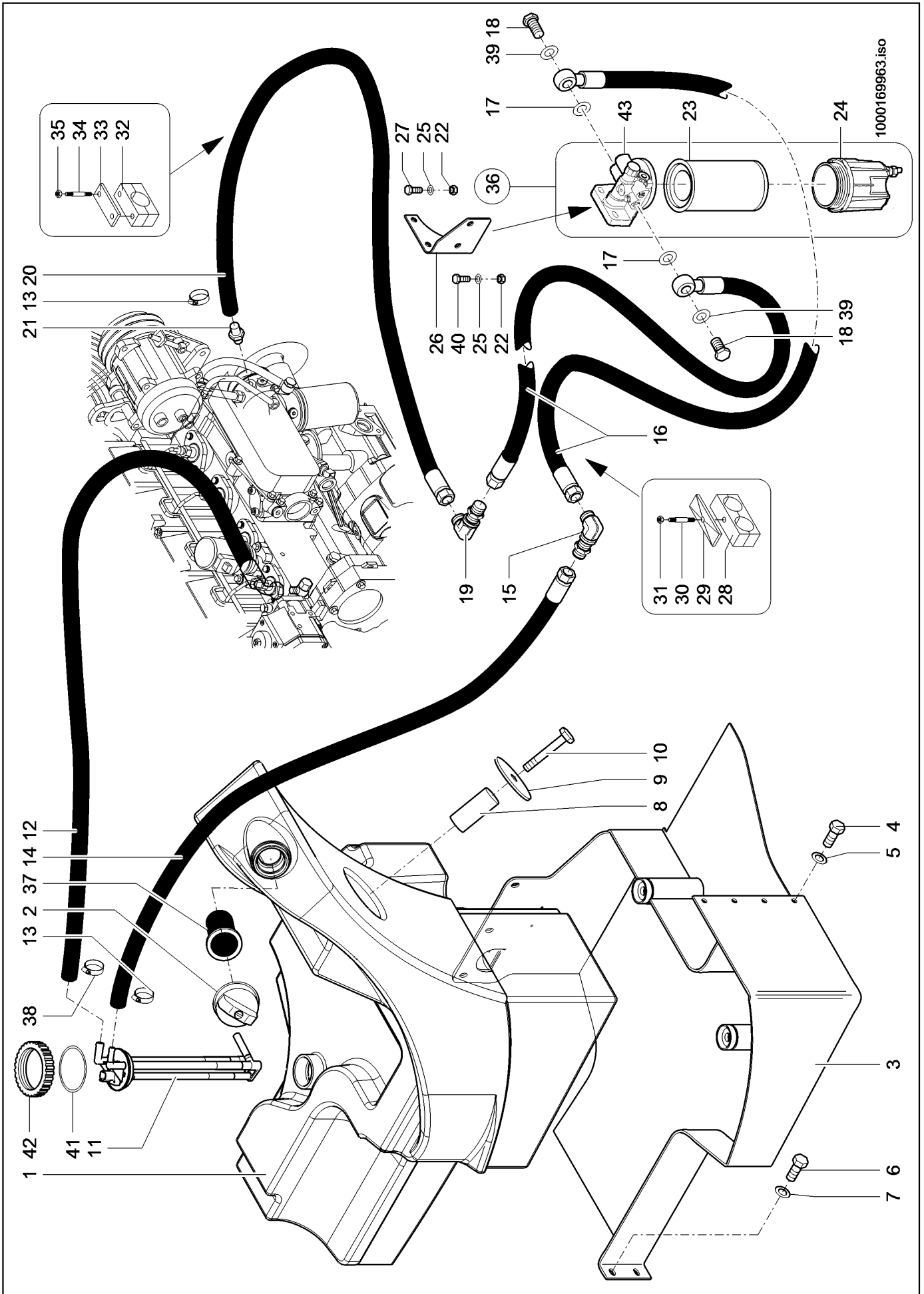

**100 FUEL TANK 1)**

Pos.	Part No.	Description	Dimension	Quantity	Conditions
1	<b>00 1300 416 0</b>	FUEL TANK		1	
2	<b>00 1300 181 0</b>	LOCKING COVER	KRAFTSTOFFTANK	1	
3	<b>00 1300 611 0</b>	BEARING		1	
4	<b>00 0237 383 0</b>	HEXAGON HEAD BOLT	M10X25	7	
5	<b>00 0215 683 0</b>	WASHER	10,5	7	
6	<b>77 0002 771 6</b>	SECURING SCREW	M16X45-VERBUS RIPP	2	
7	<b>00 0214 612 0</b>	WASHER	16	2	
8	<b>00 1300 436 0</b>	SPACER TUBE		1	
9	<b>00 1301 418 0</b>	WASHER		1	
10	<b>00 0215 898 0</b>	HEXAGON HEAD BOLT	M16X160	1	
11	<b>00 1300 458 0</b>	SUCTION LANCE	BISTABILE REEDKONTAKTE	1	
12	<b>00 1301 266 0</b>	HYDR. HOSE		1	
13	<b>00 1301 433 0</b>	CLAMP	A 12-22X9 W1	2	
14	<b>00 1301 240 0</b>	HOSE PIPE		1	
15	<b>00 0215 102 0</b>	ANGLE UNION	BHE-L15	1	
16	<b>00 1302 308 0</b>	HOSE PIPE		2	
17	<b>00 1302 316 0</b>	SEALING RING	16X27X5	2	
18	<b>00 0096 030 0</b>	HOLLOW SCREW	12 - M16X1,5 (12-3 ZULÄS	1	
19	<b>00 0215 102 0</b>	ANGLE UNION	BHE-L15	1	
20	<b>00 1301 240 0</b>	HOSE PIPE		1	
21	<b>00 1302 368 0</b>	HOSE FITTING		1	
22	<b>00 0238 316 0</b>	LOCK NUT	M10	4	
23	<b>00 1302 279 0</b>	FUEL FILTER		1	
24	<b>00 1302 423 0</b>	CONTAINER		1	
25	<b>00 0215 683 0</b>	WASHER	10,5	4	
26	<b>00 1302 299 0</b>	SUPPORT		1	
27	<b>00 0233 396 0</b>	HEXAGON HEAD BOLT	M10X30-MKL	2	
28	<b>00 1301 437 0</b>	CLAMP	Z KP-3-R-20-20-PP	3	
29	<b>00 1300 064 0</b>	COVER PLATE	Z DP-3-W1 ERS.D.313226.	3	
30	<b>00 1301 540 0</b>	STUD BOLT	M8X90	3	
31	<b>00 0236 170 0</b>	HEXAGONAL NUT	M8	3	
32	<b>00 1301 447 0</b>	CLAMP	L KP-3-R-20-PA	1	
33	<b>00 1300 066 0</b>	COVER PLATE	L DP-3-W1	1	
34	<b>00 1301 536 0</b>	STUD BOLT	M6X55	2	
35	<b>00 0211 113 0</b>	LOCK NUT	M6	2	
36	<b>00 1302 434 0</b>	FILTER HEAD		1	
37	<b>00 1302 051 0</b>	FILL IN STRAINER		1	
38	<b>00 1302 315 0</b>	CLAMP	COBRA 16/8	2	
39	<b>00 0132 239 0</b>	SEALING RING	A16X22X1,5/ A`100 IN TÜT	2	
40	<b>00 0237 874 0</b>	HEXAGON HEAD BOLT	M10X35	2	
41	<b>00 0212 165 0</b>	O-RING	66X3 -N	1	
42	<b>00 1302 876 0</b>	UNION NUT	S80 X 4	1	
43	<b>00 1304 250 0</b>	SUPPORT BRACKET		1	

**1) machine no.**

+ up to 403030917

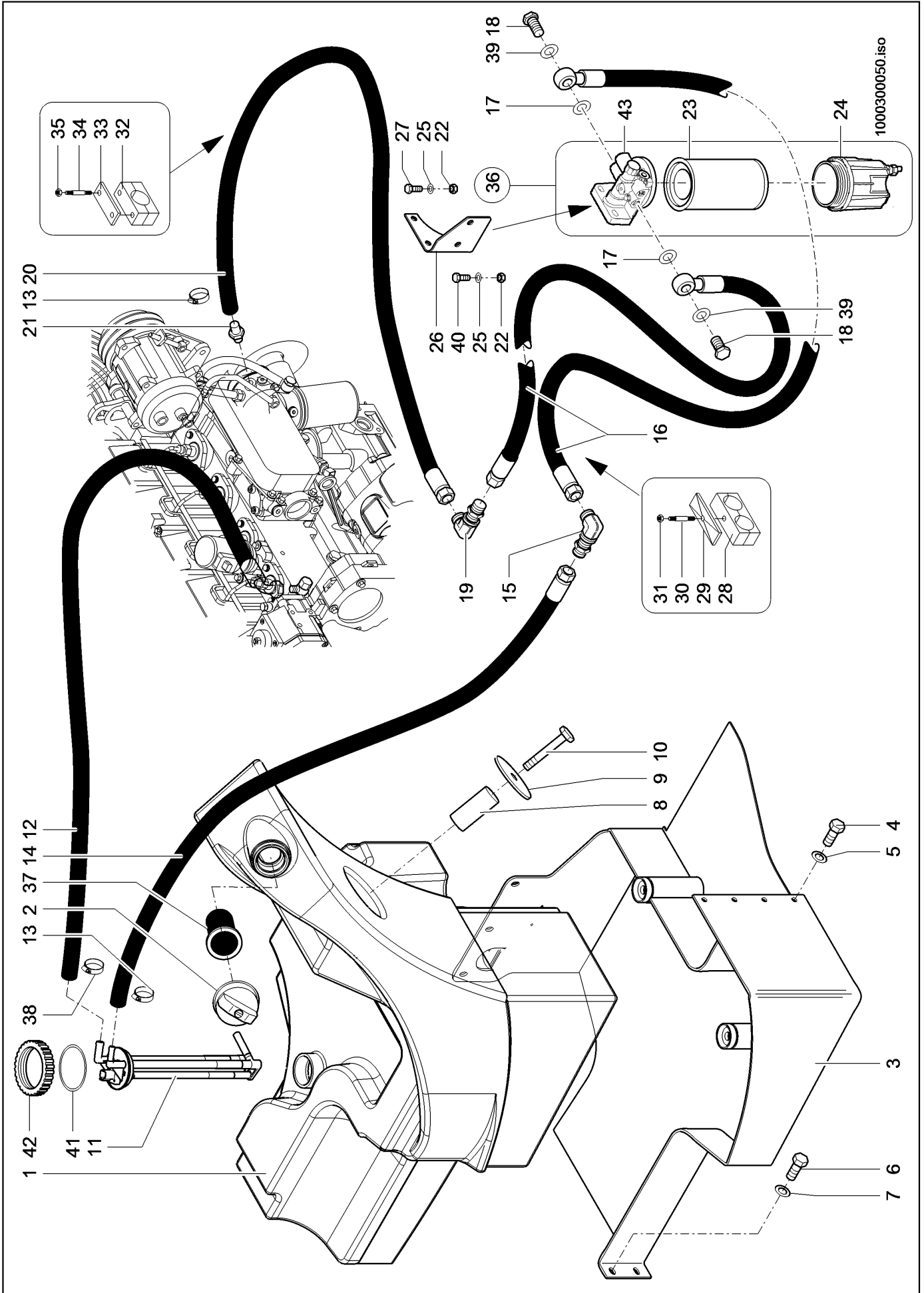

**100 FUEL TANK 1)**

Pos.	Part No.	Description	Dimension	Quantity	Conditions
1	<b>00 1300 416 0</b>	FUEL TANK		1	
2	<b>00 1300 181 0</b>	LOCKING COVER	KRAFTSTOFFTANK	1	
3	<b>00 1300 611 0</b>	BEARING		1	
4	<b>00 0237 383 0</b>	HEXAGON HEAD BOLT	M10X25	7	
5	<b>00 0215 683 0</b>	WASHER	10,5	7	
6	<b>77 0002 771 6</b>	SECURING SCREW	M16X45-VERBUS RIPP	2	
7	<b>00 0214 612 0</b>	WASHER	16	2	
8	<b>00 1300 436 0</b>	SPACER TUBE		1	
9	<b>00 1301 418 0</b>	WASHER		1	
10	<b>00 0215 898 0</b>	HEXAGON HEAD BOLT	M16X160	1	
11	<b>00 1300 458 0</b>	SUCTION LANCE	BISTABILE REEDKONTAKTE	1	
12	<b>00 1301 266 0</b>	HYDR. HOSE		1	
13	<b>00 1301 433 0</b>	CLAMP	A 12-22X9 W1	2	
14	<b>00 1301 240 0</b>	HOSE PIPE		1	
15	<b>00 0215 102 0</b>	ANGLE UNION	BHE-L15	1	
16	<b>00 1302 308 0</b>	HOSE PIPE		2	
17	<b>00 1302 316 0</b>	SEALING RING	16X27X5	2	
18	<b>00 0096 030 0</b>	HOLLOW SCREW	12 - M16X1,5 (12-3 ZULÄS	1	
19	<b>00 0215 102 0</b>	ANGLE UNION	BHE-L15	1	
20	<b>00 1301 240 0</b>	HOSE PIPE		1	
21	<b>00 1302 368 0</b>	HOSE FITTING		1	
22	<b>00 0238 316 0</b>	LOCK NUT	M10	4	
23	<b>00 1302 279 0</b>	FUEL FILTER		1	
24	<b>00 1302 423 0</b>	CONTAINER		1	
25	<b>00 0215 683 0</b>	WASHER	10,5	4	
26	<b>00 1302 299 0</b>	SUPPORT		1	
27	<b>00 0233 396 0</b>	HEXAGON HEAD BOLT	M10X30-MKL	2	
28	<b>00 1301 437 0</b>	CLAMP	Z KP-3-R-20-20-PP	3	
29	<b>00 1300 064 0</b>	COVER PLATE	Z DP-3-W1 ERS.D.313226.	3	
30	<b>00 1301 540 0</b>	STUD BOLT	M8X90	3	
31	<b>00 0236 170 0</b>	HEXAGONAL NUT	M8	3	
32	<b>00 1301 447 0</b>	CLAMP	L KP-3-R-20-PA	1	
33	<b>00 1300 066 0</b>	COVER PLATE	L DP-3-W1	1	
34	<b>00 1301 536 0</b>	STUD BOLT	M6X55	2	
35	<b>00 0211 113 0</b>	LOCK NUT	M6	2	
37	<b>00 1302 051 0</b>	FILL IN STRAINER		1	
38	<b>00 0223 018 0</b>	CLAMP	COBRA 15/8	1	
39	<b>00 0132 239 0</b>	SEALING RING	A16X22X1,5/ A`100 IN TÜT	2	
40	<b>00 0237 874 0</b>	HEXAGON HEAD BOLT	M10X35	2	
41	<b>00 0212 165 0</b>	O-RING	66X3 -N	1	
42	<b>00 1302 876 0</b>	UNION NUT	S80 X 4	1	
43	<b>00 1304 250 0</b>	SUPPORT BRACKET		1	

**1) machine no.**

+ from 403030952

Thank you so much for reading.  
Please click the “Buy Now!”  
button below to download the  
complete manual.



After you pay.

You can download the most  
perfect and complete manual in  
the world immediately.

Our support email:

[ebooklibonline@outlook.com](mailto:ebooklibonline@outlook.com)