

100 ENGINE SUSPENSION 1)

Pos.	Part No.	Description	Dimension	Quantity	Conditions
1	00 1301 751 0	DIESEL ENGINE	BF4M2012C 90 KW/2400MIN-	1	2)
2	00 1300 828 1	CLUTCH		1	
3	00 0237 874 0	HEXAGON HEAD BOLT	M10X35	8	
4	00 1300 444 0	FLANGE		1	
5	00 0235 495 1	SOCKET HEAD SCREW	M10X 25	12	
6	00 0242 380 0	HEXAGON HEAD BOLT	M12X120	4	
7	00 0238 315 0	HEXAGONAL NUT	M12	4	
8	00 1301 651 0	SPACER PIECE		4	
9	00 1301 652 0	WASHER		4	
10	00 1301 630 0	SHUT OFF PLATE		2	
11	00 0237 573 0	HEXAGON HEAD BOLT	M12X50	2	
12	00 0214 777 0	SOCKET HEAD SCREW	M12X 40	2	
13	00 1300 481 0	BEARING PLATE		1	
14	00 1300 364 0	BEARING PLATE		1	
15	77 0102 992 4	HEXAGON HEAD SCREW		4	
16	00 1301 870 0	STAND		2	
17	00 1302 286 0	DIESEL ENGINE	TCD 2012 LO4 2V 88 KW/24	1	3)
1)	machine no.		+ up to 404030107 88/90 KW		
2)	Remarks		90 KW		
3)	Remarks		88 KW		

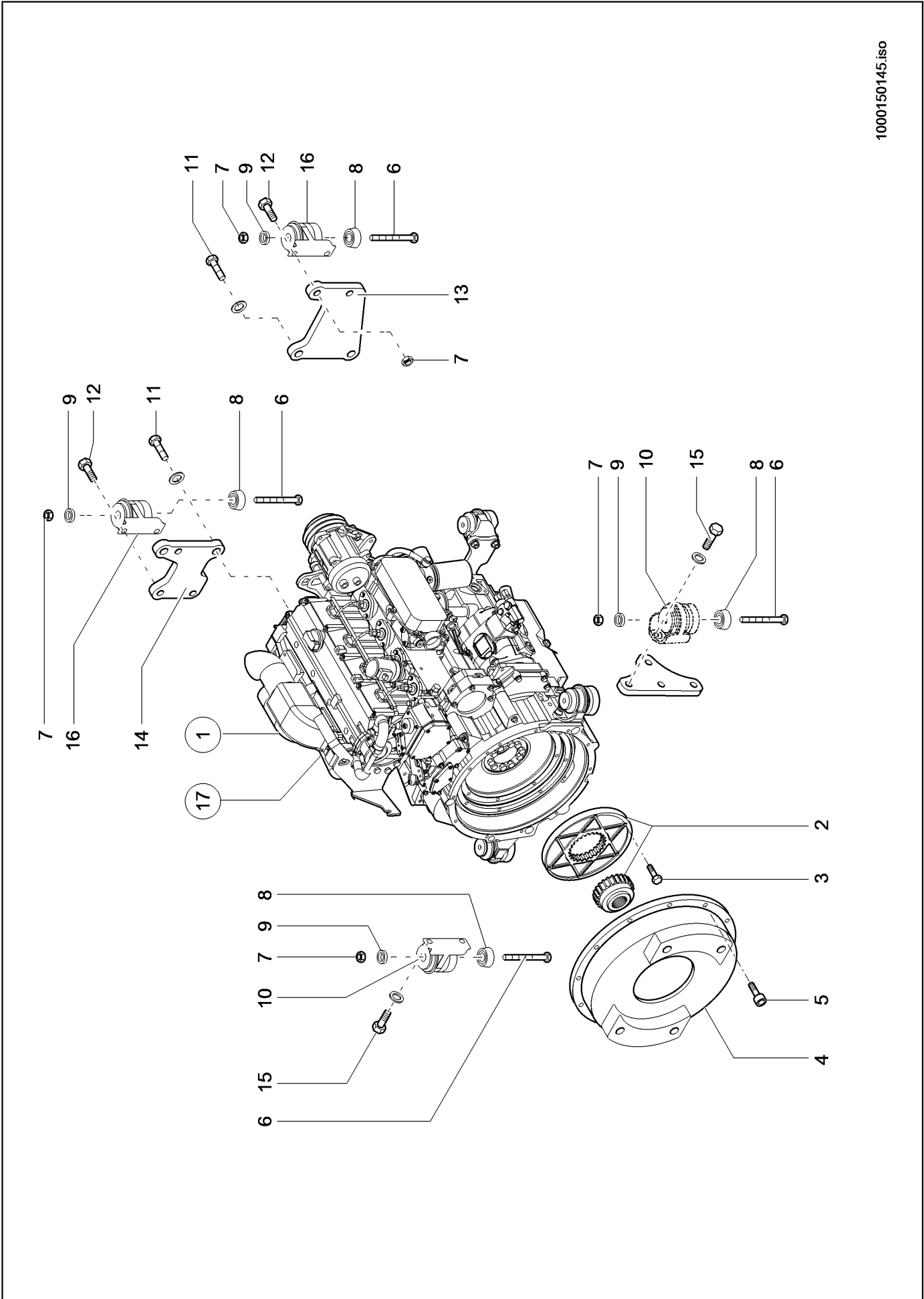

100 ENGINE SUSPENSION 1)

Pos.	Part No.	Description	Dimension	Quantity	Conditions
1	00 1301 728 0	DIESEL ENGINE	BF4M2012C 100KW/2400MIN-	1	2)
2	00 1300 828 1	CLUTCH		1	
3	00 0237 874 0	HEXAGON HEAD BOLT	M10X35	8	
4	00 1300 444 0	FLANGE		1	
5	00 0235 495 1	SOCKET HEAD SCREW	M10X 25	12	
6	00 0242 380 0	HEXAGON HEAD BOLT	M12X120	4	
7	00 0238 315 0	HEXAGONAL NUT	M12	4	
8	00 1301 651 0	SPACER PIECE		4	
9	00 1301 652 0	WASHER		4	
10	00 1301 630 0	SHUT OFF PLATE		2	
11	00 0237 573 0	HEXAGON HEAD BOLT	M12X50	2	
12	00 0214 777 0	SOCKET HEAD SCREW	M12X 40	2	
13	00 1300 481 0	BEARING PLATE		1	
14	00 1300 364 0	BEARING PLATE		1	
15	77 0102 992 4	HEXAGON HEAD SCREW		4	
16	00 1301 870 0	STAND		2	
17	00 1302 287 0	DIESEL ENGINE	TCD 2012 LO4 2V 103 KW/2	1	3)
1)	machine no.		+ up to 404030107 100/103 KW		
2)	Remarks		100 KW		
3)	Remarks		103 KW		

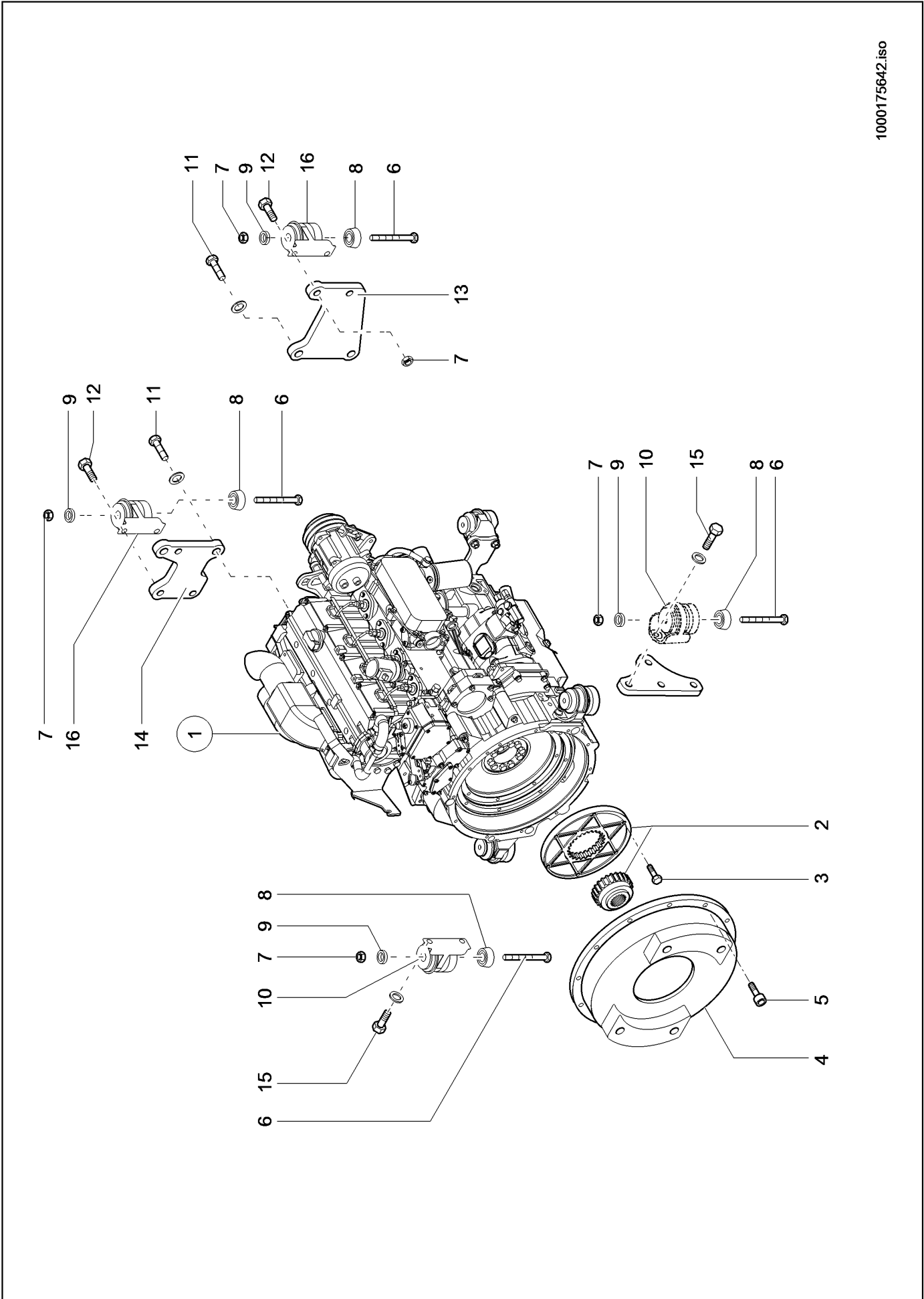

100 ENGINE SUSPENSION 1)

Pos.	Part No.	Description	Dimension	Quantity	Conditions
1	00 1302 286 1	DIESEL ENGINE	TCD 2012 LO4 2V 88 KW/24	1	2)
2	00 1300 828 1	CLUTCH		1	
3	00 0237 874 0	HEXAGON HEAD BOLT	M10X35	8	
4	00 1300 444 0	FLANGE		1	
5	00 0235 495 1	SOCKET HEAD SCREW	M10X 25	12	
6	00 0242 380 0	HEXAGON HEAD BOLT	M12X120	4	
7	00 0238 315 0	HEXAGONAL NUT	M12	4	
8	00 1301 651 0	SPACER PIECE		4	
9	00 1301 652 0	WASHER		4	
10	00 1301 630 0	SHUT OFF PLATE		2	
11	00 0237 573 0	HEXAGON HEAD BOLT	M12X50	2	
12	00 0214 777 0	SOCKET HEAD SCREW	M12X 40	2	
13	00 1300 481 0	BEARING PLATE		1	
14	00 1300 364 0	BEARING PLATE		1	
15	77 0102 992 4	HEXAGON HEAD SCREW		4	
16	00 1301 870 0	STAND		2	
1)	machine no.		+ from 404030108 88 KW		
2)	Remarks		88 KW		

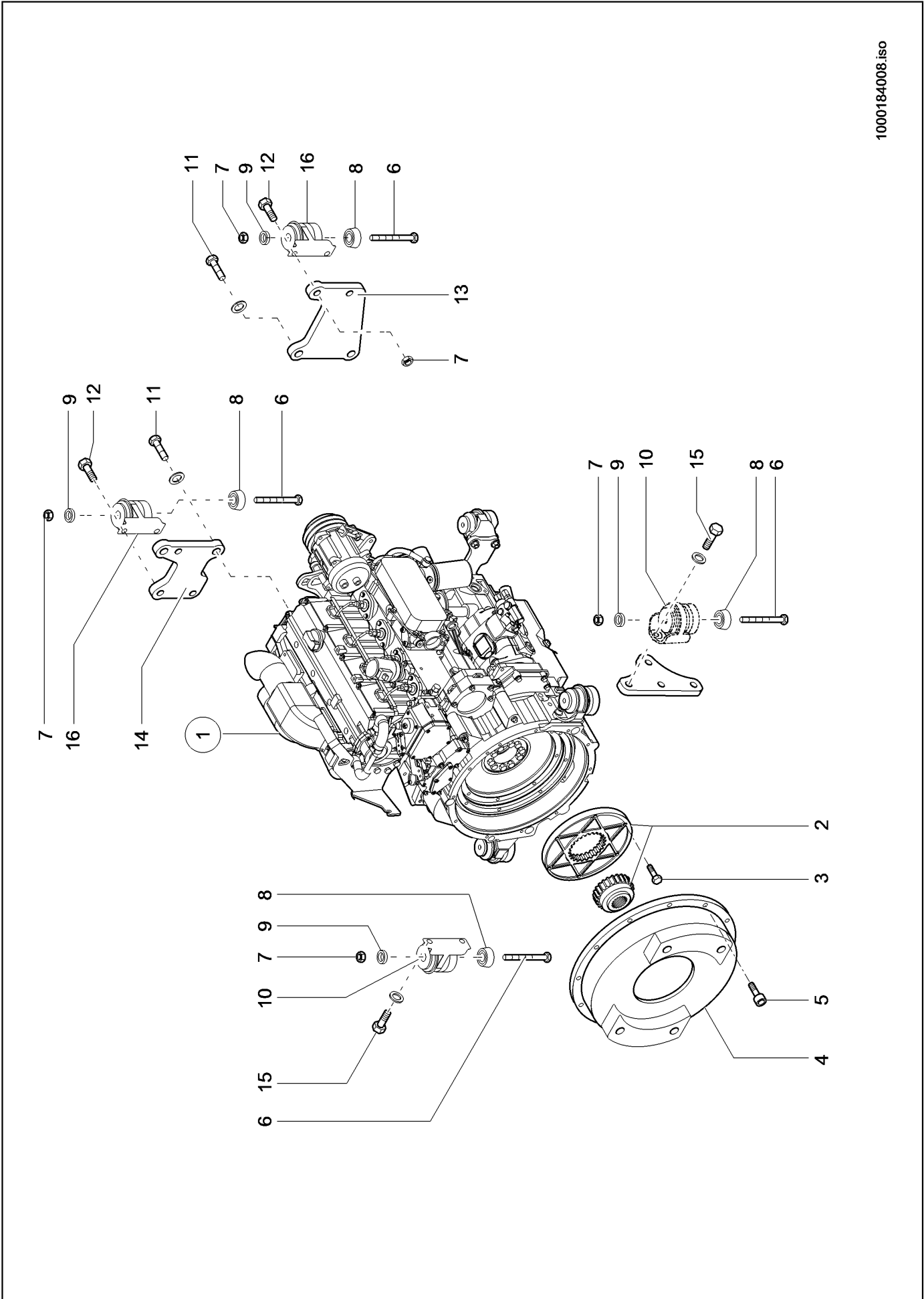

100 ENGINE SUSPENSION 1)

Pos.	Part No.	Description	Dimension	Quantity	Conditions
1	00 1302 287 1	DIESEL ENGINE	TCD 2012 LO4 2V 103 KW/2	1	2)
2	00 1300 828 1	CLUTCH		1	
3	00 0237 874 0	HEXAGON HEAD BOLT	M10X35	8	
4	00 1300 444 0	FLANGE		1	
5	00 0235 495 1	SOCKET HEAD SCREW	M10X 25	12	
6	00 0242 380 0	HEXAGON HEAD BOLT	M12X120	4	
7	00 0238 315 0	HEXAGONAL NUT	M12	4	
8	00 1301 651 0	SPACER PIECE		4	
9	00 1301 652 0	WASHER		4	
10	00 1301 630 0	SHUT OFF PLATE		2	
11	00 0237 573 0	HEXAGON HEAD BOLT	M12X50	2	
12	00 0214 777 0	SOCKET HEAD SCREW	M12X 40	2	
13	00 1300 481 0	BEARING PLATE		1	
14	00 1300 364 0	BEARING PLATE		1	
15	77 0102 992 4	HEXAGON HEAD SCREW		4	
16	00 1301 870 0	STAND		2	
1)	machine no.		+ from 404030108 103 KW		
2)	Remarks		103 KW		

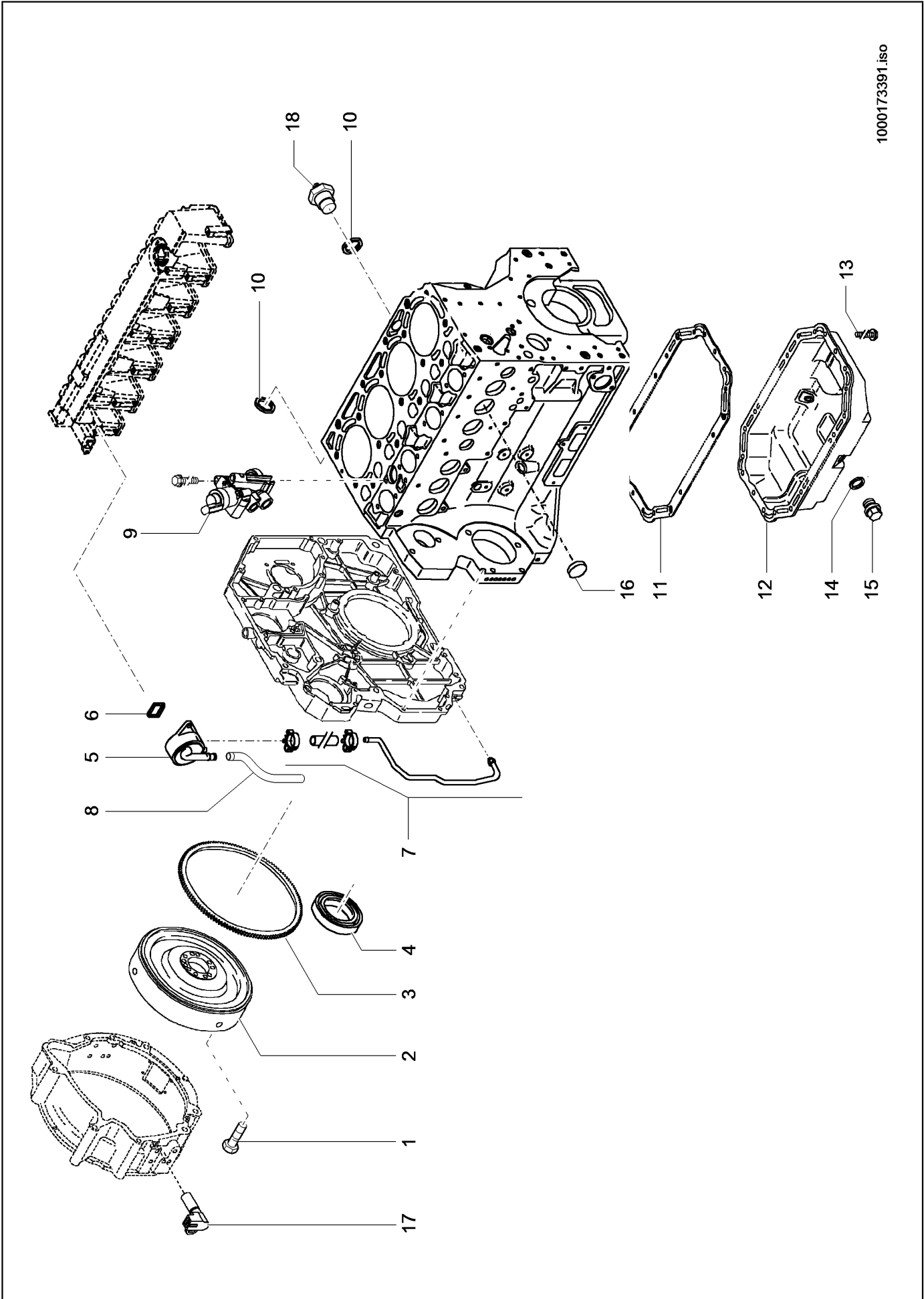

1000173391.iso

100 CRANKCASE 1)

Pos.	Part No.	Description	Dimension	Quantity	Conditions
1	00 1301 721 0	HEXAGON HEAD BOLT	N. Z.	8	
2	00 1301 657 0	FLYWHEEL		1	2)
3	00 1134 889 0	TOOTHED RIM		1	
4	00 1301 663 0	ROTARY SHAFT SEAL		1	
5	00 1302 414 0	BREATHER VALVE		1	
6	00 1302 424 0	GASKET		1	
7	00 1302 425 0	RETURN PIPE		1	
8	00 1302 410 0	HOSE		1	
9	00 1302 445 0	CONTROL BLOCK		1	
10	60 0500 090 3	SEALING RING		2	
11	00 1301 660 0	GASKET		1	
12	00 1301 658 0	OIL SUMP		1	
13	60 0502 649 7	HEXAGON HEAD BOLT	M08X16	22	
14	60 0502 632 1	SEALING RING	18X24-1,34	1	
15	00 1300 046 0	DRAIN COUPLING	ÖL E-A-M18X1,5 - M22X1,5	1	
16	00 1301 654 0	LOCKING COVER	A 45	6	
17	00 1301 656 0	RPM SENSOR		1	
18	00 1302 352 0	TEMP. SWITCH	50 - 150°C	1	
1)	machine no.		+ up to 404030342 103 KW		
2)	Remarks		complete		

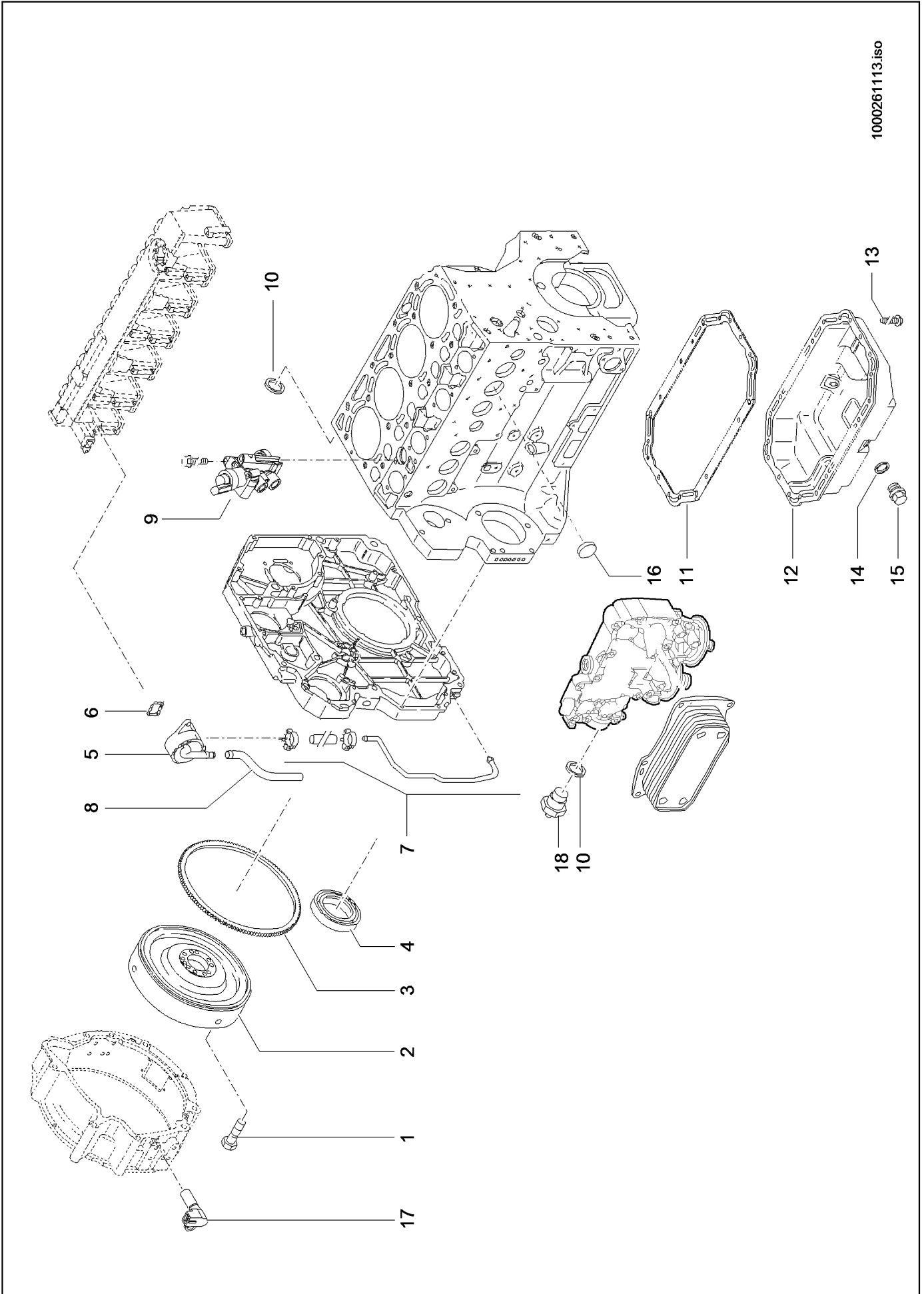

1000261113.iso

100 CRANKCASE 1)

Pos.	Part No.	Description	Dimension	Quantity	Conditions
1	00 1301 721 0	HEXAGON HEAD BOLT	N. Z.	8	
2	00 1301 657 0	FLYWHEEL		1	2)
3	00 1134 889 0	TOOTHED RIM		1	
4	00 1301 663 0	ROTARY SHAFT SEAL		1	
5	00 1302 414 0	BREATHER VALVE		1	
6	00 1302 424 0	GASKET		1	
7	00 1302 425 0	RETURN PIPE		1	
8	00 1302 410 0	HOSE		1	
9	00 1302 445 0	CONTROL BLOCK		1	
10	60 0500 090 3	SEALING RING		2	
11	00 1301 660 0	GASKET		1	
12	00 1301 658 0	OIL SUMP		1	
13	60 0502 649 7	HEXAGON HEAD BOLT	M08X16	22	
14	60 0502 632 1	SEALING RING	18X24-1,34	1	
15	00 1300 046 0	DRAIN COUPLING	ÖL E-A-M18X1,5 - M22X1,5	1	
16	00 1301 654 0	LOCKING COVER	A 45	6	
17	00 1301 656 0	RPM SENSOR		1	
18	00 1303 750 0	TEMPERAT.FEELER		1	
1)	machine no.		+ from 404030343 103 KW		
2)	Remarks		complete		

Thank you so much for reading.
Please click the “Buy Now!”
button below to download the
complete manual.



After you pay.

You can download the most
perfect and complete manual in
the world immediately.

Our support email:

ebooklibonline@outlook.com