



Bobcat®

Service Manual

Three-Point Snow Blower

3SB

(54 Inch) S/N ABCW00101 & Above
(66 Inch) S/N ABCU00101 & Above
(72 Inch) S/N AB4K00101 & Above

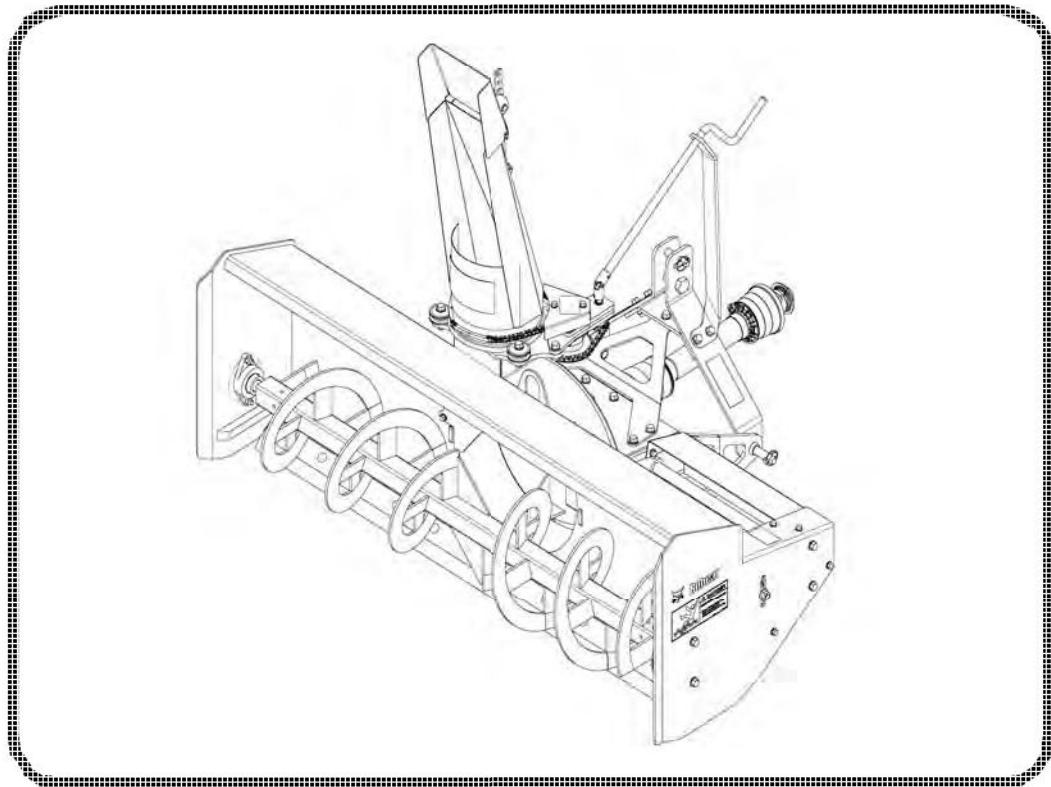

Dealer Copy -- Not for Resale



MAINTENANCE SAFETY









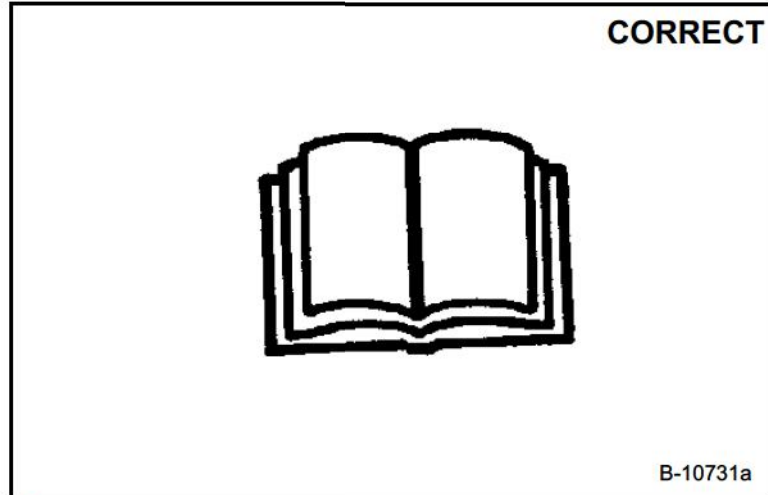

WARNING

Instructions are necessary before operating or servicing machine. Read and understand the Operation & Maintenance Manual, Operator's Handbook and signs (decals) on machine. Follow warnings and instructions in the manuals when making repairs, adjustments or servicing. Check for correct function after adjustments, repairs or service. Untrained operators and failure to follow instructions can cause injury or death. W-2003-0903



Safety Alert Symbol: This symbol with a warning statement, means: "Warning, be alert! Your safety is involved!" Carefully read the message that follows.



-  Never service attachments / implements without instructions. See Operation & Maintenance Manual and Attachment / Implement Service Manual.
-  Cleaning and maintenance are required daily.
-  Never service or adjust attachment / implement with the engine running unless instructed to do so in manual.
-  Always lower the attachment / implement to the ground before lubricating or servicing.
-  Avoid contact with leaking hydraulic fluid or diesel fuel under pressure. It can penetrate skin or eyes.
-  Stop, cool and clean engine of flammable materials before checking fluids.
-  Keep body, loose objects and clothing away from moving parts, electrical contacts, hot parts and exhaust.
-  Safety glasses are needed for eye protection from electrical arcs, battery acid, compressed springs, fluids under pressure and flying debris or when tools are used. Use eye protection approved for type of welding.

ALPHABETICAL INDEX

AUGER	30-10-1
CHAIN DRIVE	30-20-1
CROSS SHAFT	30-90-1
DEFLECTOR	30-40-1
DELIVERY REPORT	III
DISCHARGE CHUTE	30-30-1
FAN	30-40-1
GEARBOX	30-60-1
GEARBOX FLUID CHANGE	10-60-1
HAND CRANK	30-70-1
HYDRAULIC SCHEMATIC	SPEC 10-1
IDENTIFICATION AND MACHINE SIGNS (DECALS)	IV
IMPLEMENT STORAGE AND RETURN TO SERVICE	10-80-1
INSPECTION	10-30-1
LUBRICATING THE IMPLEMENT	10-40-1
REGULAR MAINTENANCE ITEMS	10-50-1
REMOVAL AND INSTALLATION	10-70-1
ROTATOR CHAIN (LOWER CHAIN)	30-81-1
ROTATOR CHAIN (UPPER CHAIN)	30-80-1
ROTATOR MOTOR	20-10-1
SERIAL NUMBER LOCATION	III
SERVICE SCHEDULE	10-20-1
SNOW BLOWER IMPLEMENT SPECIFICATIONS	SPEC 20-1
TROUBLESHOOTING	10-10-1

**ALPHABETICAL
INDEX**

Copy -- Not for Resale

CONTENTS

DELIVERY REPORT..... III
IDENTIFICATION AND MACHINE SIGNS (DECALS) IV
SERIAL NUMBER LOCATION III
PREVENTIVE MAINTENANCE 10-1
HYDRAULIC SYSTEM 20-1
MAIN FRAME 30-1
SPECIFICATIONS AND SCHEMATICS SPEC-1

**PREVENTIVE
MAINTENANCE**

**HYDRAULIC
SYSTEM**

**MAIN
FRAME**

**SPECIFICATIONS
AND
SCHEMATICS**

REFERENCE INFORMATION

Write the correct information for YOUR three-point snow blower in the spaces below. Always use these numbers when referring to your three-point snow blower.

Three-Point Snow Blower Serial Number _____

NOTES:

YOUR BOBCAT® DEALER:

ADDRESS:

PHONE:

Bobcat Company
P.O. Box 128
Gwinner, ND 58040-0128

Bobcat Company Europe
Drève Richelle 167
B-1410 WATERLOO
Belgium

Dealer Copy -- Not for Resale

SERIAL NUMBER LOCATION

Figure 1

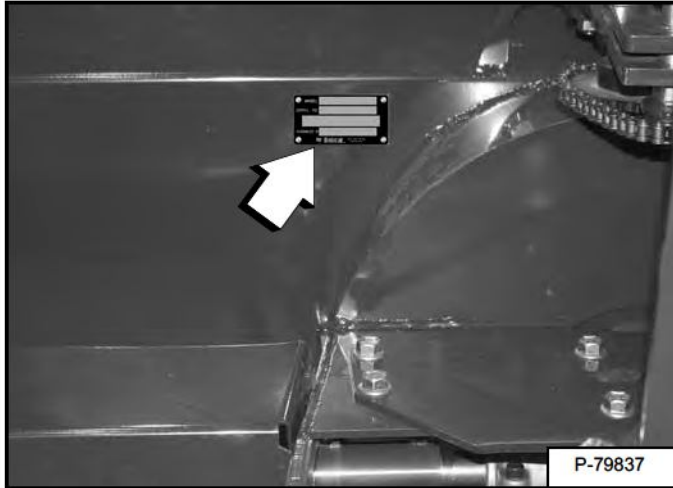

Always use the serial number of the three-point snow blower when requesting service information or when ordering parts. Early or later models (identification made by serial number) may use different parts, or it may be necessary to use a different procedure in doing a specific service operation [Figure 1].

DELIVERY REPORT

Figure 2

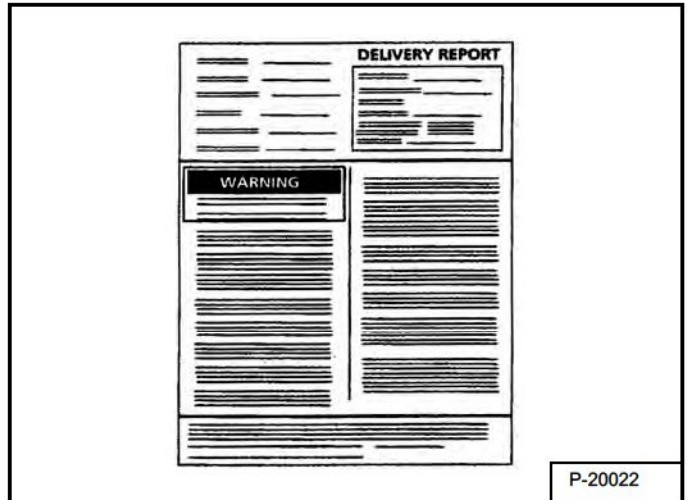

The delivery report must be filled out by the dealer and signed by the owner or operator when the three-point snow blower is delivered. An explanation of the form must be given to the owner. Make sure it is filled out completely [Figure 2].

Dealer Copy -- Not for Resale

IDENTIFICATION AND MACHINE SIGNS (DECALS)

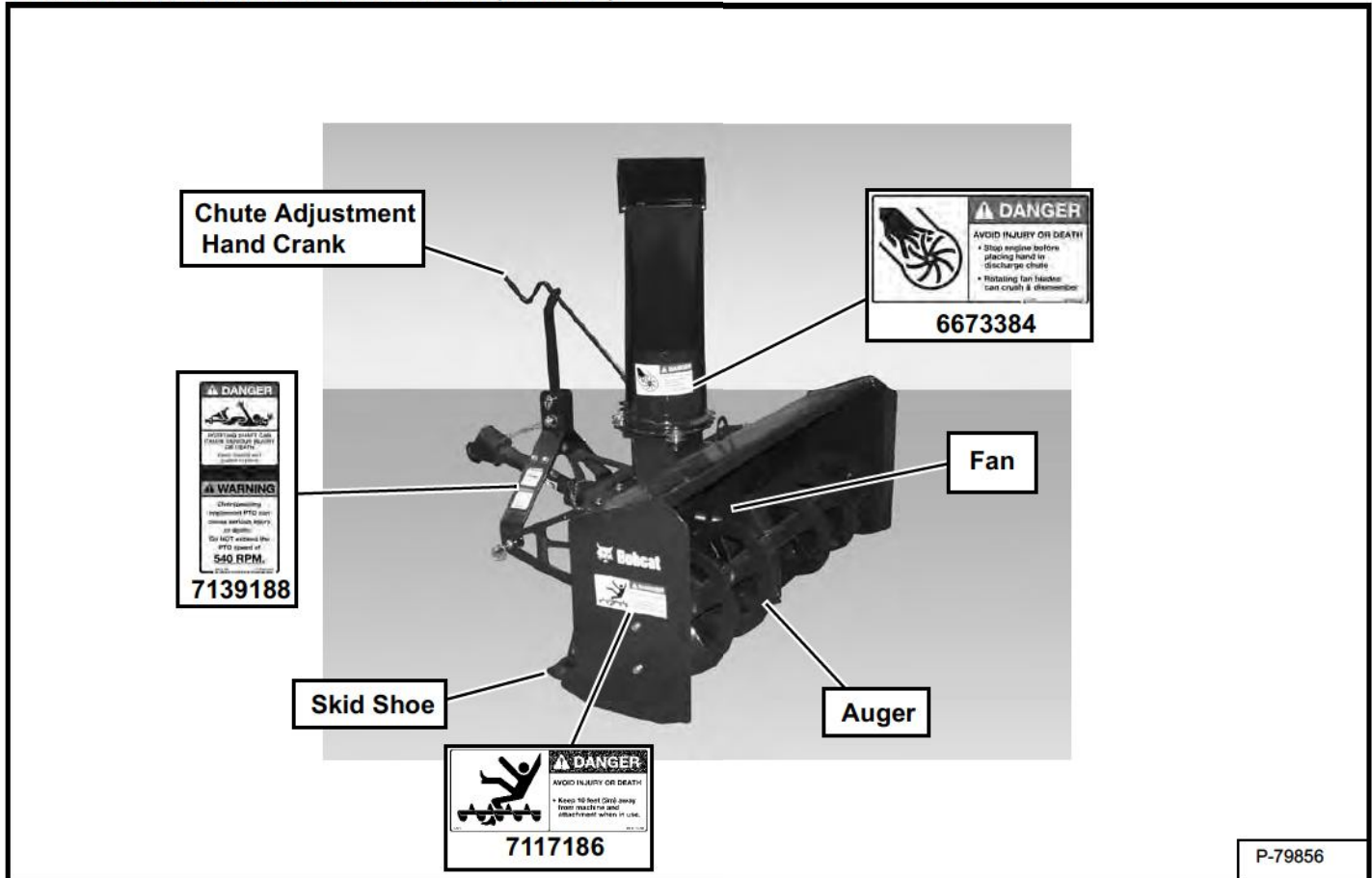

P-79856

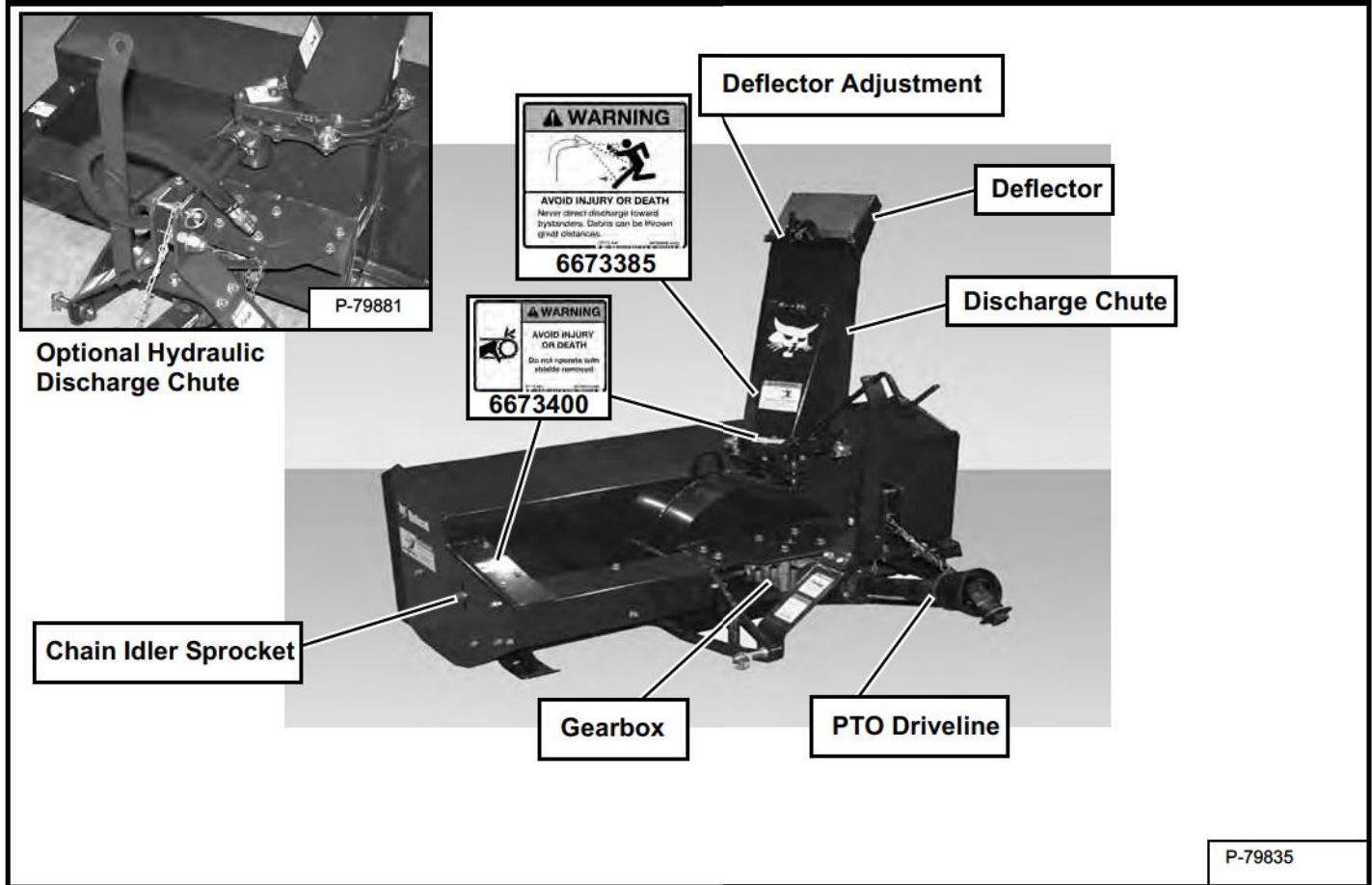

P-79835

Dealer Copy -- Not for Resale

PREVENTIVE MAINTENANCE

PREVENTIVE MAINTENANCE

GEARBOX FLUID CHANGE	10-60-1
Three-point Snow Blower (All Models).	10-60-1
IMPLEMENT STORAGE AND RETURN TO SERVICE	10-80-1
Return to Service	10-80-1
Storage	10-80-1
INSPECTION	10-30-1
Implement Mounting Frame	10-30-1
Three-Point Hitch	10-30-1
LUBRICATING THE IMPLEMENT	10-40-1
Lubrication Locations	10-40-1
REGULAR MAINTENANCE ITEMS	10-50-1
Chain Tightness	10-50-2
Cleaning The Three-Point Snow Blower	10-50-3
Cutting Edge	10-50-1
Gearbox Fluid	10-50-2
Skid Shoes	10-50-1
REMOVAL AND INSTALLATION	10-70-1
Cutting Edge Replacement	10-70-1
Skid Shoe Replacement	10-70-1
SERVICE SCHEDULE	10-20-1
Description	10-20-1
TROUBLESHOOTING	10-10-1
Chart	10-10-1

Dealer Copy -- Not for Resale

Buy Now



Our support email:

ebooklibonline@outlook.com