



# Bobcat®

## Concrete Mixer

# Service Manual

S/N 678500101 & Above

S/N A01600101 & Above

Dealer Copy -- Not for Resale

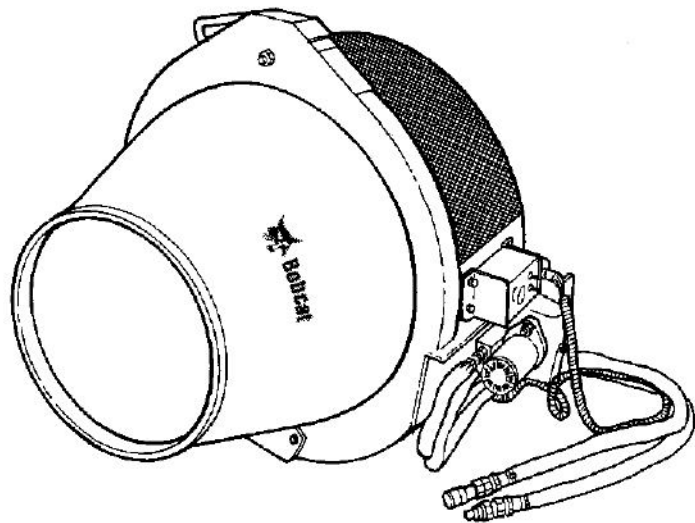

*Doosan purchased Bobcat Company from Ingersoll-Rand Company in 2007. Any reference to Ingersoll-Rand Company or use of trademarks, service marks, logos, or other proprietary identifying marks belonging to Ingersoll-Rand Company in this manual is historical or nominative in nature, and is not meant to suggest a current affiliation between Ingersoll-Rand Company and Bobcat Company or the products of either.*

# MAINTENANCE SAFETY



## WARNING







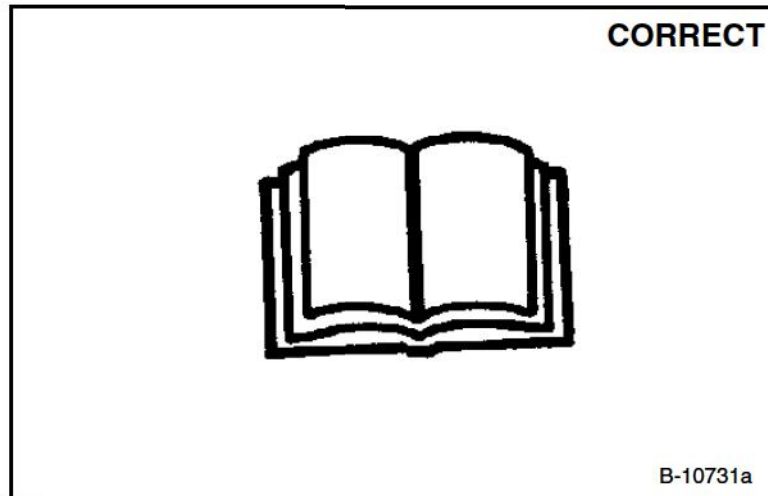

Instructions are necessary before operating or servicing machine. Read and understand the Operation & Maintenance Manual, Operator's Handbook and signs (decals) on machine. Follow warnings and instructions in the manuals when making repairs, adjustments or servicing. Check for correct function after adjustments, repairs or service. Untrained operators and failure to follow instructions can cause injury or death.

W-2003-0903



**Safety Alert Symbol:** This symbol with a warning statement, means: "Warning, be alert! Your safety is involved!" Carefully read the message that follows.



-  Never service attachments without instructions. See Operation & Maintenance Manual and Attachment Service Manual.
-  Cleaning and maintenance are required daily.
-  Never service or adjust attachment with the engine running unless instructed to do so in manual.
-  Always lower the attachment to the ground before lubricating or servicing.
-  Avoid contact with leaking hydraulic fluid or diesel fuel under pressure. It can penetrate skin or eyes.
-  Stop, cool and clean engine of flammable materials before checking fluids.
-  Keep body, loose objects and clothing away from moving parts, electrical contacts, hot parts and exhaust.
-  Safety glasses are needed for eye protection from electrical arcs, battery acid, compressed springs, fluids under pressure and flying debris or when tools are used. Use eye protection approved for type of welding.

## ALPHABETICAL INDEX

ATTACHMENT DELIVERY REPORT .....	III
BEARING .....	30-10-1
CONCRETE MIXER ELECTRICAL SCHEMATIC .....	SPEC-40-1
DRUM ROLLER .....	30-20-1
GLOSSARY OF HYDRAULIC SYMBOLS FOR ATTACHMENTS .....	SPEC-20-1
GREASE SEAL .....	30-30-1
HYDRAULIC CONTROL VALVE .....	20-20-1
HYDRAULIC MOTOR .....	20-10-1
HYDRAULIC SCHEMATIC .....	SPEC-30-1
IDENTIFICATION .....	IV
INNER DRUM .....	30-40-1
INSPECTION .....	10-30-1
LOADER REMOTE ATTACHMENT CONTROL ELECTRICAL SCHEMATIC .....	SPEC-50-1
LUBRICATION .....	10-20-1
MIXING DRUM DRIVE CHAIN .....	30-50-1
MIXING DRUM DRIVE SPROCKET .....	30-60-1
MIXING PADDLES .....	30-70-1
REMOTE ATTACHMENT CONTROL .....	40-10-1
SHAFT MOUNT .....	30-80-1
SPECIFICATIONS .....	SPEC-10-1
TROUBLESHOOTING .....	10-10-1

Dealer Copy -- Not for Resale

## CONTENTS

ATTACHMENT DELIVERY REPORT .....	III
IDENTIFICATION AND MACHINE SIGNS (DECALS) .....	IV
SERIAL NUMBER LOCATION .....	III
SAFETY AND MAINTENANCE.....	10-01
HYDRAULIC SYSTEM .....	20-01
MAIN FRAME .....	30-01
ELECTRICAL SYSTEM .....	40-01
SPECIFICATIONS AND SCHEMATICS .....	SPEC-01

**SAFETY AND  
MAINTENANCE**

**HYDRAULIC  
SYSTEM**

**MAIN  
FRAME**

**ELECTRICAL  
SYSTEM**

**SPECIFICATIONS  
AND  
SCHEMATICS**

**CALIFORNIA  
PROPOSITION 65 WARNING**

Diesel engine exhaust and some of its constituents are known to the State of California to cause cancer, birth defects and other reproductive harm.

Dealer Copy -- Not for Resa

## SERIAL NUMBER LOCATION

Figure 1

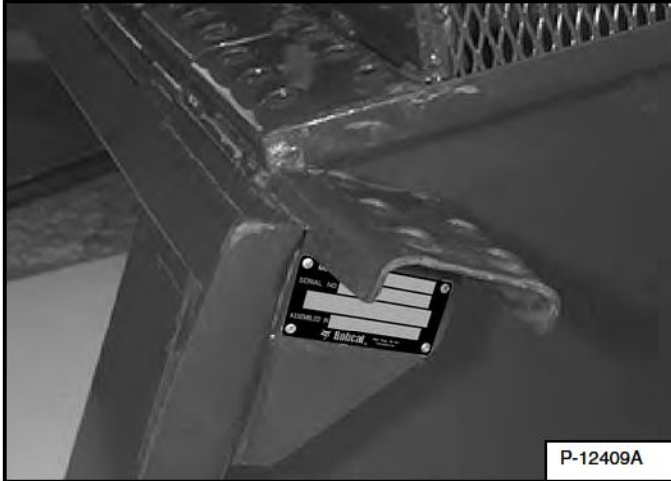

Always use the serial number of the Concrete Mixer when requesting service information or when ordering parts. Early or later models (identification made by serial number) may use different parts, or it may be necessary to use a different procedure in doing a specific service operation [Figure 1].

## ATTACHMENT DELIVERY REPORT

Figure 2

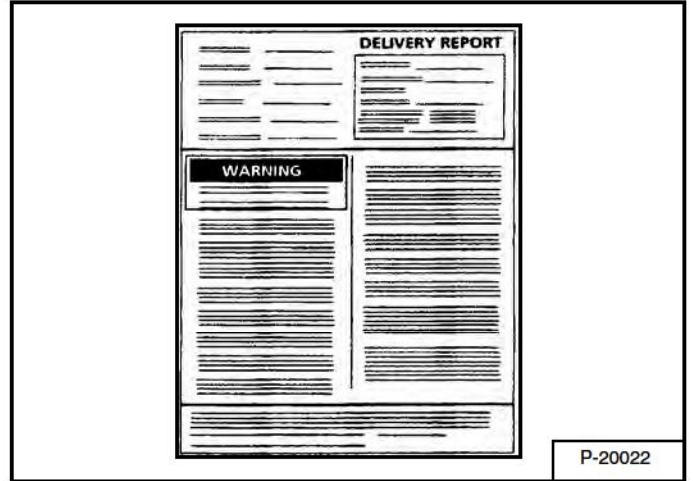

The Attachment Delivery Report must be filled out by the dealer and signed by the owner or operator when the Concrete Mixer is delivered. An explanation of the form must be given to the owner. Make sure it is filled out completely [Figure 2].

Dealer Copy -- Not for Resale

**IDENTIFICATION AND MACHINE SIGNS (DECALS)**

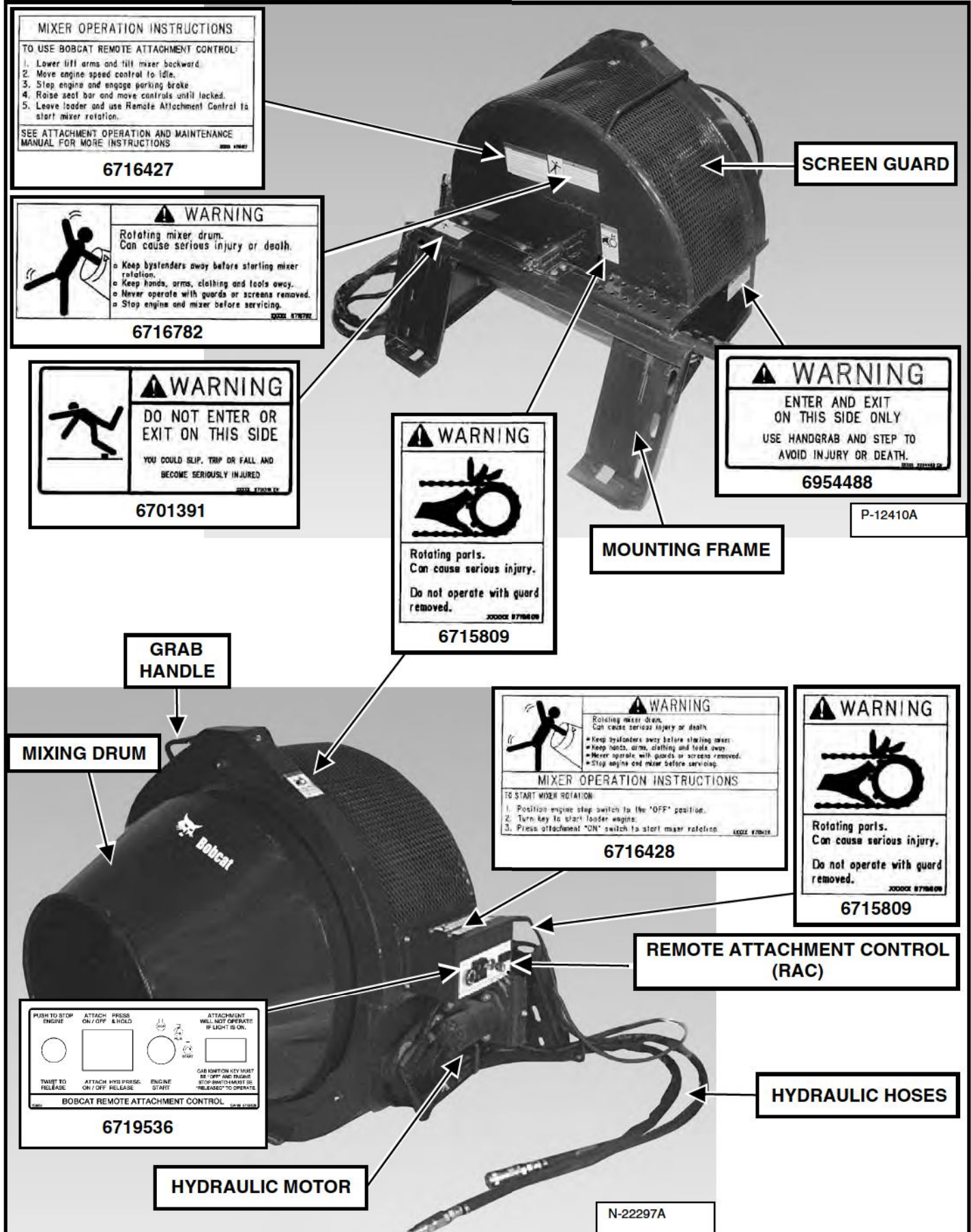

Dealer Copy -- Not for Resale

## SAFETY AND MAINTENANCE

## SAFETY AND MAINTENANCE

LUBRICATION .....	10-20-1
INSPECTION .....	10-30-1
Concrete Mixer Mount Inspection .....	10-30-3
Hand Lever Bob-Tach Inspection .....	10-30-1
Power Bob-Tach Inspection .....	10-30-2
TROUBLESHOOTING .....	10-10-1

Dealer Copy -- Not for Resale

## TROUBLESHOOTING

PROBLEM	CAUSE	CORRECTION
Concrete Mixer does not seat properly on the Bob-Tach.	Bob-Tach pins are not fully retracted prior to installation.	Retract Bob-Tach pins before installing.
	Mud, dirt or stones are lodged between the Bob-Tach and the Concrete Mixer.	Remove debris between Bob-Tach and Concrete Mixer.
Loader will not start with Concrete Mixer removed.	Connector not installed on remote attachment control harness on the loader lift arm.	Install connector on wire harness.
Loader will not start with loader key switch with Attachment installed.	Engine stop switch on Remote Attachment Control engaged.	Turn the engine stop switch clockwise to reset the switch.
	Key switch on Remote Attachment Control in the run position.	Turn the key switch to the OFF position.
Loader will not start with the Remote Attachment Control key switch.	Engine stop switch on Remote Attachment Control engaged.	Turn the engine stop switch clockwise to reset the switch.
	Loader key switch in the run position.	Turn the loader key switch to the OFF position.
Mixer Drum does not turn.	No hydraulic flow.	Check quick couplers connection. Check for damaged hose ends and fittings. Engage loader front auxiliary hydraulics.
	Incorrect chain adjustment.	Adjust drive chain.
	Damaged sprockets and/or drive chain.	Repair or replace sprockets and drive chain.
Mixer Drum vibrates excessively.	Concrete Mixer not correctly attached to Bob-Tach.	Check for correct mounting of the Concrete Mixer to the Bob-Tach.
	Drum rollers worn.	Replace drum rollers.
	Rear shaft bent.	Replace shaft.
	Rear shaft bearing is worn or damaged.	Replace rear shaft bearing.

Dealer Copy -- Not for Resale



## LUBRICATION

Always use a good quality lithium base grease when lubricating the Concrete Mixer. Apply the lubricant until extra grease shows.

# IMPORTANT

Fluid such as engine oil, hydraulic fluid, coolants, etc. must be disposed of in an environmentally safe manner. Some regulations require that certain spills and leaks on the ground must be cleaned in a specific manner. See local, state and federal regulations for the correct disposal.

I-2067-0395

Lubricate the following grease fittings. **EVERY 8-10 HOURS:**



Figure 10-20-1

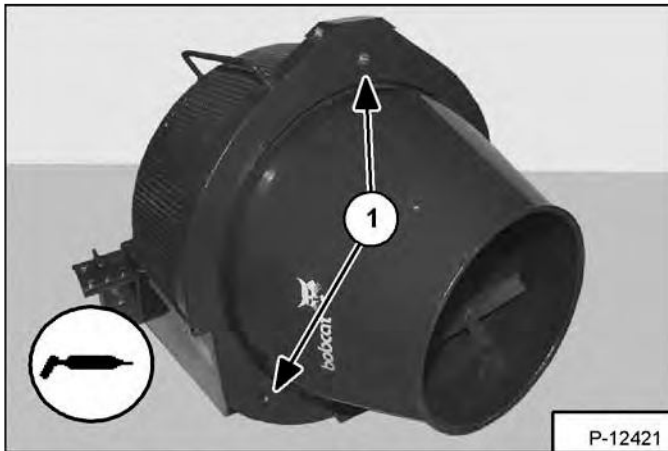
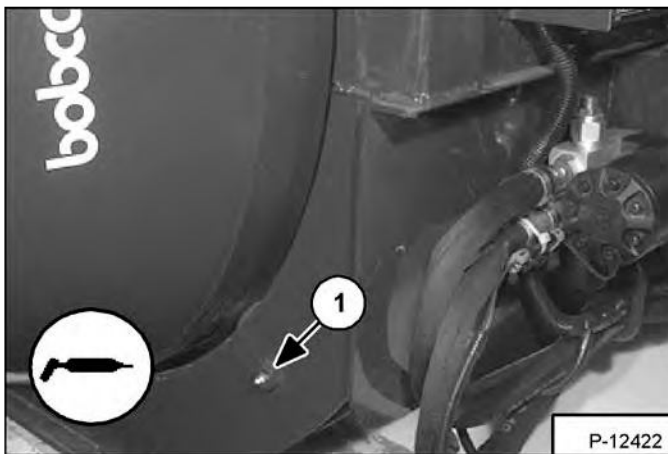

Figure 10-20-2



Drum wheels (3) (Item 1) [Figure 10-20-1] & [Figure 10-20-2].

Lubricate the following grease fitting.

**EVERY 50 HOURS:**



Figure 10-20-3

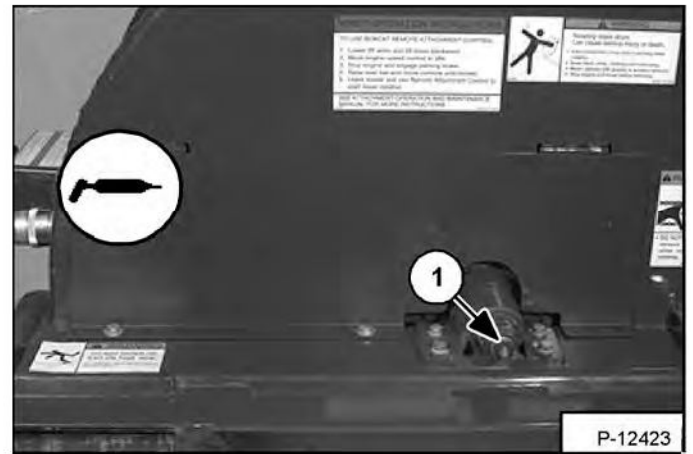

Rear drum spindle (Item 1) [Figure 10-20-3].

Dealer Copy -- Not for Resale

## INSPECTION

### Hand Lever Bob-Tach Inspection



Bob-Tach wedges must extend through the holes in attachment. Lever(s) must be fully down and locked. Failure to secure wedges can allow attachment to come off and cause injury or death.

W-2102-0497

Figure 10-30-1

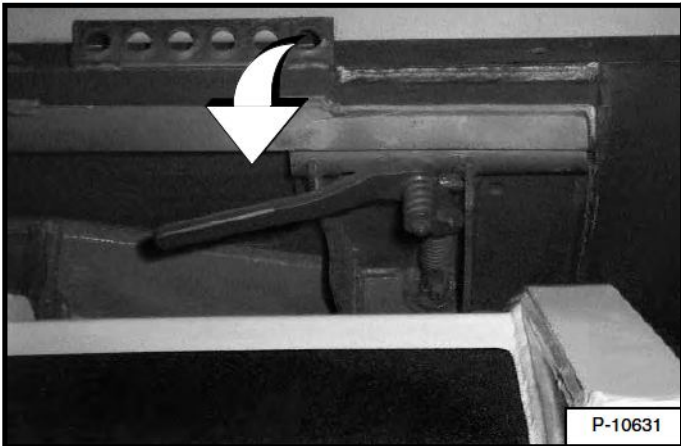

Move the Bob-Tach levers down to engage the wedges [Figure 10-30-1].

The levers and wedges must move freely.

Figure 10-30-2

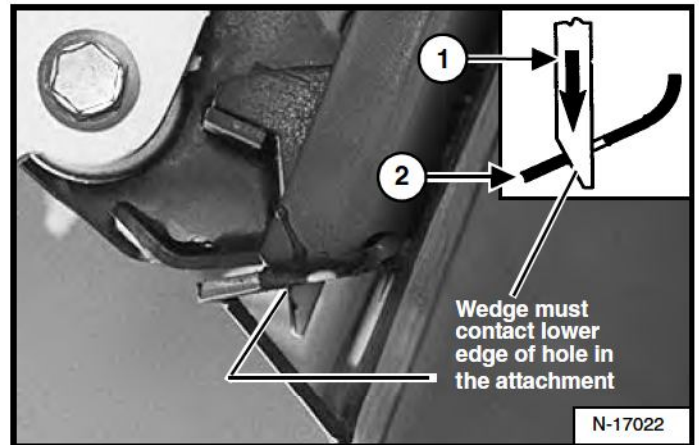

The wedges must extend through the holes in the attachment mounting frame (Item 2) [Figure 10-30-2].

The spring loaded wedge (Item 1) must contact the lower edge of the hole in the attachment (Item 2) [Figure 10-30-2].

If the wedge does not contact the lower edge of the hole the attachment will be loose and can come off the Bob-Tach.

Figure 10-30-3

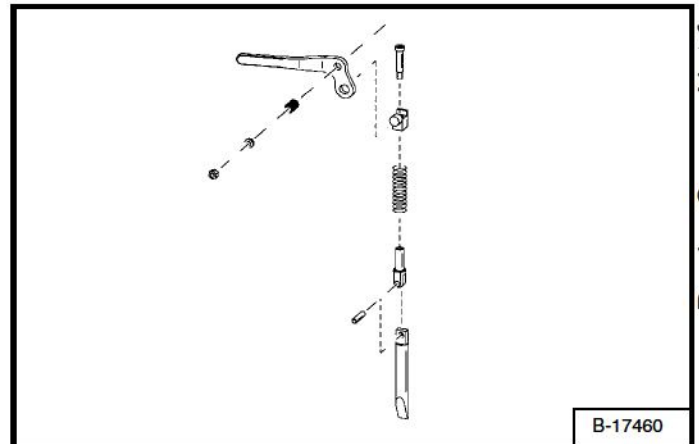

Inspect the mounting frame on the attachment and the Bob-Tach, linkages and wedges for excessive wear or damage [Figure 10-30-3].

Replace any parts that are damaged, bent, or missing.

Keep all fasteners tight.

Look for cracked welds. Contact your Bobcat dealer for repair or replacement parts.

Lubricate the wedges. (See the correct Loader Operation & Maintenance Manual for *LUBRICATION OF THE BOBCAT MACHINE.*)

Dealer Copy -- Not for Resale

## INSPECTION (CONT'D)

### Power Bob-Tach Inspection

# ! WARNING

Bob-Tach wedges must extend through the holes in attachment. Lever(s) must be fully down and locked. Failure to secure wedges can allow attachment to come off and cause injury or death.

W-2102-0497

Figure 10-30-4

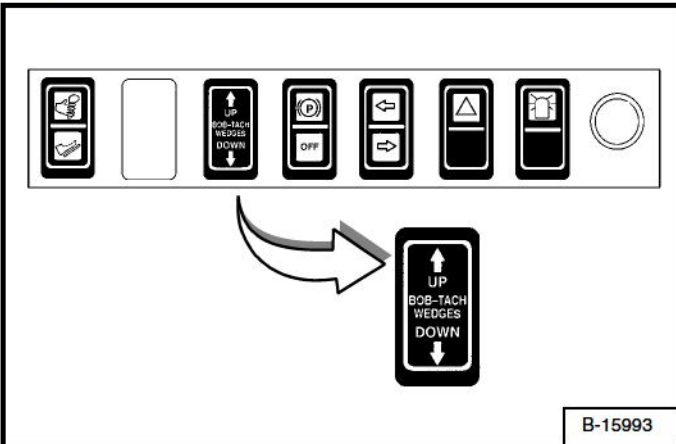

Push and hold the *BOB-TACH WEDGES UP* switch until wedges are fully raised. Push and hold the *BOB-TACH WEDGES DOWN* switch until the wedges are fully down [Figure 10-30-4].

The wedges must move freely.

**NOTE:** The Power Bob-Tach system has continuous pressurized oil to keep the wedges in the engaged position and prevent attachment disengagement. Because the wedges can slowly lower, the operator may need to reactivate the switch (*WEDGES UP*) before installing an attachment to be sure both wedges are fully raised before installing the attachment.

Figure 10-30-5

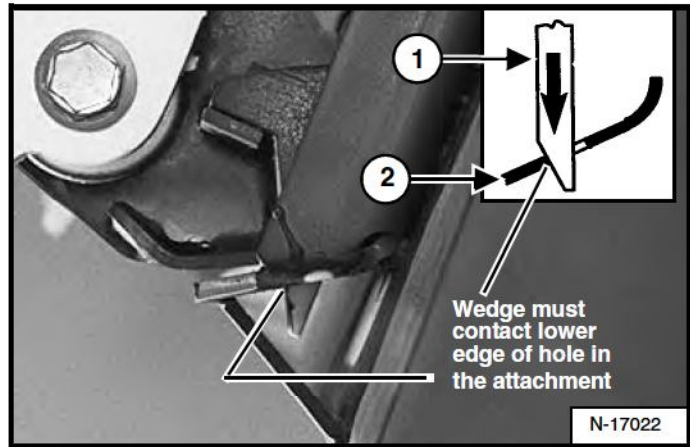

The wedges must extend through the holes in the attachment mounting frame (Item 2) [Figure 10-30-5].

The spring loaded wedge (Item 1) must contact the lower edge of the hole in the attachment (Item 2) [Figure 10-30-5].

If the wedge does not contact the lower edge of the hole the attachment will be loose and can come off the Bob-Tach [Figure 10-30-5].

Figure 10-30-6

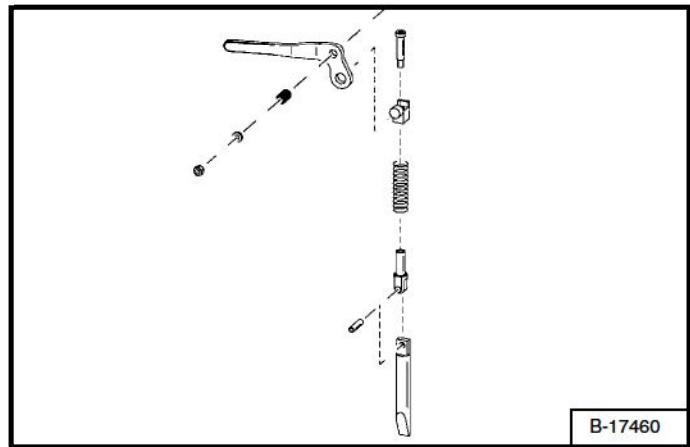

Inspect the mounting frame on the attachment and the Bob-Tach, linkages and wedges for excessive wear or damage [Figure 10-30-6].

Replace any parts that are damaged, bent, or missing. Keep all fasteners tight.

Inspect the hoses and fittings for leaks.

Look for cracked welds. Contact your Bobcat dealer for repair or replacement parts.

Lubricate the wedges. (See the correct loader Operation & Maintenance Manual for *LUBRICATION OF THE BOBCAT LOADER*.)

Dealer Copy -- Not for Resale

## INSPECTION (CONT'D)

### Concrete Mixer Mount Inspection

Figure 10-30-7

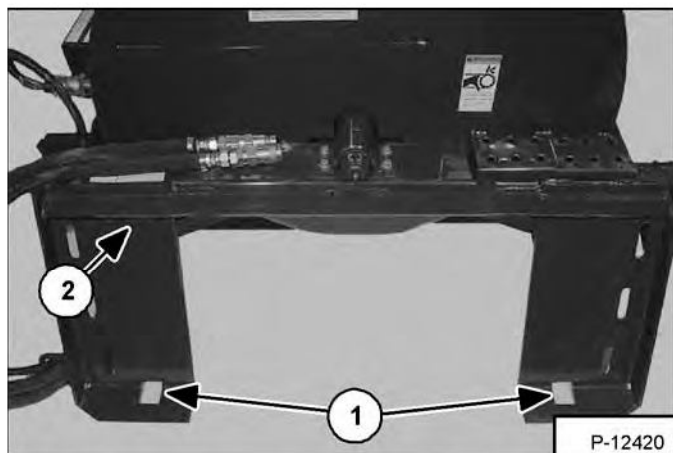

Inspect the Bob-Tach wedge mounts (Item 1), mounting flange (Item 2) and all welds on the Concrete Mixer mount for wear and damage each time the Concrete Mixer is removed from the loader [Figure 10-30-7].

**Buy Now**



Our support email:

[ebooklibonline@outlook.com](mailto:ebooklibonline@outlook.com)