



# Bobcat®

## Dozer 96 Inch

# Service Manual

(96 Inch) S/N 224400101 & Above

Dealer Copy -- Not for Resale

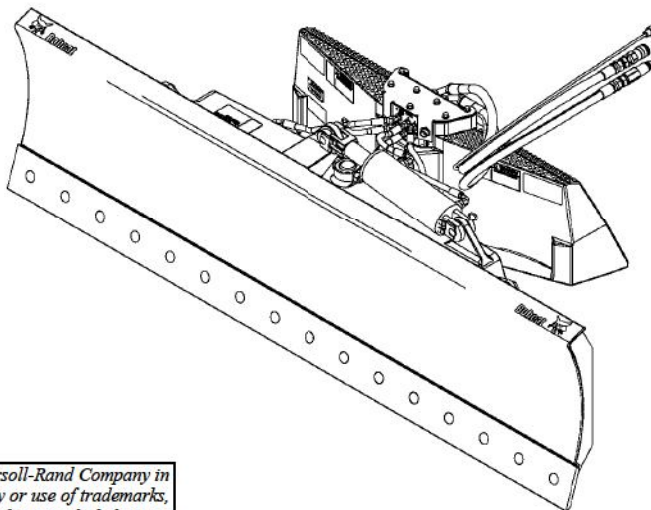

*Doosan purchased Bobcat Company from Ingersoll-Rand Company in 2007. Any reference to Ingersoll-Rand Company or use of trademarks, service marks, logos, or other proprietary identifying marks belonging to Ingersoll-Rand Company in this manual is historical or nominative in nature, and is not meant to suggest a current affiliation between Ingersoll-Rand Company and Bobcat Company or the products of either.*

## ALPHABETICAL INDEX

ACD (ATTACHMENT CONTROL DEVICE) .....	30-10-1
ATTACHMENT DELIVERY REPORT .....	III
CUTTING EDGE .....	30-40-1
ELECTRICAL SCHEMATIC-7 PIN CONNECTOR .....	SPEC-20-1
ELECTRICAL SCHEMATIC-7 PIN CONNECTOR WITH 14 PIN ADAPTER HARNESS .....	SPEC-20-1
HYDRAULIC CONTROL VALVE .....	20-10-1
HYDRAULIC CYLINDER .....	20-20-1
HYDRAULIC SCHEMATIC .....	SPEC-30-1
INSPECTION .....	10-20-1
IDENTIFICATION .....	IV
MOLDBOARD .....	30-20-1
MOUNTING FRAME AND ROTATING SECTION .....	30-30-1
LUBRICATION .....	10-40-1
SERIAL NUMBER LOCATION .....	III
SPECIFICATIONS .....	SPEC-10-1
TROUBLESHOOTING .....	10-10-1

Dealer Copy -- Not for Resale

## CONTENTS

ATTACHMENT DELIVERY REPORT .....	III
IDENTIFICATION AND MACHINE SIGNS (DECALS) .....	IV
SERIAL NUMBER LOCATION .....	III
SAFETY AND MAINTENANCE.....	10-01
HYDRAULIC SYSTEM .....	20-01
MAIN FRAME .....	30-01
SPECIFICATIONS AND SCHEMATICS .....	SPEC-01

**SAFETY AND  
MAINTENANCE**

**HYDRAULIC  
SYSTEM**

**MAIN  
FRAME**

**SPECIFICATIONS  
AND  
SCHEMATICS**

### **CALIFORNIA**

#### **PROPOSITION 65 WARNING**

Diesel engine exhaust and some of its constituents are known to the State of California to cause cancer, birth defects and other reproductive harm.

Dealer Copy -- Not for Resale

## SERIAL NUMBER LOCATION

Figure 1

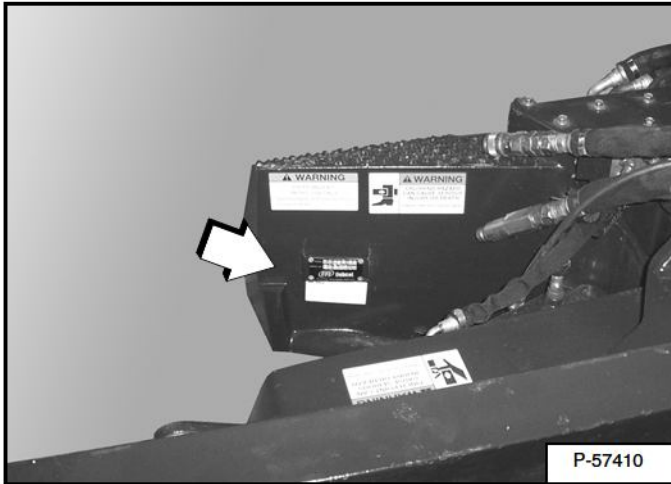

Always use the serial number of the Dozer when requesting service information or when ordering parts. Early or later models (identification made by serial number) may use different parts, or it may be necessary to use a different procedure in doing a specific service operation [Figure 1].

## ATTACHMENT DELIVERY REPORT

Figure 2

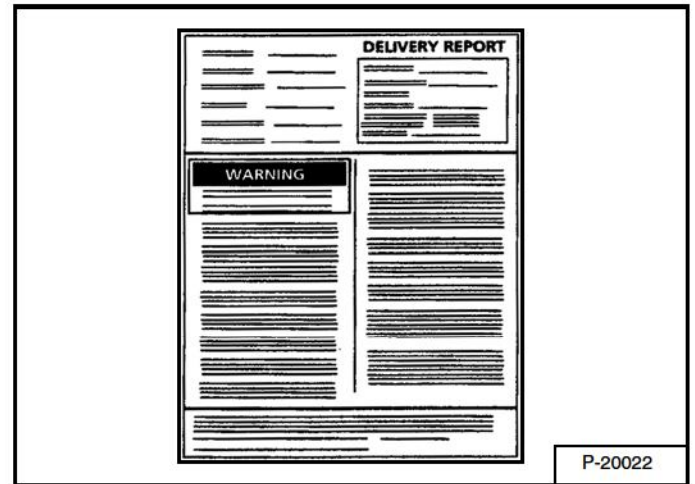

The Attachment Delivery Report must be filled out by the dealer and signed by the owner or operator when the Dozer is delivered. An explanation of the form must be given to the owner. Make sure it is filled out completely [Figure 2].

Dealer Copy -- Not for Resale

**IDENTIFICATION AND MACHINE SIGNS (DECALS)**

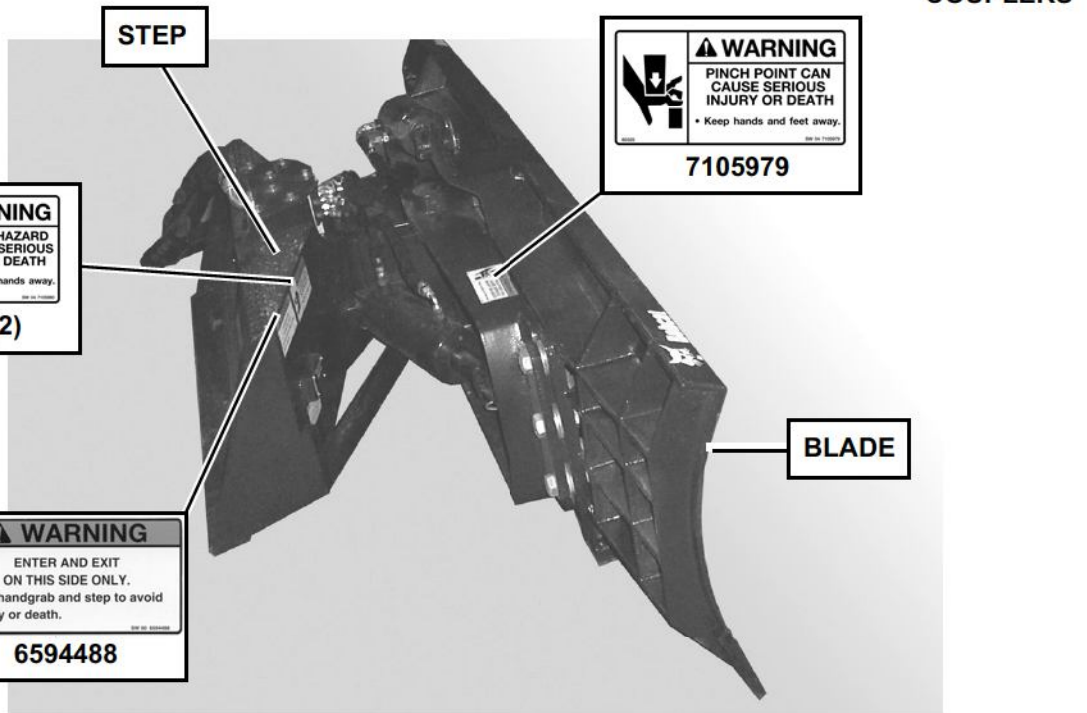
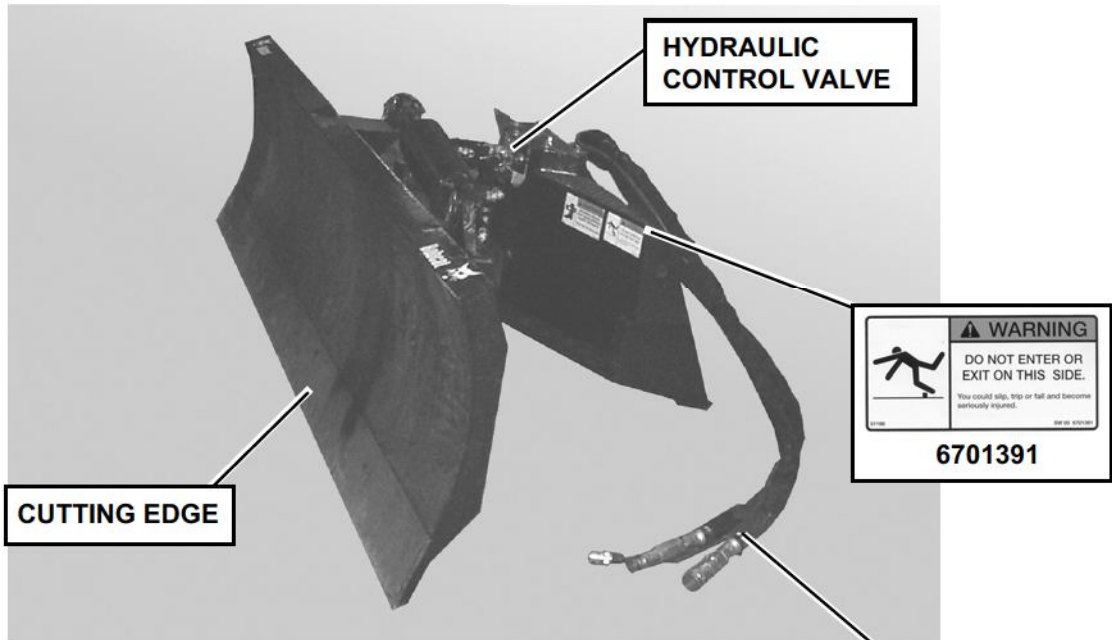

P-57411  
P-57412

Dealer Copy -- Not for Resale



## SAFETY AND MAINTENANCE

## SAFETY AND MAINTENANCE

TROUBLESHOOTING .....	10-10-1
INSPECTION .....	10-20-1
Cutting Edge Inspection.....	10-20-3
Dozer Mount Inspection.....	10-20-3
Hand Lever Bob-Tach Inspection.....	10-30-1
Power Bob-Tach Inspection.....	10-20-2

Dealer Copy -- Not for Resale

## TROUBLESHOOTING

PROBLEM	CAUSE	CORRECTION
Dozer does not mount properly on the Bob-Tach.	Bob-Tach wedges are not fully retracted before installation.	Retract Bob-Tach wedges before installation.
	Mud, dirt or stones are lodged between the Bob-Tach and the Dozer mount.	Remove debris between Bob-Tach and Dozer mount.
Dozer does not rotate or oscillate.	No hydraulic flow.	Activate loader front auxiliary hydraulics.
		Check quick couplers connection. Check for damaged hose ends and fittings.
	Electrical harness not installed.	Install electrical harness from the Dozer to the loader.
	No electrical current flow through harness.	Check Dozer electrical harness for damage to connector or harness.

Dealer Copy -- Not for Resale

## INSPECTION

### Hand Lever Bob-Tach Inspection

 **WARNING**

**Bob-Tach wedges must extend through the holes in attachment. Lever(s) must be fully down and locked. Failure to secure wedges can allow attachment to come off and cause injury or death.**

W-2102-0497

Figure 10-20-1

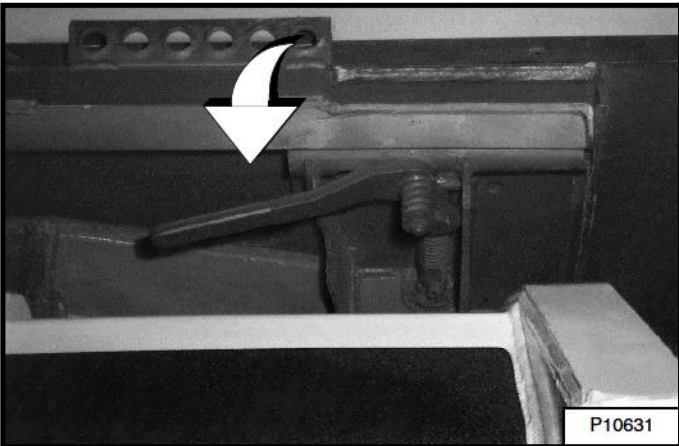

Move the Bob-Tach levers down to engage the wedges [Figure 10-20-1]. The levers and wedges must move freely.

Figure 10-20-2

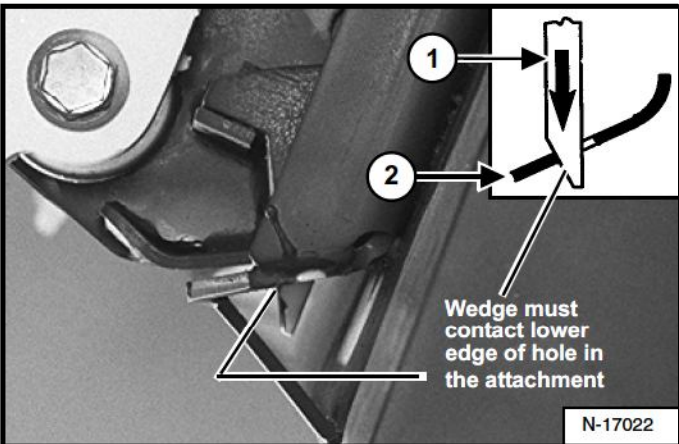

The wedges must extend through the holes in the attachment mounting frame (Item 2) [Figure 10-20-2].

The spring loaded wedge (Item 1) must contact the lower edge of the hole in the attachment (Item 2) [Figure 10-20-2].

If the wedge does not contact the lower edge of the hole the attachment will be loose and can come off the Bob-Tach.

Figure 10-20-3

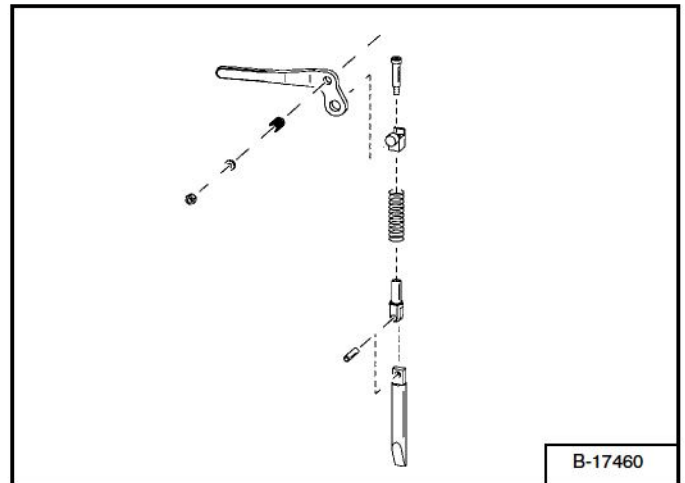

Inspect the mounting frame on the attachment and the Bob-Tach, linkages and wedges for excessive wear or damage. Replace any parts that are damaged, bent, or missing [Figure 10-20-3]. Keep all fasteners tight.

Look for cracked welds. Contact your Bobcat dealer for repair or replacement parts.

Lubricate the wedges. (See the correct Loader Operation & Maintenance Manual for *LUBRICATION OF THE BOBCAT MACHINE.*)

Dealer Copy -- Not for Resale



## INSPECTION (CONT'D)

### Power Bob-Tach Inspection

# WARNING

Bob-Tach wedges must extend through the holes in attachment. Lever(s) must be fully down and locked. Failure to secure wedges can allow attachment to come off and cause injury or death.

W-2102-0497

Figure 10-20-4

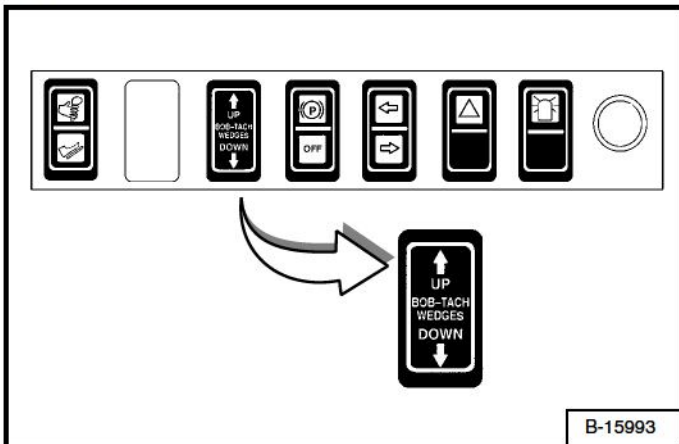

B-15993

**NOTE:** The Power Bob-Tach system has continuous pressurized hydraulic oil to keep the wedges in the engaged position and prevent attachment disengagement. Because the wedges can slowly lower, the operator may need to reactivate the switch (BOB-TACH WEDGES UP) to be sure both wedges are fully raised before installing the attachment.

Push and hold the BOB-TACH WEDGES UP switch until wedges are fully raised. Push and hold the BOB-TACH WEDGES DOWN switch until [Figure 10-20-4] the wedges are fully down.

The wedges must move freely.

Figure 10-20-5

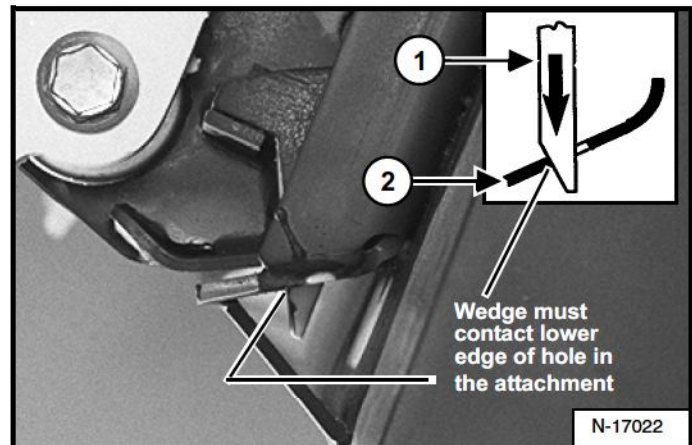

The wedges must extend through the holes in the attachment mounting frame (Item 2) [Figure 10-20-5].

The spring loaded wedge (Item 1) must contact the lower edge of the hole in the attachment (Item 2) [Figure 10-20-5].

If the wedge does not contact the lower edge of the hole [Figure 10-20-5] the attachment will be loose and can come off the Bob-Tach.

Figure 10-20-6

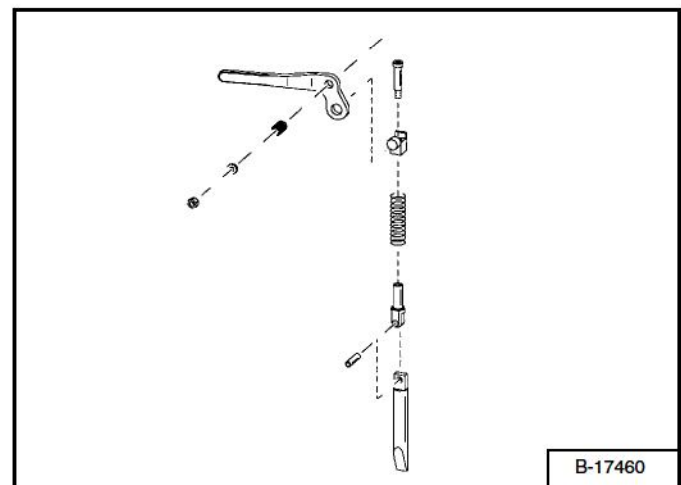

Inspect the mounting frame on the attachment and the Bob-Tach, linkages and wedges for excessive wear or damage [Figure 10-20-6].

Replace any parts that are damaged, bent, or missing. Keep all fasteners tight. Inspect the hoses and fittings for leaks.

Look for cracked welds. Contact your Bobcat dealer for repair or replacement parts.

Lubricate the wedges. (See the correct loader Operation & Maintenance Manual for *LUBRICATION OF THE BOBCAT LOADER.*)

Dealer Copy -- Not for Resale

**Buy Now**



Our support email:

[ebooklibonline@outlook.com](mailto:ebooklibonline@outlook.com)