



Bobcat®

Service Manual

Front Mount Angle Broom

(FMAB54) S/N AT3400101 & Above
(FMAB70) S/N AT3300101 & Above
(FMAB54) S/N B22M00101 & Above
(FMAB70) S/N B1CZ00101 & Above

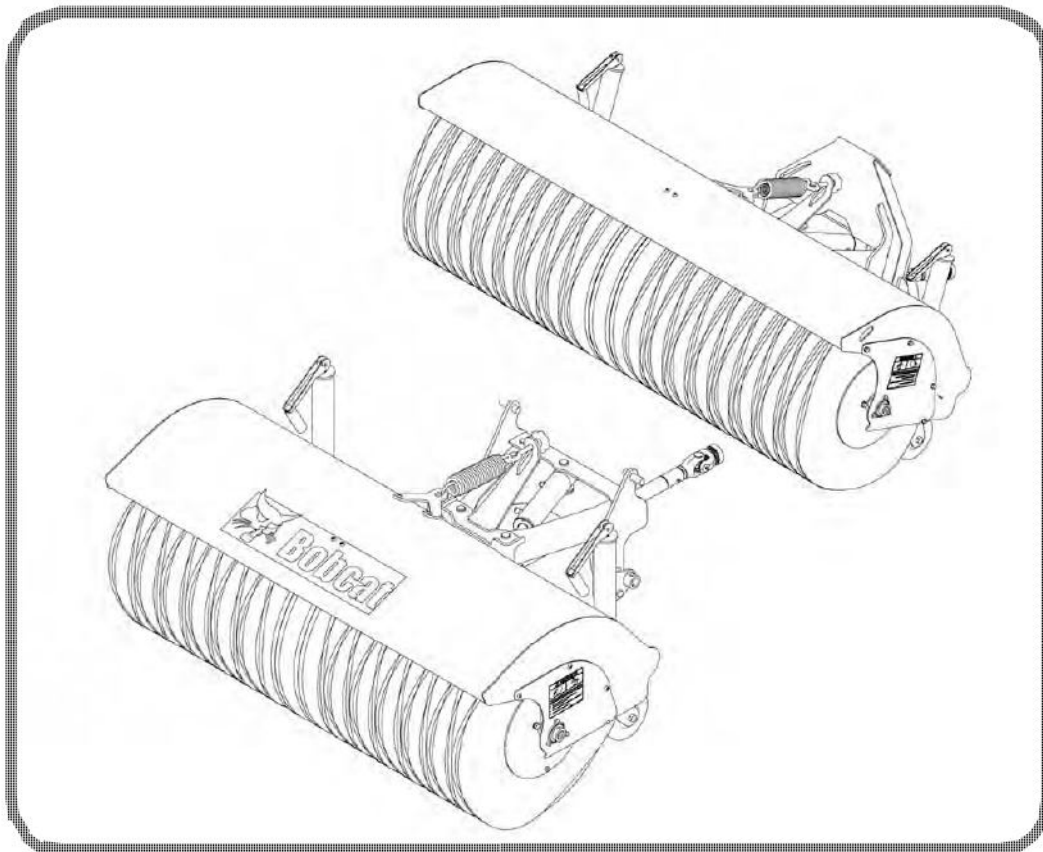

Dealer Copy -- Not for Resale



MAINTENANCE SAFETY



WARNING







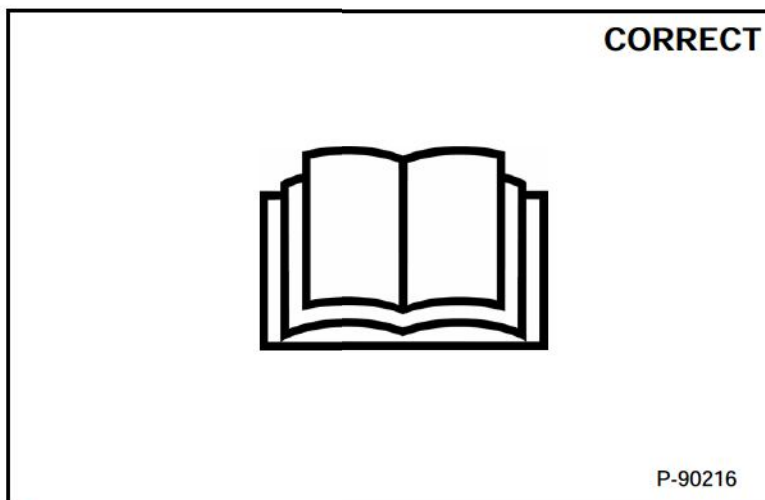

Instructions are necessary before operating or servicing machine. Read and understand the Operation & Maintenance Manual, Operator's Handbook and signs (decals) on machine. Follow warnings and instructions in the manuals when making repairs, adjustments or servicing. Check for correct function after adjustments, repairs or service. Untrained operators and failure to follow instructions can cause injury or death.

W-2003-0807



Safety Alert Symbol: This symbol with a warning statement, means: "Warning, be alert! Your safety is involved!" Carefully read the message that follows.



-  Never service attachments / implements without instructions. See Operation & Maintenance Manual and Attachment / Implement Service Manual.
-  Cleaning and maintenance are required daily.
-  Never service or adjust attachment / implement with the engine running unless instructed to do so in manual.
-  Always lower the attachment / implement to the ground before lubricating or servicing.
-  Avoid contact with leaking hydraulic fluid or diesel fuel under pressure. It can penetrate skin or eyes.
-  Stop, cool and clean engine of flammable materials before checking fluids.
-  Keep body, loose objects and clothing away from moving parts, electrical contacts, hot parts and exhaust.
-  Safety glasses are needed for eye protection from electrical arcs, battery acid, compressed springs, fluids under pressure and flying debris or when tools are used. Use eye protection approved for type of welding.

Dealer Copy -- Not for Resale

MSW30-0409

CONTENTS

SAFETY AND MAINTENANCE	10-01
HYDRAULIC SYSTEM	20-01
MAINFRAME	30-01
SPECIFICATIONS	SPEC-01
ALPHABETICAL INDEX	INDEX-01

Dealer Copy -- Not for Resale

FOREWORD

SERIAL NUMBER LOCATION	1-7
Attachment Serial Number	1-7
DELIVERY REPORT	1-7
ATTACHMENT IDENTIFICATION	1-8
(FMAB54) S/N AT3400101 & Above, (FMAB70) S/N AT3300101 & Above	1-8
(FMAB54) S/N B22M00101 & Above, (FMAB70) S/N B1CZ00101 & Above	1-9

SERIAL NUMBER LOCATION

Attachment Serial Number

Figure 1

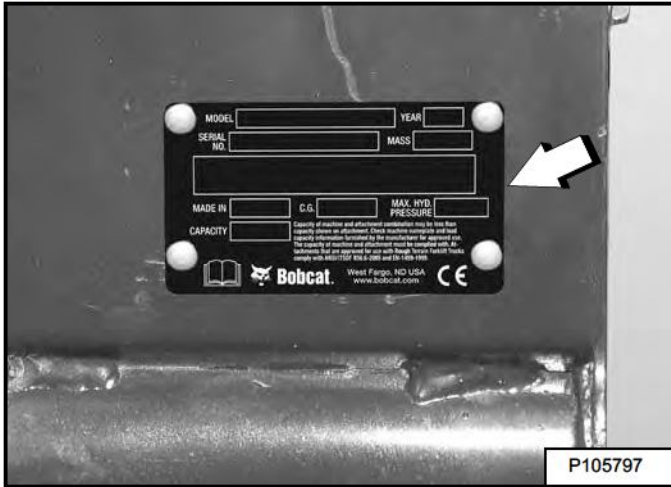

Always use the serial number [Figure 1] of the front mount angle broom when requesting service information or when ordering parts. Early or later models (identification made by serial number) may use different parts, or it may be necessary to use a different procedure in doing a specific service operation.

DELIVERY REPORT

Figure 2

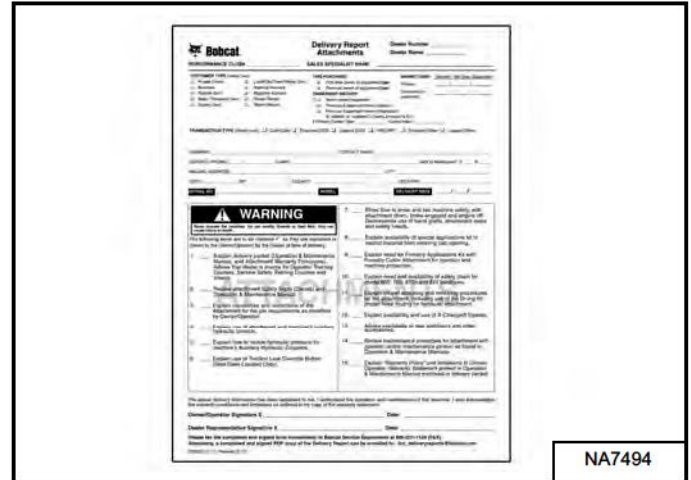

The delivery report [Figure 2] must be completed by the dealer and signed by the owner or operator when the Bobcat front mount angle broom is delivered. An explanation of the form must be given to the owner.

Dealer Copy -- Not for Resale

ATTACHMENT IDENTIFICATION

(FMAB54) S/N AT3400101 & Above, (FMAB70) S/N AT3300101 & Above

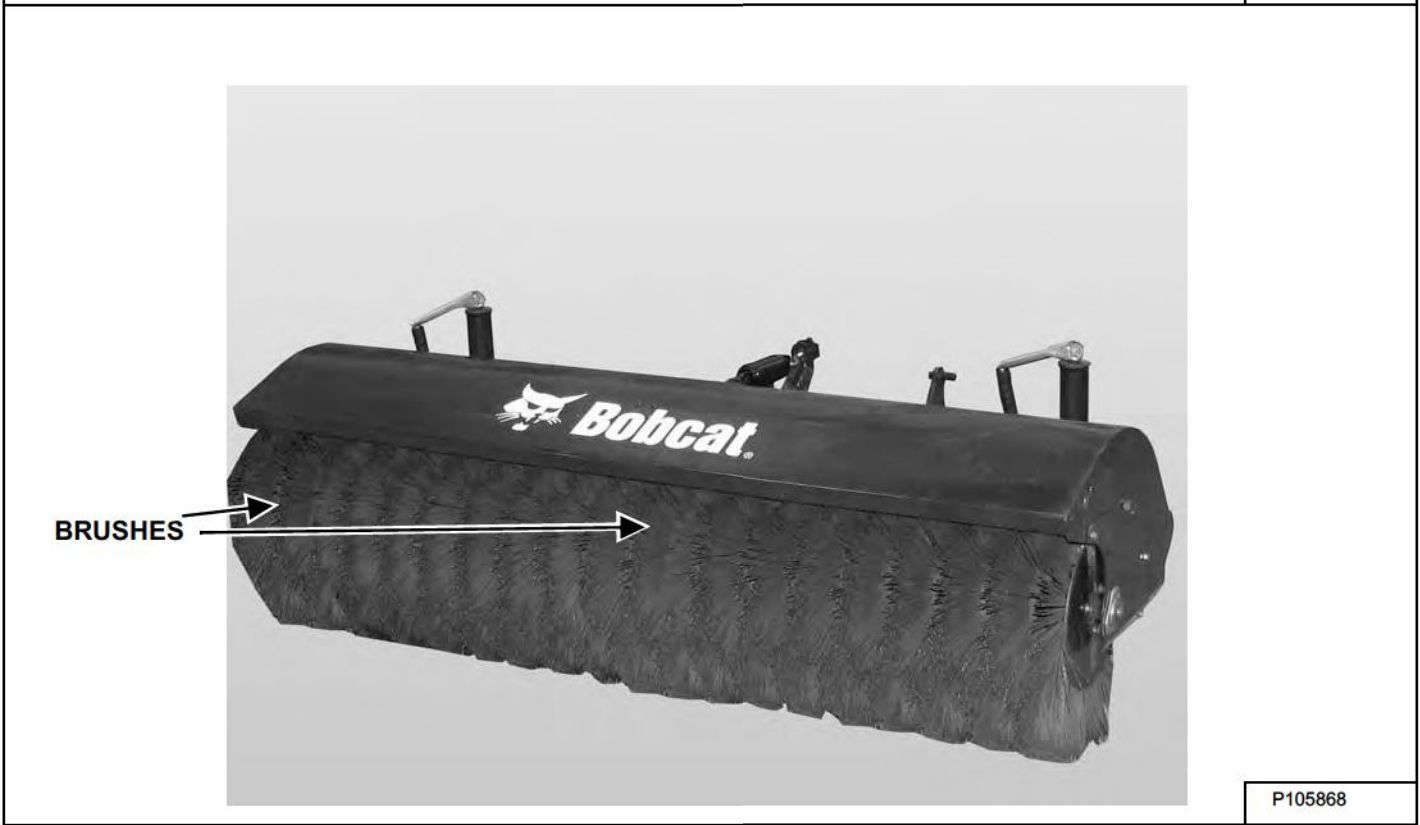
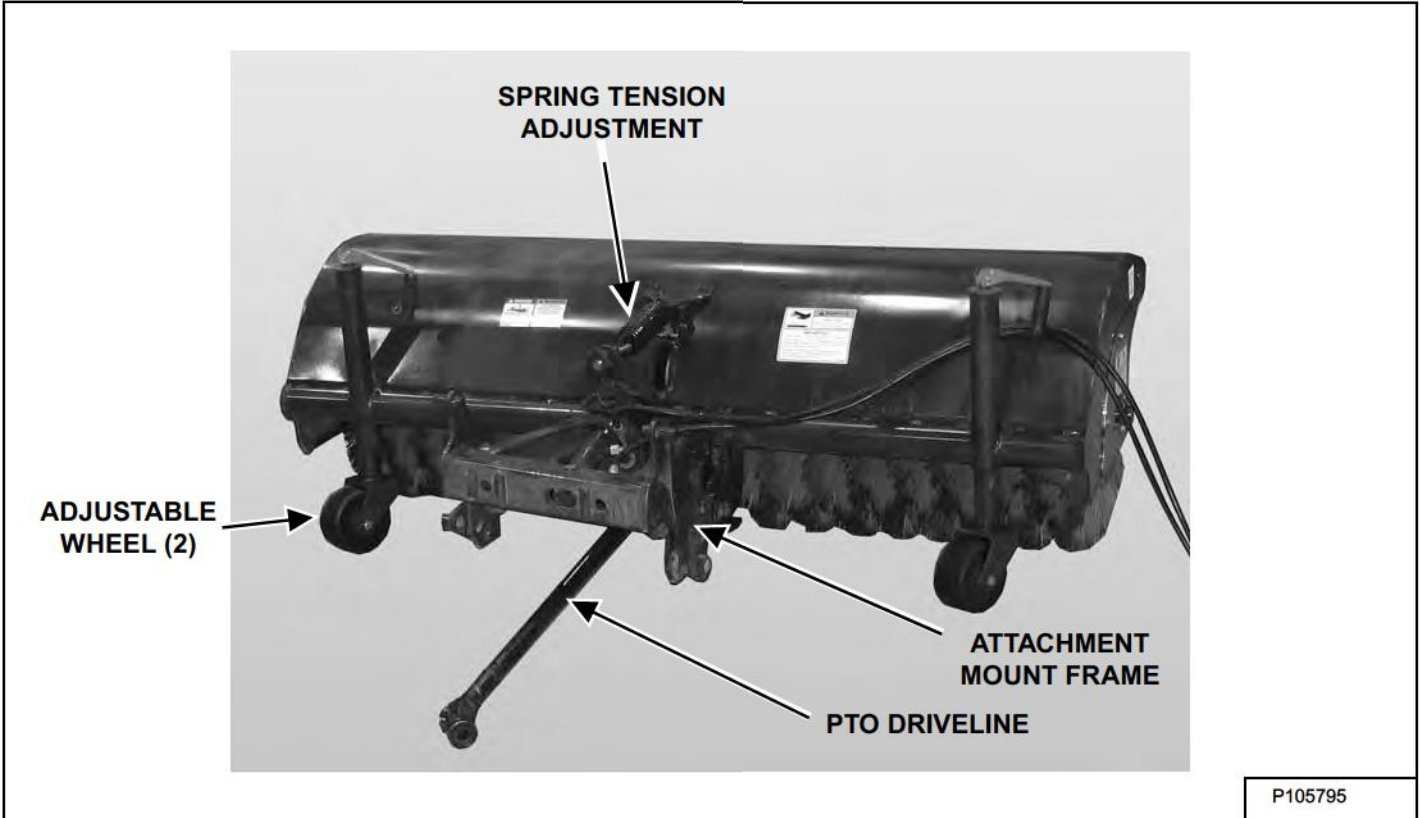

Dealer Copy -- Not for Resale

ATTACHMENT IDENTIFICATION (CONT'D)

(FMAB54) S/N B22M00101 & Above, (FMAB70) S/N B1CZ00101 & Above

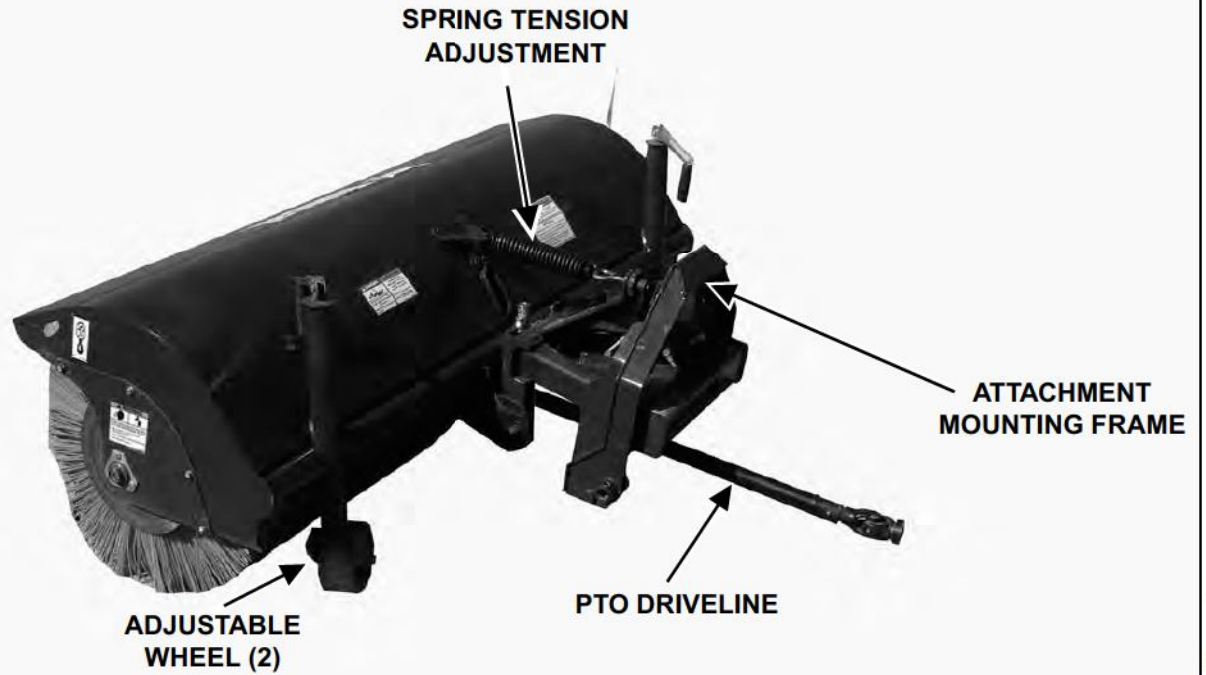

P108364



P108028

Dealer Copy -- Not for Resale

SAFETY AND MAINTENANCE

TROUBLESHOOTING	10-10-1
Chart	10-10-1
SERVICE SCHEDULE	10-20-1
Chart	10-20-1
DAILY INSPECTION	10-30-1
Attachment Mounting Frame	10-30-1
Compact Tractor Quick Hitch	10-30-1
Quick Hitch	10-30-2
Front Mount Frame	10-30-3
Front-PTO Shaft Assembly (Compact Tractor Only)	10-30-4
PTO Driveline	10-30-4
LUBRICATING THE ATTACHMENT	10-40-1
Lubrication Locations	10-40-1
Gearbox Fluid Change	10-40-3
REGULAR MAINTENANCE ITEMS	10-50-1
Adjustable Wheels	10-50-1
Shear Bolt Replacement	10-50-1
Cleaning The Front Mount Angle Broom	10-50-3
ATTACHMENT STORAGE AND RETURN TO SERVICE	10-60-1
Storage	10-60-1
Return To Service	10-60-1

Dealer Copy -- Not for Resale

TROUBLESHOOTING

Chart

 WARNING	<p>Instructions are necessary before operating or servicing machine. Read and understand the Operation & Maintenance Manual, Operator's Handbook and signs (decals) on machine. Follow warnings and instructions in the manuals when making repairs, adjustments or servicing. Check for correct function after adjustments, repairs or service. Untrained operators and failure to follow instructions can cause injury or death.</p> <p style="text-align: right;">W-2003-0807</p>
--	--

Use the following troubleshooting chart to locate and correct problems which most often occur with the attachment.

PROBLEM	CAUSE	CORRECTION
Angle broom does not operate.	Damaged or incorrect attachment of the PTO shaft.	Check connection, connect properly, repair or replace.
	Brush shaft shear bolt has sheared / missing.	Replace bolt.
	Gearbox input shaft shear bolt has sheared or missing.	Replace bolt.
Broom brushes wear quickly.	Too much down pressure being applied to the broom.	Adjust the wheel height.
		Adjust spring tension
Broom operation not effective.	Broom brushes worn to minimum length.	Replace Broom brush sections.

Dealer Copy -- Not for Resale

Buy Now



Our support email:

ebooklibonline@outlook.com