



**Bobcat®**

# TREE VIBRATOR

Single  
Double

# Service Manual

Model 30 – S/N 991600101 & Above  
Model 40 – S/N 991700101 & Above

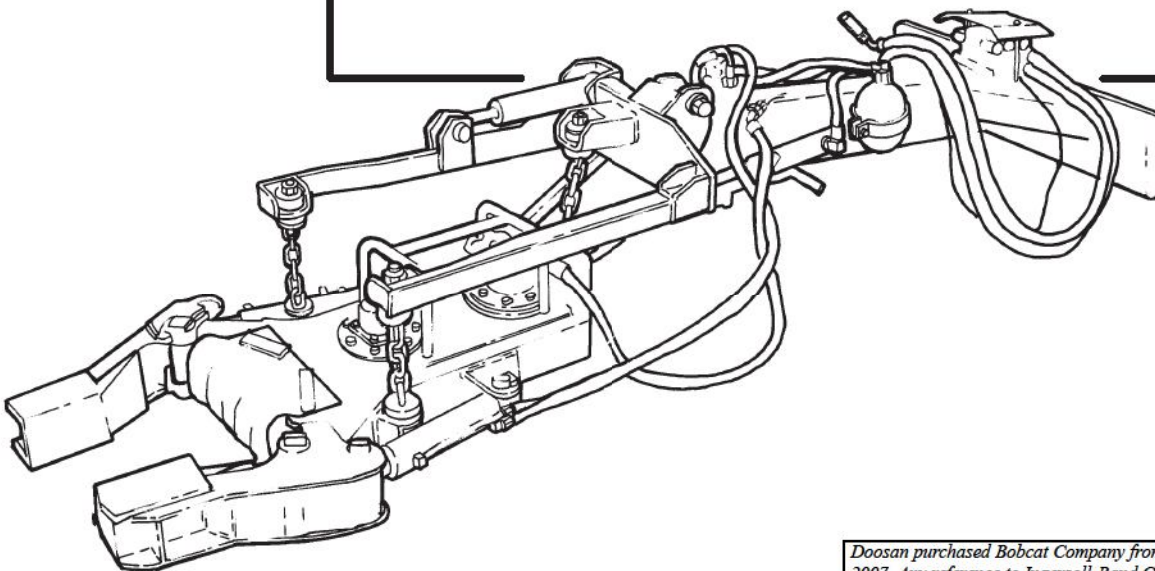

*Doosan purchased Bobcat Company from Ingersoll-Rand Company in 2007. Any reference to Ingersoll-Rand Company or use of trademarks, service marks, logos, or other proprietary identifying marks belonging to Ingersoll-Rand Company in this manual is historical or nominative in nature, and is not meant to suggest a current affiliation between Ingersoll-Rand Company and Bobcat Company or the products of either.*



Printed in U.S.A.

# MAINTENANCE SAFETY



## WARNING







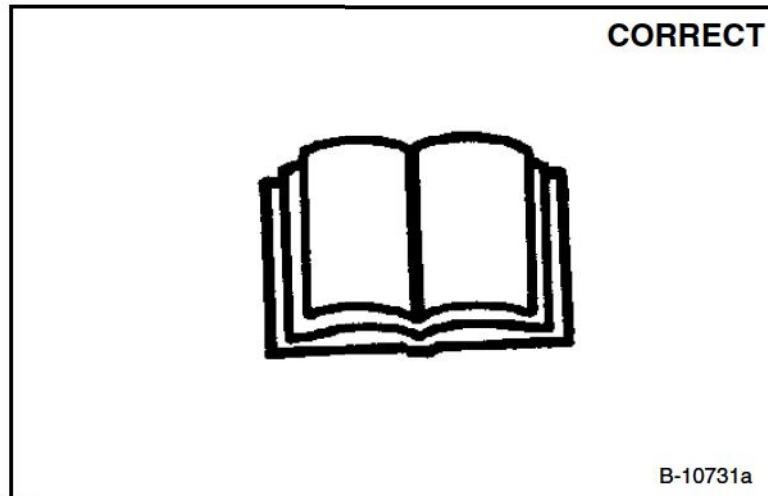

Instructions are necessary before operating or servicing machine. Read and understand the Operation & Maintenance Manual, Operator's Handbook and signs (decals) on machine. Follow warnings and instructions in the manuals when making repairs, adjustments or servicing. Check for correct function after adjustments, repairs or service. Untrained operators and failure to follow instructions can cause injury or death.

W-2003-0903



**Safety Alert Symbol:** This symbol with a warning statement, means: "Warning, be alert! Your safety is involved!" Carefully read the message that follows.



-  Never service attachments without instructions. See Operation & Maintenance Manual and Attachment Service Manual.
-  Cleaning and maintenance are required daily.
-  Never service or adjust attachment with the engine running unless instructed to do so in manual.
-  Always lower the attachment to the ground before lubricating or servicing.
-  Avoid contact with leaking hydraulic fluid or diesel fuel under pressure. It can penetrate skin or eyes.
-  Stop, cool and clean engine of flammable materials before checking fluids.
-  Keep body, loose objects and clothing away from moving parts, electrical contacts, hot parts and exhaust.
-  Safety glasses are needed for eye protection from electrical arcs, battery acid, compressed springs, fluids under pressure and flying debris or when tools are used. Use eye protection approved for type of welding.

## ALPHABETICAL INDEX

ACCUMULATOR (DOUBLE) .....	20-01
CLAMPING ARM (SINGLE AND DOUBLE) .....	30-01
CLAMPING PADS (SINGLE AND DOUBLE) .....	30-01
ELECTRICAL SCHEMATIC WITH 7-PIN CONNECTOR .....	40-01
GLOSSARY OF HYDRAULIC SYMBOLS .....	40-01
HYDRAULIC CONTROL VALVE (SINGLE AND DOUBLE) .....	20-01
HYDRAULIC CYLINDER (SINGLE AND DOUBLE) .....	20-01
HYDRAULIC MOTOR (SINGLE AND DOUBLE) .....	20-01
HYDRAULIC SCHEMATIC .....	40-01
INSPECTION .....	10-01
LEVELING ARM (SINGLE AND DOUBLE) .....	30-01
LUBRICATION .....	10-01
PARTS IDENTIFICATION .....	v
SERIAL NUMBER LOCATION .....	iii
SPECIFICATIONS (DOUBLE) .....	40-01
SPECIFICATIONS (SINGLE) .....	40-01
TILTING FRAME (SINGLE AND DOUBLE) .....	30-01
TROUBLESHOOTING .....	10-01
VIBRATING HEAD (DOUBLE) .....	30-01
VIBRATING HEAD (SINGLE) .....	30-01

Dealer Copy -- Not for Resale

# CONTENTS

SERIAL NUMBER LOCATION .....	iii ..
PARTS IDENTIFICATION .....	v ..
SAFETY AND MAINTENANCE .....	10-01
HYDRAULIC SYSTEM .....	20-01
MAIN FRAME .....	30-01
SPECIFICATIONS AND SCHEMATICS .....	40-01

**SAFETY AND  
MAINTENANCE**

**HYDRAULIC  
SYSTEM**

**MAIN  
FRAME**

**SPECIFICATIONS  
AND  
SCHEMATICS**

**CALIFORNIA  
PROPOSITION 65 WARNING**

Diesel engine exhaust and some of its constituents are known to the State of California to cause cancer, birth defects and other reproductive harm.

Dealer Copy -- Not for Resale

## SERIAL NUMBER LOCATION

Always use the serial number of the Tree Vibrator when requesting service information or when ordering parts. Early or later models (identification made by serial number) may use different parts, or it may be necessary to use a different procedure in doing a specific service operation [A].

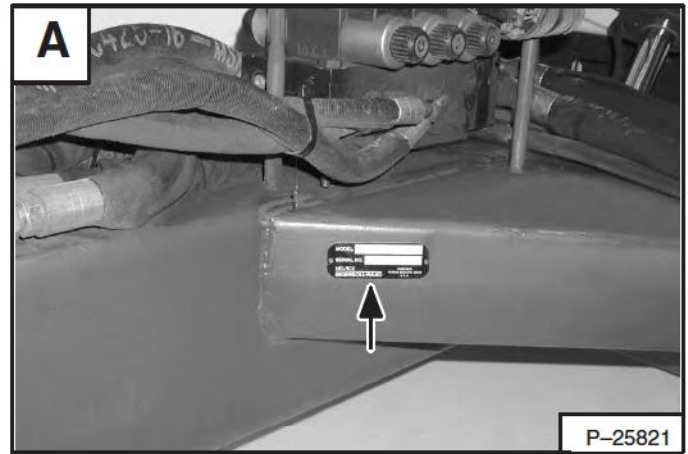

Dealer Copy -- Not for Resale

**PARTS IDENTIFICATION**  
Single

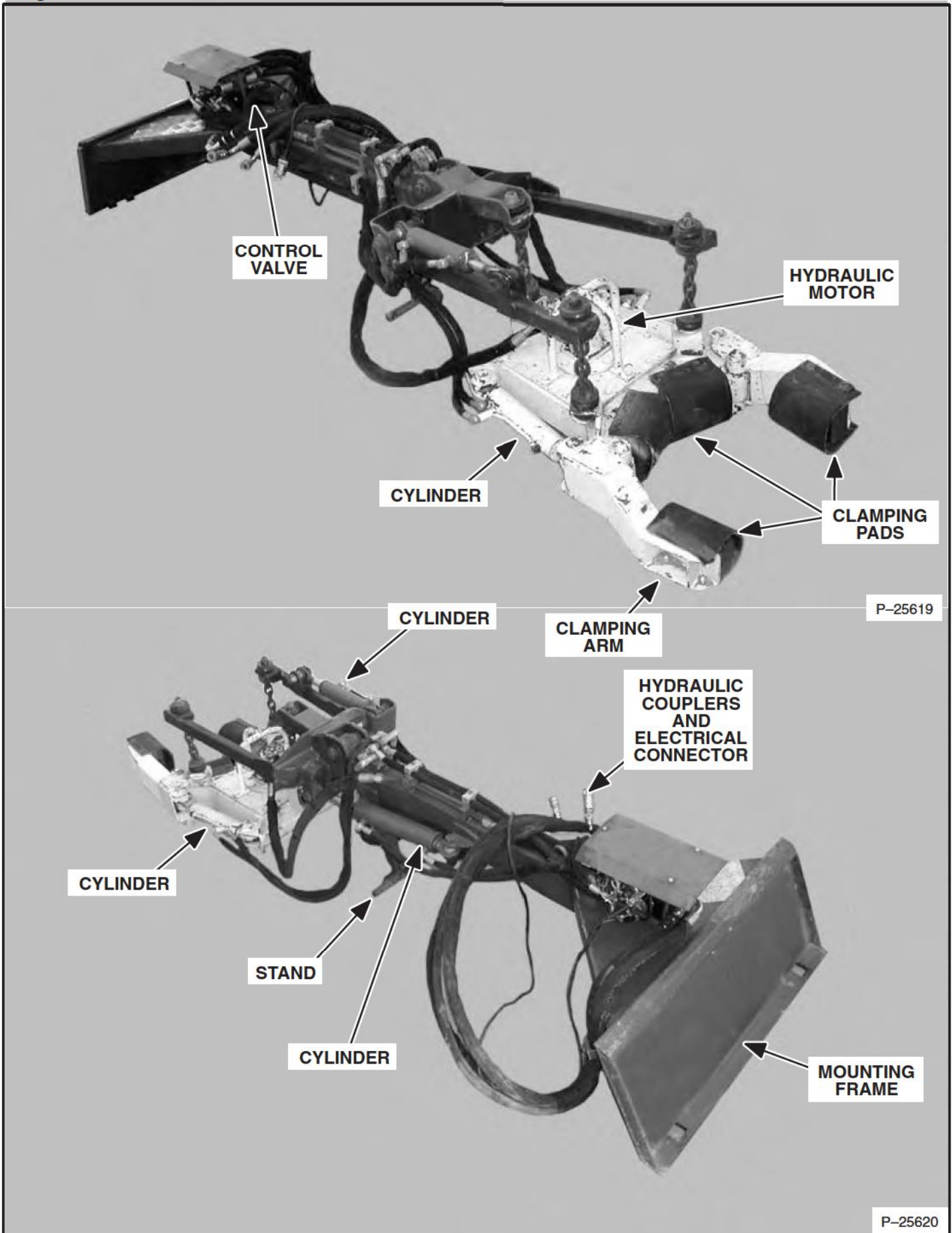

Dealer Copy -- Not for Resale

PARTS IDENTIFICATION (Cont'd)

Double

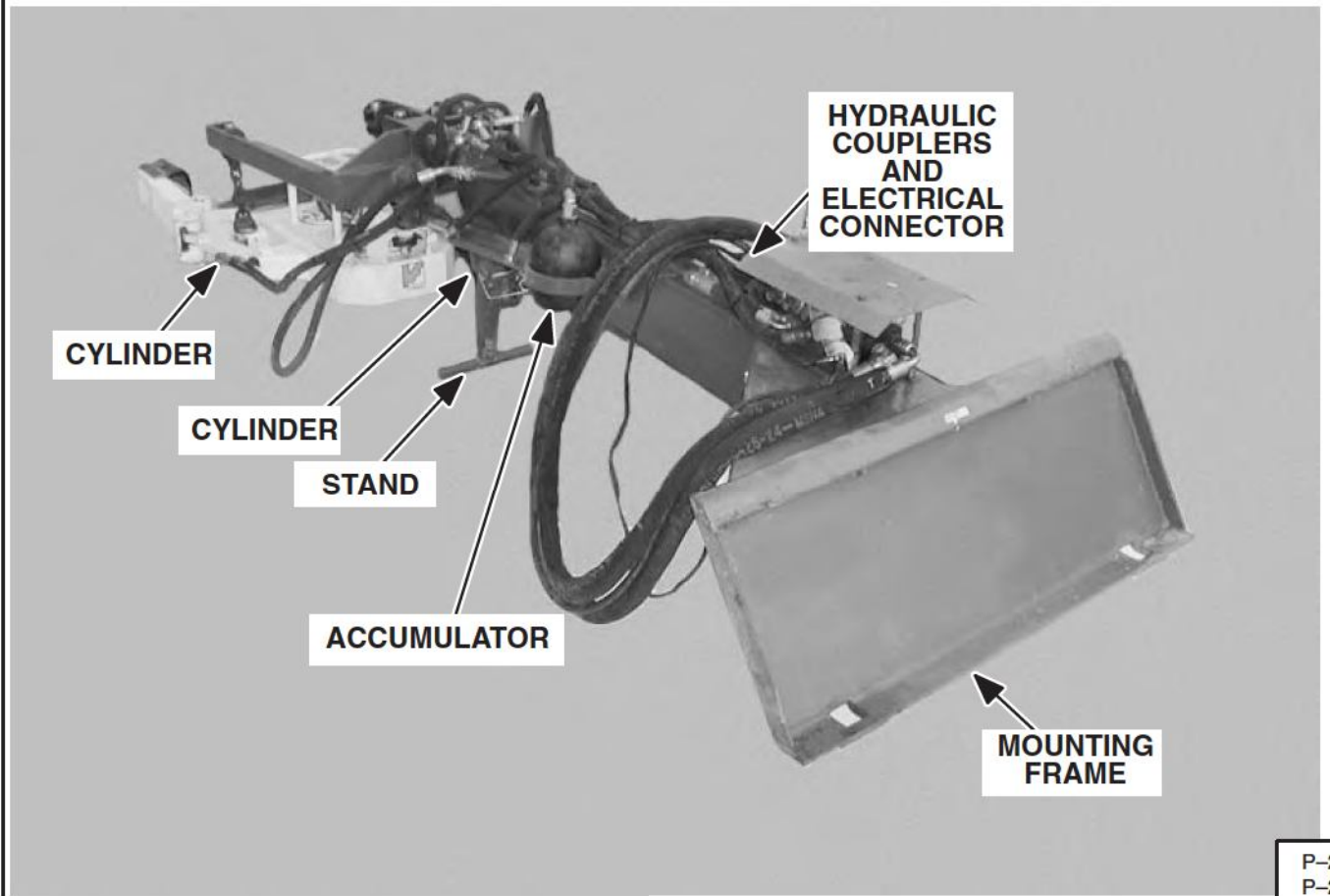
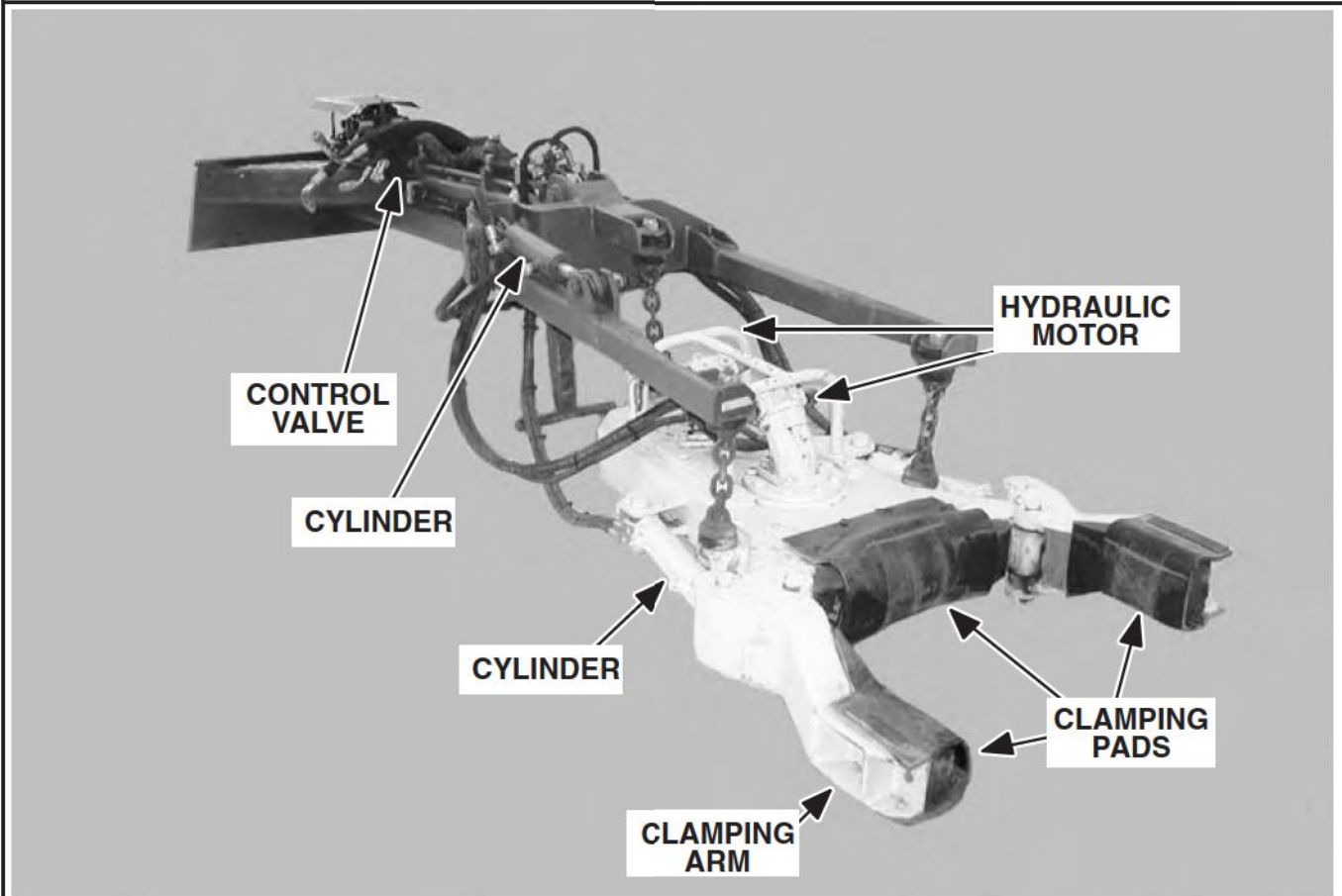

Dealer Copy --- Not for Resale

P-25837  
P-25836

# SAFETY AND MAINTENANCE

	<b>PAGE NUMBER</b>
<b>INSPECTION</b>	
Tree Vibrator Mount Inspection .....	10-10-4
Hand Lever Bob-Tach Inspection .....	10-10-2
Power Bob-Tach Inspection .....	10-10-3
<b>LUBRICATION</b>	
Lubrication Points .....	10-10-4
<b>TROUBLESHOOTING</b> .....	10-10-1

**SAFETY AND  
MAINTENANCE**

Dealer Copy -- Not for Resale



**TROUBLESHOOTING**



Instructions are necessary before operating or servicing machine, Read Operation & Maintenance Manual, Handbook and signs (decals) on machine. Follow warnings and instructions in the manuals when making repairs, adjustments or servicing. Check for correct function after adjustments, repairs or service. Failure to follow instructions can cause injury or death.

W-2003-0199

If the Tree Vibrator is not working correctly, check the hydraulic system of the Bobcat Loader thoroughly before making any repairs on the Tree Vibrator. Tree Vibrator problems can be affected by a hydraulic system that is not operating to specifications.

If the Bobcat Loader operation is found to be correct, use the following troubleshooting chart to locate and correct problems with the Tree Vibrator.

PROBLEM	CAUSE	CORRECTION
Cannot change angle of cylinders.	Fuse is blown. Electrical overload.	Replace fuse in loader. See your Bobcat Loader Operation & Maintenance Manual for the location, size and type of fuse.
	Damage to the wires, harness or electrical connectors.	See your Bobcat dealer and the electrical schematics in the SPECIFICATION section of this manual.
	Faulty or damaged solenoid(s).	Replace solenoid(s).
	Auxiliary hydraulics switch not engaged.	Engage auxiliary hydraulics switch.
Tree Vibrator will not vibrate.	Auxiliary front hydraulics not engaged.	Engage the loader front auxiliary hydraulics.
	Continuous Operation auxiliary hydraulic switch not engaged.	Engage Continuous Operation auxiliary hydraulic switch.
Cylinders move quickly and are hard to position.	Auxiliary switch in maximum flow position.	Move switch to variable flow.

Dealer Copy -- Not for Resale

## INSPECTION

### Hand Lever Bob-Tach Inspection

Move the Bob-Tach levers to engage the wedges [A]. The levers and wedges must move freely.

The wedges must extend through the holes in the attachment mounting frame (Item 1) [A].

## ! WARNING

Bob-Tach wedges must extend through the holes in attachment. Lever(s) must be fully down and locked. Failure to secure wedges can allow attachment to come off and cause injury or death.

W-2102-0497

The spring loaded wedge (Item 1) [A] must contact the lower edge of the hole in the attachment (Item 1) [B] and [C].

If the wedge does not contact the lower edge of the hole [B] and [C], the attachment will be loose and can come off the Bob-Tach.

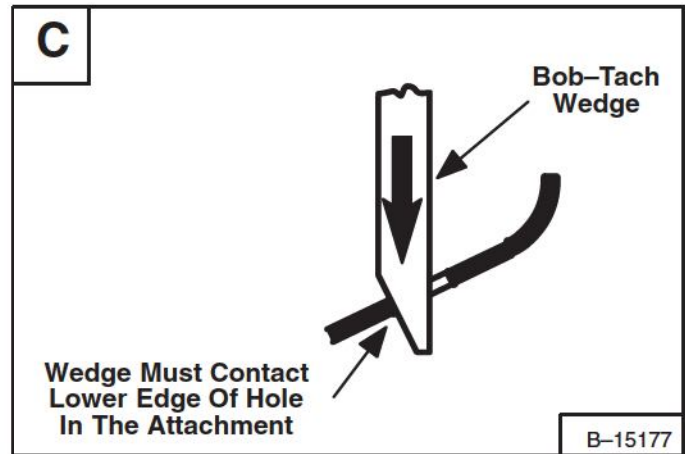
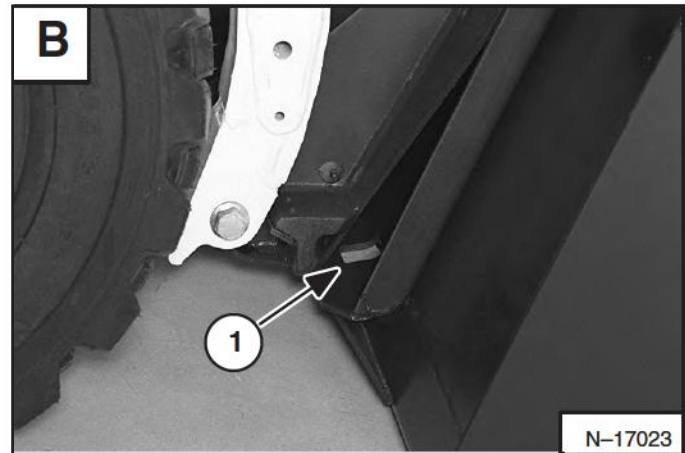
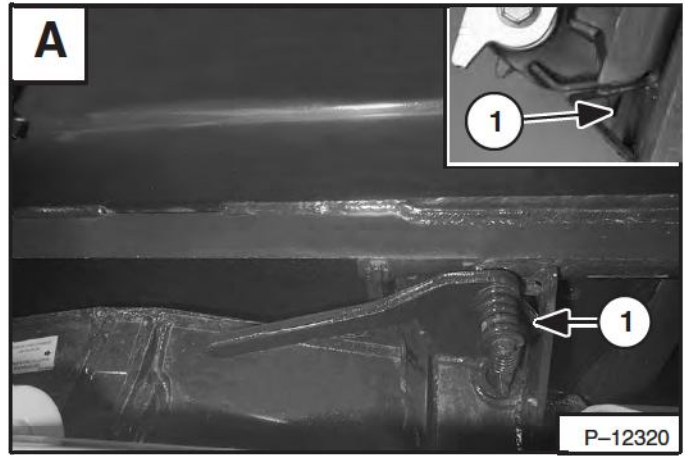

Inspect the mounting frame on the attachment and the Bob-Tach, linkages and wedges for excessive wear or damage [D]. Replace any parts that are damaged, bent, or missing. Keep all fasteners tight.

Look for cracked welds. Contact your Bobcat dealer for repair or replacement parts.

Lubricate the wedges (See the correct loader Operation And Maintenance Manual for LUBRICATION OF THE LOADER).

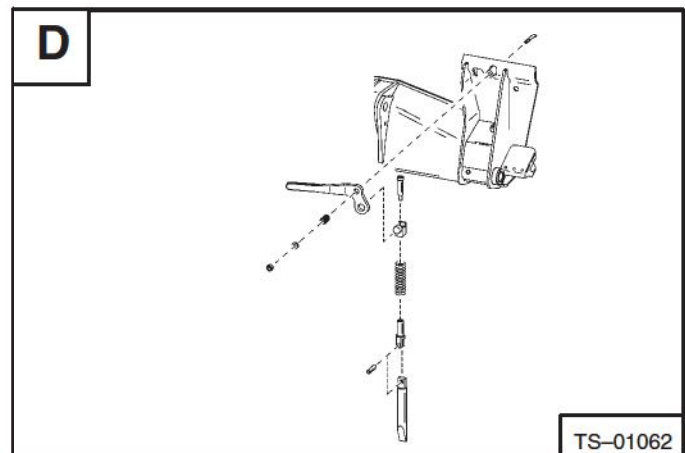

## INSPECTION(Cont'd)

### Power Bob-Tach Inspection

Push and hold the Bob-Tach “WEDGES UP” switch [A] until wedges are fully raised. Push and hold the Bob-Tach “WEDGES DOWN” switch [A] until the wedges are fully down. The wedges must move freely.

The wedges must extend through the holes in the attachment mounting frame (Item 1) [B] and must contact the lower edge of the hole in the attachment [B] and (Item 1) [C].

If the wedge does not contact the lower edge of the hole [C], the attachment will be loose and can come off the Bob-Tach.

Inspect the mounting frame on the attachment and the Bob-Tach, linkages and wedges for excessive wear or damage [D]. Replace any parts including decals and levers that are damaged, bent or missing. Keep all fasteners tight. Inspect the hoses and fittings for leaks.

Look for cracked welds. Contact your Bobcat dealer for repair or replacement parts.

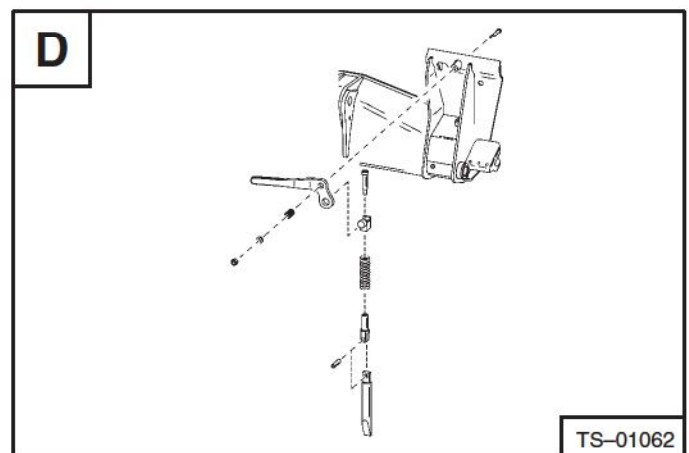
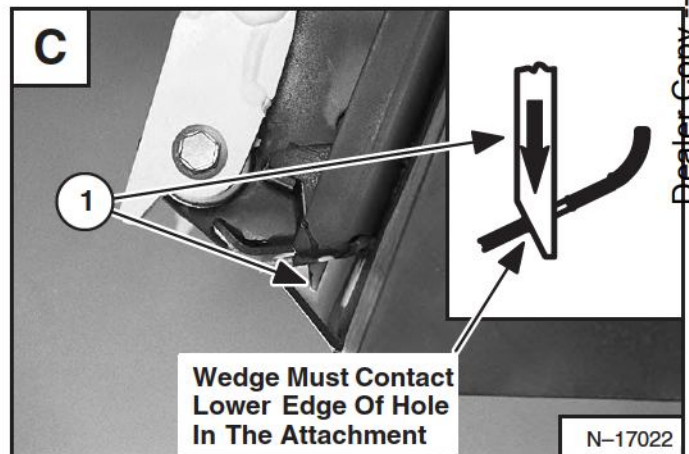
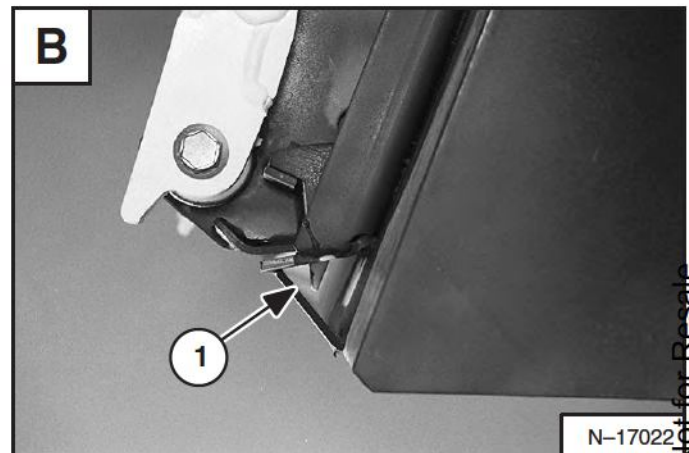
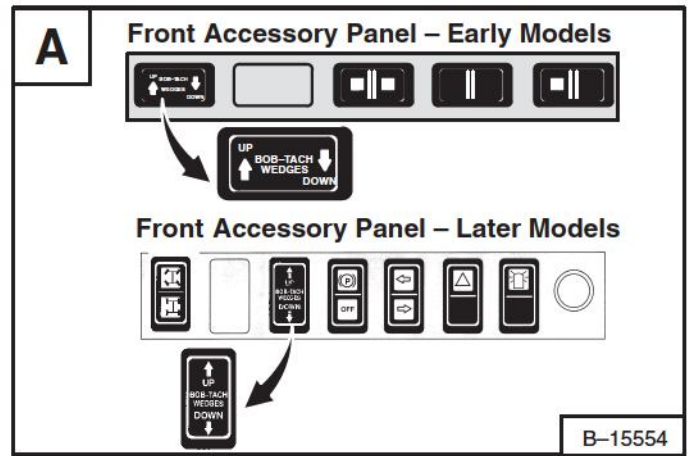

Thank you so much for reading.  
Please click the “Buy Now!”  
button below to download the  
complete manual.



After you pay.

You can download the most  
perfect and complete manual in  
the world immediately.

Our support email:

[ebooklibonline@outlook.com](mailto:ebooklibonline@outlook.com)