



Service Repair Manual

Models

160M 3 AWD MOTOR GRADER

Product: MOTOR GRADER

Model: 160M 3 AWD MOTOR GRADER N9T

Configuration: 160M Series 3 Motor Grader-All Wheel Drive N9T00001-UP (MACHINE) POWERED BY C9.3 Engine

Disassembly and Assembly

12M Series 3, 140M Series 3 and 160M Series 3 Motor Graders Machine Systems

Media Number -UENR3488-02

Publication Date -01/09/2018

Date Updated -24/09/2018

i02649335

Piston Pump (Hydraulic and Steering) - Assemble

SMCS - 4306-016; 5070-016

Assembly Procedure

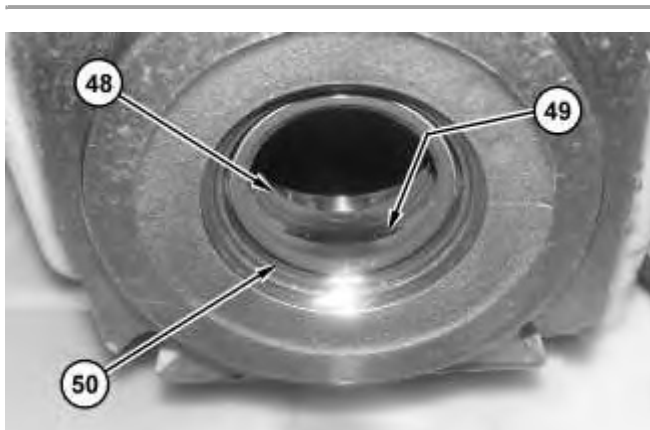

Illustration 1

g01330063

1. Install lip seal (48).
 2. Use Tooling (C) in order to install retaining ring (49).
 3. Install lip seal (50).
-

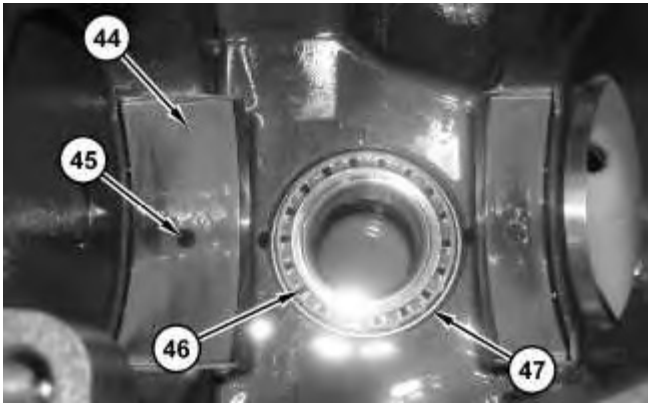

Illustration 2

g01330062

4. Install screws (45), bearings (44), bearing cone (46), and bearing cup (47).

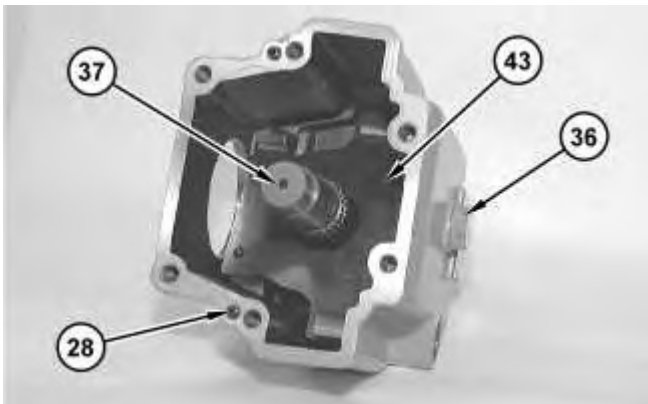

Illustration 3

g01333311

5. Install swashplate (43).
6. Install shaft (37).
7. Install plug (36).
8. Install dowel (28).

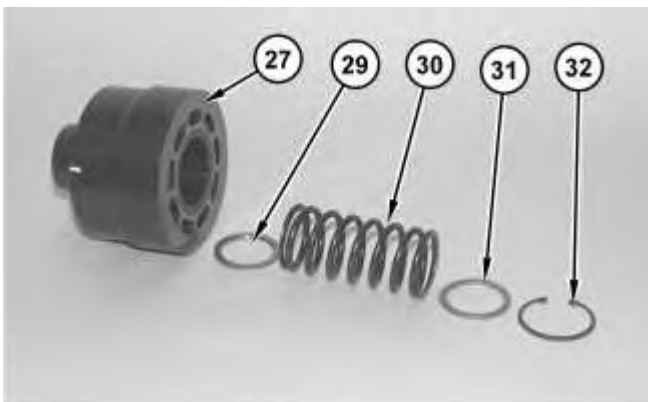

Illustration 4

g01329913

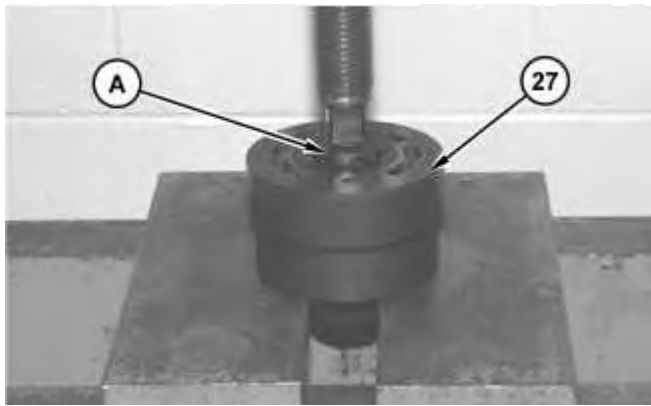

Illustration 5

g01329911

 **WARNING**

Improper assembly of parts that are spring loaded can cause bodily injury.

To prevent possible injury, follow the established assembly procedure and wear protective equipment.

9. Install washer (31), spring (30), and washer (29).
10. Use Tooling (A), Tooling (B) and a suitable press in order to install retaining ring (32) onto barrel (27).

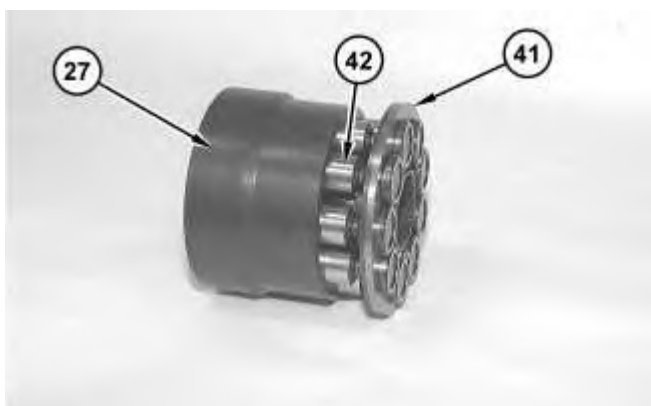

Illustration 6

g01333324

11. Install pistons (42) into retainer (41) and barrel (27).
-



Illustration 7

g01333336

12. Install barrel (27).

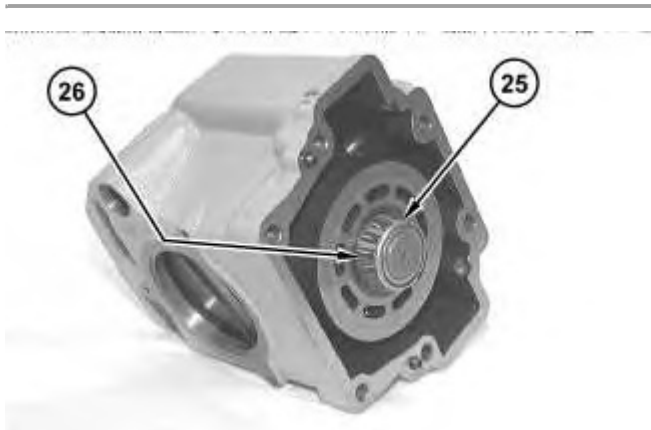

Illustration 8

g01333337

13. Install shim (26) and bearing cone (25).

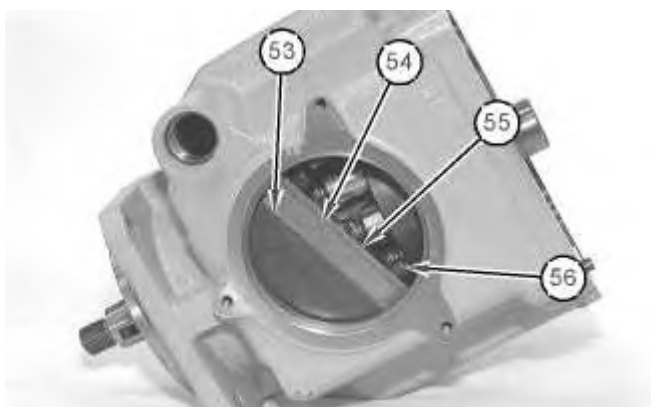

Illustration 9

g01076392

Thank you so much for reading.
Please click the “Buy Now!”
button below to download the
complete manual.



After you pay.

You can download the most
perfect and complete manual in
the world immediately.

Our support email:

ebooklibonline@outlook.com