



# Service Repair Manual

## **Models**

Caterpillar Cat 236B

SKID STEER LOADER

---

Product: SKID STEER LOADER

Model: 236B SKID STEER LOADER HEN

Configuration: 236B 246B 252B 262B SKID STEER LOADER HEN00001-06749 (MACHINE) POWERED BY 3044C Engine

## Disassembly and Assembly

### C3.4 Engines for Caterpillar Built Machines

Media Number -KENR6941-04

Publication Date -01/03/2012

Date Updated -01/03/2012

i02639276

## Flywheel Housing - Remove and Install

SMCS - 1157-010

### Removal Procedure

Table 1

Required Tools			
Tool	Part Number	Part Description	Qty
A	-	Guide Stud (M10 x 1.25 by 100 mm)	2

#### Start By:

- A. Remove the flywheel. Refer to Disassembly and Assembly, "Flywheel - Remove".

---

#### NOTICE

**Keep all parts clean from contaminants.**

**Contaminants may cause rapid wear and shortened component life.**

---

---

#### NOTICE

**Care must be taken to ensure that fluids are contained during performance of inspection, maintenance, testing, adjusting and repair of the product. Be prepared to collect the fluid with suitable containers before opening any compartment or disassembling any component containing fluids.**

**Dispose of all fluids according to local regulations and mandates.**

---

1. Support the engine.

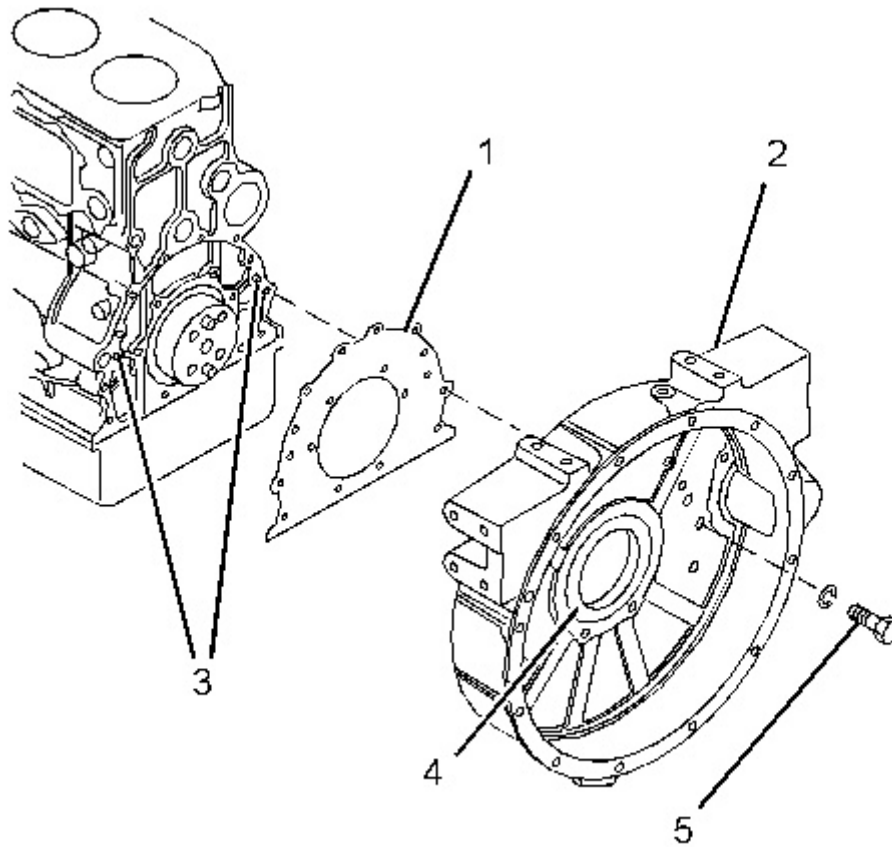

---

Illustration 1

g01335374

Typical example

---

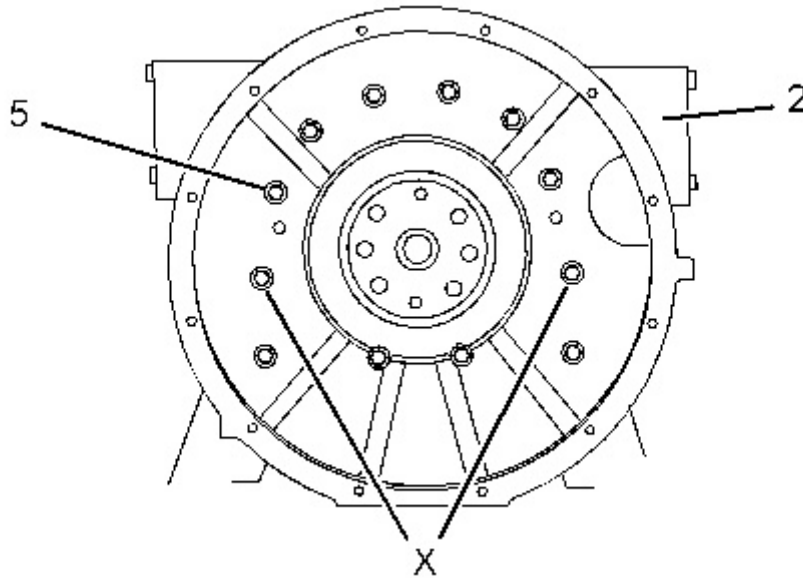

Illustration 2

g01366220

Typical example

2. Remove two bolts (5) from positions (X) on flywheel housing (2) .
  3. Install Tooling (A) to positions (X) on flywheel housing (2) .
  4. Attach a suitable lifting device to flywheel housing (2). The weight of the flywheel housing is approximately 32 kg (71 lb).
  5. Remove the remaining bolts (5) .
  6. Carefully remove flywheel housing (2) from dowels (3) and from the cylinder block.
- Note:** If necessary, tap the flywheel housing with a soft faced hammer in order to separate the flywheel housing from the cylinder block.
7. Remove joint (1) .
  8. Remove crankshaft rear seal (4) from flywheel housing (2) .

## Installation Procedure

Table 2

Required Tools			
Tool	Part Number	Part Description	Qty
A	-	Guide Stud (M10 x 1.25 by100 mm)	2
B	8T-5096	Dial Indicator Group	1

## NOTICE

**Keep all parts clean from contaminants.**

**Contaminants may cause rapid wear and shortened component life.**

---

1. Ensure that the mating surfaces of the cylinder block and the flywheel housing are clean and free from damage.

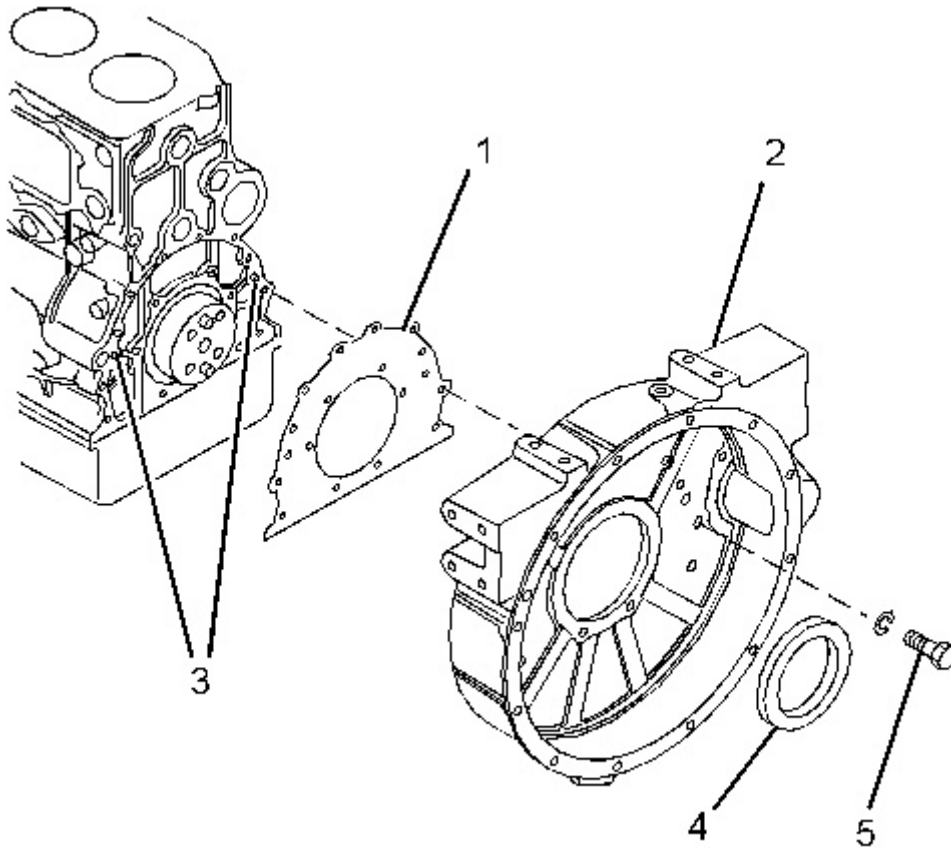

Illustration 3

g01335383

Typical example

2. Inspect dowels (3) in the cylinder block. If necessary, replace the dowels.
-

Thank you so much for reading.  
Please click the “Buy Now!”  
button below to download the  
complete manual.



After you pay.

You can download the most  
perfect and complete manual in  
the world immediately.

Our support email:

[ebooklibonline@outlook.com](mailto:ebooklibonline@outlook.com)